

UNITED STATES  
DEPARTMENT OF THE INTERIOR  
GEOLOGICAL SURVEY

## APPLICATION FOR PERMIT TO DRILL, DEEPEN, OR PLUG BACK

## 1a. TYPE OF WORK

DRILL ☒DEEPEN ☐PLUG BACK ☐

## b. TYPE OF WELL

OIL  
WELL ☐GAS  
WELL ☒

OTHER

SINGLE  
ZONE ☒MULTIPLE  
ZONE ☐

## 2. NAME OF OPERATOR

PAN AMERICAN PETROLEUM CORPORATION

## 3. ADDRESS OF OPERATOR

P. O. Box 480, Farmington, New Mexico

4. LOCATION OF WELL (Report location clearly and in accordance with any State requirements.)  
At surface

1010' PBL &amp; 1675' PBL

At proposed prod. zone

Same

## 14. DISTANCE IN MILES AND DIRECTION FROM NEAREST TOWN OR POST OFFICE\*

10 miles southeast of Farmington, New Mexico

## 15. DISTANCE FROM PROPOSED\*

LOCATION TO NEAREST  
PROPERTY OR LEASE LINE, FT.  
(Also to nearest drlg. unit line, if any)

1010'

18. DISTANCE FROM PROPOSED LOCATION\*  
TO NEAREST WELL, DRILLING, COMPLETED,  
OR APPLIED FOR, ON THIS LEASE, FT.2700'  
Gallup

## 16. NO. OF ACRES IN LEASE

43,146.62

## 19. PROPOSED DEPTH

6,400'

17. NO. OF ACRES ASSIGNED  
TO THIS WELL

380

## 20. ROTARY OR CABLE TOOLS

Rotary

## 21. ELEVATIONS (Show whether DF, RT, GR, etc.)

To be reported later

## 22. APPROX. DATE WORK WILL START\*

March 8, 1966

## 23.

## PROPOSED CASING AND CEMENTING PROGRAM

| SIZE OF HOLE | SIZE OF CASING | WEIGHT PER FOOT | SETTING DEPTH | QUANTITY OF CEMENT   |
|--------------|----------------|-----------------|---------------|--|
| 12-1/4"      | 8-5/8"         | 24.6            | 350'          | 250 sacks  |
| 7-7/8"       | 4-1/2"         | 10.56           | 6400'         | 1400 sacks (Two stage tool set<br>100' below base of Mesaverde<br>with possible third stage tool<br>set below Pictured Cliffs) |

Completion will be determined upon reaching total depth.  
Copies of location plat are attached.

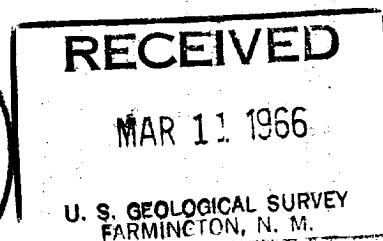

IN ABOVE SPACE DESCRIBE PROPOSED PROGRAM: If proposal is to deepen or plug back, give data on present productive zone and proposed new productive zone. If proposal is to drill or deepen directionally, give pertinent data on subsurface locations and measured and true vertical depths. Give blowout preventer program, if any.

## 24.

## ORIGINAL SIGNED BY

G. W. Eaton, Jr.

SIGNED

TITLE

Area Engineer

DATE

March 7, 1966

(This space for Federal or State office use)

PERMIT NO.

APPROVAL DATE

APPROVED BY

TITLE

DATE

CONDITIONS OF APPROVAL, IF ANY:

## Instructions

**General:** This form is designed for submitting proposals to perform certain well operations, as indicated, on all types of lands and leases for appropriate action by either a Federal or a State agency, or both, pursuant to applicable Federal and/or State laws and regulations. Any necessary special instructions concerning the use of this form and the number of copies to be submitted, particularly with regard to local, area, or regional procedures and practices, either are shown below or will be issued by, or may be obtained from, the local Federal and/or State office.

**Item 1:** If the proposal is to redrill to the same reservoir at a different subsurface location or to a new reservoir, use this form with appropriate notations. Consult applicable State or Federal regulations concerning subsequent work proposals or reports on the well.

**Item 4:** If there are no applicable State requirements, locations on Federal or Indian land should be described in accordance with Federal requirements. Consult local State or Federal office for specific instructions.

Item 14: Needed only when location of well cannot readily be found by road from the land or lease description. A plat, or plats, separate or on this reverse side, showing the roads to, and the surveyed location of, the well, and any other required information, should be furnished when required by Federal or State agency offices.

Items 15 and 18: If well is to be, or has been directionally drilled, give distances for subsurface location of hole in any present or objective production zone.

**Item 22:** Consult applicable Federal or State regulations, or appropriate officials, concerning approval of the proposal before operations are started.

☆ U.S. GOVERNMENT PRINTING OFFICE : 1963—O-711-398



**NEW MEXICO OIL CONSERVATION COMMISSION  
WELL LOCATION AND ACERAGE DEDICATION PLAT**

*All distances must be from the outer boundaries of the Section*

|  |                                      |                             |   |  |                        |
|--|--------------------------------------|-----------------------------|---|--|------------------------|
| Operator<br><b>PAN AMERICAN PETROLEUM CORPORATION</b>  |                                      |                             | Lease<br><b>GALLEGOS CANYON UNIT (DAKOTA)</b> |  | Well No.<br><b>243</b> |
| Unit Letter<br><b>B</b>  | Section<br><b>24</b>                 | Township<br><b>28 NORTH</b> | Range<br><b>12 WEST</b>                       | County<br><b>SAN JUAN</b>              |                        |
| Actual Footage Location of Well:<br><b>1010</b> feet from the <b>NORTH</b> line and <b>1675</b> feet from the <b>EAST</b> line |                                      |                             |   |  |                        |
| Ground Level Elev.<br><b>REPORT LATER</b>  | Producing Formation<br><b>DAKOTA</b> |                             | Pool<br><b>BASIN DAKOTA</b>                   | Dedicated Acreage:<br><b>320</b> Acres |                        |

1. Outline the acreage dedicated to the subject well by colored pencil or hachure marks on the plat below.
2. If more than one lease is dedicated to the well, outline each and identify the ownership thereof (both as to working interest and royalty),
3. If more than one lease of different ownership is dedicated to the well, have the interests of all owners been consolidated by communitization, unitization, force-pooling, etc?

(X) Yes ( ) No If answer is "yes," type of consolidation Unitization

If answer is "no," list the owners and tract descriptions which have actually consolidated. (Use reverse side of this Form if necessary.)

No allowable will be assigned to the well until all interests have been consolidated (by communitization, unitization, forced-pooling, or otherwise) or until a non standard unit, eliminating such interests, has been approved by the Commission.

**CERTIFICATION**

I hereby certify that the information contained herein is true and complete to the best of my knowledge and belief.

*G. W. Eaton, Jr.*  
Name  
**G. W. Eaton, Jr.**  
Position  
**Area Engineer**  
Company  
**PAN AMERICAN PETROLEUM CORP.**  
Date  
**March 7, 1966**

I hereby certify that the well location shown on this plat was plotted from field notes of actual surveys made by me or under my supervision, and that the same is true and correct to the best of my knowledge and belief.

**March 7, 1966**  
Date Surveyed  
*James P. Leese*  
Registered Professional Engineer  
and/or Land Surveyor  
**James P. Leese**  
**1463**  
Certificate No.

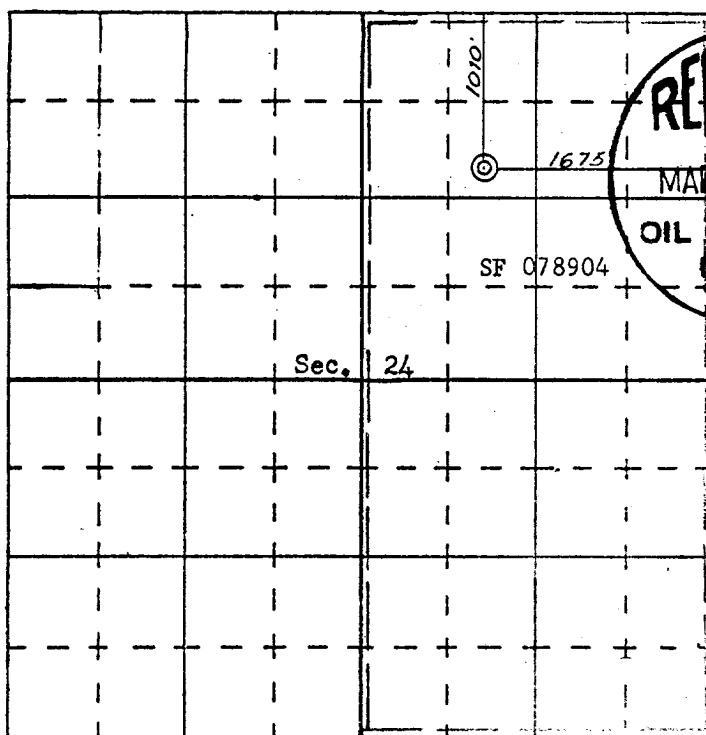

SCALE—4 INCHES EQUALS 1 MILE

**SAN JUAN ENGINEERING COMPANY, FARMINGTON, N. M.**