

**NEW MEXICO OIL CONSERVATION COMMISSION
WELL LOCATION AND ACREAGE DEDICATION PLAT**

Form C-101
Supersedes C-101
1 Effective

All distances must be from the outer boundaries of the Section

Lease: R & G Drilling Company			Lessee: Krause		Well No.: 64
Unit Letter: P	Section: 29	Township: 28N	Range: 11W	County: San Juan	
Actual Footage Location of Well:					
1190 feet from the South line and		1125' feet from the East line			
Ground Level Elev.: 5789	Producing Formation: Farmington	Pool: Kutz Farmington	Dedicated Acreage: 160 Acres		

1. Outline the acreage dedicated to the subject well by colored pencil or hatchure marks on the plat below.
2. If more than one lease is dedicated to the well, outline each and identify the ownership thereof (both as to working interest and royalty).
3. If more than one lease of different ownership is dedicated to the well, have the interests of all owners been consolidated by communitization, unitization, force-pooling, etc?

☐ Yes ☐ No If answer is "yes," type of consolidation _____

If answer is "no," list the owners and tract descriptions which have actually been consolidated. (Use reverse side of this form if necessary.) _____

No allowable will be assigned to the well until all interests have been consolidated (by communitization, unitization, forced-pooling, or otherwise) or until a non-standard unit, eliminating such interests, has been approved by the Commission.

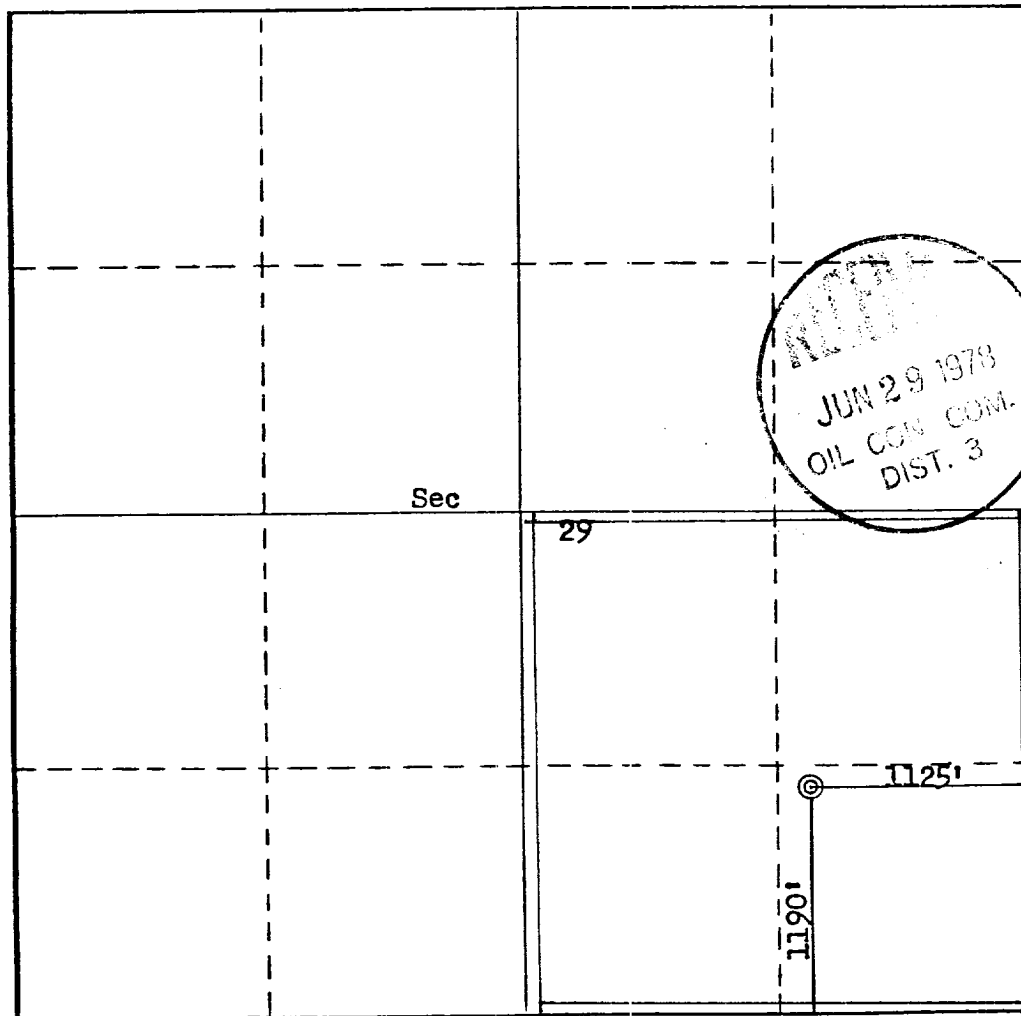

CERTIFICATION

I hereby certify that the information contained herein is true and complete to the best of my knowledge and belief.

FOR: **R&G DRILLING CO.**

Name: **Ewell N. Walsh**

Ewell N. Walsh, P.E.

Position

President

Company

Walsh Engr. & Prod. Corp.

Date

6-27-78

I hereby certify that the well location shown on this plat was plotted from field notes of actual surveys made by me or under my supervision, and that the same is true and correct to the best of my knowledge and belief.

Date Surveyed

August 31, 1977

Registered Professional Engineer and/or Land Surveyor

Fred B. Kerr Jr.

Certificate No.

3950

