

UNITED STATES
DEPARTMENT OF THE INTERIOR
GEOLOGICAL SURVEY

30-045-24360

APPLICATION FOR PERMIT TO DRILL, DEEPEN, OR PLUG BACK

1a. TYPE OF WORK

DRILL ☒DEEPEN ☐PLUG BACK ☐

b. TYPE OF WELL

OIL
WELL ☐GAS
WELL ☒

OTHER

SINGLE
ZONE ☒MULTIPLE
ZONE ☐

2. NAME OF OPERATOR

SUPRON ENERGY CORPORATION

3. ADDRESS OF OPERATOR

P.O. Box 808, Farmington, New Mexico 87401

4. LOCATION OF WELL (Report location clearly and in accordance with any State requirements.*)

At surface

790 ft./South and 790 ft./East line

At proposed prod. zone

Same as above

14. DISTANCE IN MILES AND DIRECTION FROM NEAREST TOWN OR POST OFFICE*

7 miles south of Bloomfield, New Mexico

15. DISTANCE FROM PROPOSED*

LOCATION TO NEAREST
PROPERTY OR LEASE LINE, FT.
(Also to nearest drlg. unit line, if any)

790 ft.

790 ft.

18. DISTANCE FROM PROPOSED LOCATION*
TO NEAREST WELL, DRILLING, COMPLETED,
OR APPLIED FOR, ON THIS LEASE, FT.

3555 ft.

16. NO. OF ACRES IN LEASE

1894.08

19. PROPOSED DEPTH

6445

17. NO. OF ACRES ASSIGNED
TO THIS WELLE 320.00 E₂

20. ROTARY OR CABLE TOOLS

Rotary

21. ELEVATIONS (Show whether DF, RT, GR, etc.)

5783 Gr.

22. APPROX. DATE WORK WILL START*

July 10, 1980

23.

PROPOSED CASING AND CEMENTING PROGRAM

| SIZE OF HOLE | SIZE OF CASING | WEIGHT PER FOOT | SETTING DEPTH | QUANTITY OF CEMENT |
|--------------|----------------|-----------------|---------------|--------------------|
| 12-1/4" | 8-5/8" | 24.00 | 250 ft. | 175 sx |
| 7-7/8" | 4-1/2" | 10.50 | 6445 ft. | 1175 sx |

The surface hole will be drilled to +250 ft. Casing will be run and cemented with the cement being circulated back to the surface. The surface casing will be pressure tested. The well will be drilled to T.D. of approx. 6445 ft. using a starch base mud as the circulating medium. Pipe will be run and cemented in three stages with the estimated cement top to be at approx. 250 ft. The pipe will be pressure tested then the Dakota zone will be perforated and sand water fraced to stimulate production. The well will then be cleaned up, tubing run to the top of the Dakota zone and the wellhead nipped down.

IN ABOVE SPACE DESCRIBE PROPOSED PROGRAM: If proposal is to deepen or plug back, give data on present productive zone and proposed new productive zone. If proposal is to drill or deepen directionally, give pertinent data on subsurface locations and measured and true vertical depths. Give blowout preventer program, if any.

24.

SIGNED

Rudy P. Motto

TITLE Area Superintendent

DATE May 2, 1980

(This space for Federal or State office use)

PERMIT NO.

APPROVAL DATE

APPROVED BY

CONDITIONS OF APPROVAL, IF ANY:

TITLE

NMOCC

APPROVED
AS AMENDED

DATE

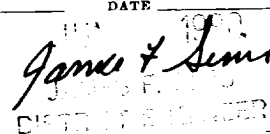
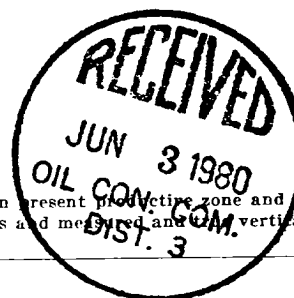
James F. Smith
DISTRICT SUPERVISOR

All distances must be from the outer boundaries of the Section.

| | | | | | |
|--|--------------------------------------|-----------------------------|--------------------------------|--|-------------------------|
| Operator SUPRON ENERGY CORPORATION | | | Lease ANGEL PEAK "B" | | Well No. 26-E |
| Unit Letter P | Section 25 | Township 28 NORTH | Range 11 WEST | County SAN JUAN | |
| Actual Footage Location of Well: 790 feet from the SOUTH line and 790 feet from the EAST line | | | | | |
| Ground Level Elev. 5783 | Producing Formation Dakota | | Pool Basin Dakota | Dedicated Acres Ex 320 Acres | |

1. Outline the acreage dedicated to the subject well by colored pencil or hatchure marks on the plat below.
2. If more than one lease is dedicated to the well, outline each and identify the ownership thereof (both as to working interest and royalty).
3. If more than one lease of different ownership is dedicated to the well, have the interests of all owners been consolidated by communitization, unitization, force-pooling, etc?

☐ Yes ☐ No If answer is "yes," type of consolidation _____

If answer is "no," list the owners and tract descriptions which have actually been consolidated. (Use reverse side of this form if necessary.) _____

No allowable will be assigned to the well until all interests have been consolidated (by communitization, unitization, forced-pooling, or otherwise) or until a non-standard unit, eliminating such interests, has been approved by the Division.

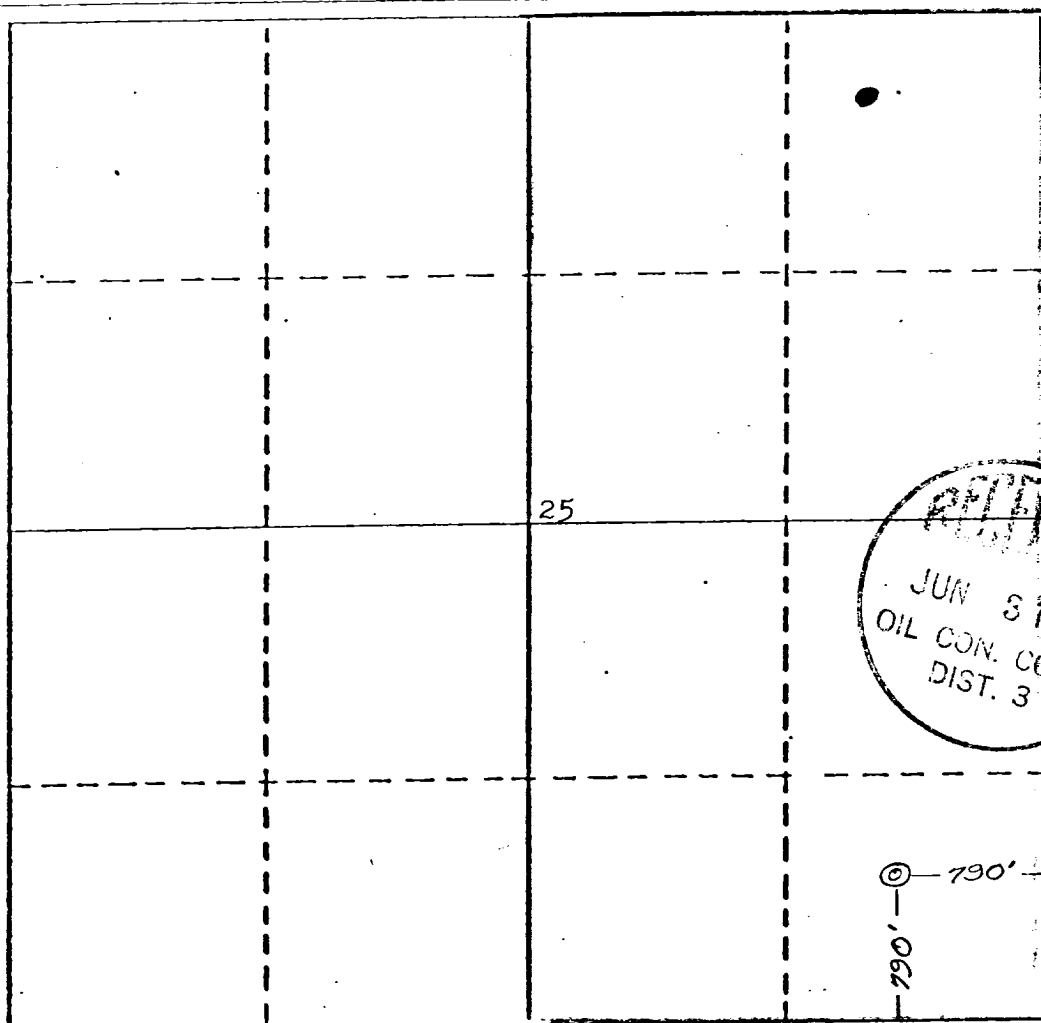

CERTIFICATION

I hereby certify that the information contained herein is true and complete to the best of my knowledge and belief.

Name *Ludy A. Motte*
Position Area Superintendent
Company Supron Energy Corporation
Date March 7, 1980

Hereby certify that the information shown on this plat was plotted from field notes of a survey made by NO. 1463 under my supervision, and that the same is true and correct to the best of my knowledge and belief.

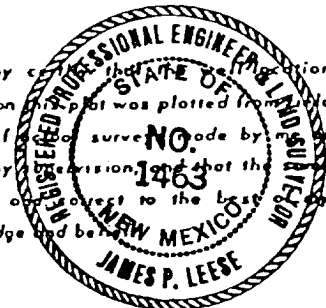

Date Surveyed February 21, 1980
Registered Professional Engineer and/or Land Surveyor
James P. Leese
James P. Leese

Certificate No. 1463

0 330 660 990 1320 1650 1980 2310 2640 2000 1500 1000 500 0

SUPRON ENERGY CORPORATION

The following attachments are included with this application:

- 1. Topographical map showing the proposed location and access road.*
- 2. Planned access road is 1000 ft. long and 20 ft. wide. The road will follow the natural contours of the land and will have drainage facilities installed to meet the requirements of NTL-6. No extra surfacing materials will be used.*
- 3. Map showing existing producing facilities and access roads.*
- 4. Location of surface equipment if required.*
- 5. Drilling and completion water will be obtained from the San Juan River.*
- 6. All pits will be fenced and constructed in such a way as to prevent litter on the location.*
- 7. We will dispose of all waste by placing it in the reserve pit and burying it when the well is completed.*
- 8. There will be no camp at or near the well site.*
- 9. There will be no air strip.*
- 10. A plat is attached showing the location of the rig, mud tanks, reserve pit, burn pit and etc.*
- 11. A letter of certification is attached. The operator representative for compliance purposes is Rudy D. Motto, Area Superintendent, P.O. Box 808, Farmington, New Mexico 87401. Phone (505) 325-3587.*
- 12. After the well is completed, the location will be cleaned up and bladed. The reserve pit will be allowed to dry and then be filled and restored to its natural state.*
- 13. The soil is sandy clay, the principal vegetation is juniper, bitterbrush, galleta, narrow leaf yucca, shadscale, indian ricegrass, prickley pear, and four wing saltbrush.*

Supron Energy Corporation
Angel Peak "B" #26-E
SE $\frac{1}{4}$ Sec. 25, T28N, R11W, N.M.P.M.
San Juan County, New Mexico

LOCATION AND EQUIPMENT LAYOUT

SUPRON ENERGY CORPORATION

Angel Peak "B" No. 26-E

790 feet from the South line and 790 feet from the East line of Section 25, Township 28 North, Range 11 West, N.M.P.M., San Juan County, New Mexico.

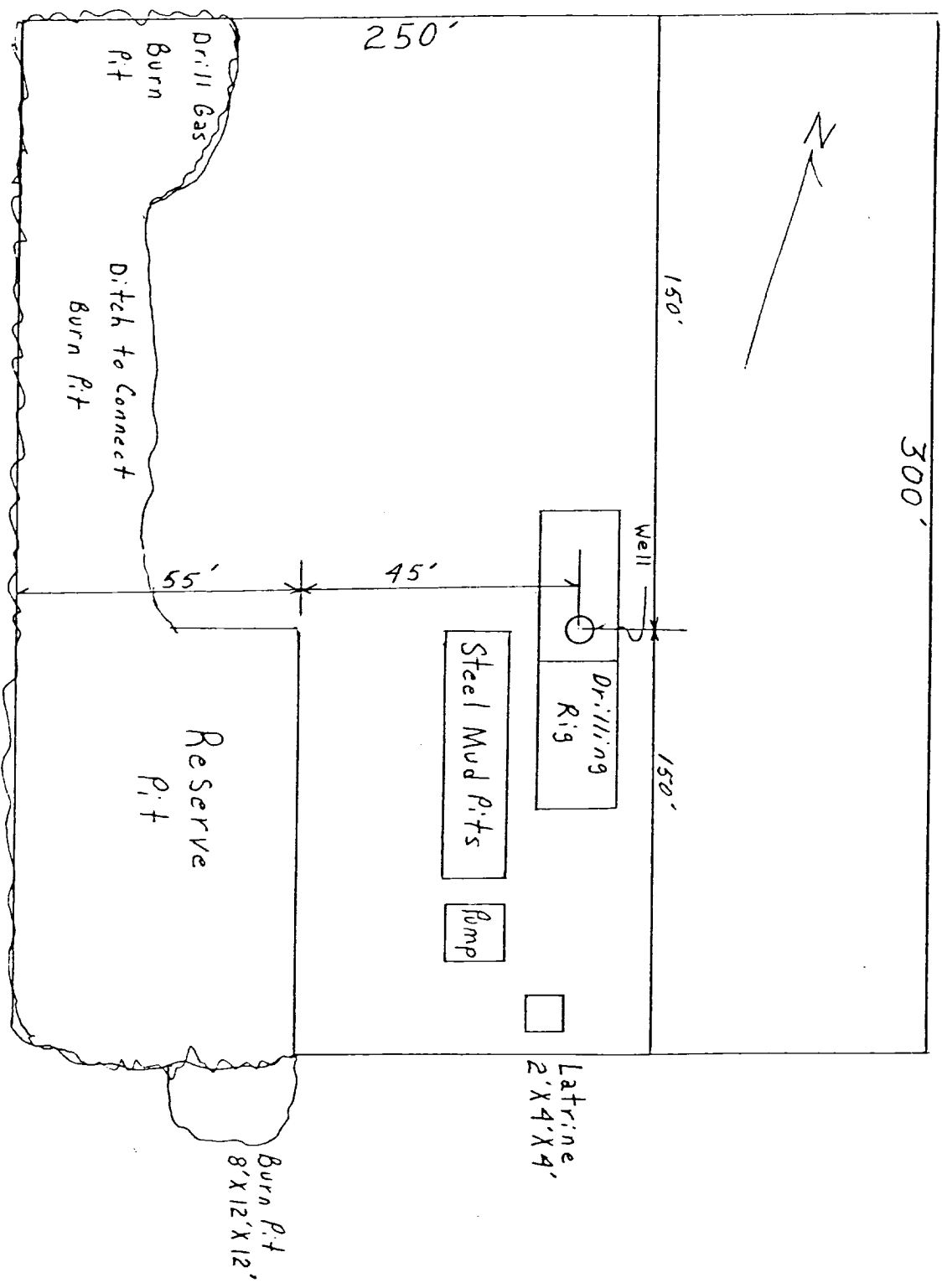

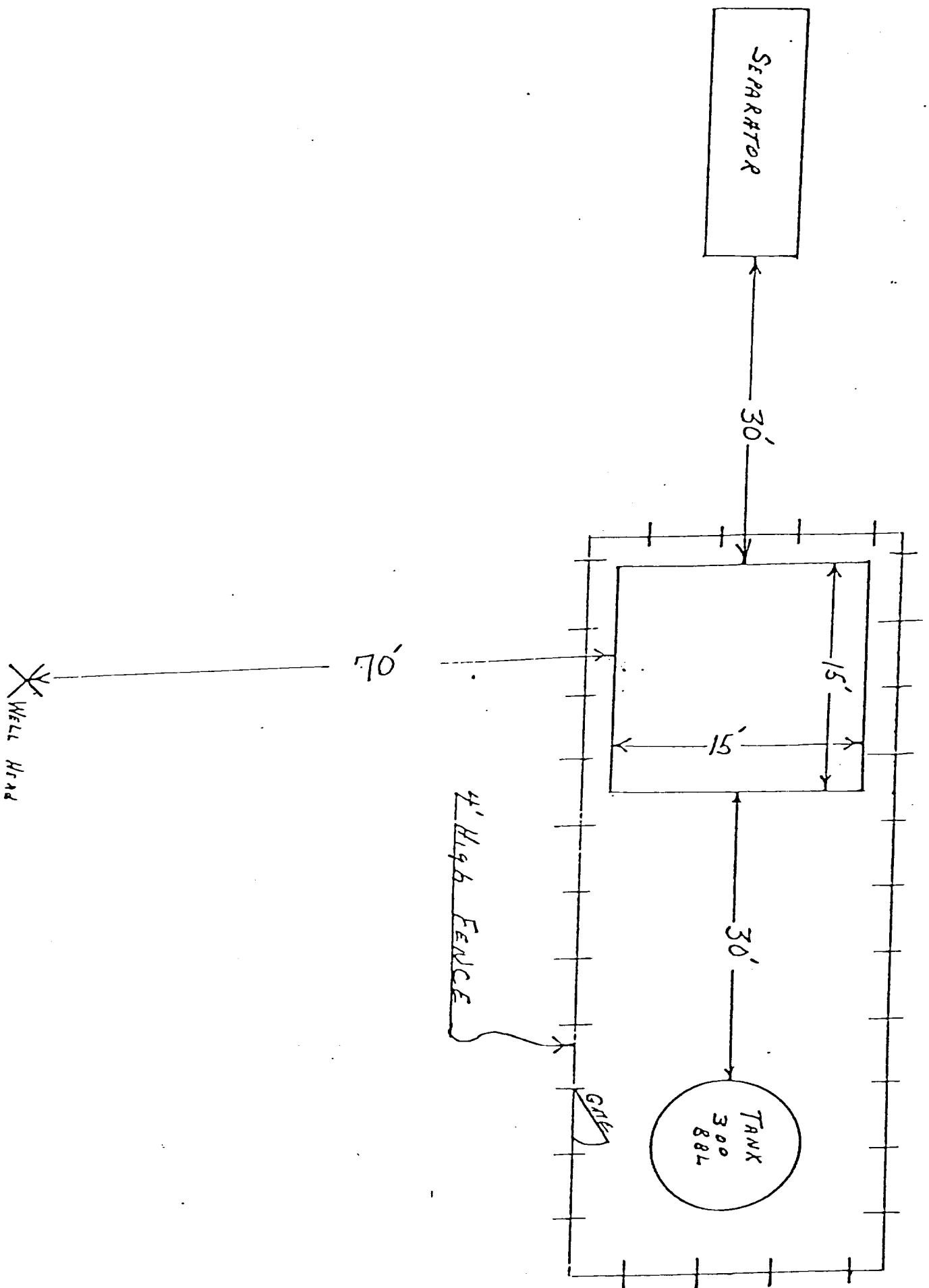

Blowout Preventer will be tested daily and prior to drilling out with the results to be logged on the drillers report.

The B.O.P. and all valve and fittings are rated at 3000 psi working pressure, and hydraulically operated

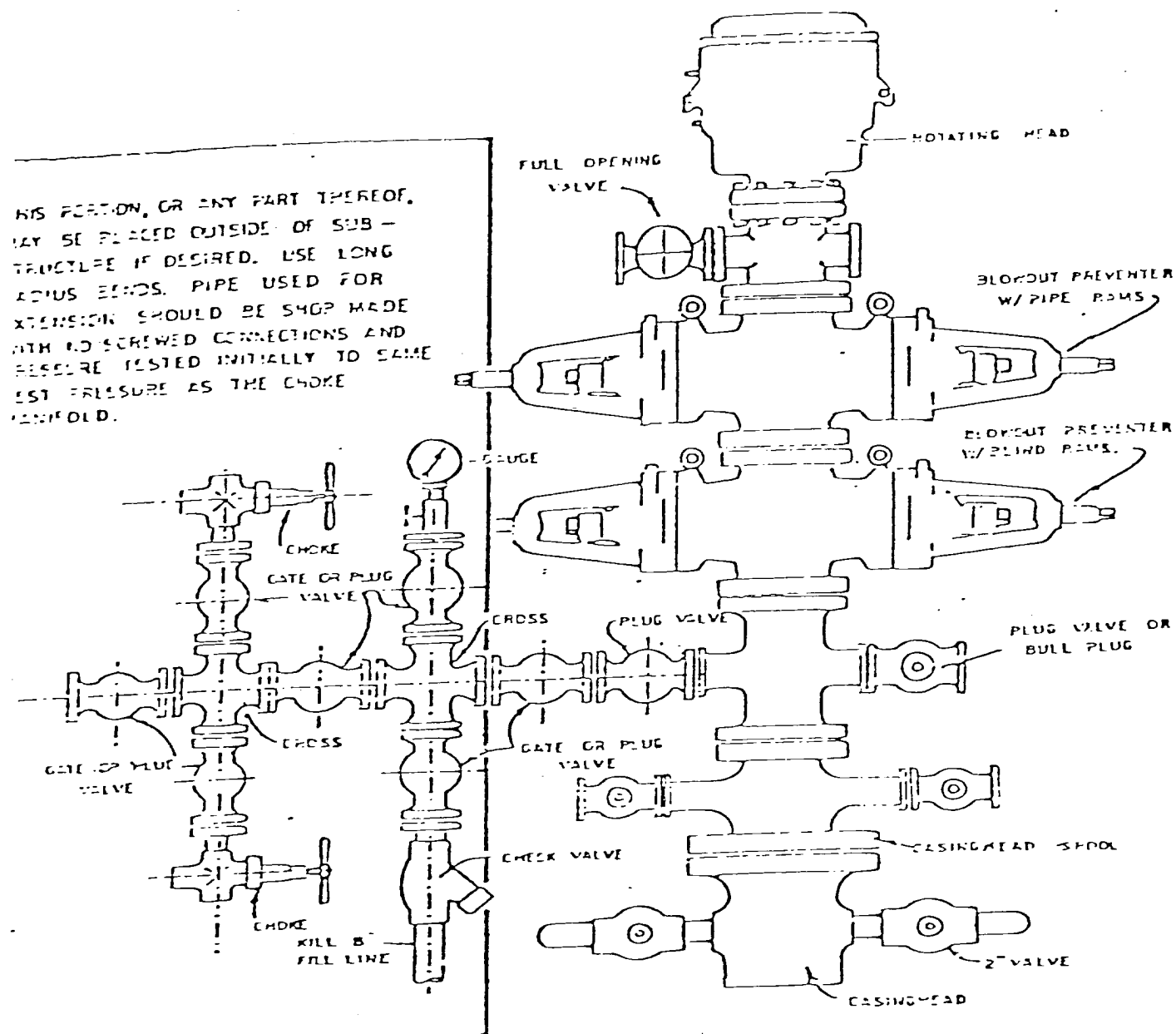

BLOWOUT PREVENTER HOOKUP

SUPRON ENERGY CORPORATION
Post Office Box 808
FARMINGTON, NEW MEXICO 87401

I hereby certify that I, or persons under my direct supervision, have inspected the proposed drillsite and access route; that I am familiar with the conditions which presently exist; that the statements made in this plan are, to the best of my knowledge, true and correct; and, that the work associated with the operations proposed herein will be performed by SUPRON ENERGY CORPORATION and its contractors subcontractors in conformity with this plan and the terms and conditions under which it is approved.

SUPRON ENERGY CORPORATION

A handwritten signature in cursive script, reading "Rudy D. Motto".

Rudy D. Motto
Area Superintendent
Phone: 325-3587

SUPRON ENERGY CORPORATION

Angel Peak "B" No. 26-E
SE ¼ Sec. 25, T-28N, R-11W, N.M.P.M.
San Juan County, New Mexico

1. The Geologic name of the surface formation is, "Wasatch".
2. The estimated tops of important Geologic markers are:
 - A. Base of the Ojo Alamo 775 ft.
 - B. Kirtland 775 ft.
 - C. Fruitland 1430 ft.
 - D. Pictured Cliffs 1729 ft.
 - E. Chacra 2259 ft.
 - F. Cliff House 3249 ft.
 - G. Point Lookout 4073 ft..
 - H. Gallup 5280 ft.
 - I. Greenhorn 6080 ft.
 - J. Dakota 6164 ft.
3. The estimated depths at which anticipated water, oil or other mineral bearing formations are expected to be encountered are:
 - A. Ojo Alamo 775 ft. Water
 - B. Kirtland 775 ft. Water
 - C. Fruitland 1430 ft. Water
 - D. Pictured Cliffs 1729 ft. Gas
 - E. Chacra 2259 ft. Gas
 - F. Cliff House 3249 ft. Water
 - G. Point Lookout 4073 ft. Water
 - H. Gallup 5280 ft. Dry
 - I. Greenhorn 6080 ft. Shale
 - J. Dakota 6164 ft. Gas
4. The casing program is shown on form 9-331C and all casing is new.
5. The lessee's pressure control equipment schematics are attached, along with minimum specifications, testing procedures, and frequencies.
6. The type, estimated volumes, and characteristics of the circulating medium are as follows:
 - A. 0 - 250 ft. Natural Mud
 - B. 250 - 6445 ft. Permaloid non dispersed mud containing approx. 180 sx gel, 70 sx of permaloid and 20 sx of CMC.
7. The auxiliary equipment to be used will be floats at the bit and a sub on the floor with a full opening valve to be stabbed into the drill pipe when the kelly is not in the string.
8. The well is in an area which is partially developed; therefore we will not have a testing and coring program. The logging program is as follows:
 - A. E.S. Induction
 - B. Gamma Ray Density
 - C. Gamma Ray Correlation
 - D. Cement Bond Log
9. We do not expect to find any abnormal pressures, temperatures or hydrogen sulfide problems in this partially developed area.
10. The anticipated starting date for this well is July 10, 1980.