

UNITED STATES
DEPARTMENT OF THE INTERIOR
GEOLOGICAL SURVEY

30-045-25020

APPLICATION FOR PERMIT TO DRILL, DEEPEN, OR PLUG BACK

1a. TYPE OF WORK

DRILL ☒DEEPEN ☐PLUG BACK ☐

b. TYPE OF WELL

OIL
WELL ☐GAS
WELL ☒

OTHER

SINGLE
ZONE ☒MULTIPLE
ZONE ☐

2. NAME OF OPERATOR

Supron Energy Corporation

3. ADDRESS OF OPERATOR

P.O. Box 808, Farmington, New Mexico 87401

4. LOCATION OF WELL (Report location clearly and in accordance with any State requirements.)

At surface 790 Ft./South; 790 Ft./East line

At proposed prod. zone Same as above

14. DISTANCE IN MILES AND DIRECTION FROM NEAREST TOWN OR POST OFFICE*

6-1/2 Miles Southwest of Farmington, New Mexico

15. DISTANCE FROM PROPOSED*

790 Ft.

16. NO. OF ACRES IN LEASE

160.00

17. NO. OF ACRES ASSIGNED

E/2 320.00

18. DISTANCE FROM PROPOSED LOCATION*

TO NEAREST WELL, DRILLING, COMPLETED,
OR APPLIED FOR, ON THIS LEASE, FT. 200 Ft..

19. PROPOSED DEPTH

6400

20. ROTARY OR TABLE TOOLS

Rotary

21. ELEVATIONS (Show whether DF, RT, GR, etc.)

6018 GR.

22. APPROX. DATE WORK WILL START*

June 1, 1981

23.

PROPOSED CASING AND CEMENTING PROGRAM

SIZE OF HOLE	SIZE OF CASING	WEIGHT PER FOOT	SETTING DEPTH	QUANTITY OF CEMENT
12-1/4"	8-5/8"	24.00	400 Ft.	220 Sx. Circulated - Cover Alamo
7-7/8"	4-1/2"	10.50	6400 Ft.	950 Sx.

We desire to drill 12-1/4" surface hole to approx. 400 ft. with natural mud and run new 8-5/8", 24.00# surface pipe. Cement with approx. 220 sx. of cement to cover the Ojo Alamo zone and circulate back to the surface pressure test the casing. Drill 7-7/8" hole with starch base mud to approx. 6400 ft. and log the well. Run new 4-1/2", 10.50# casing with a D.V. tool at approx. 4350 ft. Cement the 1st stage with approx. 350 sx of 50-50 poz. Cement 2nd stage with approx. 500 sx. of 65-35 poz followed by 100 sx of 50-50 poz. Pressure test the casing. Perforate and fracture the Dakota zone. Clean the well up. Run tubing to the Dakota zone. Nipple down the wellhead. Test and connect to a gathering system.

The gas from this well has previously been dedicated to a transporter.

IN ABOVE SPACE DESCRIBE PROPOSED PROGRAM: If proposal is to deepen or plug back, give data on present productive zone and proposed new productive zone. If proposal is to drill or deepen directionally, give pertinent data on subsurface locations and measured and true vertical depths. Give blowout preventer program, if any.

24.

SIGNED

Rudy D. Motto

TITLE Area Superintendent

DATE April 10, 1981

(This space for Federal or State office use)

PERMIT NO.

APPROVAL DATE

APPROVED BY

TITLE

CONDITIONS OF APPROVAL, IF ANY:

APPROVED
AS AMENDEDAPR 27 1981
James F. Sims
DISTRICT ENGINEER

NMOCC

**NEW MEXICO OIL CONSERVATION COMMISSION
WELL LOCATION AND ACREAGE DEDICATION PLAT**

Form C-102
Supersedes C-128
Effective 1-1-65

All distances must be from the outer boundaries of the Section.

Operator SUPRON ENERGY CORPORATION			Lease C.J. HOLDER GAS COM		Well No. 17
Unit Letter P	Section 21	Township 28 NORTH	Range 13 WEST	County SAN JUAN	
Actual Footage Location of Well: <div style="display: flex; justify-content: space-between;"> 790 feet from the SOUTH line and 790 feet from the EAST line </div>					
Ground Level Elev. 6018	Producing Formation DAKOTA	Pool BASIN		Dedicated Acreage: E/2 320.00 Acres	

1. Outline the acreage dedicated to the subject well by colored pencil or hatchure marks on the plat below.
2. If more than one lease is dedicated to the well, outline each and identify the ownership thereof (both as to working interest and royalty).
3. If more than one lease of different ownership is dedicated to the well, have the interests of all owners been consolidated by communitization, unitization, force-pooling, etc?

☐ Yes ☐ No If answer is "yes," type of consolidation _____

If answer is "no," list the owners and tract descriptions which have actually been consolidated. (Use reverse side of this form if necessary.) _____

No allowable will be assigned to the well until all interests have been consolidated (by communitization, unitization, forced-pooling, or otherwise) or until a non-standard unit, eliminating such interests, has been approved by the Commission.

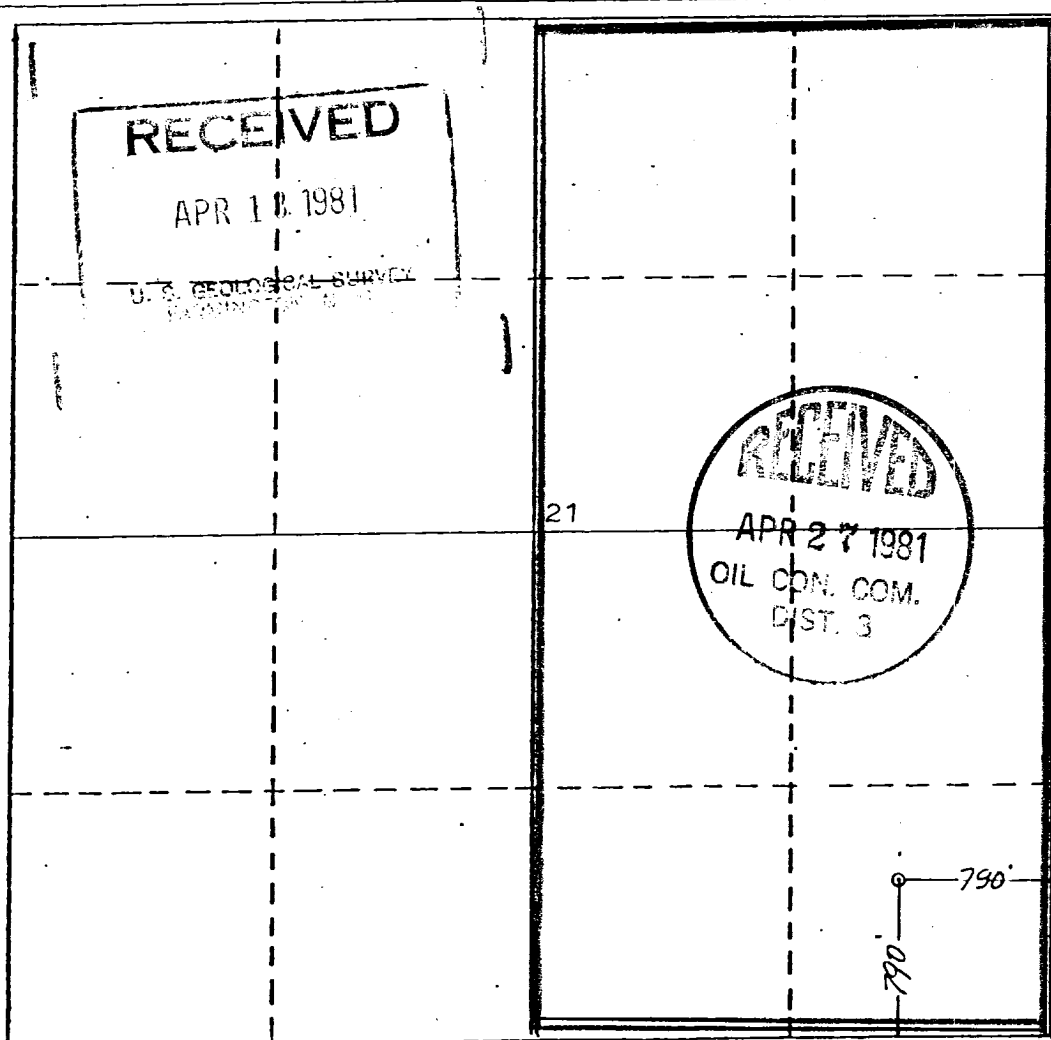

CERTIFICATION

I hereby certify that the information contained herein is true and complete to the best of my knowledge and belief.

Rudy D. Motto
Name

Rudy D. Motto

Position

Area Superintendent

Company

SUPRON ENERGY CORPORATION

Date

October 24, 1980

I hereby certify that the well location shown on this plat was plotted from field notes of actual surveys made by me or under my supervision, and that the same is true and correct to the best of my knowledge and belief.

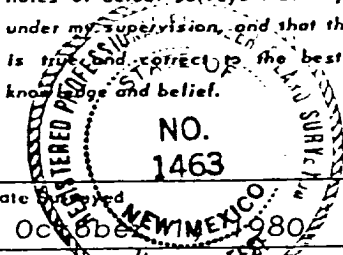

Date Surveyed

October 24, 1980

Registered Professional Engineer and/or Land Surveyor

James P. Lease
James P. Lease

Certificate No.

1463

0 330 660 990 1320 1650 1980 2310 2640 2000 1500 1000 500 0

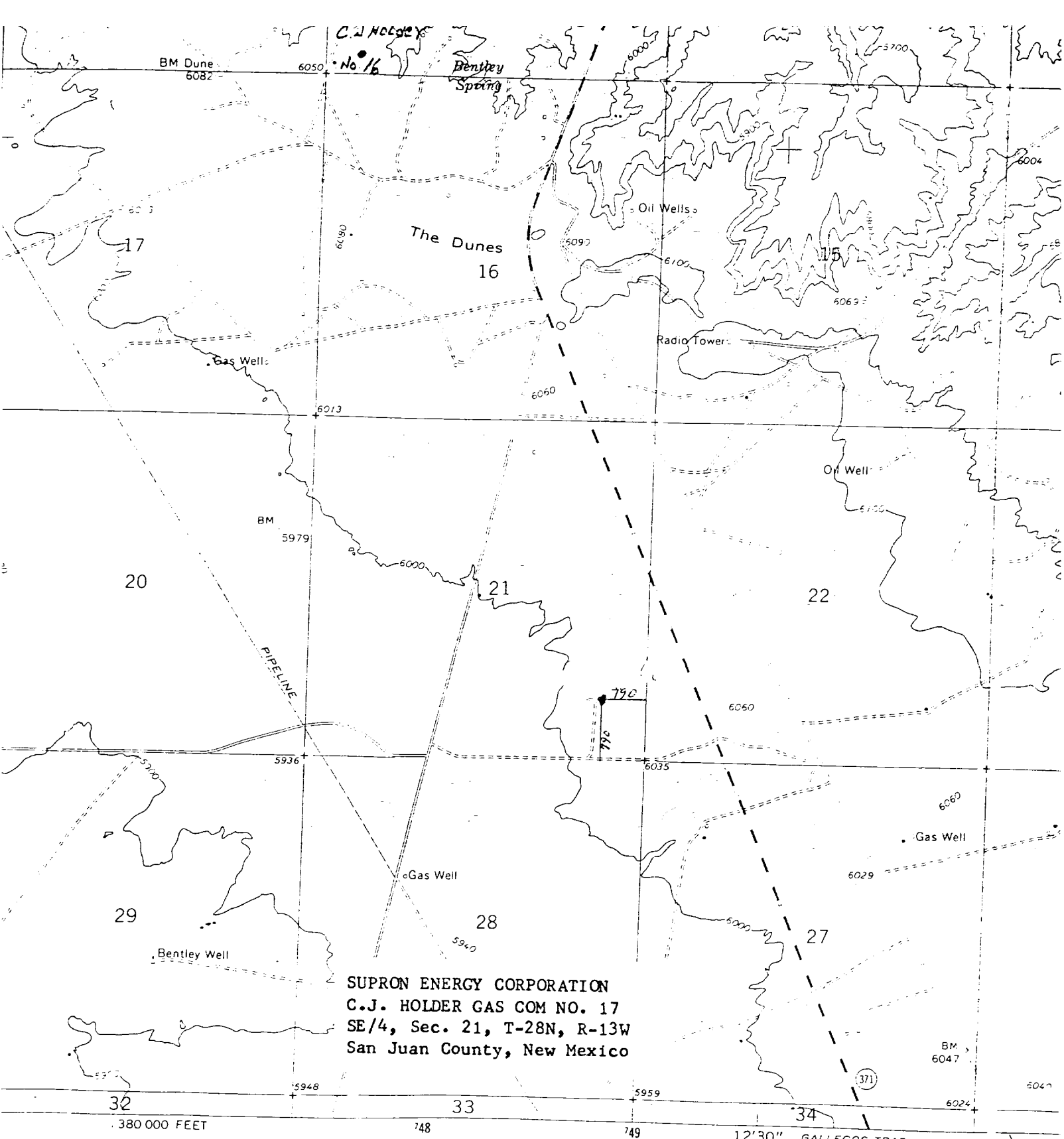

ed. edited, and published by the Geological Survey
 ol by USGS, USC&GS, and U. S. Bureau of Reclamation
 raphy by photogrammetric methods from aerial
 raphs taken 1964 and by planetable surveys of the
 u of Reclamation 1965. Field checked by USGS 1965
 onic projection. 1927 North American datum
 0 foot grid based on New Mexico coordinate system,
 from
 on the Universal Transverse Mercator grid ticks.
 1/2 inch shown in blue
 nt indicates areas in which only landmark buildings are shown
 ed dashed lines indicate selected fence lines

UTM GRID AND 1965 MAGNETIC NORTH
 DECLINATION AT CENTER OF SHEET
 1°41' 14" / 249 MILS
 30 MILS.

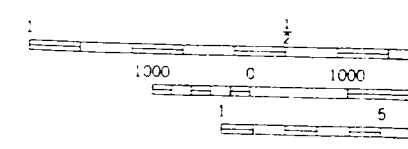

CON
 DOTTED LIN
 D

THIS MAP COMPLIES