

30-045-25364

UNITED STATES
DEPARTMENT OF THE INTERIOR
GEOLOGICAL SURVEY

APPLICATION FOR PERMIT TO DRILL, DEEPEN, OR PLUG BACK

1a. TYPE OF WORK
DRILL DEEPEN PLUG BACK

b. TYPE OF WELL
OIL WELL GAS WELL OTHER
SINGLE ZONE MULTIPLE ZONE

2. NAME OF OPERATOR
Southland Royalty Company

3. ADDRESS OF OPERATOR
P.O. Drawer 570, Farmington, New Mexico 87499-0570

4. LOCATION OF WELL (Report location clearly and in accordance with any State requirements.)*
At surface 1100' FNL & 1800' FEL
At proposed prod. zone

14. DISTANCE IN MILES AND DIRECTION FROM NEAREST TOWN OR POST OFFICE*
10 Miles Southeast of Bloomfield, New Mexico

15. DISTANCE FROM PROPOSED* LOCATION TO NEAREST PROPERTY OR LEASE LINE, FT. (Also to nearest drig. unit line, if any) 1100'

16. NO. OF ACRES IN LEASE 320.00

18. DISTANCE FROM PROPOSED LOCATION* TO NEAREST WELL, DRILLING, COMPLETED, OR APPLIED FOR, ON THIS LEASE, FT. 700'

19. PROPOSED DEPTH 2950'

17. NO. OF ACRES ASSIGNED TO THIS WELL 160 / 160

20. ROTARY OR CABLE TOOLS Rotary

21. ELEVATIONS (Show whether DF, RT, GR, etc.) 5767' GL

22. APPROX. DATE WORK WILL START* April 1, 1982

23. PROPOSED CASING AND CEMENTING PROGRAM

SIZE OF HOLE	SIZE OF CASING	WEIGHT PER FOOT	SETTING DEPTH	QUANTITY OF CEMENT
12-1/4"	9-5/8"	32.30#	200'	130 cu. ft. (Circulate to surface)
8-3/4"	2-7/8"	6.5 #	1650'	Both Strings: 969 cu. ft. (Case Ojo Alamo)
6-3/4"	2-7/8"	6.5 #	2950'	

Surface formation is Nacimiento.
Top of Ojo Alamo sand is at 489'.
Top of Pictured Cliffs sand is at 1679'.
Fresh water mud will be used to drill from surface to Total Depth.
It is anticipated that an IEL be run from Total Depth to surface casing and GR-CNL/FDC be run from total depth to 1000'.
No abnormal pressures or poisonous gases are anticipated in this well.
It is expected that this well will be drilled before June 1, 1982.
This depends on time required for approvals, rig availability and the weather.
Gas is dedicated.

IN ABOVE SPACE DESCRIBE PROPOSED PROGRAM: If proposal is to deepen or plug back, give data on present productive zone and proposed new productive zone. If proposal is to drill or deepen directionally, give pertinent data on subsurface locations and measured and true vertical depths. Give blowout preventer program, if any.

24. SIGNED R. E. Fielder

TITLE District Engineer

(This space for Federal or State office use)

PERMIT NO. _____

APPROVED BY _____
CONDITIONS OF APPROVAL, IF ANY:

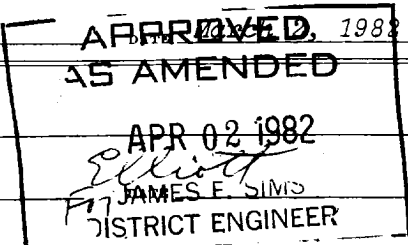
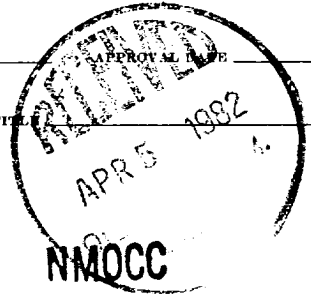

DRILLING OPERATIONS AUTHORIZED ARE SUBJECT TO COMPLIANCE WITH ATTACHED "GENERAL REQUIREMENTS"

This action is subject to administrative appeal pursuant to 30 CFR 290.

OIL CONSERVATION DIVISION

STATE OF NEW MEXICO
ENERGY AND MINERALS DEPARTMENT

P. O. BOX 2088
SANTA FE, NEW MEXICO 87501

Form C-107
Revised 10-1-78

All distances must be from the outer boundaries of the Section.

Operator SOUTHLAND ROYALTY COMPANY		Lease HUGHES		Well No. 3
Unit Letter B	Section 23	Township 28N	Range 11W	County San Juan
Actual Footage Location of Well: 1100 feet from the North line and 1800 feet from the East line				
Ground Level Elev. 5767	Producing Formation Chacra/Fruitland	Pool Undes Bloomfield/Kutz	Dedicated Acreage: 160 Acres	

1. Outline the acreage dedicated to the subject well by colored pencil or hachure marks on the plat below.
2. If more than one lease is dedicated to the well, outline each and identify the ownership thereof (both as to working interest and royalty).
3. If more than one lease of different ownership is dedicated to the well, have the interests of all owners been consolidated by communitization, unitization, force-pooling, etc.?

Yes No If answer is "yes," type of consolidation _____

If answer is "no," list the owners and tract descriptions which have actually been consolidated. (Use reverse side of this form if necessary.) _____

No allowable will be assigned to the well until all interests have been consolidated (by communitization, unitization, forced-pooling, or otherwise) or until a non-standard unit, eliminating such interests, has been approved by the Commission.

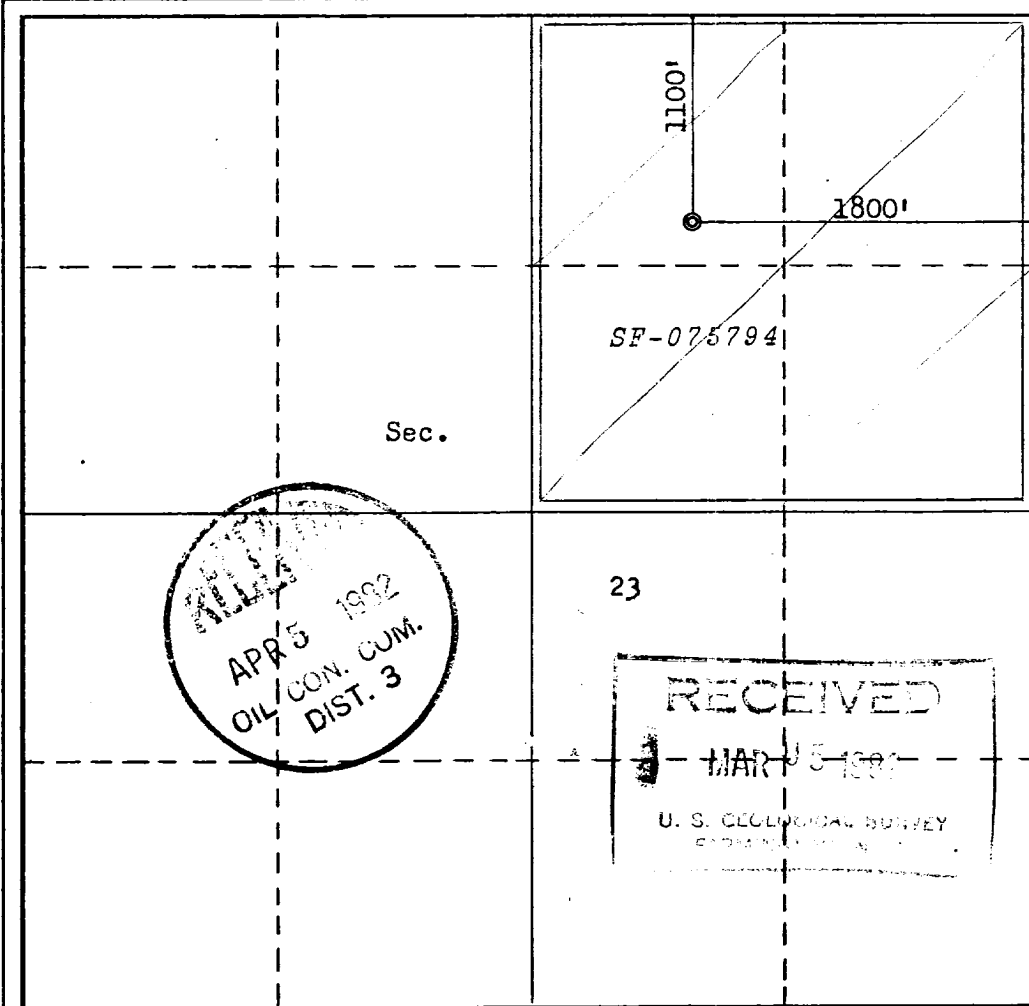

CERTIFICATION

I hereby certify that the information contained herein is true and complete to the best of my knowledge and belief.

R. E. Fielder

Name
R. E. Fielder

Position
District Engineer

Company
Southland Royalty Company

Date
March 2, 1982

I hereby certify that the well location shown on this plat was plotted from field notes of actual surveys made by me or under my supervision, and that the same is true and correct to the best of my knowledge and belief.

Date Surveyed
January 30 1982

Registered Professional Engineer and/or Land Surveyor
Fred B. Kerr Jr.
Fred B. Kerr Jr.

Certificate No.
3950

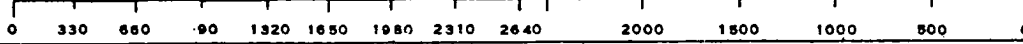

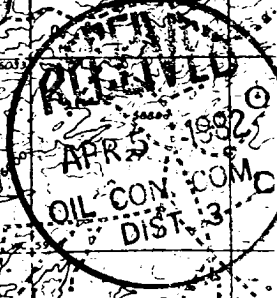
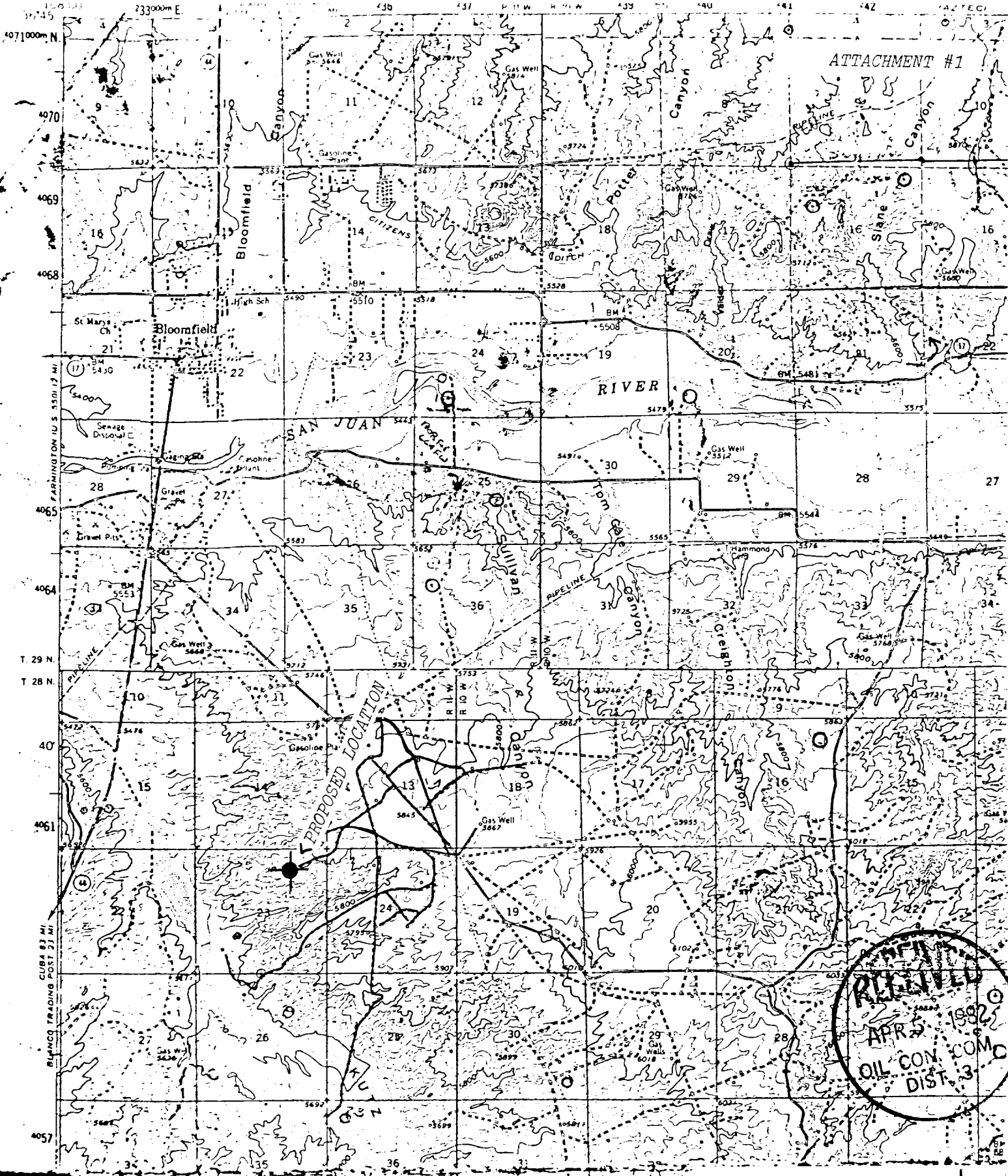

Vicinity Map for
 SOUTHLAND ROYALTY COMPANY #3 HUGHES
 1100'FNL 1800'FEL Sec. 23-T28N-R11
 SAN JUAN COUNTY, NEW MEXICO

PROPOSED LOCATION
 EXISTING LOCATIONS
 EXISTING ROADS



T 28 N
 T 27 N

4055