

N API 30-045-22556 5-16-77

F. Loc. 1850/S; 1850/W Elev. 5623 GL Spd. Comp. TD PB

Casing S. S W Sx. Int. S W Sx. Pr. S W Sx. T. S  
Csg. Perf. Prod. Stim.

TRANS

I.P. BO/D MCF/D After Hrs. SICP PSI After Days GOR Grav. 1st Del. S

TOPS		NITD	X	Well Log	TEST DATA								
Kirtland		C-103		Plat	X	Schd.	PC	Q	PW	PD	D	Ref. No.	
Fruitland		C-104		Electric Log									
Pictured Cliffs				C-122									
Cliff House		Ditr		Dfa									
Menefee		Datr		Dac									
Point Lookout		160											
Mancos													
Gallup													
Sanostee													
Greenhorn													
Dakota													
Morrison													
Entrada													

P  
O  
O  
1. OJO Ft-PC Co. SJ S 35 T 28N R 15W U K Oper. Dugan Production Corp Lse. Pet. Inc No. 16

**UNITED STATES  
DEPARTMENT OF THE INTERIOR  
GEOLOGICAL SURVEY**

**SUBMIT IN TRIPLICATE\***  
(Other instructions on  
reverse side)

Form approved.  
Budget Bureau No. 42-R1425.

30-045-22556

**APPLICATION FOR PERMIT TO DRILL, DEEPEN, OR PLUG BACK**

## 1a. TYPE OF WORK

DRILL ☒DEEPEN ☐PLUG BACK ☐

## b. TYPE OF WELL

OIL  
WELL ☐GAS  
WELL ☒

OTHER

SINGLE  
ZONE ☐MULTIPLE  
ZONE ☐

## 2. NAME OF OPERATOR

Dugan Production Corp.

## 3. ADDRESS OF OPERATOR

Box 234, Farmington, NM 87401

## 4. LOCATION OF WELL (Report location clearly and in accordance with any State requirements.)\*

At surface

1850' FSL - 1850' FWL

At proposed prod. zone

## 14. DISTANCE IN MILES AND DIRECTION FROM NEAREST TOWN OR POST OFFICE\*

9 miles south of Fruitland, New Mexico

## 15. DISTANCE FROM PROPOSED\*

LOCATION TO NEAREST  
PROPERTY OR LEASE LINE, FT.  
(Also to nearest drlg. unit line, if any)

1850'

## 16. NO. OF ACRES IN LEASE

2480

17. NO. OF ACRES ASSIGNED  
TO THIS WELL

160

## 18. DISTANCE FROM PROPOSED LOCATION\*

TO NEAREST WELL, DRILLING, COMPLETED,  
OR APPLIED FOR, ON THIS LEASE, FT.

2640'

## 19. PROPOSED DEPTH

550'

## 20. ROTARY OR CABLE TOOLS

Rotary

## 21. ELEVATIONS (Show whether DF, RT, GR, etc.)

5623' GR

## 22. APPROX. DATE WORK WILL START\*

6-2-77

## 23. PROPOSED CASING AND CEMENTING PROGRAM

SIZE OF HOLE	SIZE OF CASING	WEIGHT PER FOOT	SETTING DEPTH	QUANTITY OF CEMENT
8-3/4"	7"	20#	30'	5 SX
6-1/4"	3-1/2"	7.7#	550'	20 SX

Drill well with air using slim hole technique to test the Pictured Cliffs formation, cement above formation packer shoe, clean out and run 1-1/4" tubing, and complete well.

MAY 13 1977

IN ABOVE SPACE DESCRIBE PROPOSED PROGRAM: If proposal is to deepen or plug back, give data on present productive zone and proposed new productive zone. If proposal is to drill or deepen directionally, give pertinent data on subsurface locations and measured and true vertical depths. Give blowout preventer program, if any.

24.

SIGNED

Jim L. Jacobs

TITLE

Geologist

DATE

5-11-77

(This space for Federal or State office use)

PERMIT NO.

APPROVAL DATE

APPROVED BY

TITLE

DATE

CONDITIONS OF APPROVAL, IF ANY:

NEW MEXICO OIL CONSERVATION COMMISSION  
WELL LOCATION AND ACREAGE DEDICATION PLAT

Form C-102  
Supersedes C-128  
Effective 1-1-65

All distances must be from the outer boundaries of the Section.

Operator <b>Dugan Production Corporation</b>			Lease <b>Pet Inc</b>		Well No. <b>16</b>
Unit Letter <b>K</b>	Section <b>35</b>	Township <b>28 North</b>	Range <b>15 West</b>	County <b>San Juan</b>	
Actual Footage Location of Well: <b>1850'</b> feet from the <b>South</b> line and <b>1850</b> feet from the <b>West</b> line					
Ground Level Elev. <b>5623</b>	Producing Formation <b>Pictured Cliffs</b>	Pool <b>Ojo Pictured Cliffs ext</b>	Dedicated Acreage: <b>160</b> Acres		

- Outline the acreage dedicated to the subject well by colored pencil or hachure marks on the plat below.
- If more than one lease is dedicated to the well, outline each and identify the ownership thereof (both as to working interest and royalty).
- If more than one lease of different ownership is dedicated to the well, have the interests of all owners been consolidated by communitization, unitization, force-pooling, etc?

☐ Yes ☐ No If answer is "yes," type of consolidation \_\_\_\_\_

If answer is "no," list the owners and tract descriptions which have actually been consolidated. (Use reverse side of this form if necessary.) \_\_\_\_\_

No allowable will be assigned to the well until all interests have been consolidated (by communitization, unitization, forced-pooling, or otherwise) or until a non-standard unit, eliminating such interests, has been approved by the Commission.

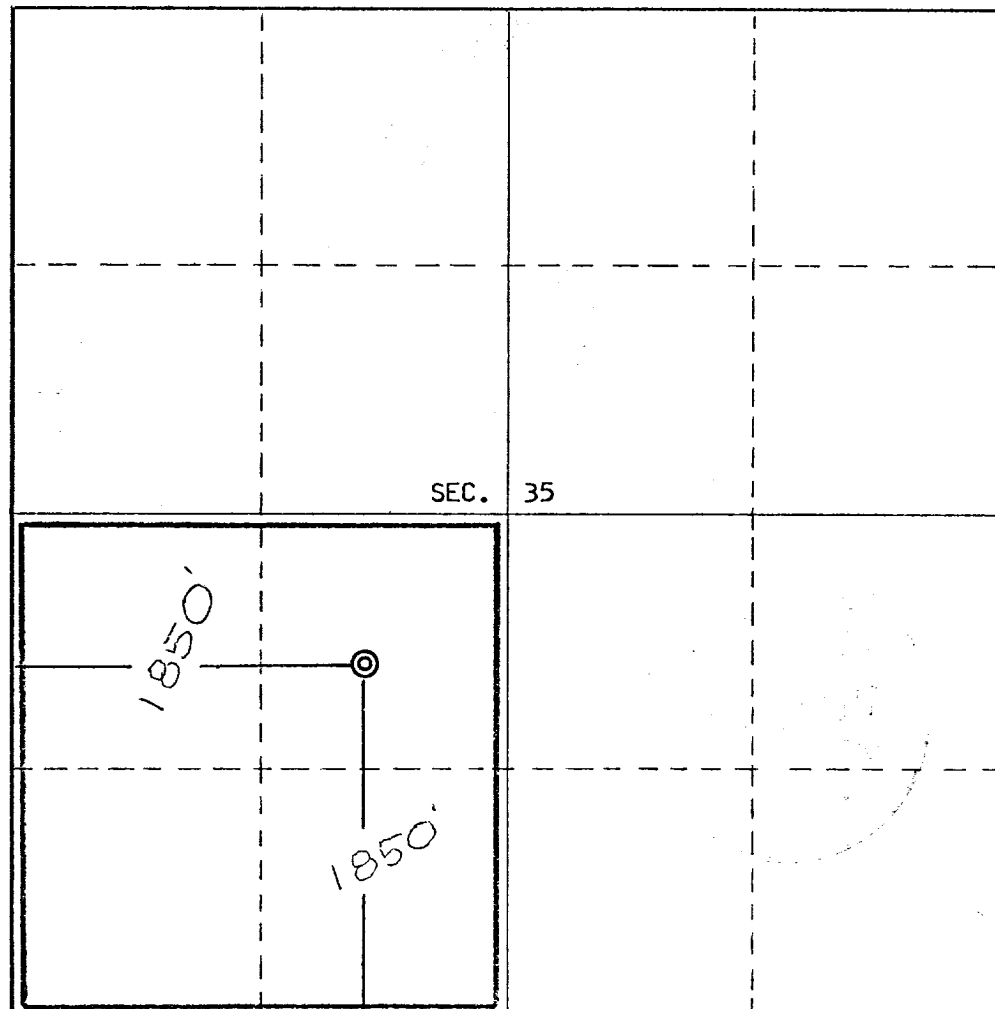

CERTIFICATION

I hereby certify that the information contained herein is true and complete to the best of my knowledge and belief.

*Jim L. Jacobs*

Name  
**Jim L. Jacobs**

Position  
**Geologist**

Company  
**Dugan Production Corp.**

Date  
**5-11-77**

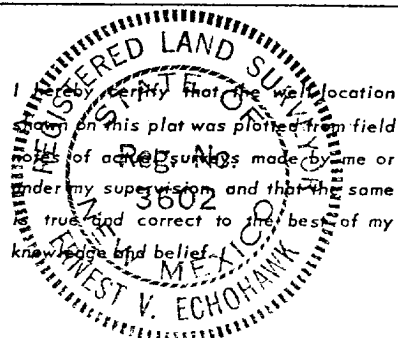

Date Surveyed  
**April 16, 1977**

Registered Professional Engineer  
and/or Land Surveyor

*E. V. Echohawk*

Certificate No. **3602**  
**E.V. Echohawk LS**

0 330 660 90 1320 1650 1980 2310 2640 2000 1500 1000 500 0