

UNITED STATES  
DEPARTMENT OF THE INTERIOR  
GEOLOGICAL SURVEY

## APPLICATION FOR PERMIT TO DRILL, DEEPEN, OR PLUG BACK

|   |  |  |  |
|---|--|--|--|
| 1a. TYPE OF WORK<br>DRILL <input checked="" type="checkbox"/> DEEPEN <input type="checkbox"/> PLUG BACK <input type="checkbox"/>  |  | 5. LEASE DESIGNATION AND SERIAL NO.<br>NM20499   |  |
| b. TYPE OF WELL<br>OIL WELL <input type="checkbox"/> GAS WELL <input checked="" type="checkbox"/> OTHER <input type="checkbox"/> SINGLE ZONE <input checked="" type="checkbox"/> MULTIPLE ZONE <input type="checkbox"/> |  | 6. IF INDIAN, ALLOTTEE OR TRIBE NAME   |  |
| 2. NAME OF OPERATOR<br>Marathon Oil Company 14021   |  | 7. UNIT AGREEMENT NAME   |  |
| 3. ADDRESS OF OPERATOR<br>P. O. Box 552, Midland, TX 79702  |  | 8. FARM OR LEASE NAME<br>Ohio Government 16040 "22"  |  |
| 4. LOCATION OF WELL (Report location clearly and in accordance with any State requirements.)<br>At surface 2725 1560<br>1785' FNL & 1895' FEL<br>At proposed prod. zone<br>1785' FNL & 1895' FEL                        |  | 9. WELL NO.<br>1   |  |
| 14. DISTANCE IN MILES AND DIRECTION FROM NEAREST TOWN OR POST OFFICE*<br>5 miles south of Bloomfield, NM  |  | 10. FIELD AND POOL, OR WILDCAT<br>Basin Fruitland Coal   |  |
| 15. DISTANCE FROM PROPOSED* LOCATION TO NEAREST PROPERTY OR LEASE LINE, FT. (Also to nearest drlg. unit line, if any) 1785'   |  | 11. SEC., T., R., M., OR BLK. AND SURVEY OR AREA<br>G<br>Sec. 22, T-28-N, R-11-W   |  |
| 16. NO. OF ACRES IN LEASE<br>320 240  |  | 12. COUNTY OR PARISH<br>San Juan   |  |
| 17. NO. OF ACRES ASSIGNED TO THIS WELL<br>320   |  | 13. STATE<br>NM  |  |
| 18. DISTANCE FROM PROPOSED LOCATION* TO NEAREST WELL, DRILLING, COMPLETED, OR APPLIED FOR, ON THIS LEASE, FT. *   |  | 19. PROPOSED DEPTH<br>1575'  |  |
| 20. ROTARY OR CABLE TOOLS<br>Rotary   |  | 21. APPROX. DATE WORK WILL START*<br>July 1, 1990  |  |
| 22. ELEVATIONS (Show whether DF, RT, GR, etc.)<br>5564' GL 6611' GL   |  | 23. DRILLING OPERATIONS AUTHORIZED ARE SUBJECT TO COMPLIANCE WITH ATTACHED "GENERAL REQUIREMENTS".<br>175 sx - circulate to surface<br>260 sx - circulate to surface |  |

Propose to drill to a TD of  $\pm 1575'$ .

All casing will be run and cemented in accordance with regulations and by approved methods.

Blowout prevention equipment will be applied as outlined in Additional Information.

See attached Multipoint Surface Use Plan and Additional Information for specific drilling operations.

\* First Fruitland Coal well on this lease

RECEIVED  
SEP 24 1990

OIL CON. DIV.

DIST. 3

IN ABOVE SPACE DESCRIBE PROPOSED PROGRAM: If proposal is to deepen or plug back, give present productive zone and proposed new productive zone. If proposal is to drill or deepen directionally, give pertinent data on subsurface locations and measured and true vertical depths. Give blowout preventer program, if any.

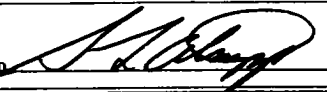
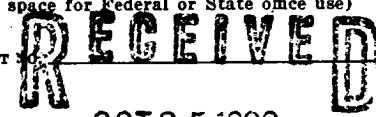
|  |                               |              |
|--|-------------------------------|--------------|
| SIGNED  | TITLE Drilling Superintendent | DATE 5/18/90 |
| (This space for Federal or State office use)   |                               |              |
| PERMIT  | APPROVAL DATE                 | AS / M       |
| APPROVED BY OCT 25 1990  | TITLE                         | SEP 19 1990  |
| CONDITIONS OF APPROVAL, IF ANY:  |                               | AREA MANAGER |

OIL CON. DIV.

NMOOD

DIST. 3

\*See Instructions On Reverse Side

Held C-104 FOR C&amp;E

Submit to Appropriate  
District Office  
State Lease - 4 copies  
Fee Lease - 3 copies

State of New Mexico  
Energy, Minerals and Natural Resources Department

Form C-442  
Revised 1-1-89

OIL CONSERVATION DIVISION

P.O. Box 2088  
Santa Fe, New Mexico 87504-2088

DISTRICT I  
P.O. Box 1980, Hobbs, NM 88240

DISTRICT II  
P.O. Drawer DD, Artesia, NM 88210

DISTRICT III  
1000 Rio Brazos Rd., Aztec, NM 87410

WELL LOCATION AND ACREAGE DEDICATION PLAT

All Distances must be from the outer boundaries of the section

|  |  |                         |  |                           |  |
|--|--|-------------------------|--|---------------------------|--|
| Operator<br><b>MARATHON OIL COMPANY</b>  |  |                         | Lease<br><b>OHIO GOVERNMENT SECTION 22</b> |                           | Well No.<br><b>22-1</b>                |
| Unit Letter<br><b>G</b>  | Section<br><b>22</b>                         | Township<br><b>28 N</b> | Range<br><b>11 W</b>                       | County<br><b>San Juan</b> |  |
| Actual Footage Location of Well:<br><b>2125</b> feet from the <b>North</b> line and <b>1560</b> feet from the <b>East</b> line |  |                         |  |                           |  |
| Ground level Elev.<br><b>5564</b>  | Producing Formation<br><b>Fruitland Coal</b> |                         | Pool<br><b>Basin Fruitland Coal</b>        |                           | Dedicated Acreage:<br><b>320</b> Acres |

1. Outline the acreage dedicated to the subject well by colored pencil or hatchure marks on the plat below.
2. If more than one lease is dedicated to the well, outline each and identify the ownership thereof (both as to working interest and royalty).
3. If more than one lease of different ownership is dedicated to the well, have the interest of all owners been consolidated by communitization, unitization, force-pooling, etc.?  
☐ Yes ☐ No If answer is "yes" type of consolidation \_\_\_\_\_  
If answer is "no" list the owners and tract descriptions which have actually been consolidated. (Use reverse side of this form if necessary.)  
No allowable will be assigned to the well until all interests have been consolidated (by communitization, unitization, forced-pooling, or otherwise) or until a non-standard unit, eliminating such interest, has been approved by the Division.

0 330 660 990 1320 1650 1980 2310 2640 2970 3300 3630 3960 4290 4620 4950 5280 5610 5940 6270 6600 6930 7260 7590 7920 8250 8580 8910 9240 9570 9900 0

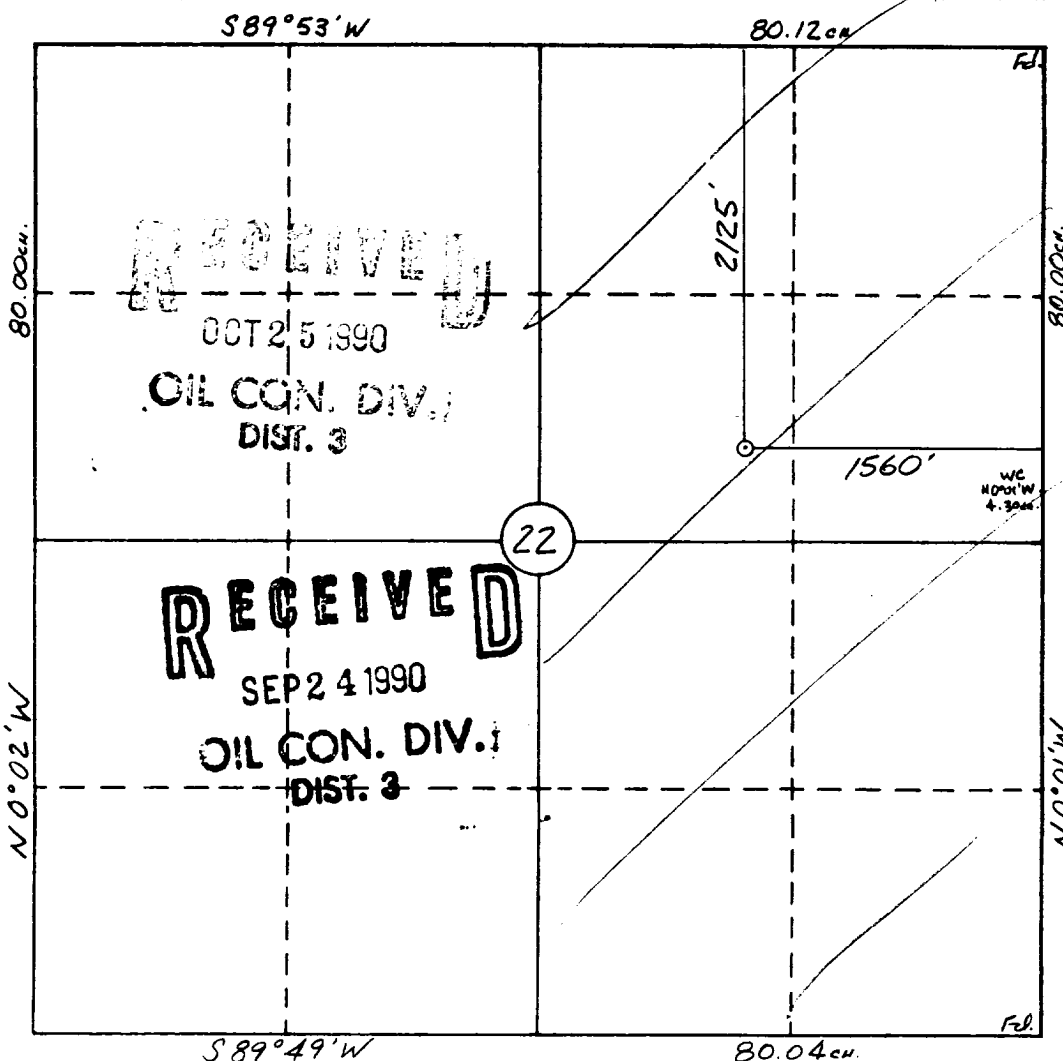

OPERATOR CERTIFICATION

I hereby certify that the information contained herein is true and complete to the best of my knowledge and belief.

Signature *S. L. Atnipp*  
Printed Name **S. L. Atnipp**  
Position **Drilling Superintendent**  
Company **Marathon Oil Company**  
Date **8/3/90**

SURVEYOR CERTIFICATION

I hereby certify that the well location shown on this plat was plotted from field notes of actual surveys made by me or under my supervision, and that the same is true and correct to the best of my knowledge and belief.  
7-25-90

Date Surveyed  
**William S. Manke II**  
Signature & Seal of Professional Surveyor  
**WILLIAM S. MANKE II**  
**NEW MEXICO**  
**#8466**  
Certificate No. **8466**

MARATHON OIL COMPANY  
OHIO GOV'T. SECTION 22 #22-1-R  
1785'FNL & 1895'FEL  
Sec.22, T28N, R11W  
San Juan Co., N.M.

**EXHIBIT A**  
Topographic Map showing  
location of well as staked

460000, FEE