



**UNITED STATES  
DEPARTMENT OF THE INTERIOR  
BUREAU OF LAND MANAGEMENT**

RECEIVED

**APPLICATION FOR PERMIT TO DRILL OR DEEPEN**

1a. TYPE OF WORK <b>DRILL</b> <input checked="" type="checkbox"/> <b>DEEPEN</b> <input type="checkbox"/>		5. LEASE DESIGNATION AND SERIAL NO. NM010063	
b. TYPE OF WELL OIL WELL <input type="checkbox"/> GAS WELL <input checked="" type="checkbox"/> OTHER <input type="checkbox"/>		6. IF INDIAN, ALLOTTEE OR TRIBE NAME	
2. NAME OF OPERATOR Roddy Production Company <i>36845</i> ✓		7. UNIT AGREEMENT NAME	
3. ADDRESS AND TELEPHONE NO. P. O. Box 2221, Farmington, New Mexico 87499 (505)325 - 5750		8. FARM OR LEASE NAME, WELL NO. Lucerne Federal No. 5R ✓ <i>13929</i>	
4. LOCATION OF WELL (Report location clearly and in accordance with any State requirements.) At surface 790' FSL - 1850' FEL At proposed prod. zone		9. API WELL NO. <i>30-045-29449</i> ✓	
14. DISTANCE IN MILES AND DIRECTION FROM NEAREST TOWN OR POST OFFICE* 5 miles southwest of Bloomfield, New Mexico		10. FIELD AND POOL, OR WILDCAT West Kutz Pictured Cliffs ✓ <i>7860</i>	
15. DISTANCE FROM PROPOSED* LOCATION TO NEAREST PROPERTY OR LEASE LINE, FT. 790'		11. SEC., T., R., M., OR BLK AND SURVEY OR AREA Sec. 17, T28N, R11W, NMPM	
16. NO. OF ACRES IN LEASE 1518		12. COUNTY San Juan ✓	
17. NO. OF ACRES ASSIGNED TO THIS WELL 160 ✓		13. STATE NM	
18. DISTANCE FROM PROPOSED LOCATION* TO NEAREST WELL, DRILLING, COMPLETED, OR APPLIED FOR, ON THIS LEASE, FT. 565'		20. ROTARY OR CABLE TOOLS Rotary	
21. ELEVATIONS (Show whether DF, RT, GR, etc.) 5770' GL		22. APPROX. DATE WORK WILL START* March 1997	

**This action is subject to technical and procedural review pursuant to 43 CFR 3165.3 and appeal pursuant to 43 CFR 3165.4.**

**PROPOSED CASING AND CEMENTING PROGRAM**

SIZE OF HOLE	GRADE, SIZE OF CASING	WEIGHT PER FOOT	SETTING DEPTH	QUANTITY OF CEMENT
8.750 "	7.000 ", J - 55	20	200 '	65 cf, circ to surface
6.250 "	4.500 ", J - 55	10.5	1880 '	292.10 cf, circ to surface

Roddy Production Company proposes to spud in the Nacimiento Formation. Will drill an 8 3/4 " hole to 200 '. Run and cement surface casing with cement returns to surface. WOC 12 hours. Test casing and BOPE to 600 psig for 30 minutes. Drill a 6 1/4 " hole to TD of 1880 ' using fresh water mud. No poisonous gases or abnormal pressures are anticipated, however the Farmington sands may be abnormally pressured. Adequate weight material will be on location to control any flows from the Farmington sands. Run logs at TD. Run and cement production casing with cement returns to surface. WOC 12 hours. Move out drilling rig and move in completion unit. Pressure test production casing to 2000 psig for 30 minutes prior to perforating. Run cased hole correlation logs. Perforate Pictured Cliffs and stimulate using a fresh water based foam system.

Surface ownership is BLM.

Roddy Production Company proposes to retain the wellbore of the Lucerne Federal No. 5 in its present state as a pressure monitor well until such time that it becomes economically feasible to plug back to a shallower formation.

**RECEIVED**  
APR 14 1997

**DRILLING OPERATIONS AUTHORIZED ARE  
SUBJECT TO COMPLIANCE WITH ATTACHED  
"GENERAL REQUIREMENTS"**

IN ABOVE SPACE DESCRIBE PROPOSED PROGRAM: If proposal is to deepen, give data on present productive zone and proposed new productive zone. If proposal is to drill or deepen directionally, give pertinent data on subsurface locations and measured true vertical depths. Give blowdown, enter, and shut-in pressures.

24. SIGNED <i>R. E. Fiddle</i>	<b>OIL CON. DIV.</b>	<b>DIST. 3</b>	DATE February 28, 1997
TITLE Agent			

(This space for Federal or State office use)

PERMIT NO. \_\_\_\_\_ APPROVAL DATE **APR 11 1997**

Application approval does not warrant or certify that the applicant holds legal or equitable title to those rights in the subject lease which would entitle the applicant to conduct operations thereon.  
CONDITIONS OF APPROVAL, IF ANY

APPROVED BY *AS/ Duane W. Spencer* TITLE \_\_\_\_\_ DATE **APR 11 1997**

**NMOC**

District I  
PO Box 1980, Hobbs, NM 88241-1980  
District II  
PO Drawer DD, Artesia, NM 88211-0719  
District III  
1000 Rio Brazos Rd., Aztec, NM 87410  
District IV  
PO Box 2088, Santa Fe, NM 87504-2088

State of New Mexico  
Energy, Minerals & Natural Resources Department

OIL CONSERVATION DIVISION  
PO Box 2088  
Santa Fe, NM 87504-2088

Form C-102  
Revised February 21, 1994  
Instructions on back  
Submit to Appropriate District Office  
State Lease - 4 Copies  
Fee Lease - 3 Copies

57 MAR -4 PM 1:46

☐ AMENDED REPORT

WELL LOCATION AND ACREAGE DEDICATION PLAT

API Number 30-045-29449		Pool Code 79860	Well Name West Kutz Pictured Cliffs
Property Code 13929	Property Name Lucerne Federal		Well Number 5R
OGRID No. 36845	Operator Name RODDY PRODUCTION, INC.		Elevation 5770'

<sup>10</sup> Surface Location

UL or lot no.	Section	Township	Range	Lot Ida	Feet from the	North/South line	Feet from the	East/West line	County
0	17	28-N	11-W		790	South	1850	East	S.J.

<sup>11</sup> Bottom Hole Location If Different From Surface

UL or lot no.	Section	Township	Range	Lot Ida	Feet from the	North/South line	Feet from the	East/West line	County

<sup>12</sup> Dedicated Acres 160	<sup>13</sup> Joint or Infill NA	<sup>14</sup> Consolidation Code NA	<sup>15</sup> Order No. NA
--------------------------------------	-------------------------------------	--	-------------------------------

NO ALLOWABLE WILL BE ASSIGNED TO THIS COMPLETION UNTIL ALL INTERESTS HAVE BEEN CONSOLIDATED  
OR A NON-STANDARD UNIT HAS BEEN APPROVED BY THE DIVISION

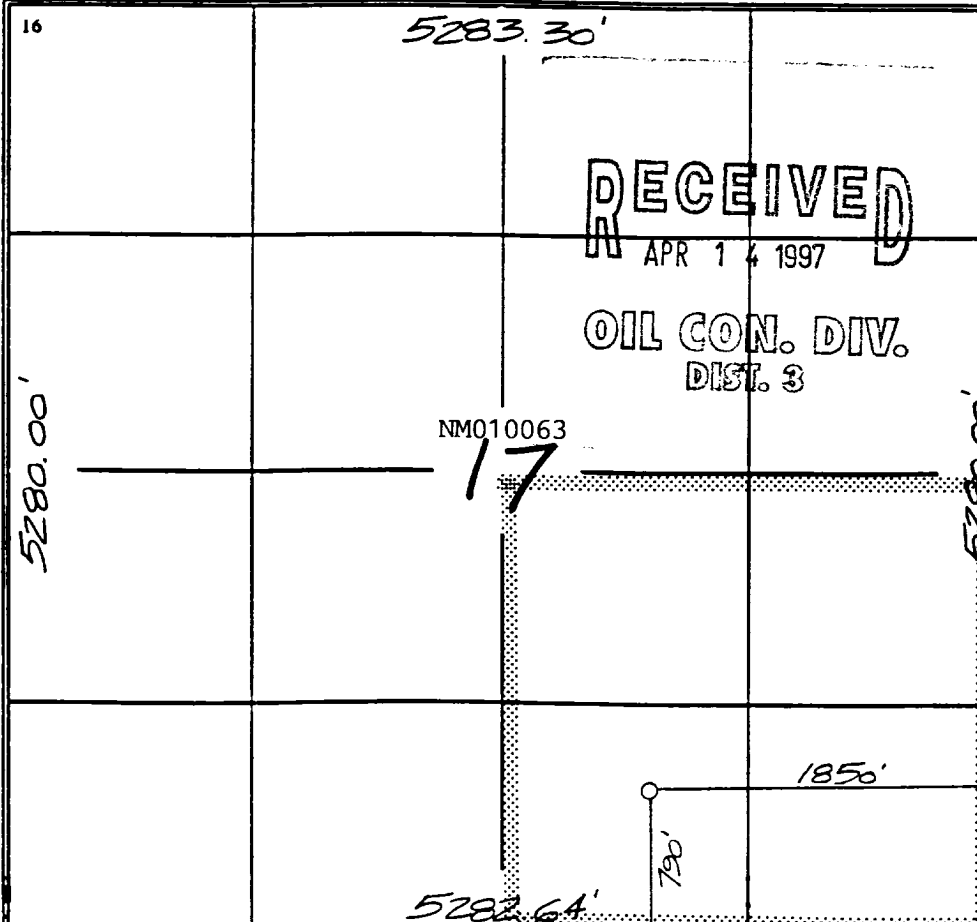
16		<b>17 OPERATOR CERTIFICATION</b> I hereby certify that the information contained herein is true and complete to the best of my knowledge and belief.  Robert E. Fielder Signature Robert E. Fielder Printed Name Agent Title February 28, 1997 Date

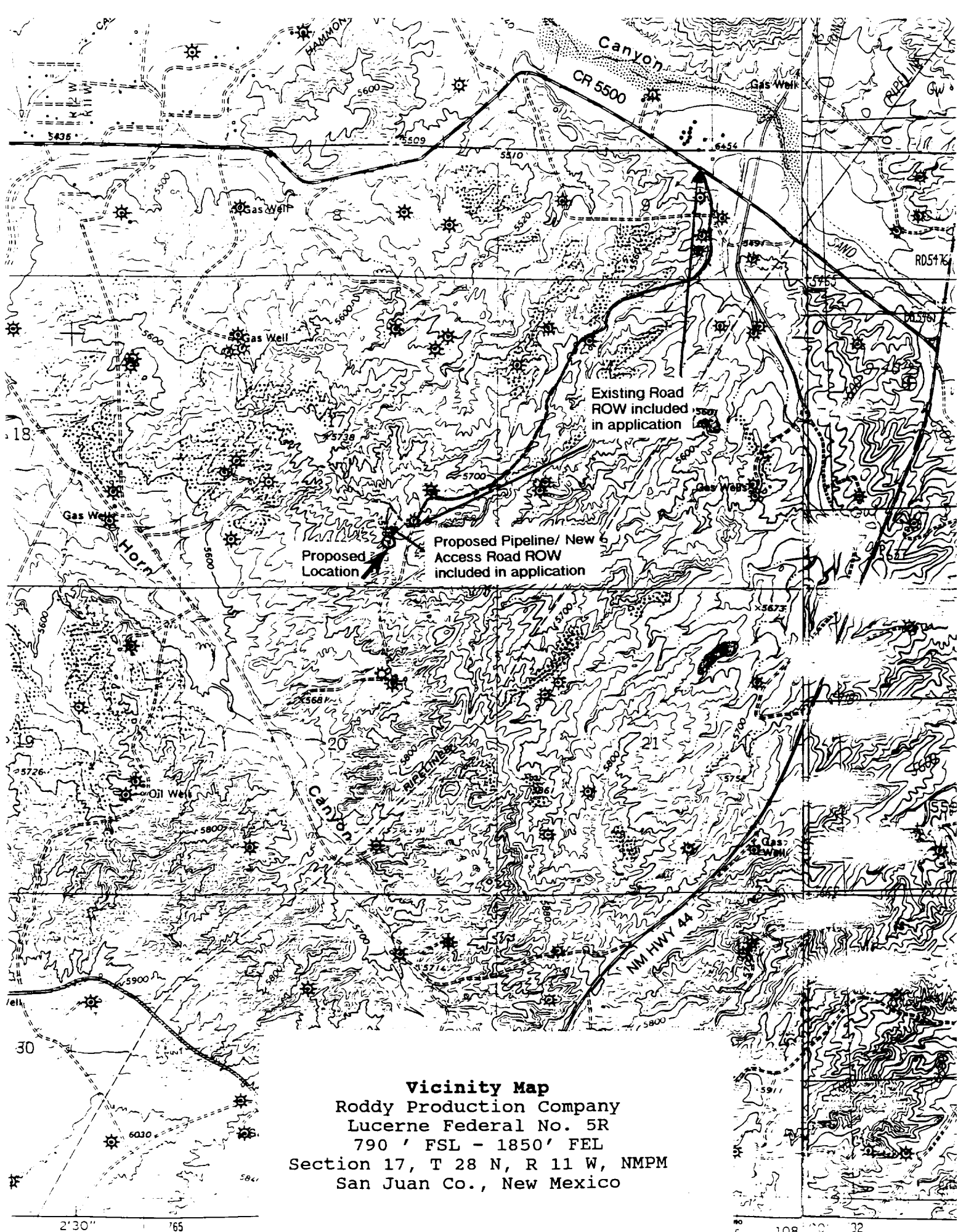

**Vicinity Map**  
 Roddy Production Company  
 Lucerne Federal No. 5R  
 790' FSL - 1850' FEL  
 Section 17, T 28 N, R 11 W, NMPM  
 San Juan Co., New Mexico