

NO. OF COPIES RECEIVED	6
DISTRIBUTION	
SANTA FE	1
FILE	1 ✓
U.S.G.S.	2
LAND OFFICE	1
OPERATOR	1

# NEW MEXICO OIL CONSERVATION COMMISSION

Form C-101  
Revised 1-1-65

5A. Indicate Type of Lease
STATE <input checked="" type="checkbox"/> FEE <input type="checkbox"/>
5. State Oil & Gas Lease No.
<b>E-289</b>

## APPLICATION FOR PERMIT TO DRILL, DEEPEN, OR PLUG BACK

1a. Type of Work		7. Unit Agreement Name	
DRILL <input checked="" type="checkbox"/> DEEPEN <input type="checkbox"/> PLUG BACK <input type="checkbox"/>		<b>San Juan 29-6</b>	
b. Type of Well		8. Farm or Lease Name	
OIL WELL <input type="checkbox"/> GAS WELL <input checked="" type="checkbox"/> OTHER <input type="checkbox"/> SINGLE ZONE <input checked="" type="checkbox"/> MULTIPLE ZONE <input type="checkbox"/>			
2. Name of Operator		9. Well No.	
<b>Beta Development Co.</b>		<b>96</b>	
3. Address of Operator		10. Field and Pool, or Wildcat	
<b>234 Petroleum Club Plaza, Farmington, New Mexico</b>		<b>Basin Dakota</b>	
4. Location of Well		12. County	
UNIT LETTER <b>M</b> LOCATED <b>1185</b> FEET FROM THE <b>South</b> LINE AND <b>1170</b> FEET FROM THE <b>West</b> LINE OF SEC. <b>2</b> TWP. <b>29 N</b> RGE. <b>6 W</b> NMPM		<b>Rio Arriba</b>	
19. Proposed Depth		19A. Formation	20. Rotary or C.T.
<b>7900'</b>		<b>Dakota</b>	<b>Rotary</b>
21. Elevations (Show whether DF, RT, etc.)	21A. Kind & Status Plug. Bond	21B. Drilling Contractor	22. Approx. Date Work will start
<b>6471.39' GR</b>	<b>On File</b>	<b>Loffland Bros.</b>	<b>May 18, 1966</b>

23.

## PROPOSED CASING AND CEMENT PROGRAM

SIZE OF HOLE	SIZE OF CASING	WEIGHT PER FOOT	SETTING DEPTH	SACKS OF CEMENT	EST. TOP
12 1/4"	8 5/8"	24#	300'	175 sx	Circulate
7 7/8"	4 1/2"	10.5 & 11.6#	7900'	3 stages	

Propose to cement production casing in 3 stages: 1st stage - to protect the Dakota formation; 2nd stage - to protect the MesaVerde formation; 3rd stage - to protect the Pictured Cliffs and Kirtland formations.

Propose to perforate and sand - water - frac the Dakota formation.



IN ABOVE SPACE DESCRIBE PROPOSED PROGRAM: IF PROPOSAL IS TO DEEPEN OR PLUG BACK, GIVE DATA ON PRESENT PRODUCTIVE ZONE AND PROPOSED NEW PRODUCTIVE ZONE. GIVE BLOWOUT PREVENTER PROGRAM, IF ANY.

I hereby certify that the information above is true and complete to the best of my knowledge and belief.

Original signed by: **JOHN T. HAMPTON** Title **Manager** Date **May 12, 1966**

(This space for State Use)

APPROVED BY

CONDITIONS OF APPROVAL, IF ANY:

TITLE **Sup. Dist. III**  
APPROVAL VALID  
FOR 90 DAYS UNLESS  
DRILLING COMMENCED,

DATE

**5-16-66**

8-15-66

# NEW MEXICO OIL CONSERVATION COMMISSION WELL LOCATION AND ACERAGE DEDICATION PLAT

All distances must be from the outer boundaries of the Section

Operator <b>BETA DEVELOPMENT COMPANY</b>			Lease <b>San Juan 29-6 Unit</b>		Well No. <b>96</b>
Unit Letter <b>M</b>	Section <b>2</b>	Township <b>29 NORTH</b>	Range <b>6 WEST</b>	County <b>RIO ARriba</b>	
Actual Footage Location of Well: <b>1185</b> feet from the <b>SOUTH</b> line and <b>1170</b> feet from the <b>WEST</b> line					
Ground Level Elev <b>6471.39</b>	Producing Formation <b>Dakota</b>	Pool <b>Basin Dakota</b>	Dedicated Acreage: <b>W/319.13</b> Acres		

1. Outline the acreage dedicated to the subject well by colored pencil or hatchure marks on the plat below.
2. If more than one lease is dedicated to the well, outline each and identify the ownership thereof (both as to working interest and royalty),
3. If more than one lease of different ownership is dedicated to the well, have the interests of all owners been consolidated by communitization, unitization, force-pooling, etc?

( ) Yes ( ) No If answer is "yes," type of consolidation .....

If answer is "no," list the owners and tract descriptions which have actually consolidated. (Use reverse side of this form if necessary.) .....

No allowable will be assigned to the well until all interests have been consolidated (by communitization, unitization, forced-pooling, or otherwise) or until a non standard unit, eliminating such interests, has been approved by the Commission.

## CERTIFICATION

I hereby certify that the information contained herein is true and complete to the best of my knowledge and belief.

Original signed by:  
**JOHN T. HAMPTON**

Name  
**Manager**

Position  
**Beta Development Co.**

Company  
**May 12, 1966**

Date

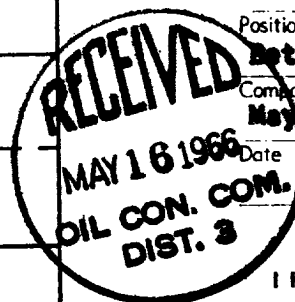

I hereby certify that the well location shown on this plat was plotted from field notes of actual surveys made by me or under my supervision, and that the same is true and correct to the best of my knowledge and belief.

Date Survey

Required Signature of Surveyor

Certification

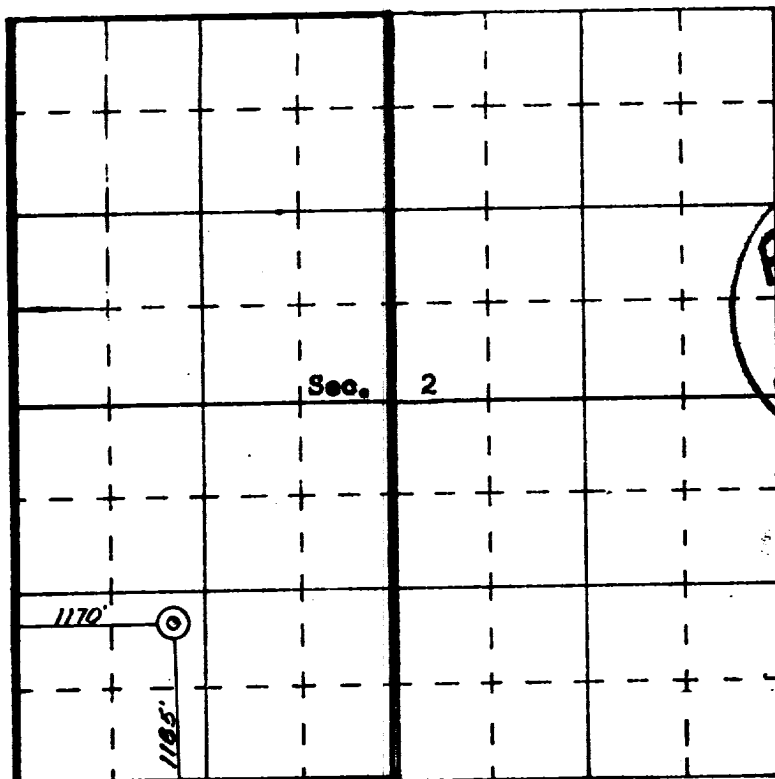

SCALE—4 INCHES EQUALS 1 MILE

SAN JUAN ENGINEERING COMPANY, FARMINGTON, N. M.