

NO. OF COPIES RECEIVED	6
DISTRIBUTION	
SANTA FE	1
FILE	1
U.S.G.S.	2
LAND OFFICE	1
OPERATOR	1

# NEW MEXICO OIL CONSERVATION COMMISSION

Form C-101  
Revised 1-1-65 30-039-20356

5A. Indicate Type of Lease
STATE <input checked="" type="checkbox"/> FEE <input type="checkbox"/>
5. State Oil & Gas Lease No.
<b>E-289-36</b>

## APPLICATION FOR PERMIT TO DRILL, DEEPEN, OR PLUG BACK

1a. Type of Work		7. Unit Agreement Name	
DRILL <input checked="" type="checkbox"/> DEEPEN <input type="checkbox"/> PLUG BACK <input type="checkbox"/>		<b>San Juan 29-5 Unit</b>	
b. Type of Well		8. Farm or Lease Name	
OIL WELL <input type="checkbox"/> GAS WELL <input checked="" type="checkbox"/> OTHER <input type="checkbox"/>		<b>San Juan 29-5 Unit</b>	
2. Name of Operator		9. Well No.	
<b>El Paso Natural Gas Company</b>		<b>53</b>	
3. Address of Operator		10. Field and Pool, or Wildcat	
<b>Box 990, Farmington, New Mexico 87401</b>		<b>Basin Dakota</b>	
4. Location of Well		12. County	
UNIT LETTER <b>L</b> LOCATED <b>1800</b> FEET FROM THE <b>South</b> LINE		<b>Rio Arriba</b>	
AND <b>990</b> FEET FROM THE <b>West</b> LINE OF SEC. <b>32</b> TWP. <b>29N</b> RGE. <b>5W</b> NMPM			
21. Elevations (Show whether DF, RT, etc.)		22. Approx. Date Work will start	
<b>6479' BOX GL</b>			
21A. Kind & Status Plug. Bond		20. Rotary or C.T.	
<b>Statewide</b>		<b>Rotary</b>	
21B. Drilling Contractor		19. Proposed Depth	
<b>Arapahoe Drilling Co.</b>		<b>7945</b>	
		19A. Formation	
		<b>Dakota</b>	

## PROPOSED CASING AND CEMENT PROGRAM

SIZE OF HOLE	SIZE OF CASING	WEIGHT PER FOOT	SETTING DEPTH	SACKS OF CEMENT	EST. TOP
13 3/4"	9 5/8"	32.30#	200'	190 Sks.	Circulated
8 3/4"	7"	20#	3640'	185 Sks.	2530'
6 1/4"	4 1/2"	10.5 & 11.6#	7945'	355 Sks.	3640'

Selectively perforate and sand water fracture the Dakota formation.

The S/2 of Section 32 is dedicated to this well.

APPROVAL VALID  
FOR 90 DAYS UNLESS  
DRILLING COMMENCED,

EXPIRES May 17, 1971

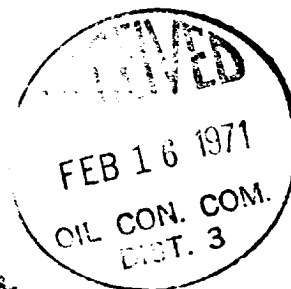

IN ABOVE SPACE DESCRIBE PROPOSED PROGRAM: IF PROPOSAL IS TO DEEPEN OR PLUG BACK, GIVE DATA ON PRESENT PRODUCTIVE ZONE AND PROPOSED NEW PRODUCTIVE ZONE. GIVE BLOWOUT PREVENTER PROGRAM, IF ANY.

I hereby certify that the information above is true and complete to the best of my knowledge and belief.

Signed John Sigurd F. H. WOOD Title Petroleum Engineer Date 2-11-71

(This space for State Use)

APPROVED BY A. R. Kendrick TITLE PETROLEUM ENGINEER DIST. NO. 3 DATE FEB 16 1971

CONDITIONS OF APPROVAL, IF ANY:

NEW MEXICO OIL CONSERVATION COMMISSION  
WELL LOCATION AND ACREAGE DEDICATION PLAT

EL PASO NATURAL GAS COMPANY

SAN JUAN 29-5 UNIT

(E-289-36)

53

L

32

29-N

5-W

RIO ARriba

1800

SOUTH

990

WEST

6479

DAKOTA

BASIN DAKOTA

320.00

1. Outline the acreage dedicated to the subject well by colored pencil or ink.
2. If more than one lease is dedicated to the well, outline each and attach to this plat a list of interest and royalty.
3. If more than one lease of different ownership is dedicated to the well, have the interest dated by communalization, unitization, forced pooling, etc.

**X**

Yes

No

If answer is "yes," type of communalization

**Unitization**

If answer is "no," list the owners and tract descriptions which have actually been included in this plat if necessary.

No allowable will be assigned to the well until all interests have been included in the unit, forced pooling, or otherwise, or until a non-standard unit including such interests has been designated.

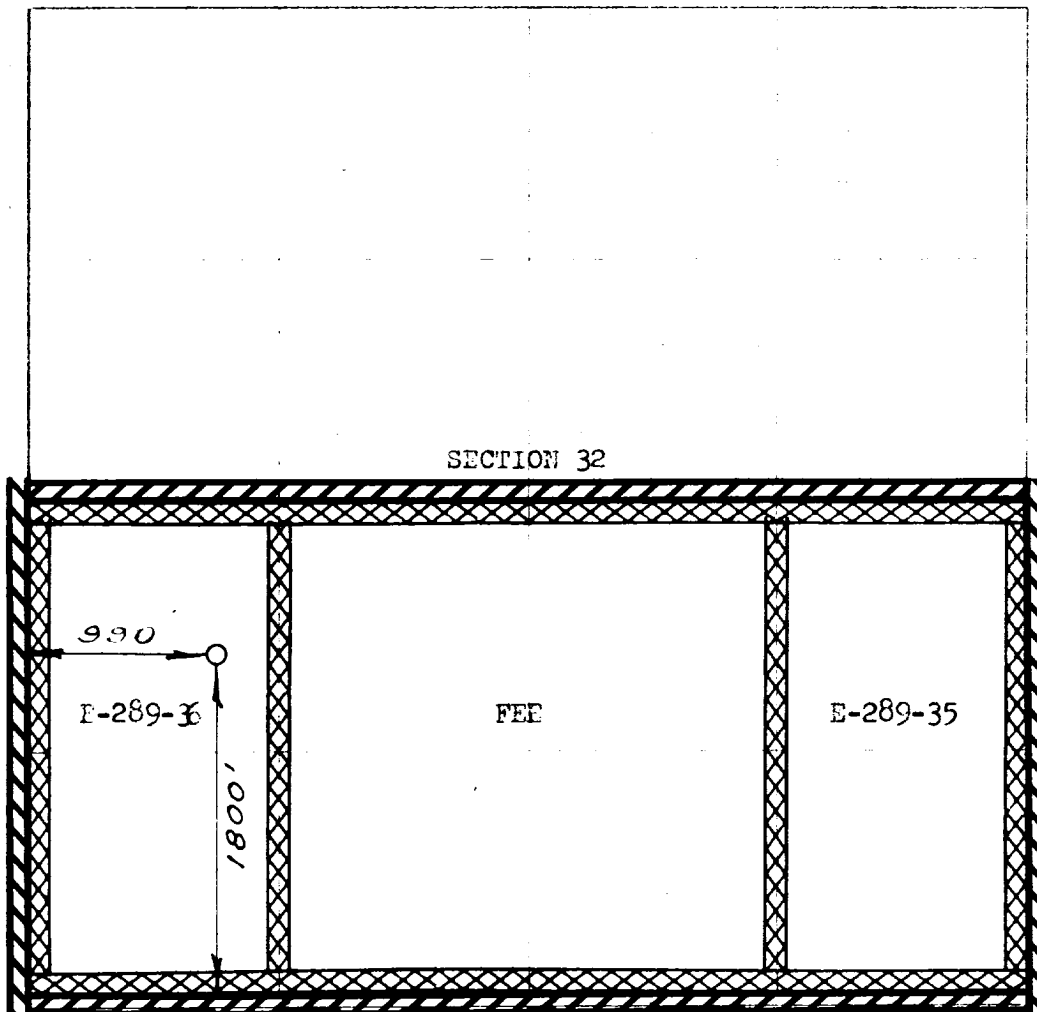

Original Signed F. H. WOOD

**Petroleum Engineer**

**El Paso Natural Gas Company**

**February 11, 1971**

JANUARY 11, 1971

1760