

UNITED STATES  
DEPARTMENT OF THE INTERIOR  
GEOLOGICAL SURVEY

## APPLICATION FOR PERMIT TO DRILL, DEEPEN, OR PLUG BACK

1a. TYPE OF WORK DRILL <input checked="" type="checkbox"/> DEEPEN <input type="checkbox"/> PLUG BACK <input type="checkbox"/>		5. LEASE DESIGNATION AND SERIAL NO. NM - 18323		
b. TYPE OF WELL OIL WELL <input type="checkbox"/> GAS WELL <input checked="" type="checkbox"/> OTHER <input type="checkbox"/>		6. IF INDIAN, ALLOTTEE OR TRIBE NAME		
2. NAME OF OPERATOR Continental Oil Company		7. UNIT AGREEMENT NAME		
3. ADDRESS OF OPERATOR 152 N. Durbin, Casper, Wyoming 82601		8. FARM OR LEASE NAME Conoco 29-4		
4. LOCATION OF WELL (Report location clearly and in accordance with any State requirements.)* At surface 1100' FSL, 1185' FWL (SW SW) At proposed prod. zone		9. WELL NO. 4		
14. DISTANCE IN MILES AND DIRECTION FROM NEAREST TOWN OR POST OFFICE*		10. WELLS AND POOL, OR WILDCAT <del>East San Juan-Mesaverde</del>		
15. DISTANCE FROM PROPOSED* LOCATION TO NEAREST PROPERTY OR LEASE LINE, FT. (Also to nearest drlg. unit line, if any)		11. SEC., T., R., M., OR BLK. AND SURVEY OR AREA Sec. 24-T29N-R4W		
16. NO. OF ACRES IN LEASE 640		12. COUNTY OR PARISH Rio Arriba		
17. NO. OF ACRES ASSIGNED TO THIS WELL 320		13. STATE New Mexico		
18. DISTANCE FROM PROPOSED LOCATION* TO NEAREST WELL, DRILLING, COMPLETED, OR APPLIED FOR, ON THIS LEASE, FT.		20. ROTARY OR CABLE TOOLS Rotary		
21. ELEVATIONS (Show whether DF, RT, GR, etc.) 6999 GR		22. APPROX. DATE WORK WILL START* July 15, 1973		
23. PROPOSED CASING AND CEMENTING PROGRAM				
SIZE OF HOLE	SIZE OF CASING	WEIGHT PER FOOT	SETTING DEPTH	QUANTITY OF CEMENT
12 1/4"	8 5/8"	24#	200'	150 sacks class "A"
7 7/8"	4 1/2"	10.5#	6210'	260-130 sack POZ "A" in two stages

It is proposed to drill the subject well to test for commercial production from the Mesaverde formation. No cores or DST's are planned. All appropriate logs will be run.

The drilling rig will be equipped with a blow-out preventer, which will be tested daily. Also all equipment used in the drilling operations will be equipped with all safety devices prescribed by the U. S. Forest Service, and all operations will be conducted according to their rules and regulations.

IN ABOVE SPACE DESCRIBE PROPOSED PROGRAM: If proposal is to deepen or plug back, give data on present productive zone and proposed new productive zone. If proposal is to drill or deepen directionally, give pertinent data on subsurface locations and measured and true vertical depths. Give blowout preventer program, if any.

24. SIGNED J. A. Uhlen TITLE Administrative Supervisor DATE June 6, 1973  
(This space for Federal or State office use)

PERMIT NO. \_\_\_\_\_ APPROVAL DATE \_\_\_\_\_

APPROVED BY [Signature] TITLE \_\_\_\_\_ DATE \_\_\_\_\_  
CONDITIONS OF APPROVAL, IF ANY:

USGS(6) NMOCC - Aztec(2) U. S. Forest Service File(2)

**NEW MEXICO OIL CONSERVATION COMMISSION  
WELL LOCATION AND ACERAGE DEDICATION PLAT**

All distances must be from the outer boundaries of the Section

Operator <b>CONTINENTAL OIL COMPANY</b>			Lease <b>SAN JUAN 29-4</b>		Well No. <b>4</b>
Unit Letter <b>M</b>	Section <b>24</b>	Township <b>29 NORTH</b>	Range <b>4 WEST</b>	County <b>RIO ARriba</b>	
Actual Surface Location of Well: <b>1100</b> feet from the <b>SOUTH</b> line and <b>1185</b> feet from the <b>WEST</b> line					
Ground Level Elev. <b>6999.0</b>	Producing Formation		Pool <b>Blanco Mesaverde</b>	Dedicated Acreage <b>320</b>	Acres

1. Outline the acreage dedicated to the subject well by colored pencil or hatchure marks on the plat below.
2. If more than one lease is dedicated to the well, outline each and identify the ownership thereof (both as to working interest and royalty).
3. If more than one lease of different ownership is dedicated to the well, have the interests of the owners been consolidated by communitization, unitization, force-pooling, etc?

( ) Yes ( ) No If answer is "yes," type of consolidation .....

If answer is "no," list the owners and tract descriptions which have actually consolidated. (Use reverse side of this form if necessary.) .....

No allowable will be assigned to the well until all interests have been consolidated (by communitization, unitization, forced-pooling, or otherwise) or until a non standard unit, eliminating such interests, has been approved by the Commission.

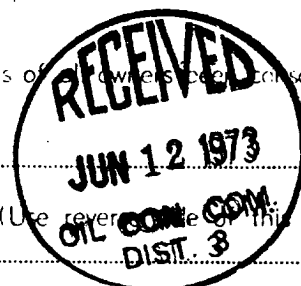

**CERTIFICATION**

I hereby certify that the information contained herein is true and complete to the best of my knowledge and belief.

*J. A. Ubben*  
Name

**J. A. Ubben**  
Position

**Administrative Supervisor**  
Company

**CONTINENTAL OIL COMPANY**

Date

**June 6, 1973**

I hereby certify that the well location shown on this plat was plotted from field notes of actual surveys made by me or under my supervision, and that the same is true and correct to the best of my knowledge and belief.

**23 May, 1973**  
Date Approved

*James P. Leese*  
Registered Professional Engineer  
and a Land Surveyor

**JAMES P. LEESE**

**1463**  
Certificate No.

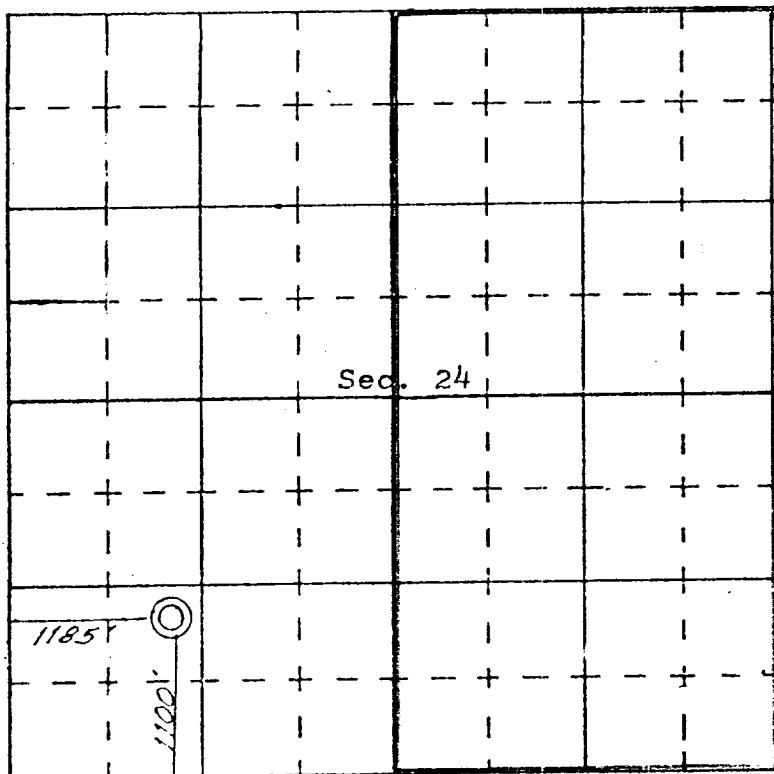

SCALE—4 INCHES EQUALS 1 MILE

**SAN JUAN ENGINEERING COMPANY, FARMINGTON, N. M.**