

UNITED STATES  
DEPARTMENT OF THE INTERIOR  
GEOLOGICAL SURVEY

30-039-23318  
5. LEASE DESIGNATION AND SERIAL NO.  
SF-079758

APPLICATION FOR PERMIT TO DRILL, DEEPEN, OR PLUG BACK

12. TYPE OF WORK  
DRILL  DEEPEN  PLUG BACK

6. IF INDIAN, ALLOTTEE OR TRIBE NAME

D. TYPE OF WELL  
OIL WELL  GAS WELL  OTHER  SINGLE ZONE  MULTIPLE ZONE

7. UNIT AGREEMENT NAME

2. NAME OF OPERATOR  
Eastern States Exploration Company, Inc.

8. FARM OR LEASE NAME  
San Juan 29-4

3. ADDRESS OF OPERATOR  
913 King Street, Alexander, Virginia 22314

9. WELL NO.  
3

4. LOCATION OF WELL (Report location clearly and in accordance with any State requirements.)  
At surface  
At proposed prod. zone 1735 1850' FNL, 790' FEL

10. FIELD AND POOL, OR WILDCAT  
Basin Dakota

11. SEC., T., R., M., OR BLK. AND SURVEY OR AREA  
Sec. 16-T29N-R4W  
N.M.P.M.

14. DISTANCE IN MILES AND DIRECTION FROM NEAREST TOWN OR POST OFFICE\*  
15 miles east of Gobernador, New Mexico

12. COUNTY OR PARISH 13. STATE  
Rio Arriba N.M.

15. DISTANCE FROM PROPOSED\* LOCATION TO NEAREST PROPERTY OR LEASE LINE, FT. (Also to nearest drig. unit line, if any) 790'

16. NO. OF YEARS IN LEASE  
2558.90

17. NO. OF ACRES ASSIGNED TO THIS WELL  
320

18. DISTANCE FROM PROPOSED LOCATION\* TO NEAREST WELL, DRILLING, COMPLETED, OR APPLIED FOR, ON THIS LEASE, FT. 2500'

19. PROPOSED DEPTH  
8950'

20. ROTARY OR CABLE TOOLS  
Rotary

21. ELEVATIONS (Show whether DF, RT, GR, etc.)  
7514' G.R.

DRILLING OPERATIONS AUTHORIZED ARE SUBJECT TO COMPLIANCE WITH ATTACHED

22. APPROX. DATE WORK WILL START\*  
10/15/83

23. GENERAL REQUIREMENTS: PROPOSED CASING AND CEMENTING PROGRAM This action is subject to administrative appeal pursuant to 30 CFR 290.

SIZE OF HOLE	SIZE OF CASING	WEIGHT PER FOOT	SETTING DEPTH	QUANTITY OF CEMENT
15"	10-3/4"	40.50	350'	550 Cu. Ft.
9-7/8"	7-5/8"	26.40	4650'	550 Cu. Ft.
6-3/4"	4-1/2"	11.60	4450'-8950'	622 Cu. Ft.

The Pictured Cliffs, Gallup and Dakota Formations will be tested. Final completion will depend upon results of tests. Appropriate approvals will be requested for other than single zone completion.

EXHIBITS:

- "A" Location & Elevation Plat
- "B" Ten Point Compliance Program
- "C" Blowout Preventer Diagram
- "D" Multi Point Requirements of APD
- "E" Access Road to Location
- "F" Radius Map of Field
- "G" Drill Rig Layout
- "H" Fracturing Program Layout
- "I" Location Profile

RECEIVED  
OCT - 6 1983  
OIL COMPANY  
DEPT 3

The gas for this well is committed.

The E/2 Section 16 is dedicated to this well.

IN ABOVE SPACE DESCRIBE PROPOSED PROGRAM: If proposal is to deepen or plug back, give data on present productive zone and proposed new productive zone. If proposal is to drill or deepen directionally, give pertinent data on subsurface locations and measured and true vertical depths. Give blowout preventer program, if any.

24. FOR: EASTERN STATES EXPLORATION COMPANY, INC.

SIGNED EWELL N. WALSH ORIGINAL SIGNED BY Walsh Engr. & Prod. Corp. DATE 8/15/83  
Ewell N. Walsh, P.E. President

(This space for Federal or State office use)

PERMIT NO. \_\_\_\_\_ APPROVAL DATE \_\_\_\_\_

APPROVED BY \_\_\_\_\_ TITLE \_\_\_\_\_ DATE \_\_\_\_\_

CONDITIONS OF APPROVAL, IF ANY:

APPROVED  
AS AMENDED  
DATE OCT 04 1983  
AREA MANAGER  
FARMINGTON RESOURCE AREA

\*See Instructions On Reverse Side

oh ↓

AM000

# OIL CONSERVATION DIVISION

P. O. BOX 2048

SANTA FE, NEW MEXICO 87501

Form C-107  
Revised 10-1-78

STATE OF NEW MEXICO

ENERGY AND MINERALS DEPARTMENT

All distances must be from the outer boundaries of the Section.

Operator <b>EASTERN STATES EXPLORATION CO., INC.</b>			Lease <b>San Juan 29-4</b>		Well No. <b>3</b>
Unit Letter <b>H</b>	Section <b>16</b>	Township <b>29N</b>	Range <b>4W</b>	County <b>Rio Arriba</b>	
Actual Footage Location of Well: <b>1735</b> feet from the <b>North</b> line and <b>790</b> feet from the <b>East</b> line					
Ground Level Elev: <b>7524</b>	Producing Formation <b>Dakota</b>		Pool <b>Basin Dakota</b>	Dedicated Acreage <b>320</b>	Acres <b>Acres</b>

1. Outline the acreage dedicated to the subject well by colored pencil or hachure marks on the plat below.
2. If more than one lease is dedicated to the well, outline each and identify the ownership thereof (both as to working interest and royalty).
3. If more than one lease of different ownership is dedicated to the well, have the interests **RECONSOLIDATED** (both as to working interest and royalty) been consolidated by communitization, unitization, force-pooling, etc?

Yes  No If answer is "yes," type of consolidation \_\_\_\_\_

If answer is "no," list the owners and tract descriptions which have actually been consolidated. (Use reverse side of this form if necessary.) \_\_\_\_\_

No allowable will be assigned to the well until all interests have been consolidated (by communitization, unitization, forced-pooling, or otherwise) or until a non-standard unit, eliminating such interests, has been approved by the Commission.

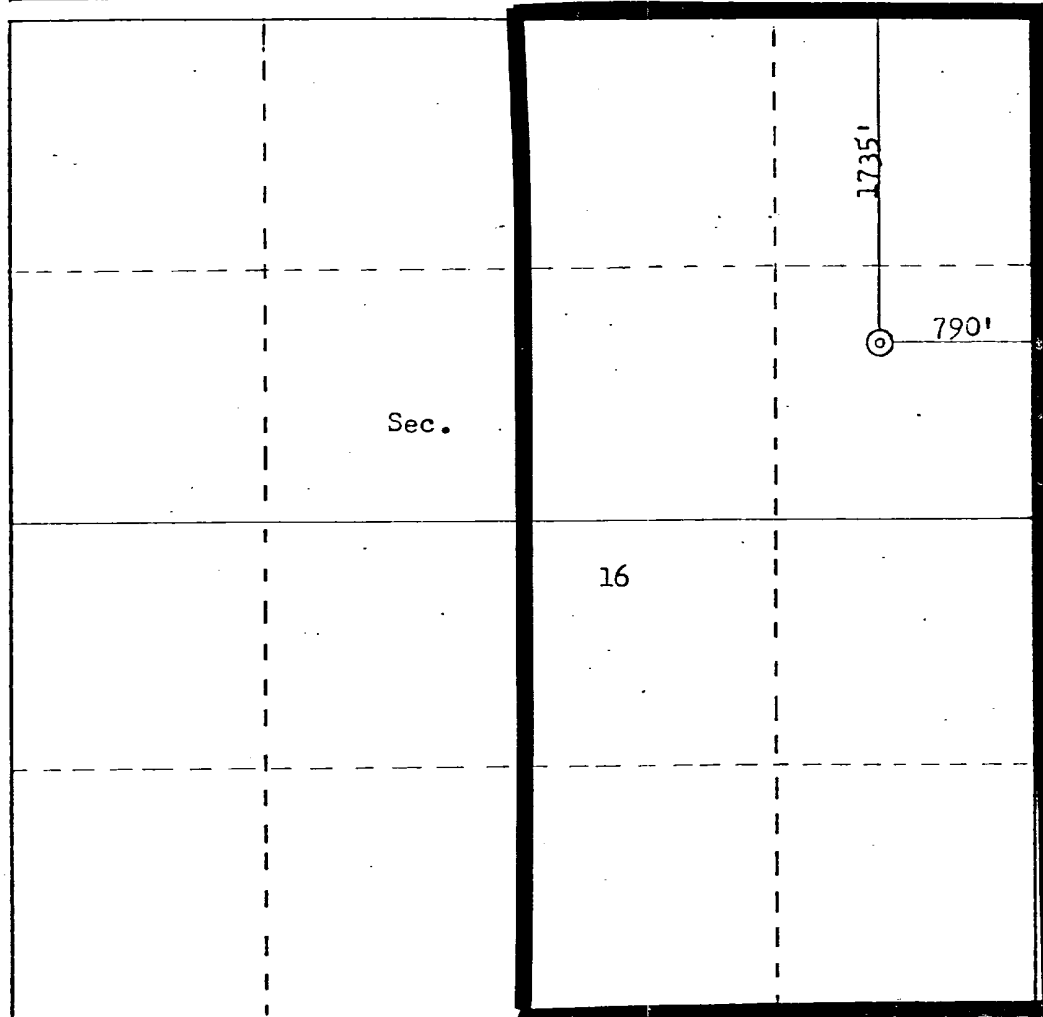

Scale: 1"=1000'

CERTIFICATION	
I hereby certify that the information contained herein is true and complete to the best of my knowledge and belief.	
For: <b>EASTERN STATES EXPLOR. CO. Inc.</b>	
Name	<b>Ewell N. Walsh, P.E.</b>
Position	<b>President</b>
Company	<b>Walsh Engr. &amp; Prod. Corp.</b>
Date	<b>8/22/83</b>
I hereby certify that the well location shown on this plat was plotted from field notes of actual surveys made by me or under my supervision, and that the same is true and correct to the best of my knowledge and belief.	
Date Surveyed	Re-issued
<b>August 22, 1983</b>	<b>August 22, 1983</b>
Registered Professional Engineer and Land Surveyor	<b>Fred B. Kerr, Jr.</b>
Certificate No.	<b>3950</b>

