

District I
PO Box 1980, Hobbs, NM 88241-1980
District II
PO Drawer DD, Artesia, NM 88211-0719
District III
1000 Rio Brazos Rd., Aztec, NM 87410
District IV
PO Box 2088, Santa Fe, NM 87504-2088

State of New Mexico
Energy, Minerals & Natural Resources Department

OIL CONSERVATION DIVISION
PO Box 2088
Santa Fe, NM 87504-2088

Form C-101
Revised February 21, 1994
Instructions on back
Submit to Appropriate District Office
State Lease - 6 Copies
Fee Lease - 5 Copies

AMENDED REPORT

APPLICATION FOR PERMIT TO DRILL, RE-ENTER, DEEPEN, PLUGBACK, OR ADD A ZONE

Operator Name and Address. Meridian Oil Inc ✓ PO Box 4289, Farmington, New Mexico 87499		OCRID Number 14538
		API Number 30-039-25592 ✓
Property Code 7465	Property Name San Juan 29-7 Unit	Well No. 129M ✓

Surface Location

UL or lot no.	Section	Township	Range	Lot Idn	Feet from the	North/South line	Feet from the	East/West line	County
I	16	29N	7W		1850	South	1190	East	RA

Proposed Bottom Hole Location If Different From Surface

UL or lot no.	Section	Township	Range	Lot Idn	Feet from the	North/South line	Feet from the	East/West line	County
72319									
Proposed Pool 1 <i>Blanco Mesaverde E/320</i>					Proposed Pool 2 <i>Basin Dakota S/320</i>				

Work Type Code N	Well Type Code M	Cable/Rotary R	Lease Type Code S	Ground Level Elevation 6266 GR ✓
Multiple Y	Proposed Depth 7493	Formation Mesaverde/Dakota	Contractor Not determined	Spud Date 3rd qtr, 1996

Proposed Casing and Cement Program

Well Size	Casing Size	Casing weight/foot	Setting Depth	Sacks of Cement	Estimated TOC
12 1/4	9 5/8	36#	200	188 cu.ft.	Surface
8 3/4	7	20#	3288	865 cu.ft.	Surface
6 1/4	4 1/2	10.5 & 11.6#	3188-7493	574 cu.ft.	3188

Describe the proposed program. If this application is to DEEPEN or PLUG BACK give the data on the present productive zone and proposed new productive zone. Describe the blowout prevention program, if any. Use additional sheets if necessary.

11" 2000 psi minimum double gate BOP

RECEIVED
SEP 26 1996

OIL CON. DIV.
DIST. 3

I hereby certify that the information given above is true and complete to the best of my knowledge and belief.

Signature: *Peggy Bradfield*
Printed name: Peggy Bradfield
Title: Regulatory Administrator
Date: 9-25-96
Phone: (505) 326-9700

OIL CONSERVATION DIVISION

Approved by: *Ernie Bush* 10-1-96
Title: *Ernie Bush*
Approved Date: _____ Expiration Date: _____
Conditions of Approval:
Attached

C-101 Instructions

Measurements and dimensions are to be in feet/inches. Well locations will refer to the New Mexico Principal Meridian.

IF THIS IS AN AMENDED REPORT CHECK THE BOX LABELED "AMENDED REPORT" AT THE TOP OF THIS DOCUMENT.

- | | | | |
|----------|--|----|---|
| 1 | Operator's OGRID number. If you do not have one it will be assigned and filled in by the District office. | 20 | Anticipated spud date. |
| 2 | Operator's name and address | 21 | Proposed hole size ID inches, proposed casing OD inch, casing weight in pounds per foot, setting depth of casing or depth and top of liner, proposed cement volume, and estimated top of cement |
| 3 | API number of this well. If this is a new drill the OCD will assign the number and fill this in. | 22 | Brief description of the proposed drilling program and program. Attach additional sheets if necessary. |
| 4 | Property code. If this is a new property the OCD will assign the number and fill it in. | 23 | The signature, printed name, and title of the person authorized to make this report. The date this report is signed and the telephone number to call for questions at this report. |
| 5 | Property name that used to be called 'well name' | | |
| 6 | The number of this well on the property. | | |
| 7 | The surveyed location of this well New Mexico Principal Meridian NOTE: If the United States government survey designates a Lot Number for this location use that number in the 'UL or lot no.' box. Otherwise use the OCD Unit Letter. | | |
| 8 | The proposed bottom hole location of this well at TD | | |
| 9 and 10 | The proposed pool(s) to which this well is being drilled. | | |
| 11 | Work type code from the following table:
N New well
E Re-entry
D Drill deeper
P Plugback
A Add a zone | | |
| 12 | Well type code from the following table:
O Single oil completion
G Single gas completion
M Multiple completion
I Injection well
S SWD well
W Water supply well
C Carbon dioxide well | | |
| 13 | Cable or rotary drilling code
C Propose to cable tool drill
R Propose to rotary drill | | |
| 14 | Lease type code from the following table:
S State
P Private | | |
| 15 | Ground level elevation above sea level | | |
| 16 | Intend to multiple completions? Yes or No | | |
| 17 | Proposed total depth of this well | | |
| 18 | Geologic formation at TD | | |
| 19 | Name of the intended drilling company if known. | | |

District I
 PO Box 1980, Hobbs, NM 88241-1980
 District II
 PO Drawer DD, Artesia, NM 88211-0719
 District III
 1000 Rio Hrasno Rd., Aztec, NM 87410
 District IV
 PO Box 2088, Santa Fe, NM 87504-2088

State of New Mexico
 Energy, Minerals & Natural Resources Department

OIL CONSERVATION DIVISION
 PO Box 2088
 Santa Fe, NM 87504-2088

Form C-102
 Revised February 21, 1994
 Instructions on back
 Submit to Appropriate District Office
 State Lease - 4 Copies
 Fee Lease - 3 Copies

AMENDED REPORT

WELL LOCATION AND ACREAGE DEDICATION PLAT

API Number 30-039-25592		Pool Code 72319/71599	Pool Name Blanco Mesaverde/Basin Dakota
Property Code 7465	Property Name San Juan 29-7 Unit		Well Number 129M
GRID No. 14538	Operator Name BURLINGTON RESOURCES OIL AND GAS COMPANY		Elevation 6266'

10 Surface Location

UL or lot no.	Section	Township	Range	Lot Ida	Feet from the	North/South line	Feet from the	East/West line	County
I	16	29 N	7 W		1850	South	1190	East	R.A.

11 Bottom Hole Location If Different From Surface

UL or lot no.	Section	Township	Range	Lot Ida	Feet from the	North/South line	Feet from the	East/West line	County

Dedicated Acres MV-E/320 OK S/320	Joint or Infill	Consolidation Code	Order No.
---	-----------------	--------------------	-----------

NO ALLOWABLE WILL BE ASSIGNED TO THIS COMPLETION UNTIL ALL INTERESTS HAVE BEEN CONSOLIDATED OR A NON-STANDARD UNIT HAS BEEN APPROVED BY THE DIVISION

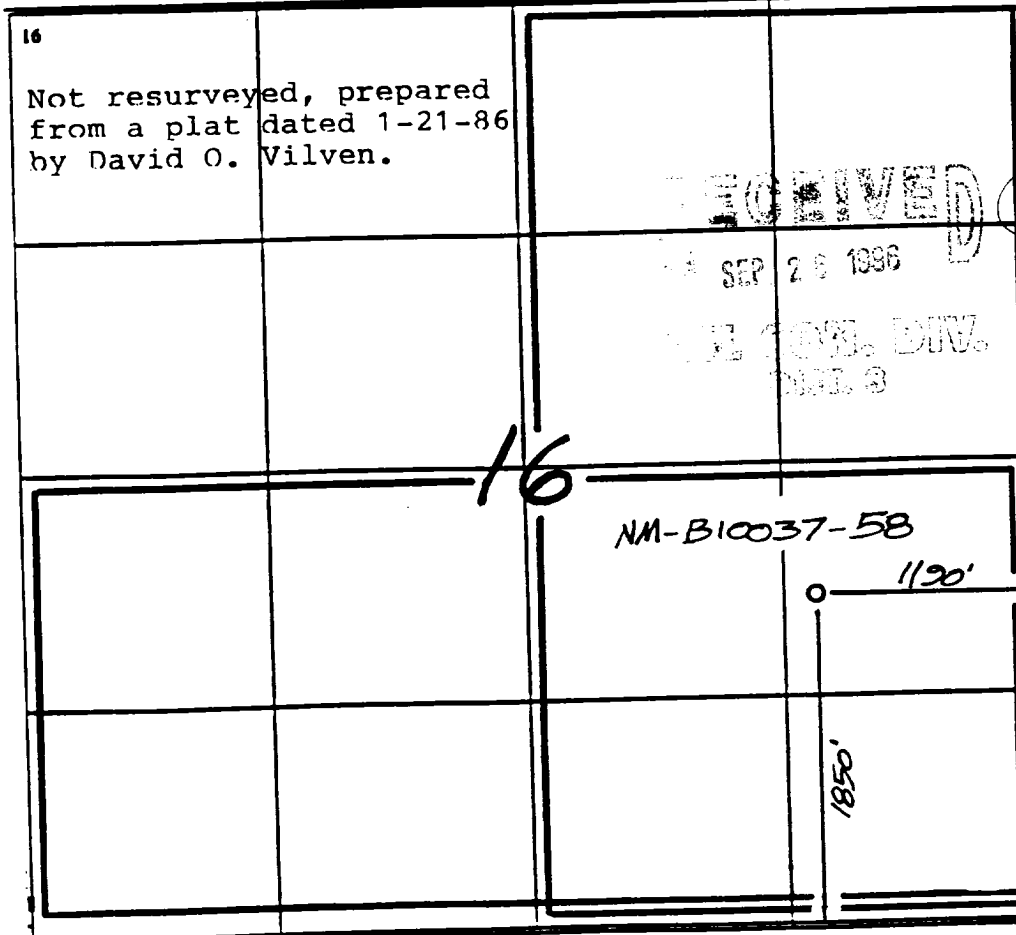

17 OPERATOR CERTIFICATION

I hereby certify that the information contained herein is true and complete to the best of my knowledge and belief

Peggy Bradford
 Signature
 Peggy Bradford
 Printed Name
 Regulatory Administrator
 Title
 9-25-96
 Date

18 SURVEYOR CERTIFICATION

I hereby certify that the well location shown on this plat was plotted from field notes of actual surveys made by me or under my supervision, and that the same is true and correct to the best of my belief.

9-9-96

Date of Survey
 Signature and Seal of Professional Surveyor

 Certificate Number