

NEW MEXICO OIL CONSERVATION COMMISSION
 WELL LOCATION AND ACREAGE DEDICATION PLAT

Form C-102
 Supersedes C-128
 Effective 1-1-65

All distances must be from the outer boundaries of the Section.

Operator EL PASO NATURAL GAS COMPANY		Lease FEUILLE (SF-080032-A)		Well No. 1 A
Unit Letter P	Section 13	Township 29-N	Range 9-W	County SAN JUAN
Actual Footage Location of Well: 925 feet from the SOUTH line and 800 feet from the EAST line				
Ground Level Elev. 6475	Producing Formation MESA VERDE	Pool BLANCO MESA VERDE	Dedicated Acreage: 303.92	Acres <input checked="" type="checkbox"/>

1. Outline the acreage dedicated to the subject well by colored pencil or hachure marks on the plat below.
2. If more than one lease is dedicated to the well, outline each and identify the ownership thereof (both as to working interest and royalty).
3. If more than one lease of different ownership is dedicated to the well, have the interests of all owners been consolidated by communitization, unitization, force-pooling, etc?

Yes No If answer is "yes," type of consolidation _____

If answer is "no," list the owners and tract descriptions which have actually been consolidated (Use reverse side of this form if necessary.) _____

No allowable will be assigned to the well until all interests have been consolidated (by communitization, unitization, forced-pooling, or otherwise) or until a non-standard unit, eliminating such interests, has been approved by the Commission. **NOTE: THIS PLAT REISSUED TO SHOW EXISTING MESA VERDE WELL. 2-25-75**

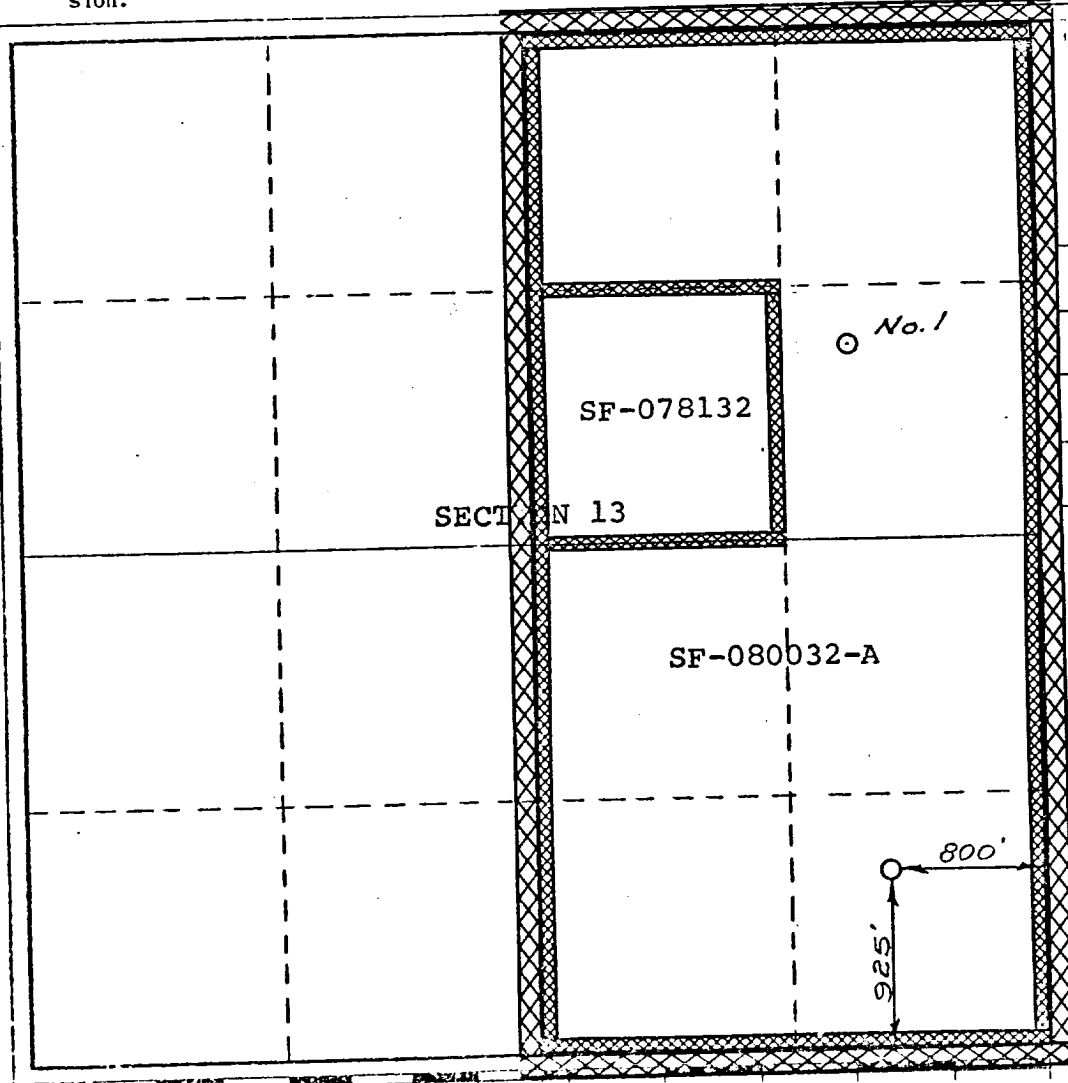

CERTIFICATION

I hereby certify that the information contained herein is true and complete to the best of my knowledge and belief.

Original Signed by

Name **D. C. Brisco**

Position _____

Company _____

Date _____

I hereby certify that the well location shown on this plat was plotted from field notes of actual surveys made by me or under my supervision, and that the same is true and correct to the best of my knowledge and belief.

Date Surveyed
DECEMBER 31, 1974

Registered Professional Engineer and/or Land Surveyor

[Signature]

Certificate No. **1760**

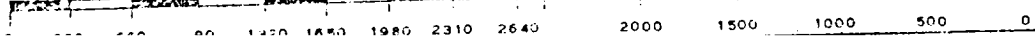

El Paso Natural Gas Company

El Paso, Texas 79978

February 20, 1975

ADDRESS REPLY TO
POST OFFICE BOX 959
FARMINGTON NEW MEXICO 87401

Mr. P. T. McGrath
U. S. Geological Survey
Post Office Box 959
Farmington, New Mexico 87401

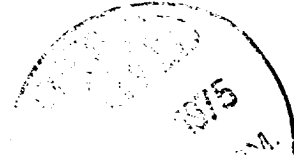

Re: Application for Permit to Drill
Feuille #1A
SESE/4 Section 13, T-29-N, R-9-W
Blanco Mesa Verde

Dear Mr. McGrath:

Details regarding existing roads, pipelines, wells, etc. relative to the above well location are included on the previously submitted base maps, "Field Road Map" and "Composite Map No. 1".

The proposed new well location, new roads and new pipeline are shown on the attached plat along with connecting existing roads and pipelines in the vicinity of the proposed new well.

Water for drilling and completion operations will be obtained from the following location: water well located in SESW 9-29-8.

Waste material will be disposed of by burial in the burn pit, latrine, or reserve pit as applicable. There will be no camp nor air strip associated with drilling this well. Upon completion or abandonment of this well, the location will be cleaned and leveled and a dry hole marker placed, if applicable.

Yours very truly,

A handwritten signature in cursive script that reads "D. G. Brisco".

D. G. Brisco
Drilling Clerk

pb

FEB 20 1975

FEUILLE NO. 1A DE SIE 13, T-29-A, R-9-00

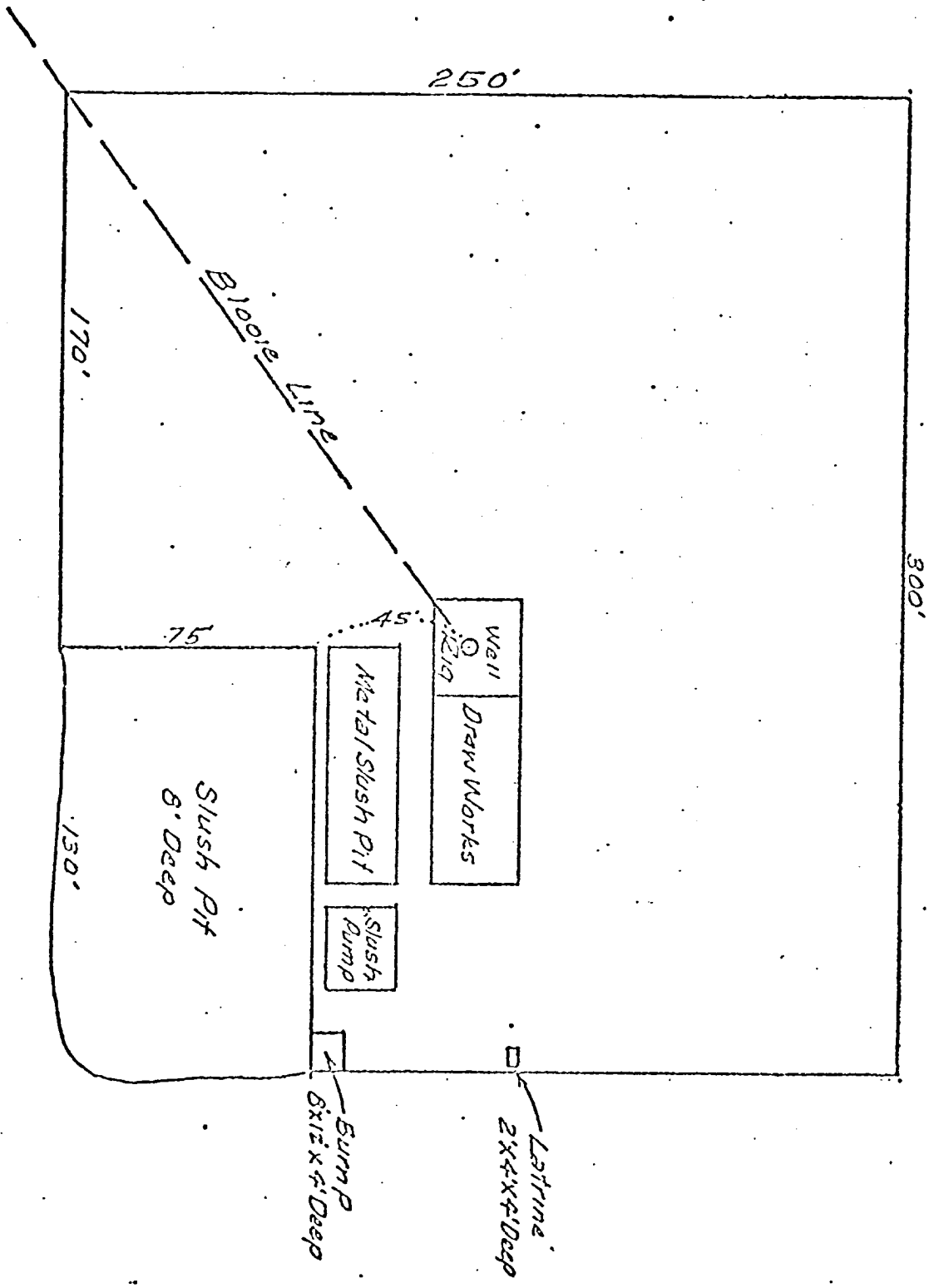

Levelling #1a
SE 1/4 Sec. 13, T-29-N, R-9-W

R-9-W

1
29
N

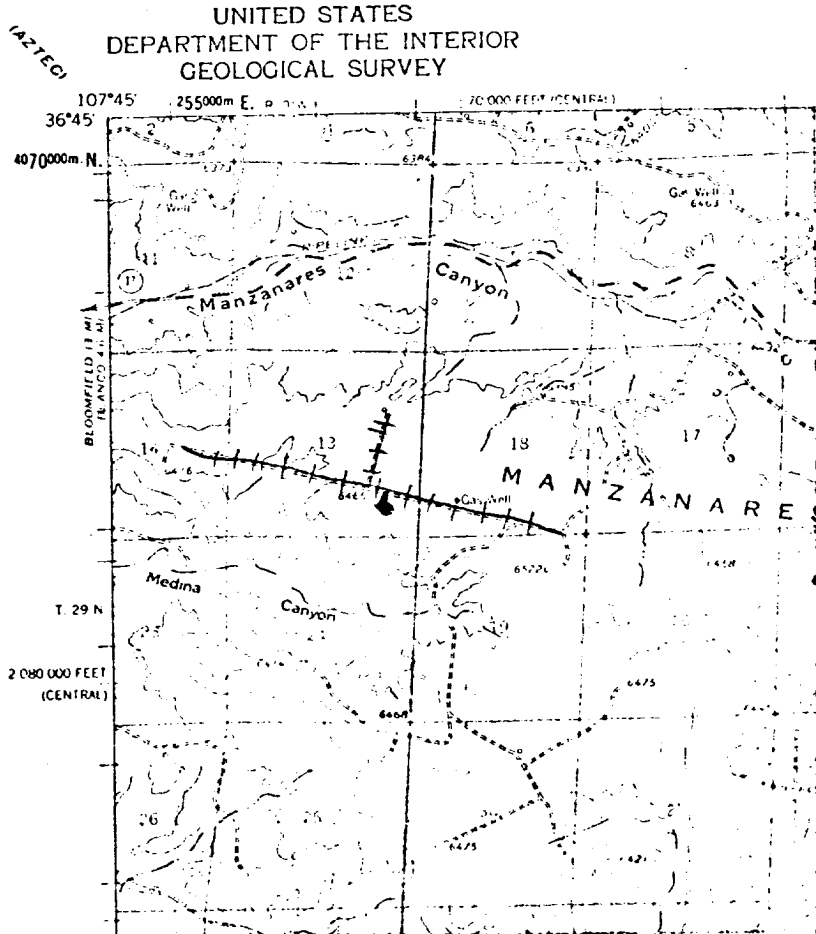

LEGEND OF RIGHT-OF-WAYS

- EXISTING ROADS
- EXISTING PIPELINES
- EXISTING ROAD & PIPELINE
- PROPOSED ROADS
- PROPOSED PIPELINES
- PROPOSED ROAD & PIPELINE