

OIL CONSERVATION COMMISSION
San Antonio DISTRICT

OIL CONSERVATION COMMISSION
BOX 2088
SANTA FE, NEW MEXICO

DATE 12-26-77

RE: Proposed MC _____
Proposed DHC _____
Proposed NSL _____
Proposed SWD _____
Proposed WFX _____
Proposed PMX _____

Gentlemen:

I have examined the application dated 12-26-77
for the Operator Lease and Well No. Unit, S-T-R

and my recommendations are as follows:

Yours very truly,

MR. Lyndell

El Paso NATURAL GAS
COMPANY

P. O. BOX 990
FARMINGTON, NEW MEXICO 87401
PHONE: 505-325-2841

October 20, 1977

Mr. Joe Ramey
New Mexico Oil Conservation Commission
Post Office Box 2088
Santa Fe, New Mexico 87501

Dear Mr. Ramey:

This is a request for administrative approval for an unorthodox gas well location in the Blanco Mesa Verde pool.

It is intended to locate the El Paso Natural Gas Company's El Paso #1A well at 500' from the North line and 1840' from the West line of Section 20, T-29-N, R-9-W, San Juan County, New Mexico.

Largo Canyon and Largo Wash cover most of the northern half of this section, making it impossible to build an orthodox gas well location.

All operators of proration units offsetting the proposed unorthodox location have been notified of this application by certified mail.

Plats showing the proposed well location and the terrain of Section 20, along with an ownership plat, are attached.

Yours truly,



D. R. Read
Division Drilling Engineer

DRR:pb



Well Name El Paso #1 A, Blanco Mesaverde

Footage---- 500' FNL, 1840' FWL

APPLICATION FOR NON-STANDARD LOCATION

County San Juan

State 2 New Mexico

Section 20 Township 29N

Range 9W

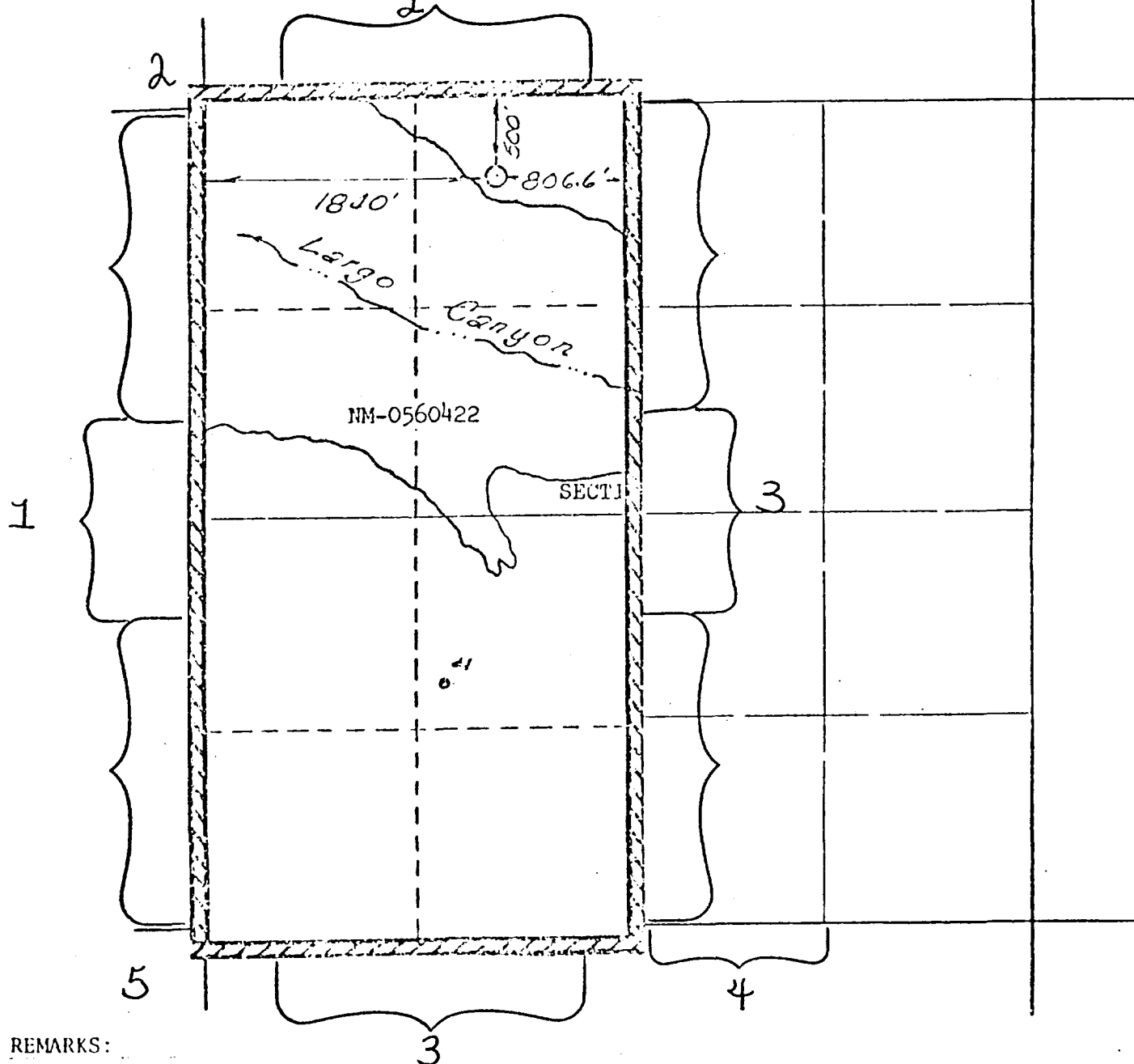

REMARKS:

- (1) El Paso Natural Gas Company
- (2) Amoco
- (3) Tenneco Oil Company
- (4) D. J. Simmons
- (5) Aztec Oil & Gas Company

NEW MEXICO OIL CONSERVATION COMMISSION
WELL LOCATION AND ACREAGE DEDICATION PLAT

Form C-102
 Supersedes C-128
 Effective 1-1-65

All distances must be from the outer boundaries of the Section.

Operator EL PASO NATURAL GAS COMPANY		Lease EL PASO (NM-0560422)		Well No. 1A
Unit Letter C	Section 20	Township 29-N	Range 9-W	County SAN JUAN
Actual Footage Location of Well: <div style="display: flex; justify-content: space-between;"> 500 feet from the NORTH line and 1840 feet from the WEST line </div>				
Ground Level Elev. 5559	Producing Formation MESA VERDE	Pool BLANCO MESA VERDE	Dedicated Acreage: 320.00 Acres	

1. Outline the acreage dedicated to the subject well by colored pencil or hachure marks on the plat below.
2. If more than one lease is dedicated to the well, outline each and identify the ownership thereof (both as to working interest and royalty).
3. If more than one lease of different ownership is dedicated to the well, have the interests of all owners been consolidated by communitization, unitization, force-pooling, etc?

☐ Yes ☐ No If answer is "yes," type of consolidation _____

If answer is "no," list the owners and tract descriptions which have actually been consolidated. (Use reverse side of this form if necessary.) _____

No allowable will be assigned to the well until all interests have been consolidated (by communitization, unitization, forced-pooling, or otherwise) or until a non-standard unit, eliminating such interests, has been approved by the Commission. **THIS PLAT REISSUED TO SHOW REVISED NOMENCLATURE. 9-6-77**

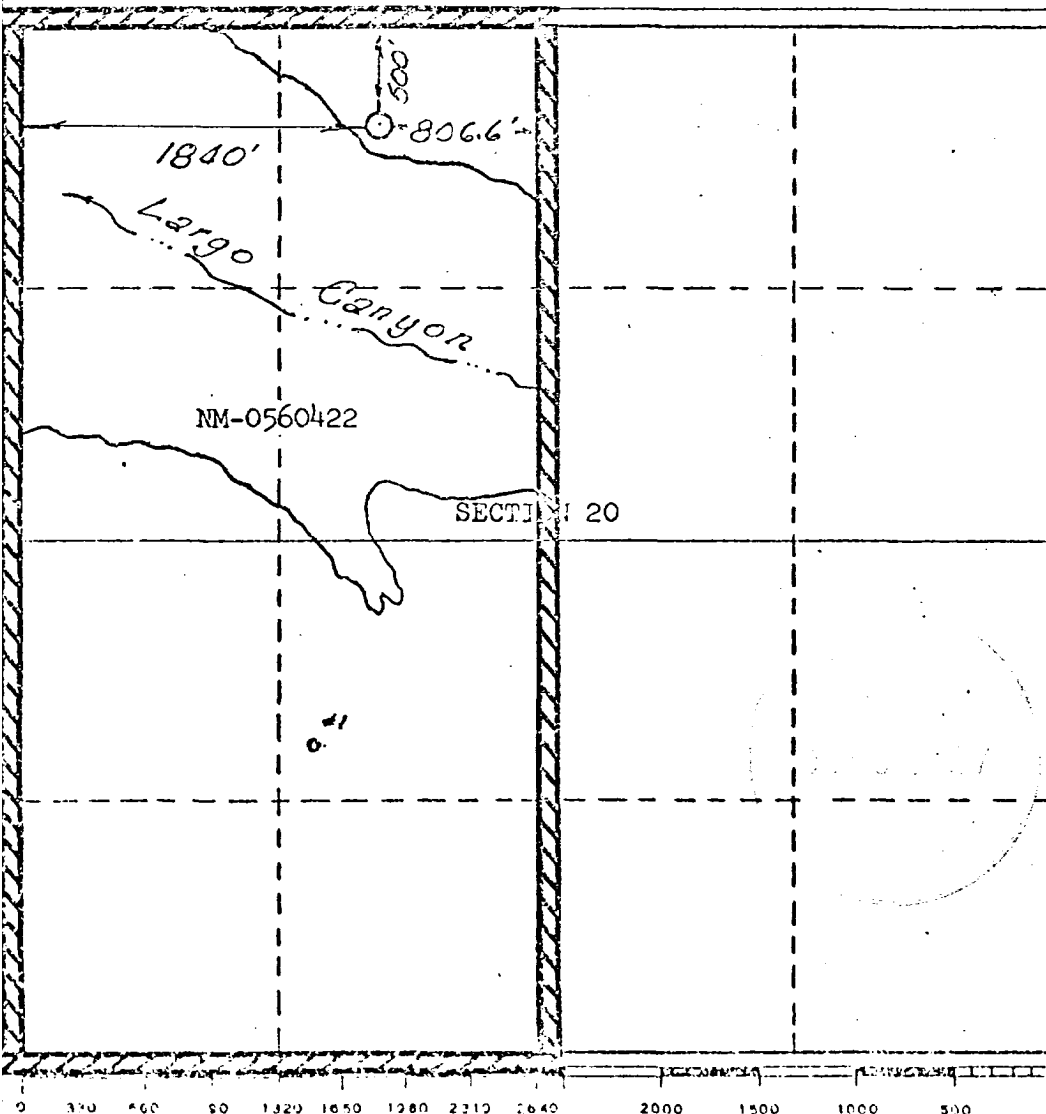

CERTIFICATION	
I hereby certify that the information contained herein is true and complete to the best of my knowledge and belief. Original Signed by D. G. Brisco	
Name	
Drilling Clerk	
Position	
El Paso Natural Gas Co.	
Company	
October 20, 1977	
Date	
I hereby certify that the well location shown on this plat was plotted from field notes of actual surveys made by me or under my supervision, and that the same is true and correct to the best of my knowledge and belief.	
Date Surveyed	AUGUST 28, 1977
Registered Professional Engineer and/or Land Surveyor	<i>[Signature]</i>
Certificate No.	1760

UNITED STATES
DEPARTMENT OF THE INTERIOR
GEOLOGICAL SURVEY

APPLICATION FOR PERMIT TO DRILL, DEEPEN, OR PLUG BACK

1a. TYPE OF WORK

DRILL ☒DEEPEN ☐PLUG BACK ☐

b. TYPE OF WELL

OIL
WELL ☐GAS
WELL ☒OTHER ☐SINGLE
ZONE ☒MULTIPLE
ZONE ☐

2. NAME OF OPERATOR

El Paso Natural Gas Company

3. ADDRESS OF OPERATOR

PO Box 990, Farmington, NM 87401

4. LOCATION OF WELL (Report location clearly and in accordance with any State requirements.*)

At surface

500'N, 1840'W

At proposed prod. zone

14. DISTANCE IN MILES AND DIRECTION FROM NEAREST TOWN OR POST OFFICE*

15. DISTANCE FROM PROPOSED*

LOCATION TO NEAREST
PROPERTY OR LEASE LINE, FT.
(Also to nearest drlg. unit line, if any)18. DISTANCE FROM PROPOSED LOCATION*
TO NEAREST WELL, DRILLING, COMPLETED,
OR APPLIED FOR, ON THIS LEASE, FT.

16. NO. OF ACRES IN LEASE

19. PROPOSED DEPTH

4720'

17. NO. OF ACRES ASSIGNED
TO THIS WELL

320.00

20. ROTARY OR CABLE TOOLS

Rotary

21. ELEVATIONS (Show whether DF, RT, GR, etc.)

5559'GL

22. APPROX. DATE WORK WILL START*

23.

PROPOSED CASING AND CEMENTING PROGRAM

SIZE OF HOLE	SIZE OF CASING	WEIGHT PER FOOT	SETTING DEPTH	QUANTITY OF CEMENT
13 3/4"	9 5/8"	32.3#	200'	224 cu.ft. to circulate
8 3/4"	7"	20.0#	2325'	322 cu.ft. to cover Ojo Alamo
6 1/4"	4 1/2" liner	10.5#	2175-4720'	443 cu.ft. to fill to 2175'

Selectively perforate and sandwater fracture the Mesa Verde formation.

A 3000 psi WP and 6000 psi test double gate preventer equipped with blind and pipe rams will be used for blow out prevention on this well.

This gas is dedicated.

The W/2 of Section 20 is dedicated to this well.

IN ABOVE SPACE DESCRIBE PROPOSED PROGRAM: If proposal is to deepen or plug back, give data on present productive zone and proposed new productive zone. If proposal is to drill or deepen directionally, give pertinent data on subsurface locations and measured and true vertical depths. Give blowout preventer program, if any.

24.

SIGNED D. G. Guice TITLE Drilling Clerk DATE 10-20-77

(This space for Federal or State office use)

PERMIT NO. _____ APPROVAL DATE _____

APPROVED BY _____ TITLE _____ DATE _____

CONDITIONS OF APPROVAL, IF ANY:

*See Instructions On Reverse Side

5. LEASE DESIGNATION AND SERIAL NO.

NM 0560422

6. IF INDIAN, ALLOTTEE OR TRIBE NAME

7. UNIT AGREEMENT NAME

8. FARM OR LEASE NAME

El Paso

9. WELL NO.

1A

10. FIELD AND POOL, OR WILDCAT

Blanco Mesa Verde

11. SEC., T., R., M., OR BLK.

AND SURVEY OR AREA

Sec. 20, T-29-N, R-9-W

NMPM

12. COUNTY OR PARISH

San Juan

13. STATE

NM