

NO. OF COPIES RECEIVED	5
DISTRIBUTION	
SANTA FE	1
FILE	1
U.S.G.S.	2
LAND OFFICE	
OPERATOR	1

# NEW MEXICO OIL CONSERVATION COMMISSION

30-045-23204  
Form C-101  
Revised 1-1-65

EXPIRES 11-15-78

5A. Indicate Type of Lease	
STATE <input type="checkbox"/>	FEE <input checked="" type="checkbox"/>

5. State Oil & Gas Lease No.

## APPLICATION FOR PERMIT TO DRILL, DEEPEN, OR PLUG BACK

1a. Type of Work		7. Unit Agreement Name	
b. Type of Well DRILL <input checked="" type="checkbox"/> DEEPEN <input type="checkbox"/> PLUG BACK <input type="checkbox"/> OIL WELL <input type="checkbox"/> GAS WELL <input checked="" type="checkbox"/> OTHER <input type="checkbox"/> SINGLE ZONE <input checked="" type="checkbox"/> MULTIPLE ZONE <input type="checkbox"/>		8. Farm or Lease Name Ulibarri Gas Com 2	
2. Name of Operator AMOCO PRODUCTION COMPANY		9. Well No. 1	
3. Address of Operator 501 AIRPORT DRIVE, FARMINGTON, NEW MEXICO 87401		10. Field and Pool, or Wildcat Basin Dakota	
4. Location of Well UNIT LETTER D LOCATED 800 FEET FROM THE North LINE AND 1015 FEET FROM THE West LINE OF SEC. 2 TWP. 29 N RGE. 9 W NMPM		12. County San Juan	
21. Elevations (Show whether DF, RT, etc.) 5610' GL		19. Proposed Depth 6770	19A. Formation Dakota
21A. Kind & Status Plug. Bond Statewide	21B. Drilling Contractor Unknown	20. Rotary or C.T. Rotary	
22. Approx. Date Work will start Within 90 days			

23.

### PROPOSED CASING AND CEMENT PROGRAM

SIZE OF HOLE	SIZE OF CASING	WEIGHT PER FOOT	SETTING DEPTH	SACKS OF CEMENT	EST. TOP
12 1/4"	9 5/8"	36#	300'	125 sx	Circ
8 3/4"	7 "	26#	2400'	200 sx	Circ
6 3/4"	4 1/2"	13.5#	6770'	600 sx	Circ

The above well is being drilled to further develop the Basin Dakota Field. The well will be drilled with a low solids non-dispersed mud system. Completion design will be based on open hole logs. Copy of all logs will be filed upon completion. Amoco's standard blowout prevention will be employed; see attached drawing for blowout preventer design.

Upon completion, the well location will be cleaned up and the reserve pit filled and leveled.

Gas produced from this well is dedicated to El Paso Natural Gas Co.

AUG 17 1978  
OIL CON. COM.  
DIST. 3

IN ABOVE SPACE DESCRIBE PROPOSED PROGRAM: IF PROPOSAL IS TO DEEPEN OR PLUG BACK, GIVE DATA ON PRESENT PRODUCTIVE ZONE AND PROPOSED NEW PRODUCTIVE ZONE. GIVE BLOWOUT PREVENTER PROGRAM, IF ANY.

I hereby certify that the information above is true and complete to the best of my knowledge and belief.

Signed [Signature] Title Area Engineer Date 8/17/78

(This space for State Use)

APPROVED BY [Signature] TITLE DEPUTY COMMISSIONER DATE AUG 17 1978

CONDITIONS OF APPROVAL, IF ANY:

**NEW MEXICO OIL CONSERVATION COMMISSION  
WELL LOCATION AND ACREAGE DEDICATION PLAT**

Form C-102  
Supersedes C-120  
Effective 1-1-65

All distances must be from the outer boundaries of the Section.

Operator <b>AMOCO PRODUCTION COMPANY</b>			Lease <b>ULIBARRI GAS COM 2</b>		Well No. <b>1</b>
Unit Letter <b>D</b>	Section <b>2</b>	Township <b>29N</b>	Range <b>9W</b>	County <b>San Juan</b>	
Actual Footage Location of Well: <b>800</b> feet from the <b>North</b> line and <b>1015</b> feet from the <b>West</b> line					
Ground Level Elev. <b>5611</b>	Producing Formation <b>Dakota</b>	Pool <b>Basin Dakota</b>		Dedicated Acreage: <b>32.4</b> Acres	

1. Outline the acreage dedicated to the subject well by colored pencil or hachure marks on the plat below.
2. If more than one lease is dedicated to the well, outline each and identify the ownership thereof (both as to working interest and royalty).
3. If more than one lease of different ownership is dedicated to the well, have the interests of all owners been consolidated by communitization, unitization, force-pooling, etc?

☐ Yes ☐ No If answer is "yes," type of consolidation \_\_\_\_\_

If answer is "no," list the owners and tract descriptions which have actually been consolidated. (Use reverse side of this form if necessary.) \_\_\_\_\_

No allowable will be assigned to the well until all interests have been consolidated (by communitization, unitization, forced-pooling, or otherwise) or until a non-standard unit, eliminating such interests, has been approved by the Commission.

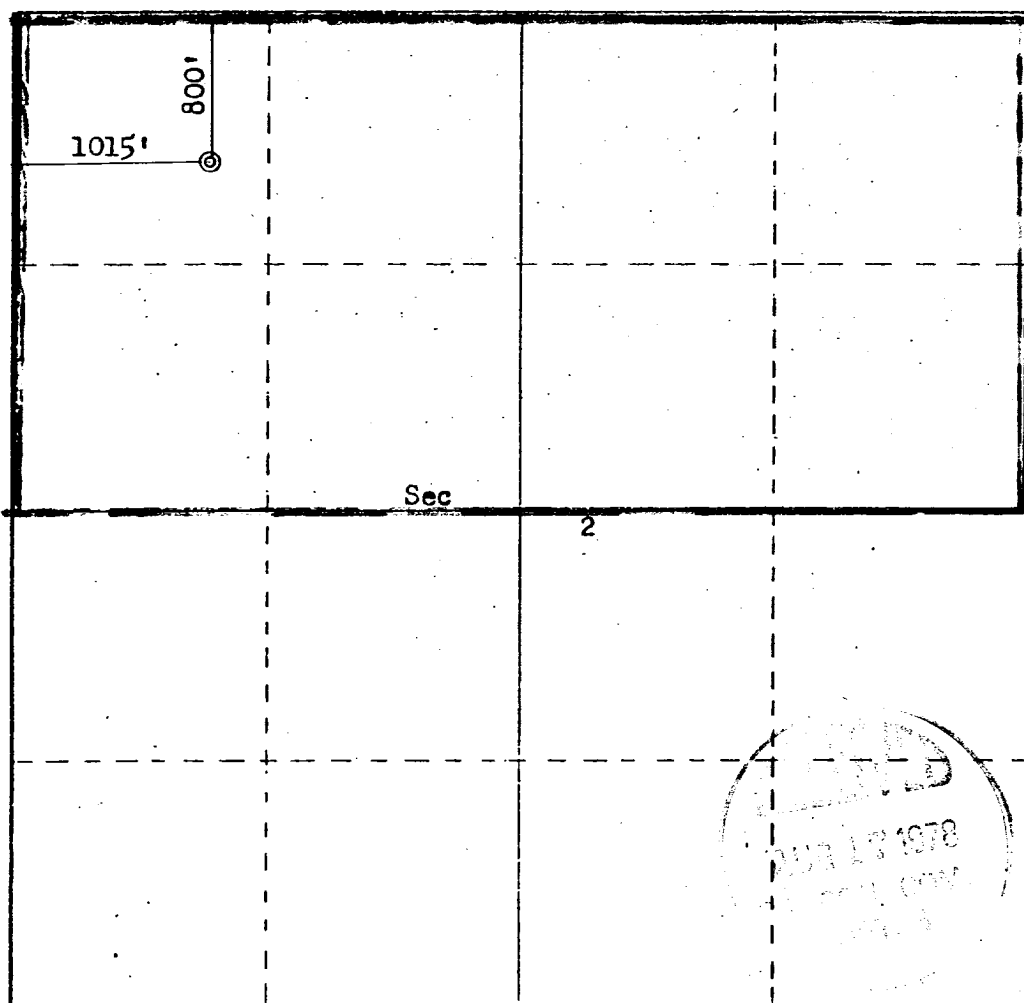

**CERTIFICATION**

I hereby certify that the information contained herein is true and complete to the best of my knowledge and belief.

Name  
**J. L. KRUPKA**  
Position  
**AREA ENGINEER**  
Company  
**AMOCO PRODUCTION COMPANY**  
Date  
**AUGUST 9, 1978**

I hereby certify that the well location shown on this plat was plotted from field notes of actual surveys made by me or under my supervision, and that the same is true and correct to the best of my knowledge and belief.

Date Surveyed  
**August 7, 1978**  
Registered Professional Engineer  
and or Land Surveyor  
**Fred B. Kerr, Jr.**  
Certified  
**3950**

0 330 660 990 1320 1650 1980 2310 2540 2000 1800 1000 800 0

# BLOWOUT PREVENTER HOOKUP

