

UNITED STATES
DEPARTMENT OF THE INTERIOR
BUREAU OF LAND MANAGEMENT

RECEIVED
JUL 10 1995

APPLICATION FOR PERMIT TO DRILL, DEEPEN, OR PLUG BACK

OIL CON. DIV.
DIST. 3

1a. Type of Work DRILL	5. Lease Number SF-080538 Unit Reporting Number
1b. Type of Well GAS	6. If Indian, All. or Tribe
2. Operator MERIDIAN OIL 014538	7. Unit Agreement Name San Juan 30-5 Unit
3. Address & Phone No. of Operator PO Box 4289, Farmington, NM 87499 (505) 326-9700	8. Farm or Lease Name 172400 San Juan 30-5 Unit 9. Well Number 255
4. Location of Well 910' FSL, 790' FWL Latitude 36° 48' 29", Longitude 107° 19' 57"	10. Field, Pool, Wildcat 71629 Basin Fruitland Coal 11. Sec., Twn, Rge, Mer. (NMPM) M Sec 14, T-30-N, R-5-W API # 30-039-25532
14. Distance in Miles from Nearest Town 8 miles to Gobernador	12. County Rio Arriba 13. State NM
15. Distance from Proposed Location to Nearest Property or Lease Line 790'	17. Acres Assigned to Well 320 W/2
16. Acres in Lease	
18. Distance from Proposed Location to Nearest Well, Drlg, Compl, or Applied for on this Lease 2400'	
19. Proposed Depth 3280'	20. Rotary or Cable Tools Rotary
21. Elevations (DF, FT, GR, Etc.) 6520' GR	22. Approx. Date Work will Start 2nd quarter 1995
23. Proposed Casing and Cementing Program See Operations Plan attached This action is subject to technical and procedural review pursuant to 43 CFR 3165.3 and appeal pursuant to 43 CFR 3165.4.	DRILLING OPERATIONS AUTHORIZED ARE SUBJECT TO COMPLIANCE WITH ATTACHED "GENERAL REQUIREMENTS"
24. Authorized by: [Signature] Regional Drilling Engineer	1/13/95 Date

PERMIT NO. _____ APPROVAL DATE _____
APPROVED BY _____ TITLE _____ DATE _____

Archaeological Report to be submitted by Arboles Contract Archaeology
Threatened and Endangered Species Report done by U.S. Forest
NOTE: This format is issued in lieu of U.S. BLM Form 3160-3

APPROVED
AS AMENDED

JUL 06 1995

DISTRICT MANAGER

MMCCD

District I
PO Box 1980, Hobbs, NM 88241-1980
District II
PO Drawer DD, Artesia, NM 88211-0719
District III
1000 Rio Brazos Rd., Aztec, NM 87410
District IV
PO Box 2088, Santa Fe, NM 87504-2088

State of New Mexico
Energy, Minerals & Natural Resources Department

OIL CONSERVATION DIVISION
PO Box 2088
Santa Fe, NM 87504-2088

Form C
Revised February 21.
Instructions on
Submit to Appropriate District C
State Lease - 4 C.
Fee Lease - 3 C.

☐ AMENDED REP

WELL LOCATION AND ACREAGE DEDICATION PLAT

API Number <u>30-039-25532</u>	Pool Code 71629	Pool Name Basin Fruitland Coal
Property Code <u>17260</u>	Property Name SAN JUAN 30-5 UNIT	Well Number 255
OGRID No. 14538	Operator Name MERIDIAN OIL INC.	Elevation 6520

10 Surface Location

UL or lot no.	Section	Township	Range	Lot Ida	Feet from the	North/South line	Feet from the	East/West line	County
M	14	30N	5W		910	SOUTH	790	WEST	R.A.

11 Bottom Hole Location If Different From Surface

UL or lot no.	Section	Township	Range	Lot Ida	Feet from the	North/South line	Feet from the	East/West line	County

12 Dedication Acres: W/320 13 Joint or Infill: 14 Consolidation Code: 15 Order No.

NO ALLOWABLE WILL BE ASSIGNED TO THIS COMPLETION UNTIL ALL INTERESTS HAVE BEEN CONSOLIDATED OR A NON-STANDARD UNIT HAS BEEN APPROVED BY THE DIVISION

	17 OPERATOR CERTIFICATE I hereby certify that the information contained here is true and complete to the best of my knowledge and belief. Signature: <u>Peggy Bradfield</u> Printed Name: <u>Peggy Bradfield</u> Title: <u>Regulatory Affairs</u> Date: <u>1-9-95</u>
	18 SURVEYOR CERTIFICATE I hereby certify that the well location shown on this was plotted from field notes of actual surveys made or under my supervision, and that the same is true correct to the best of my belief. Date of Survey: <u>11-15-94</u> Signature and Title of Professional Surveyor: <u>NEALE C. EDWARDS</u> Certificate Number: <u>8857</u>

OPERATIONS PLAN

Well Name: San Juan 30-5 Unit #255
Location: 910'FSL, 790'FWL Section 14, T-30-N, R-5-W
 Rio Arriba County, New Mexico
Formation: Basin Fruitland Coal
Elevation: 6520'GL

Formation:	Top	Bottom	Contents
Surface	San Jose	2588'	
Ojo Alamo	2588'	3148'	aquifer
Fruitland	3148'	3294'	
Intermediate TD	3158'		
Fruitland Coal Top	3148'	3260'	gas & salt water
Pictured Cliffs	3294'		
Total Depth	3280'		

Logging Program: Mud logs from intermediate to Total Depth.

Mud Program:

Interval	Type	Weight	Vis.	Fluid Loss
0- 200'	Spud	8.4-8.9	40-50	no control
200-3158'	Non-dispersed	8.4-9.1	30-60	no control
3158-3280'	Formation Water	8.4		no control
3234-3254'	Calcium Chloride for pressure coring interval			

Casing Program:

Hole Size	Depth Interval	Csg.Size	Wt.	Grade
12 1/4"	0' - 200'	9 5/8"	32.3#	H-40
8 3/4"	0' - 3158'	7"	20.0#	K-55
6 1/4"	3008' - 3280'	5 1/2"	15.5#	K-55

Coring Program: pressure core 3234-54'

Tubing Program:

0' - 3280' 2 3/8" 4.7# J-55

Float Equipment: 9 5/8" surface casing - saw tooth guide shoe. Centralizers will be run in accordance with Onshore Order #2.

7" intermediate casing - guide shoe and self-fill insert float valve. Three centralizers run every other joint above shoe. Run insert float one joint above guide shoe. Two turbolizing type centralizers - one below and one into the base of the Ojo Alamo @ 3148'. Standard centralizers thereafter every fourth joint up to the base of the surface pipe.

5 1/2" production casing - float shoe on bottom and pre-drilled liner run to the 7" casing with a minimum 50' overlap. Liner hanger is a double slip grip type.

Wellhead Equipment: 9 5/8" x 7" x 2 3/8" x 11" 3000 psi xmas tree assembly.

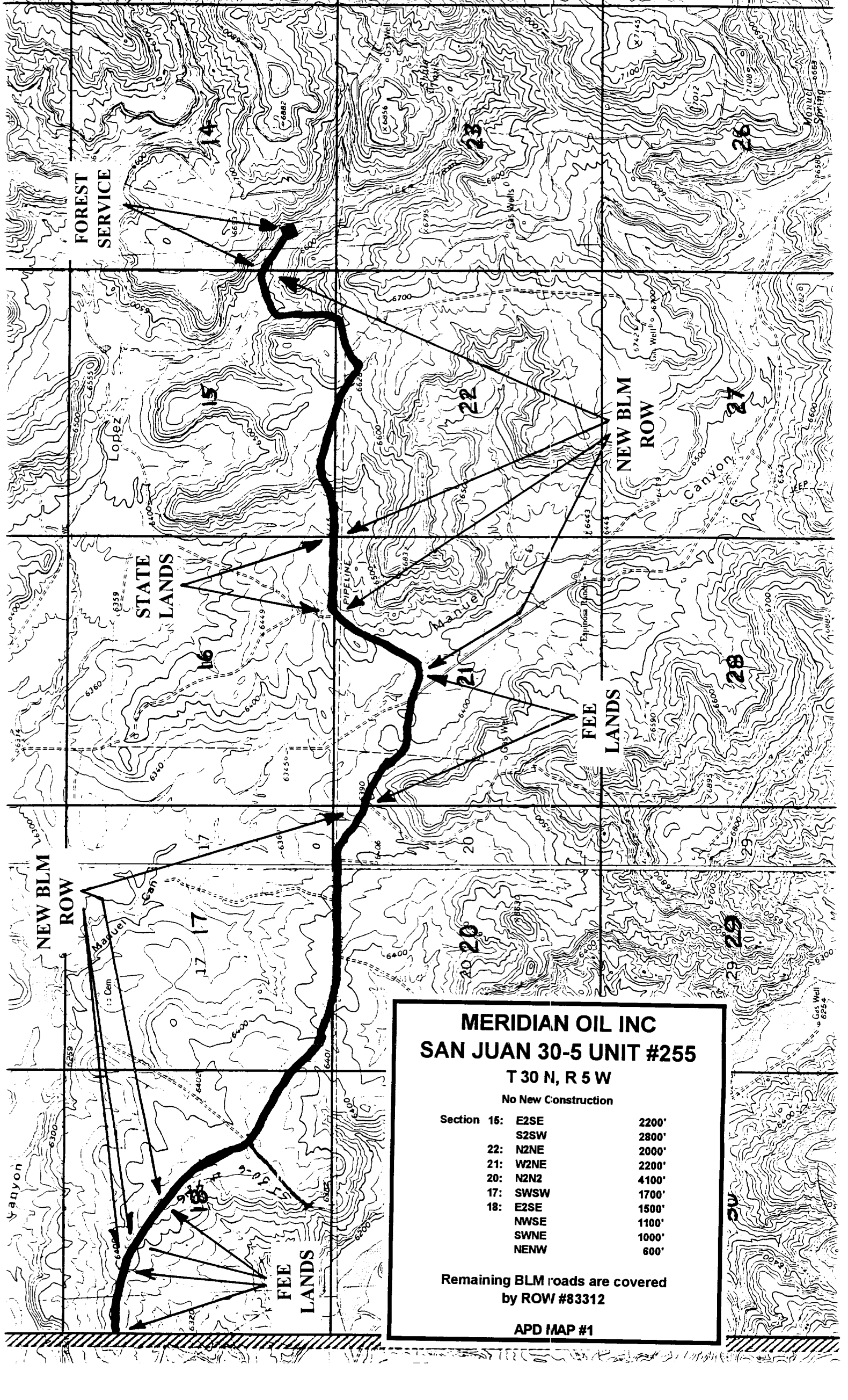

MERIDIAN OIL INC
SAN JUAN 30-5 UNIT #255

T 30 N, R 5 W
No New Construction

Section 15:	E2SE	2200'
	S2SW	2800'
22:	N2NE	2000'
	W2NE	2200'
20:	N2N2	4100'
17:	SWSW	1700'
18:	E2SE	1500'
	NWSE	1100'
	SWNE	1000'
	NENW	600'

Remaining BLM roads are covered
by ROW #83312