

(SUBMIT IN TRIPLICATE)

UNITED STATES  
DEPARTMENT OF THE INTERIOR  
GEOLOGICAL SURVEY

Land Office Santa Fe

Lease No. SF 080724

Unit SE/4 SW/4 Sec. 33, T-29N  
R-10W, N.M.P.M.

## SUNDRY NOTICES AND REPORTS ON WELLS

NOTICE OF INTENTION TO DRILL	<input checked="" type="checkbox"/>	SUBSEQUENT REPORT OF WATER SHUT-OFF	
NOTICE OF INTENTION TO CHANGE PLANS		SUBSEQUENT REPORT OF SHOOTING OR ACIDIZING	
NOTICE OF INTENTION TO TEST WATER SHUT-OFF		SUBSEQUENT REPORT OF ALTERING CASING	
NOTICE OF INTENTION TO RE-DRILL OR REPAIR WELL		SUBSEQUENT REPORT OF RE-DRILLING OR REPAIR	
NOTICE OF INTENTION TO SHOOT OR ACIDIZE		SUBSEQUENT REPORT OF ABANDONMENT	
NOTICE OF INTENTION TO PULL OR ALTER CASING		SUPPLEMENTARY WELL HISTORY	
NOTICE OF INTENTION TO ABANDON WELL			

(INDICATE ABOVE BY CHECK MARK NATURE OF REPORT, NOTICE, OR OTHER DATA)

December 30, 19 59

Well No. #13/ Zachry is located 1100 ft. from S line and 1450 ft. from W line of sec. 33  
SE/4 SW/4 33 29N 10W N.M.P.M.  
(1/4 Sec. and Sec. No.) (Twp.) (Range) (Meridian)  
Astac - Pictured Cliffs San Juan New Mexico  
(Field) (County or Subdivision) (State or Territory)

The elevation of the derrick floor above sea level is 5796 ft.

### DETAILS OF WORK

(State names of and expected depths to objective sands; show sizes, weights, and lengths of proposed casings; indicate mudding jobs, cementing points, and all other important proposed work)

The objective Sand is the Pictured Cliffs Formation anticipated at approx. 2100 Feet.

Proposed Casing Program: 100' 9-5/8" OD., 32.30#, H-40, Cemented to surface.  
2100' 5" OD., 15.50#, J-55, Cemented with 100 sacks.

Rotary tools will be employed from surface to T.D. Pipe will be set through the Pictured Cliffs Formation.

Anticipated that this well will be dual completed in the Fruitland-Pictured Cliffs Formation.

Estimated T.D. 2116 Feet.

The well will be sand fraced in an effort to stimulate production.

I understand that this plan of work must receive approval in writing by the Geological Survey before operations may be commenced.

Company SOUTHERN UNION GAS COMPANY

Address 1001 Burt Building

1700 Patterson Street

Dallas, Texas

By Vernon J. Lowe  
Drilling Superintendent

Title

NEW MEXICO OIL CONSERVATION COMMISSION  
Well Location and Acreage Dedication Plat

Section A.

Date December 7, 1959

Operator Southern Union Gas Company Lease Zachry  
Well No. 13 Unit Letter N Section 33 Township 29 North Range 10 West, NMPM  
Located 1100 Feet From South Line, 1450 Feet From West Line  
County San Juan G. L. Elevation 5786 Dedicated Acreage 160 Acres  
Name of Producing Formation Pictured Cliffs Pool Astac - Pictured Cliffs

1. Is the Operator the only owner\* in the dedicated acreage outlined on the plat below?  
Yes X No       .
2. If the answer to question one is "no," have the interests of all the owners been consolidated by communitization agreement or otherwise? Yes        No       . If answer is "yes," Type of Consolidation
3. If the answer to question two is "no," list all the owners and their respective interests below:

Owner

Land Description

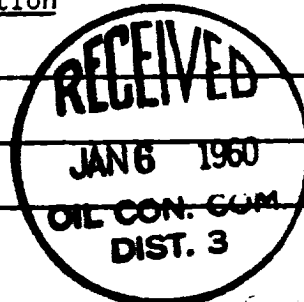

Section B

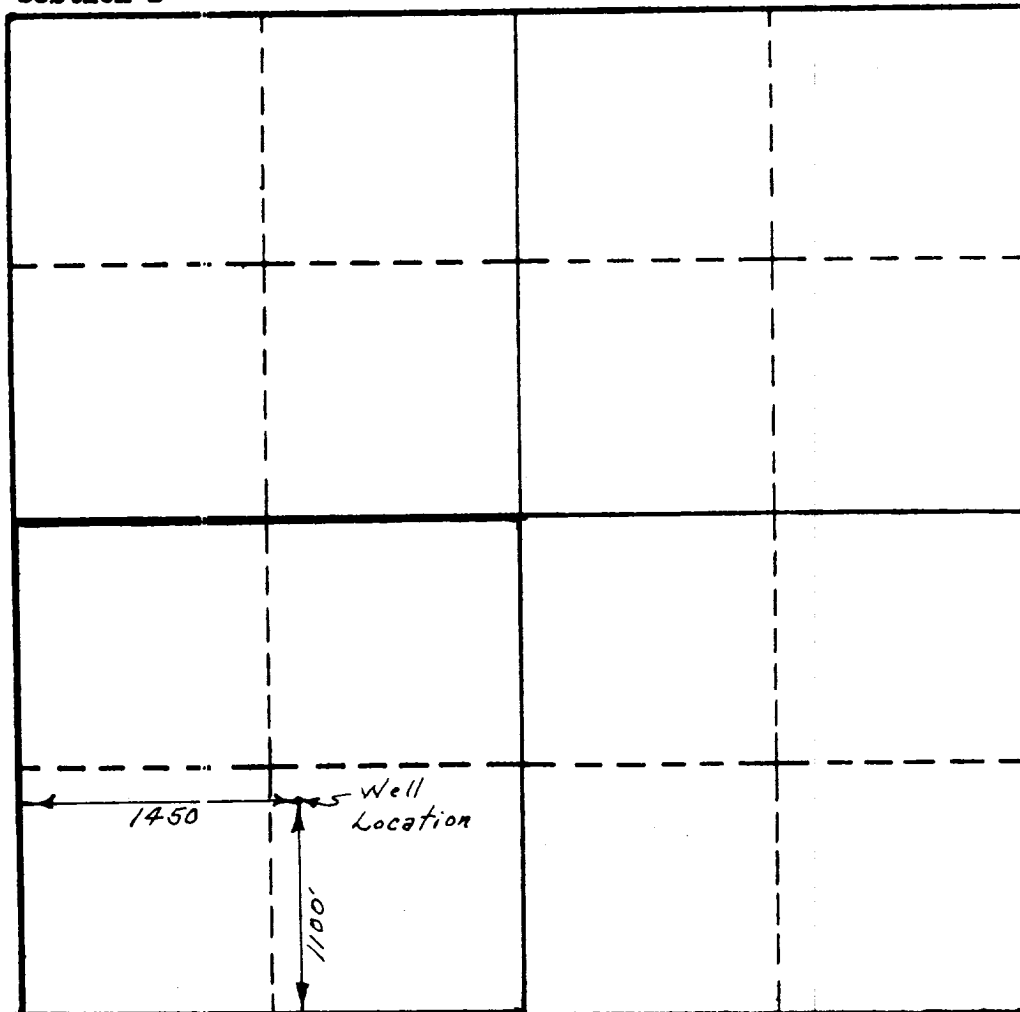

This is to certify that the information in Section A above is true and complete to the best of my knowledge and belief.

SOUTHERN UNION GAS COMPANY

(Operator)  
Verdon J. Lowe  
(Representative)

Box 815, Farmington, New Mex.  
Address

This is to certify that the well location shown on the plat in Section B was plotted from field notes of actual surveys made by me or under my supervision and that the same is true and correct to the best of my knowledge and belief.

Date Surveyed December 4, 1959

C. L. Foster  
Registered Professional  
Engineer and/or Land Surveyor.

Certificate No. 3084