

NEW MEXICO OIL CONSERVATION COMMISSION
Santa Fe, New Mexico

Form C-101
Revised (12/1/55)

NOTICE OF INTENTION TO DRILL

Notice must be given to the District Office of the Oil Conservation Commission and approval obtained before drilling or recompletion begins. If changes in the proposed plan are considered advisable, a copy of this notice showing such changes will be returned to the sender. Submit this notice in QUINTUPLICATE. One copy will be returned following approval. See additional instructions in Rules and Regulations of the Commission. If State Land submit 6 Copies Attach Form C- 128 in triplicate to first 3 copies of form C-101

Farmington, New Mexico

January 19, 1959

(Place)

(Date)

OIL CONSERVATION COMMISSION
SANTA FE, NEW MEXICO

Gentlemen:

You are hereby notified that it is our intention to commence the Drilling of a well to be known as

Pan American Petroleum Corporation

(Company or Operator)

State of New Mexico Gas Unit "W"

Well No. 1

L

The well is

located 1650 feet from the South line and 990 feet from the

West

line of Section 36, T. 29N, R. 9W, NMPM.

(GIVE LOCATION FROM SECTION LINE) Undesignated Pictured Pool, San Juan County

Cliffs

E-5314

If State Land the Oil and Gas Lease is No.

If patented land the owner is.

Address.

We propose to drill well with drilling equipment as follows:

Rotary tools to total depth.

The status of plugging bond is.

Drilling Contractor Brammon & Murray Drilling Company

Box 672

Coleman, Texas

We intend to complete this well in the Pictured Cliffs

formation at an approximate depth of 2300 feet.

Section 36

CASING PROGRAM

We propose to use the following strings of Casing and to cement them as indicated:

| Size of Hole | Size of Casing | Weight per Foot | New or Second Hand | Depth | Sacks Cement |
|--------------|----------------|-----------------|--------------------|-------|--------------|
| 12-1/4" | 8-5/8" | 22.7 | New | 250 | Circulate |
| 7-7/8" | 4-1/2" | 9.5 | New | 2300 | Circulate |
| | | | | | |
| | | | | | |

If changes in the above plans become advisable we will notify you immediately.

ADDITIONAL INFORMATION (If recompletion give full details of proposed plan of work.)

We propose to drill the above well with rotary tools to an approximate total depth of 2300' to complete in the Pictured Cliffs formation. Stimulation will be indicated on reaching total depth. Copies of location plat are attached. Logs will be furnished upon completion of well.

Approved. 1-20-59, 1959
Except as follows:

Sincerely yours,

Pan American Petroleum Corporation

(Company or Operator)

By R. M. Bauer, Jr.

Position Field Engineer

Send Communications regarding well to

Name Pan American Petroleum Corporation

Address Box 487, Farmington, New Mexico

OIL CONSERVATION COMMISSION

By

NEW MEXICO OIL CONSERVATION COMMISSION

Well Location and Acreage Declaration Form

Section A.

Date **January 16, 1959**

Operator **PAN AMERICAN PETROLEUM CORPORATION** State of New Mexico "V"
Well No. **1** Unit Letter **E** Section **36** Township **29 NORTH** Range **9 WEST** NMPM
Located **1650** Feet From **the SOUTH** Line **990** Feet From **the WEST** Line
County **SAN JUAN** G. L. Elevation ***** Dedicated Acreage **160** Acre
Name of Producing Formation **PICTURED CLIFFS** Pool **Undesignated Pictured Cliffs**

1. Is the Operator the only owner in the dedicated area? (If "no", list the parties and their respective interests below.)
Yes ☐ No ☒ ***To be reported later**
2. If the answer to question one is "no", have the interests of all the owners been ascertained by agreement or otherwise? Yes ☒ No ☐ If answer "Yes", list of co-owners:
Communitized Tract: Pan American 25%, Standard of Texas 25%, Aladdin Petroleum 25%, Sue Reeder Turner 12.5%, Sam Dazzo 12.5%.
3. If the answer to question two is "no", list all the owners and their respective interests below.

Owner

Land Description



Section B.

Note: All dimensions must be from corner boundaries of section.

This is to certify that the information in Section A above is true and complete to the best of my knowledge and belief.

PAN AMERICAN PETROLEUM CORPORATION

(Operator)

R. M. Bauer, Jr. *RMBauer, Jr.*

(Representative)

Box 487, Farmington, New Mexico

(Address)

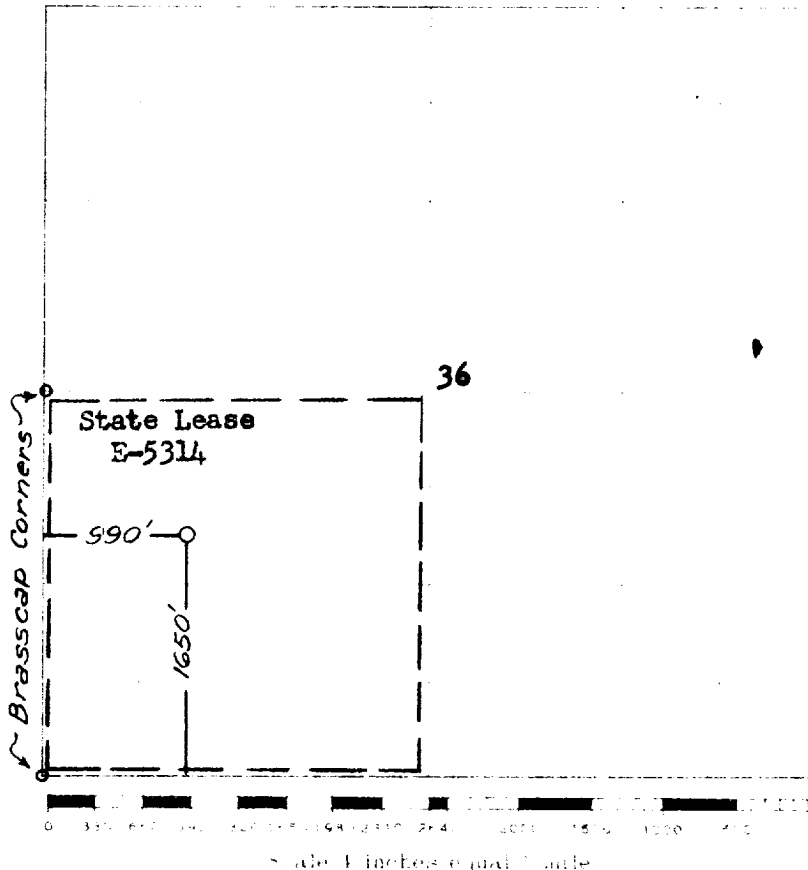

This is to certify that the above plan was prepared from field notes of actual survey made by me or under my supervision and that the same are true and correct to the best of my knowledge and belief.

Date Surveyed **17 SEPTEMBER 1957**

James P. Leese
Registered Professional Engineer and/or Land Surveyor
JAMES P. LEESE N. MEX. REG. No. 1463

