

NEW MEXICO OIL CONSERVATION COMMISSION
Santa Fe, New Mexico

Form C-101
Revised (12/1/55)

NOTICE OF INTENTION TO DRILL

Notice must be given to the District Office of the Oil Conservation Commission and approval obtained before drilling or recompletion begins. If changes in the proposed plan are considered advisable, a copy of this notice showing such changes will be returned to the sender. Submit this notice in QUINTUPPLICATE. One copy will be returned following approval. See additional instructions in Rules and Regulations of the Commission. If State Land submit 6 Copies Attach Form C-128 in triplicate to first 3 copies of form C-101

Farmington, New Mexico
(Place)

November 16, 1961
(Date)

OIL CONSERVATION COMMISSION
SANTA FE, NEW MEXICO

Gentlemen:

You are hereby notified that it is our intention to commence the Drilling of a well to be known as

Southern Union Production Company

(Company or Operator)

Pierce

(Lease)

Well No. 2-A, in A The well is

(Unit)

located 790 feet from the North line and 790 feet from the East line of Section 34, T. 29N, R. 10W, NMPM.

(GIVE LOCATION FROM SECTION LINE) Lasin Dakota Pool, San Juan County

D	C	B	A
E	F	G	H
L	K	J	I
M	N	O	P

If State Land the Oil and Gas Lease is No

If patented land the owner is J. A. Pierce

Address Aztec, New Mexico

We propose to drill well with drilling equipment as follows: Rotary tools will

be employed to T.D. of approx. 6455'

The status of plugging bond is State wide.

Drilling Contractor Huron Drilling Company

Shiprock, New Mexico

Farmington, New Mexico

We intend to complete this well in the Dakota

formation at an approximate depth of 6455' feet.

CASING PROGRAM

We propose to use the following strings of Casing and to cement them as indicated:

Size of Hole	Size of Casing	Weight per Foot	New or Second Hand	Depth	Sacks Cement
12-1/4"	8-5/8"	24.00	New	250'	150
6-3/4"	4-1/2"	10.50	New	6455'	250

If changes in the above plans become advisable we will notify you immediately.

ADDITIONAL INFORMATION (If recompletion give full details of proposed plan of work.)

Intended to be used for water table covered well

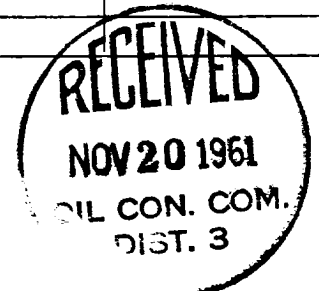

Approved: 11-26, 1961
Except as follows:

OIL CONSERVATION COMMISSION

By: [Signature]

Sincerely yours,

Southern Union Production Company

(Company or Operator)

By: Gilbert D. Noland, Jr.

Gilbert D. Noland, Jr.

Position: Drilling Superintendent

Send Communications regarding well to

Name: Gilbert D. Noland, Jr.

Address: P. O. Box 808, Farmington, New Mexico

NEW MEXICO OIL CONSERVATION COMMISSION

Well Location and Acreage Dedication Plat

Section A.

Date November 14, 1961

Operator SOUTHERN UNION PRODUCTION COMPANY Lease PIERCE
 Well No. 2 - A Unit Letter A Section 34 Township 29 NORTH Range 10 WEST, NMPM
 Located 790 Feet From the NORTH Line, 790 Feet From the EAST Line
 County SAN JUAN G. L. Elevation 5549.0 Dedicated Acreage 320 Acres
 Name of Producing Formation Dakota Pool Basin Dakota

1. Is the Operator the only owner in the dedicated acreage outlined on the plat below?

Yes _____ No X2. If the answer to question one is "no", have the interests of all the owners been consolidated by communitization agreement or otherwise? Yes X No _____. If answer is "yes", Type of Consolidation.**Communitization Agreement**

3. If the answer to question two is "no", list all the owners and their respective interests below:

OwnerLand Description

Section B.

This is to certify that the information
 in Section A above is true and complete
 to the best of my knowledge and belief.

Southern Union Production Company

Gilbert D. Noland, Jr.
 (Operator)
 (Representative)

Gilbert D. Noland, Jr.
 (Address)

P. O. Box 808

Farmington, New Mexico

Ref: GLO plat dated 19 April 1881

Note: All distances must be from outer boundaries of section.

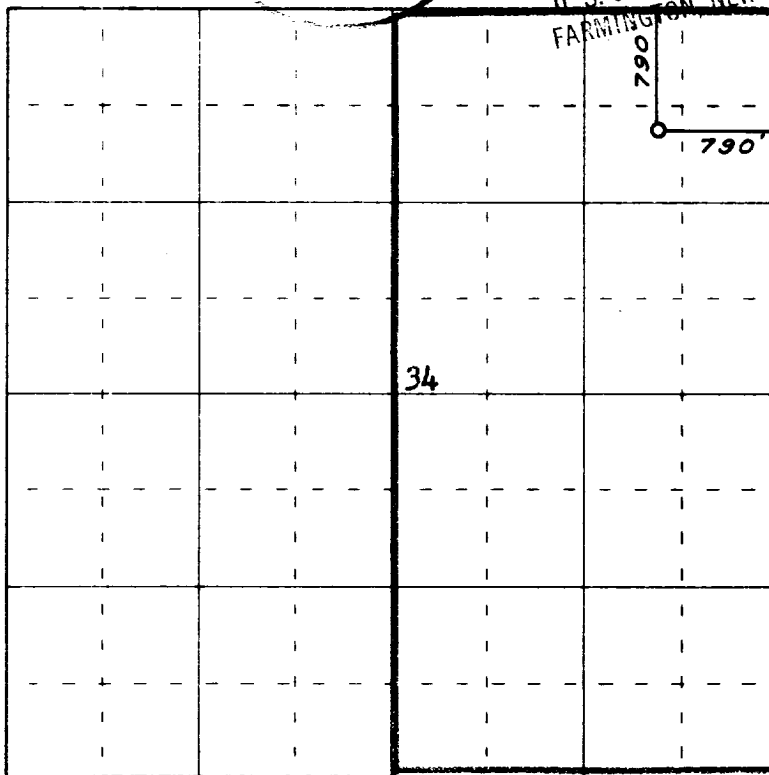

0 330 660 990 1320 1650 1980 2310 2640 2000 1500 1000 500 0

Scale 4 inches equal 1 mile

This is to certify that the above plat was prepared from field notes of actual surveys
 made by me or under my supervision and that the same are true and correct to the best
 of my knowledge and belief.

Date Surveyed 9 November 1961

James P. Leese
 Registered Professional Engineer and/or Land Surveyor
 James P. Leese N. Mex. Reg. No. 1463
 San Juan Engineering Company

