

(SUBMIT IN TRIPLICATE)

Land Office Santa Fe

Lease No. SW 978931-2

Unit _____

UNITED STATES
DEPARTMENT OF THE INTERIOR
GEOLOGICAL SURVEY

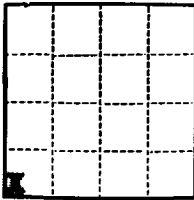

SUNDRY NOTICES AND REPORTS ON WELLS

NOTICE OF INTENTION TO DRILL	<input checked="" type="checkbox"/>	SUBSEQUENT REPORT OF WATER SHUT-OFF	<div style="text-align: center;"> <p>RECEIVED</p> <p>MAR 1 1961</p> <p>U. S. GEOLOGICAL SURVEY FARMINGTON, NEW MEXICO</p> </div>
NOTICE OF INTENTION TO CHANGE PLANS		SUBSEQUENT REPORT OF SHOOTING OR ACIDIZING	
NOTICE OF INTENTION TO TEST WATER SHUT-OFF		SUBSEQUENT REPORT OF ALTERING CASING	
NOTICE OF INTENTION TO RE-DRILL OR REPAIR WELL		SUBSEQUENT REPORT OF RE-DRILLING OR REPAIR	
NOTICE OF INTENTION TO SHOOT OR ACIDIZE		SUBSEQUENT REPORT OF ABANDONMENT	
NOTICE OF INTENTION TO PULL OR ALTER CASING		SUPPLEMENTARY WELL HISTORY	
NOTICE OF INTENTION TO ABANDON WELL			

(INDICATE ABOVE BY CHECK MARK NATURE OF REPORT, NOTICE, OR OTHER DATA)

March 1, 1961

WMA Glenn H. Callow
Well No. 16 is located 330 ft. from N line and 550 ft. from W line of sec. 27

SW 1/4 Section 27 29 N 13 W N.M.P.M.
(1/4 Sec. and Sec. No.) (Twp.) (Range) (Meridian)

Total Gallup San Juan New Mexico
(Field) (County or Subdivision) (State or Territory)

The elevation of the ground level ~~surface~~ above sea level is 5392 ft.

DETAILS OF WORK

(State names of and expected depths to objective sands; show sizes, weights, and lengths of proposed casings; indicate mudlogging jobs, cementing points, and all other important proposed work)

We propose to drill subject well as follows:

1. Rotary tools from surface to total depth.
2. Drill 12-1/4" hole to 150'.
3. Run and cement 8-5/8" casing to 150'. Circulate cement to surface.
4. Drill 7-7/8" hole to total depth, approximately 2875'.
5. Run EM-Resistivity and Gamma Ray Sonic logs.
6. Run 4-1/2" casing below Gallup pay zones, run stage collar and cement in two stages. First stage - 140 sacks 9070 Ponnix; tail in with 90 sacks 9070 Ponnix. Second stage - 90 sacks 9070 Ponnix.
7. Potential well and clean location.

I understand that this plan of work must receive approval in writing by the Geological Survey before operations may be commenced.

Company Sumaco Corporation

Address P. O. Box 1714

Durango, Colorado

By L. B. Plumb

Title District Production Superintendent

NEW MEXICO OIL CONSERVATION COMMISSION
Well Location and Acreage Dedication Plat

Section A.

Date March 1, 1961

TEHRICO CORPORATION
Operator TEHRICO CORPORATION Lease GLENN H. CALLOW
Well No. 16 Unit Letter M Section 27 Township 29N Range 13W NMPM
Located 330 Feet From South Line, 550 Feet From West Line
County San Juan G. L. Elevation 5392 Dedicated Acreage 80 Acres
Name of Producing Formation Callup Pool Utah

1. Is the Operator the only owner* in the dedicated acreage outlined on the plat below?
Yes X No .
2. If the answer to question one is "no," have the interests of all the owners been consolidated by communitization agreement or otherwise? Yes No . If answer is "yes," Type of Consolidation
3. If the answer to question two is "no," list all the owners and their respective interests below:

Owner

Land Description

Section B

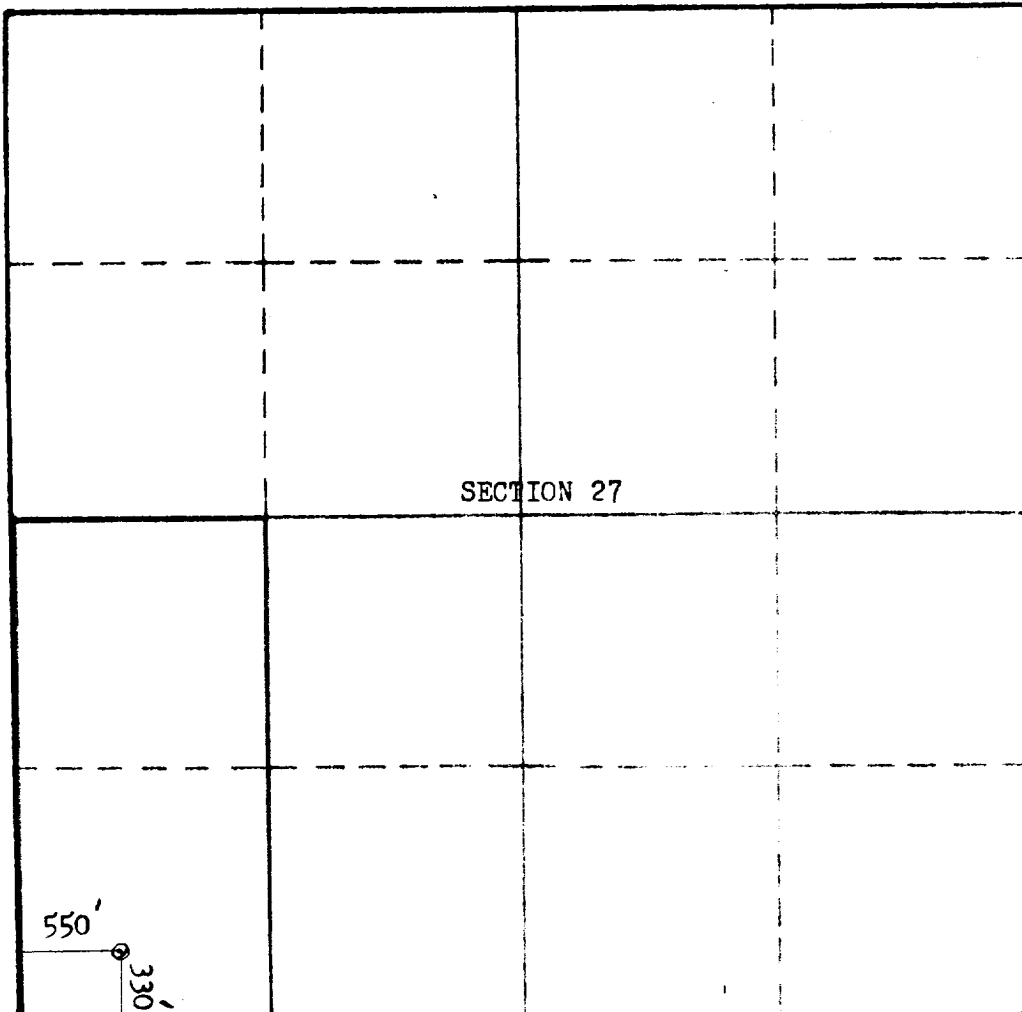

This is to certify that the information in Section A above is true and complete to the best of my knowledge and belief.

TEHRICO CORPORATION

(Operator)

L. B. Plumb L. B. Plumb
(Representative)

P. O. Box 1724

Durango, Colorado

Address

This is to certify that the well location shown on the plat in Section B was plotted from field notes of actual surveys made by me or under my supervision and that the same is true and correct to the best of my knowledge and belief.

Date Surveyed Feb. 20, 1961

Stephen H. Kinney
STEPHEN H. KINNEY

Registered Professional
Engineer and/or Land Surveyor.

Certificate No. 803