

NEW MEXICO OIL CONSERVATION COMMISSION

Well Location and Acreage Dedication Plat

SECTION A.

Date January 16, 1961

Operator Astec Oil and Gas Company Lease Hagood
 Well No. 16-0 Unit Letter I Section 29 Township 29N Range 13W NMPM
 Located 2310 Feet From South Line, 330 Feet From East Line
 County San Juan G. L. Elevation 5825 Dedicated Acreage 40 Acres
 Name of Producing Formation Gallup Pool Total

1. Is the Operator the only owner* in the dedicated acreage outlined on the plat below? Yes. xxx No.
2. If the answer to question One is "No," have the interests of all the owners been consolidated by communitization agreement or otherwise? Yes. No. If answer is "Yes," Type of Consolidation
3. If the answer to question Two is "No," list all the owners and their respective interests below:

OWNER

LAND DESCRIPTION

SECTION B.

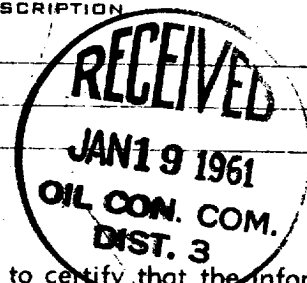
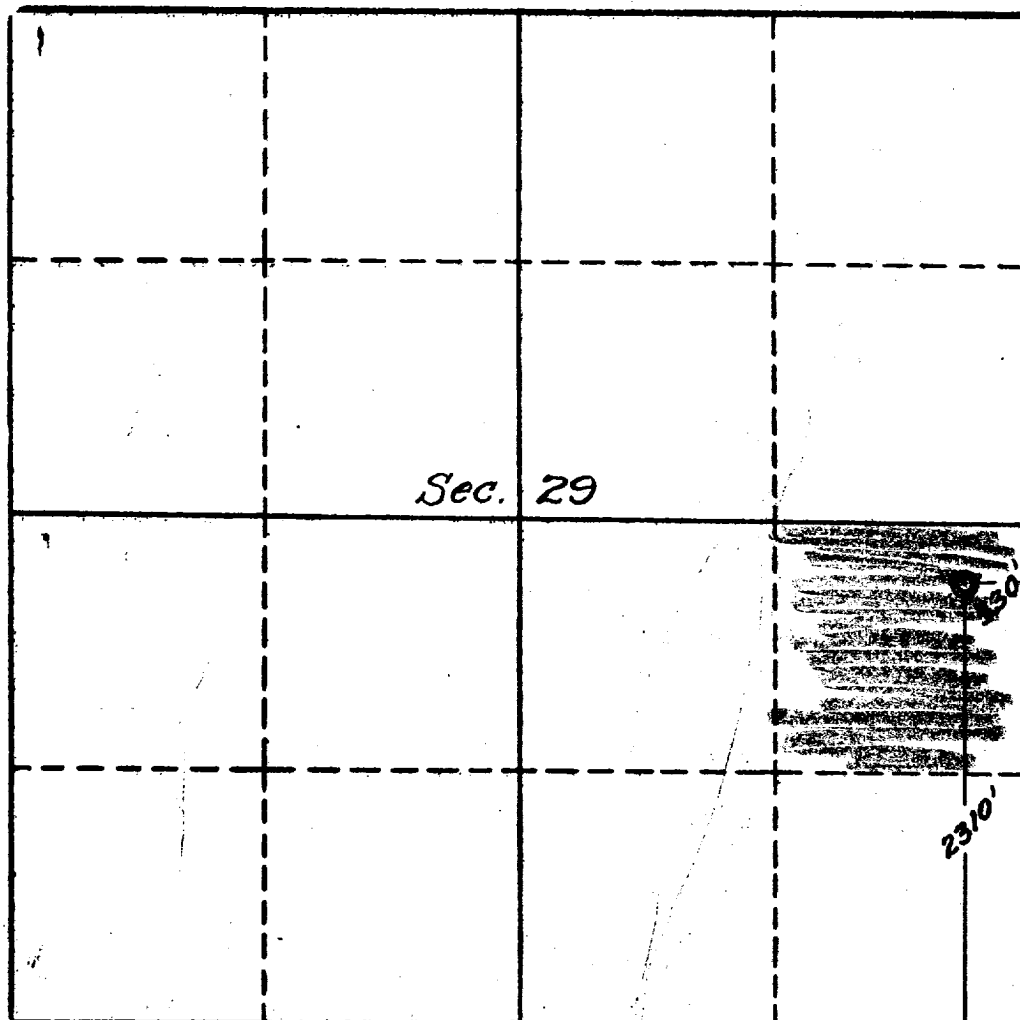

This is to certify that the information in Section A above is true and complete to the best of my knowledge and belief.

Astec Oil and Gas Company
 (OPERATOR)

ORIGINAL SIGNED BY JOE C. SALMON
 (REPRESENTATIVE)

Drawer 570, Farmington, New Mex.
 (ADDRESS)

This is to certify that the well location shown on the plat in Section B was plotted from field notes of actual surveys made by me or under my supervision and that the same is true and correct to the best of my knowledge and belief.

Date Surveyed 1-13-61

Four States Engineering Co.
 FARMINGTON, NEW MEXICO

E. J. Echols
 REGISTERED ENGINEER OR
 LAND SURVEYOR

Certificate No. 1545