

NEW MEXICO OIL CONSERVATION COMMISSION  
Santa Fe, New Mexico

30-045-07868

## NOTICE OF INTENTION TO DRILL OR RECOMPLETE

Notice must be given to the District Office of the Oil Conservation Commission and approval obtained before drilling or recompletion begins. If changes in the proposed plan are considered advisable, a copy of this notice showing such changes will be returned to the sender. Submit this notice in QUINTUPPLICATE. One copy will be returned following approval. See additional instructions in Rules and Regulations of the Commission.

If State Land submit 6 Copies

Astec, New Mexico  
(Place)June 30, 1955  
(Date)OIL CONSERVATION COMMISSION  
SANTA FE, NEW MEXICO

Gentlemen:

You are hereby notified that it is our intention to commence the (Drilling) (Recompletion) of a well to be known as

Basin Natural Gas Corporation  
(Company or Operator)Sullivan  
(Lease)

Well No. 2, in 3 (Unit) The well is

located 1655 feet from the North line and 795 feet from the

South

line of Section 26, T. 29-N, R. 11-W, NMPM.

(GIVE LOCATION FROM SECTION LINE)

Pool, San Juan County

If State Land the Oil and Gas Lease is No.

If patented land the owner is Earl B. Sullivan, Marcelle Sullivan &  
Address Bloomfield, New Mexico / Mary Sullivan

We propose to drill well with drilling equipment as follows:

Cable Tools and Rotary

The status of plugging bond is Applied for from Berger, Briggs  
and Company of Albuquerque, New Mexico

Drilling Contractor By owners

We intend to complete this well in the Picture Cliff  
formation at an approximate depth of 1800

## CASING PROGRAM

We propose to use the following strings of Casing and to cement them as indicated:

Size of Hole	Size of Casing	Weight per Foot	New or Second Hand	Depth	Sacks Cement
10	8 5/8	32	new	80	25
8 5/8	5 1/2	15	new	1800	250

If changes in the above plans become advisable we will notify you immediately.

ADDITIONAL INFORMATION (If recompletion give full details of proposed plan of work.)

Will run an electric log by Geoelectric to test the Fruitland Sand at approximately 1800 feet. If production is indicated will Sand Oil Frac by Halliburton Oil Well Cementing Co. and complete as a gas well, running 1" tubing to the bottom.

Approved 7-20, 1955  
Except as follows:

Sincerely yours,

Basin Natural Gas Corporation  
(Company or Operator)

By M. Kranovich

Position Asst. Treas.  
Send Communications regarding well to

Name Basin Natural Gas Corp.

Address 109 W Chase

Astec, New Mexico

OIL CONSERVATION COMMISSION

By

S. V. Roberts

Title PETROLEUM ENGINEER DIST. NO. 3

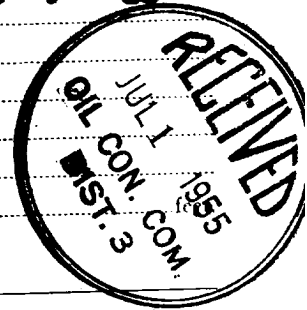

OIL CONSERVATION COMMISSION		
AZTEC DISTRICT OFFICE		
No. Copies Received		
DISTRIBUTION		
	NO. FURNISHED	
Operator		
Santa Fe		
Proration Office		
State Land Office		
U. S. G. S.		
Transporter		
File		

Company.....BASIN NATURAL GAS CORPORATION

Lease.....Sullivan.....Well No. 2

Sec. " 26 , T. 29 N. , R. 11 W. N.M.P.M.

Location.....1655' from the North line and  
795' from the East line.

Elevation.....5466.3 Ungraded ground

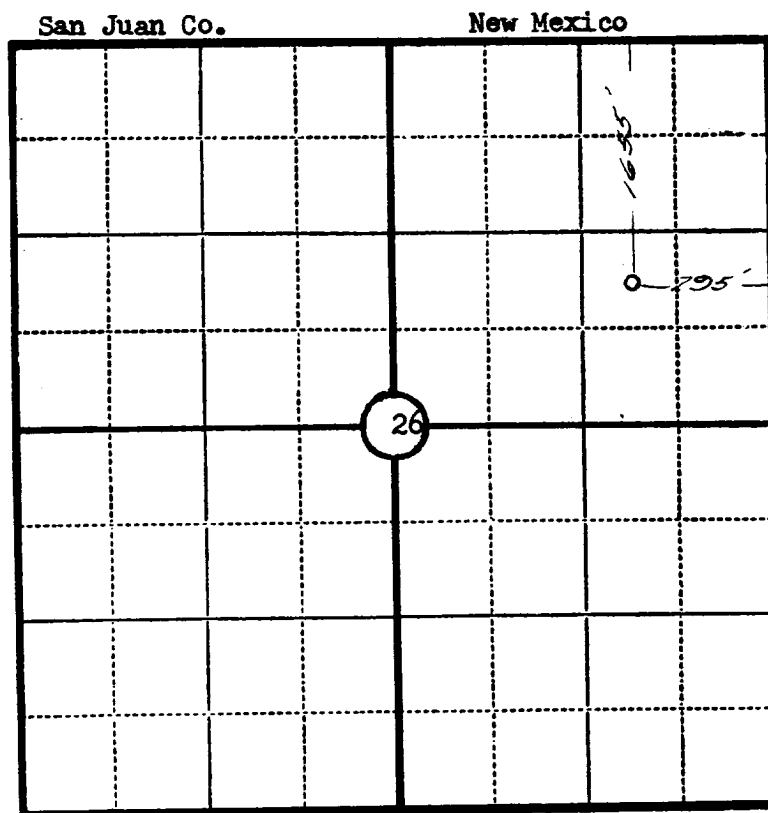

Scale—4 inches equal 1 mile.

This is to certify that the above plat was prepared from field notes of actual surveys made by me or under my supervision and that the same are true and correct to the best of my knowledge and belief.

Seal:

*James P. Lee*  
Registered [redacted]  
[redacted] Land Surveyor.

Surveyed ..... June 16 , 19 55

<b>OIL CONSERVATION COMMISSION</b>		
<b>AZTEC DISTRICT OFFICE</b>		
<b>No. Copies Received</b> 5		
<b>DISTRIBUTION</b>		
	<b>NO. FUC 12155C</b>	
Operator	/	
Santa Fe	/	
Proration Office		
State Land Office		
U. S. G. S.	2	
Transporter		
File	/	✓

NEW MEXICO  
OIL CONSERVATION COMMISSION

Gas Well Plat

Date June 30, 1955

Basin Natural Gas Corp. Sullivan 2  
Operator Lease Well No.

Name of Producing Formation \_\_\_\_\_ Pool \_\_\_\_\_

No. Acres Dedicated to the Well 100 ✓ (unsat)

Indicate land status and show ownership.

SECTION 26 TOWNSHIP 29-N RANGE 11-W

		Earl B. Sullivan Marcelle Sullivan Mary Sullivan -- $\frac{1}{4}$ interest  100 A. NE $\frac{1}{4}$ of Sec 26-29-11	

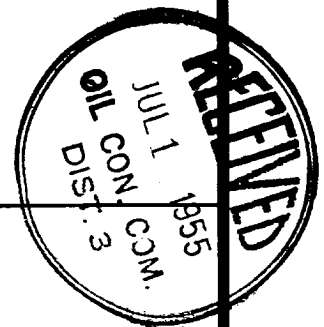

I hereby certify that the information given above is true and complete to the best of my knowledge.

Name M. Kranovich  
Position Asst. Treas  
Representing Basin Natural Gas Corp  
Address 100 W Chase, Artes, N.M.

(over)

**OIL CONSERVATION COMMISSION**

**AZTEC DISTRICT OFFICE**

No. Copies Received 5

**DISTRIBUTION**

	NO. FURNISHED	
Operator	<u>2</u>	
Santa Fe	<u>1</u>	
Proration Office		
State Land Office		
U. S. G. S.	<u>1</u>	
Transporter		
File	<u>1</u>	<u>✓</u>

OIL CONSERVATION COMMISSION

P. O. BOX 871

SANTA FE, NEW MEXICO

July 5, 1955

Basin Natural Gas Corporation  
Box 878  
Artes, New Mexico

Attention: Mr. F. B. Unberger

Gentlemen: RE: Basin Natural Gas Corp., \$5,000.00  
one-well bond; NE/4, 26-29N-11W; United  
States Casualty Co.; approved 7-5-55

The Oil Conservation Commission on this date approves the above-captioned plugging bond covering your projected Sullivan No. 2 Well, to be located 1655' PNL and 795' PNL (NE/4) Section 26, Township 29 North, Range 11 West.

Very truly yours,

W. B. Macey  
Secretary - Director

WBM:brp

CC-Berger Briggs & Co.  
Attn. Mr. Edward Ketchum  
215 Third Street, SW  
Albuquerque, N. M.

Oil Conservation Commission:  
Artesia  
~~Artes~~  
Hobbs



C  
O  
P  
Y

OIL CONSERVATION COMMISSION

P. O. BOX 871

SANTA FE, NEW MEXICO

C  
O  
P  
Y

RECEIVED

APR 10 1934

DEPT. OF THE INTERIOR

LAND OFFICE

TO THE COMMISSIONER OF LANDS

FROM THE DIRECTOR OF LANDS

RE: [illegible]

[illegible text]

[illegible text]

[illegible text]

[illegible text]

[illegible text]





NEW MEXICO OIL CONSERVATION COMMISSION  
Santa Fe, New Mexico

MISCELLANEOUS REPORTS ON WELLS

Submit this report in TRIPLICATE to the District Office, Oil Conservation Commission, within 10 days after the work specified is completed. It should be signed and filed as a report on Beginning Drilling Operations, Results of test of casing shut-off, result of plugging of well, result of well repair, and other important operations, even though the work was witnessed by an agent of the Commission. See additional instructions in the Rules and Regulations of the Commission.

Indicate Nature of Report by Checking Below

REPORT ON BEGINNING DRILLING OPERATIONS	<input checked="" type="checkbox"/>	REPORT ON RESULT OF TEST OF CASING SHUT-OFF	<input type="checkbox"/>	REPORT ON REPAIRING WELL	<input type="checkbox"/>
REPORT ON RESULT OF PLUGGING WELL	<input type="checkbox"/>	REPORT ON RECOMPLETION OPERATION	<input type="checkbox"/>	REPORT ON (Other)	<input type="checkbox"/>

July 25, 1955 (Date) Astec, New Mexico (Place)

Following is a report on the work done and the results obtained under the heading noted above at the

Basin Natural Gas Corporation

Sullivan

(Company or Operator)

(Lease)

F. B. Umbarger

(Contractor)

Well No. 2 in the SE 1/4 NE 1/4 of Sec. 26

T. 29-N, R. 11-W, NMPM, Aztec-Fruitland Pool, San Juan County.

The Dates of this work were as follows: July 12, 1955 through July 17, 1955

Notice of intention to do the work (was) ~~not~~ submitted on Form C-102 on June 30, 1955, (Cross out incorrect words)

and approval of the proposed plan (was) ~~not~~ obtained.

DETAILED ACCOUNT OF WORK DONE AND RESULTS OBTAINED

Set 48 feet of surface with 48 feet of 8 5/8" casing through the boulders to shale, cementing to the top with 20 sacks of cement.

Awaiting on Rotary which is contracted to the Banner Drilling Company.

Halliburton Oil Well Cementing Company will cement the long string from top to bottom.

L. B. Vaught  
Witnessed by (Name)

Basin Natural Gas Corp.  
(Company)

Approved: OIL CONSERVATION COMMISSION

A. R. Hendrick  
(Name)

I hereby certify that the information given above is true and complete to the best of my knowledge.

Name M. Kransuie

Position Asst. Treas.

Representing Basin Natural Gas Corporation

Address 109 W. Chaco, Aztec, New Mexico

PETROLEUM ENGINEER DIST. NO. 3 AUG 8 1955  
(Title) (Date)

OIL CONSERVATION COMMISSION		
AZTEC DISTRICT OFFICE		
No. Copies Received <u>3</u>		
DISTRIBUTION		
	NO. FURNISHED	
Operator	<u>1</u>	
Santa Fe	<u>1</u>	
Proration Office		
State Land Office		
U. S. G. S.		
Transporter		
File	<u>1</u>	<input checked="" type="checkbox"/>