

## HUMBLE LEASE NO. 240973 NEW MEXICO OIL CONSERVATION COMMISSION

STATE LEASE NO.

FEDERAL LEASE NO.

Indian Contract # 12-20-603-2172

Section A.

## Well Location and Acreage Dedication Plat

Form C-128  
Revised 5/1/57Date Aug. 23, 1960

Operator Humble Oil & Refining Co Lease Navajo Tribe of Indians "L"  
 Well No. 3 Unit Letter G Section 26 Township 29 North Range 14 West NMPM  
 Located 1980 Feet From North Line, 1830 Feet From East Line  
 County San Juan G. L. Elevation Later Dedicated Acreage 80 Acres  
 Name of Producing Formation Gallup Sand Pool Chacha Gallup

1. Is the Operator the only owner\* in the dedicated acreage outlined on the plat below?  
 Yes ☒ No ☐
2. If the answer to question one is "no", have the interests of all the owners been consolidated by communitization agreement or otherwise? Yes ☐ No ☐ If answer is "yes," Type of Consolidation \_\_\_\_\_
3. If the answer to question two is "no," list all the owners and thier respective interests below:

Owner

Land Description

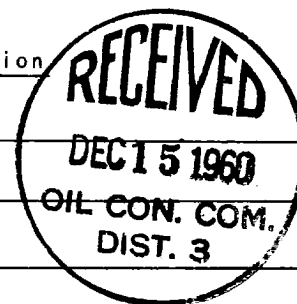

## Section B

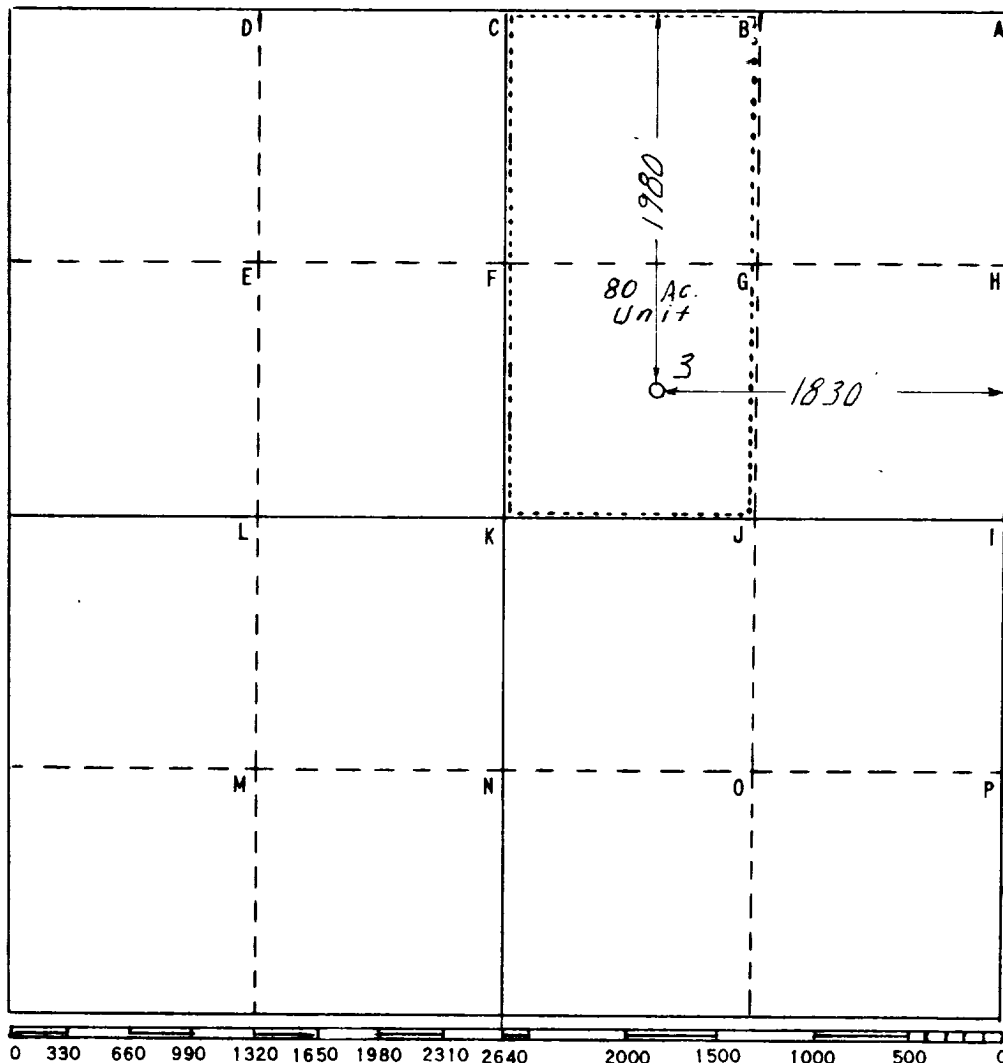

This is to certify that the information in Section A above is true and complete to the best of my knowledge and belief

HUMBLE OIL &amp; REFG. CO.

(Operator)

[Signature]  
 (Representative)

Box 1600 Midland, Texas  
 Address

This is to certify that the well location shown on the plat in Section B was plotted from field notes of actual surveys made by me or under my supervision and that the same is true and correct to the best of my knowledge and belief.

Date Surveyed Aug. 22, 1960

[Signature]  
 Registered Professional  
 Engineer and/or Land Surveyor

Certificate No. 1382

FILE NO. W-A-2953