

STATE LEASE NO. \_\_\_\_\_  
FEDERAL LEASE NO. \_\_\_\_\_  
INDIAN CONTRACT NO. \_\_\_\_\_  
14-20-603-2172

Form C-128  
Revised 5/1/57

NEW MEXICO OIL CONSERVATION COMMISSION

Well Location and Acreage Dedication Plat

Section A.

Date 7-20-60

Operator Humble Oil & Refining Co. Lease Navajo Tribe of Indians "L"  
Well No. 1 Unit Letter E Section 26 Township 29-N Range 14-W NMPM  
Located 1980 Feet From North Line, 660 Feet From West Line  
County San Juan G. L. Elevation Later Dedicated Acreage 80 Acres  
Name of Producing Formation Gallup Sand Pool Cha Cha Gallup

1. Is the Operator the only owner\* in the dedicated acreage outlined on the plat below?  
Yes X No \_\_\_\_\_
2. If the answer to question one is "no", have the interests of all the owners been consolidated by communitization agreement or otherwise? Yes \_\_\_\_\_ No \_\_\_\_\_ If answer is "yes," Type of Consolidation \_\_\_\_\_
3. If the answer to question two is "no," list all the owners and thier respective interests below:

Owner

Land Description

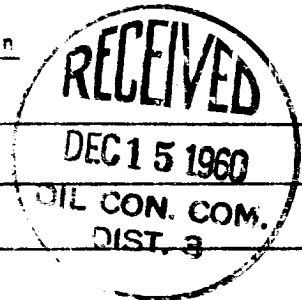

Section B

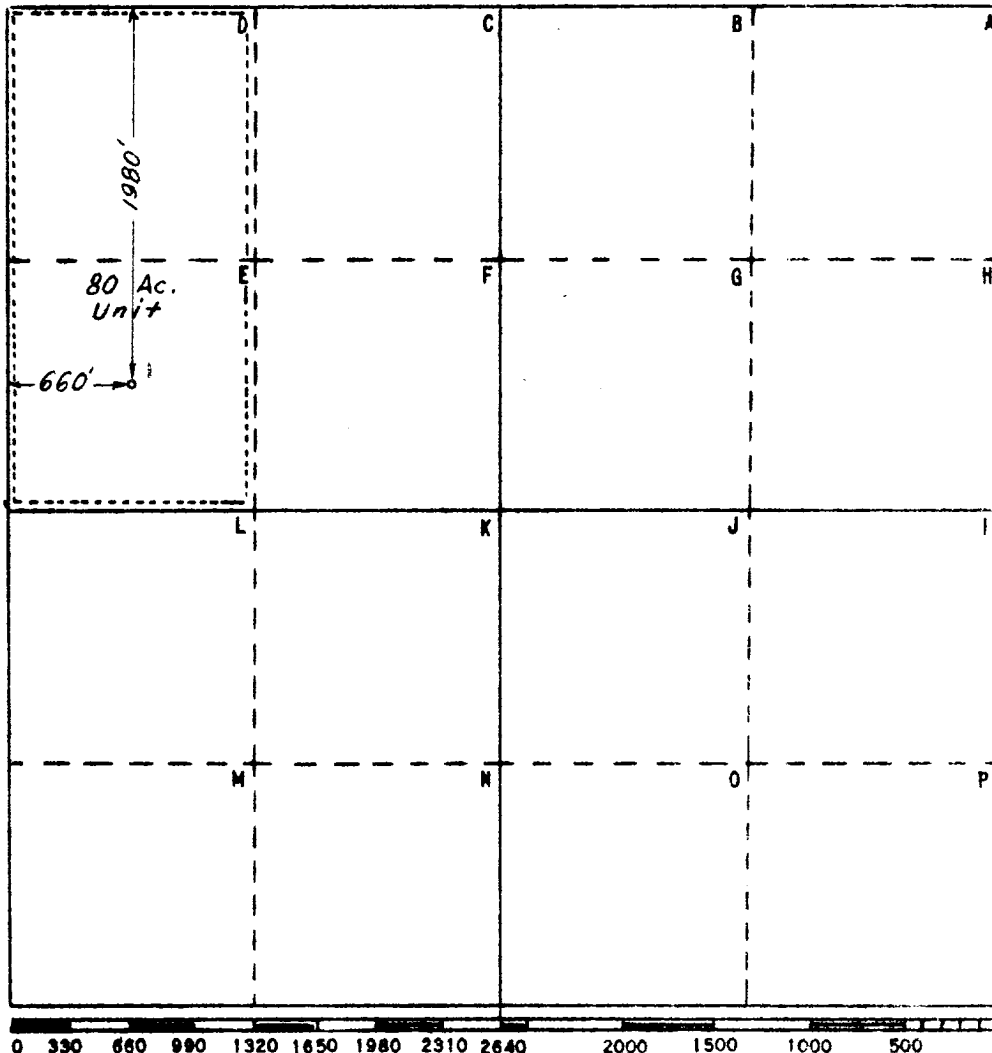

This is to certify that the information in Section A above is true and complete to the best of my knowledge and belief

HUMBLE OIL & REFG. CO.

(Operator)

H. E. Hensley

(Representative)

Box 1600 Midland, Texas

Address

This is to certify that the well location shown on the plat in Section B was plotted from field notes of actual surveys made by me or under my supervision and that the same is true and correct to the best of my knowledge and belief.

Date Surveyed 7-19-60

H. S. Westergaard

Registered Professional  
Engineer and/or Land Surveyor

Certificate No. 1382