

(SUBMIT IN TRIPLICATE)

UNITED STATES
DEPARTMENT OF THE INTERIOR
GEOLOGICAL SURVEY

Land Office

Lease No. **NM-014378**

Unit

SUNDRY NOTICES AND REPORTS ON WELLS

NOTICE OF INTENTION TO DRILL	<input checked="" type="checkbox"/>	SUBSEQUENT REPORT OF WATER SHUT-OFF	
NOTICE OF INTENTION TO CHANGE PLANS		SUBSEQUENT REPORT OF SHOOTING OR ACIDIZING	
NOTICE OF INTENTION TO TEST WATER SHUT-OFF		SUBSEQUENT REPORT OF ALTERING CASING	
NOTICE OF INTENTION TO RE-DRILL OR REPAIR WELL		SUBSEQUENT REPORT OF RE-DRILLING OR REPAIR	
NOTICE OF INTENTION TO SHOOT OR ACIDIZE		SUBSEQUENT REPORT OF ABANDONMENT	
NOTICE OF INTENTION TO PULL OR ALTER CASING		SUPPLEMENTARY WELL HISTORY	
NOTICE OF INTENTION TO ABANDON WELL			

(INDICATE ABOVE BY CHECK MARK NATURE OF REPORT, NOTICE, OR OTHER DATA)

Lease No. **163464**

H. J. Lee Federal B

August 10, 1960

Well No. 3 is located 890 ft. from N line and 790 ft. from W line of Sec. 23

SW/4 SW/4 Sec. 23 T-23-N R-12-W NMPN
(4 Sec. and Sec. No.) (Twp.) (Range) (Meridian)

Wildcat-Gallop Undesignated-Dakota San Juan
(Field) (County or Subdivision)

New Mexico
(State or Territory)

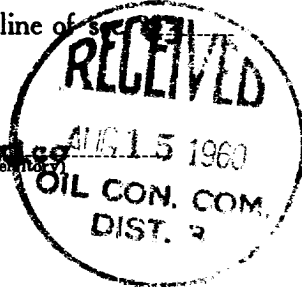

The elevation of the derrick floor above sea level is 5507 ft.

DETAILS OF WORK

(State names of and expected depths to objective sands; show sizes, weights, and lengths of proposed casings; indicate mudding jobs, cementing points, and all other important proposed work)

OBJECTIVE FORMATIONS:		SIZE CASINO			CASING PROGRAM (approx.)	
					Set at	cement
Gallop	5169'	2 5/8"	32.30#	New	200'	150' ex
Dakota	6135'	4 1/2"	9.5 #	New	5700'	
Total Depth	6570'	4 1/2"	11.6 #	New	700'	
		2 3/8"	4.7 #	New	5600'	

NOTE: A hearing before N.M.O.C.C. is being requested for a dual tubingless completion involving 4 1/2" and 2 3/8" casing. Details of this completion, including cementing program, will be outlined at hearing.

I understand that this plan of work must receive approval in writing by the Geological Survey before operations may be commenced.

Company TEXACO Inc.

Address P. O. Box 3109

Midland, Texas

By J. J. Velten

Title Division Civil Engineer

NEW MEXICO OIL CONSERVATION COMMISSION
WELL LOCATION AND ACREAGE DEDICATION PLAT

FORM C-128
Revised 5/1/57

SEE INSTRUCTIONS FOR COMPLETING THIS FORM ON THE REVERSE SIDE

SECTION A

Operator TEXACO Inc.		Lease H. J. Loe Federal "B"		Well No. 3
Unit Letter M	Section 23	Township 29 North	Range 12 West	County San Juan
Actual Footage Location of Well: 890 feet from the South line and 790 feet from the West line Sec. 23				
Ground Level Elev. 5496	Producing Formation Gallup (Oil)	Pool Wildcat-Gallup	Dedicated Acreage: 40 Acres	

1. Is the Operator the only owner in the dedicated acreage outlined on the plat below? YES ☒ NO ____ . ("Owner" means the person who has the right to drill into and to produce from any pool and to appropriate the production either for himself or for himself and another. (65-3-29 (e) NMSA 1935 Comp.)
2. If the answer to question one is "no," have the interests of all the owners been consolidated by commission agreement or otherwise? YES ____ NO ____ . If answer is "yes," Type of Consolidation ____
3. If the answer to question two is "no," list all the owners and their respective interests below:

Owner	Land Description



SECTION B

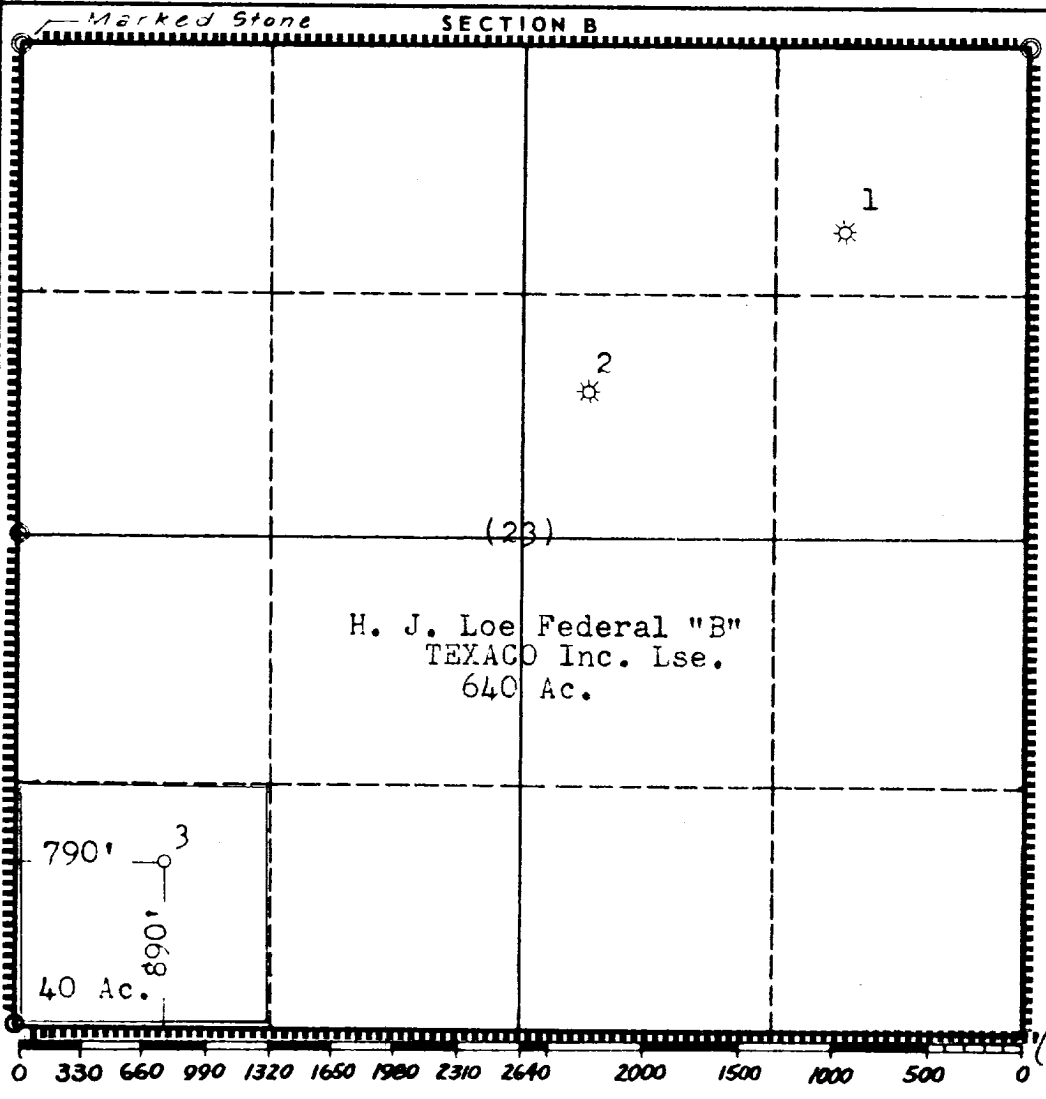

I hereby certify that the information in SECTION A above is true and complete to the best of my knowledge and belief.

Name
J. J. Velten

Position
Division Civil Engineer

Company
TEXACO Inc.

Date
8/8/60

I hereby certify that the well location shown on the plat in SECTION B was plotted from field notes of actual surveys made by me or under my supervision, and that the same is true and correct to the best of my knowledge and belief.

Date Surveyed
8/5/60

Registered Professional Engineer and/or Land Surveyor
J. J. Velten

Certificate No.
8174

NEW MEXICO OIL CONSERVATION COMMISSION
WELL LOCATION AND ACREAGE DEDICATION PLAT

FORM C-128
Revised 5/1/57

SEE INSTRUCTIONS FOR COMPLETING THIS FORM ON THE REVERSE SIDE

SECTION A

Operator TEXACO Inc.		Lease H. J. Loe Federal "B"		Well No. 3
Unit Letter M	Section 23	Township 29 North	Range 12 West	County San Juan
Actual Footage Location of Well: 890 feet from the South line and 790 feet from the West line Sec. 23				
Ground Level Elev. 5496	Producing Formation Dakota (Gas)	Pool Undesignated-Dakota	Dedicated Acreage: 320 Acres	

1. Is the Operator the only owner in the dedicated acreage outlined on the plat below? YES ☒ NO ____ . ("Owner" means the person who has the right to drill into and to produce from any pool and to appropriate the production either for himself or for himself and another. (65-3-29 (e) NMSA 1935 Comp.)
2. If the answer to question one is "no," have the interests of all the owners been consolidated by commutation agreement or otherwise? YES ____ NO ____ . If answer is "yes," Type of Consolidation ____
3. If the answer to question two is "no," list all the owners and their respective interests below

Owner	Land Description

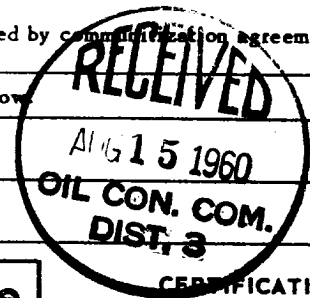

CERTIFICATION

I hereby certify that the information in SECTION A above is true and complete to the best of my knowledge and belief.

Name J. J. Velten
Position Division Civil Engineer
Company TEXACO Inc.
Date 8/8/60

I hereby certify that the well location shown on the plat in SECTION B was plotted from field notes of actual surveys made by me or under my supervision, and that the same is true and correct to the best of my knowledge and belief.

Date Surveyed 8/5/60
Registered Professional Engineer and/or Land Surveyor J. J. Velten
Certificate No. 8174

