

NEW MEXICO OIL CONSERVATION COMMISSION  
Santa Fe, New Mexico

Form C-101  
Revised (12/1/55)

NOTICE OF INTENTION TO DRILL

Notice must be given to the District Office of the Oil Conservation Commission and approval obtained before drilling or recompletion begins. If changes in the proposed plan are considered advisable, a copy of this notice showing such changes will be returned to the sender. Submit this notice in QUINTUPLICATE. One copy will be returned following approval. See additional instructions in Rules and Regulations of the Commission. If State Land submit 6 Copies Attach Form C- 128 in triplicate to first 3 copies of form C-101

Bloomfield New Mexico

(Place)

April 12, 1958

(Date)

OIL CONSERVATION COMMISSION  
SANTA FE, NEW MEXICO

Gentlemen:

You are hereby notified that it is our intention to commence the Drilling of a well to be known as

Elvis Roberts

(Company or Operator)

Grace Pearce

(Lease)

Well No. 1, in 0 The well is

(Unit)

located 990 feet from the THE SOUTH line and 1650 feet from the

THE EAST

line of Section 22, T. 29 North, R. 11 East, NMPM.

Bloomfield

Indesignated

Pool, San Juan County

(GIVE LOCATION FROM SECTION LINE)

If State Land the Oil and Gas Lease is No.

If patented land the owner is Grace Pearce

Address Bloomfield New Mexico

We propose to drill well with drilling equipment as follows:

Cable Tool Equipment

The status of plugging bond is Blanket Bond

Drilling Contractor Not known definitely at this date

We intend to complete this well in the Pannington Formation

formation at an approximate depth of 1200 feet.

CASING PROGRAM

We propose to use the following strings of Casing and to cement them as indicated:

Size of Hole	Size of Casing	Weight per Foot	New or Second Hand	Depth	Sacks Cement
12-1/4	10-3/4	35.75	New	Approx. 100'	50
10"	8-5/8	28	Second hand	600	None-will pull
8"	7	20	Used	700	50 sks.
6"	4 1/2 Liner	9.50	Perforated liner set in -	not cemented	

If changes in the above plans become advisable we will notify you immediately.

ADDITIONAL INFORMATION (If recompletion give full details of proposed plan of work.)

Approved 6-6, 1958  
Except as follows:

Sincerely yours,

By

(Company or Operator)

Position

Send Communications regarding well to

Name

Address

OIL CONSERVATION COMMISSION

By

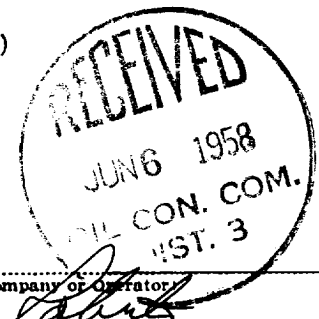

NEW MEXICO OIL CONSERVATION COMMISSION  
Well Location and Acreage Dedication Plat

Section A.

Date APRIL 18, 1958

Operator ELVIS ROBERTS Lease GRACE BEANCE  
Well No. 7 Unit Letter 0 Section 22 Township 29 NORTH Range 11 WEST NMPM  
Located 990 Feet From THE SOUTH Line, 1650 Feet From THE EAST Line  
County SAN JUAN G. L. Elevation 5425.0 Dedicated Acreage 40 Acres  
Name of Producing Formation FARMINGTON Pool UNDESIGNATED BLOOMFIELD

1. Is the Operator the only owner\* in the dedicated acreage outlined on the plat below?  
Yes X No       .
2. If the answer to question one is "no," have the interests of all the owners been consolidated by communitization agreement or otherwise? Yes        No       . If answer is "yes," Type of Consolidation
3. If the answer to question two is "no," list all the owners and their respective interests below:  
REF GLO Plat dated: 3 September 1878

Owner

Land Description

ELVIS ROBERTS

NE 1/4 SW 1/4 Sec. 22, Twp. 29 N, Rge. 11 W

RECEIVED

JUN 6 1958

OIL CON. COM.

OF N. M.

Section B

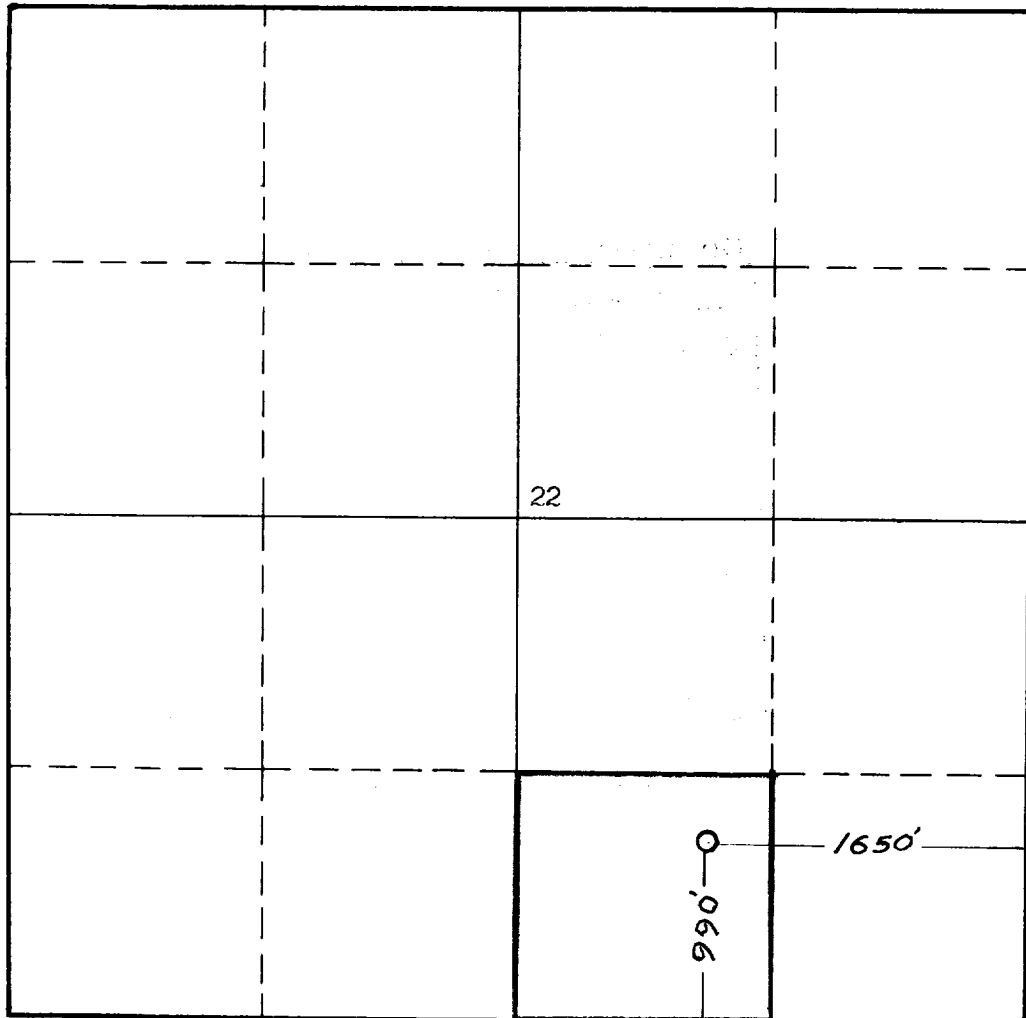

This is to certify that the information in Section A above is true and complete to the best of my knowledge and belief.

ELVIS ROBERTS

(Operator)

D. U. PRICE

(Representative)  
Box 237

Bloomfield, New Mexico

Address

This is to certify that the well location shown on the plat in Section B was plotted from field notes of actual surveys made by me or under my supervision and that the same is true and correct to the best of my knowledge and belief.

Date Surveyed May 5, 1958

James P. Lense  
Registered Professional  
Engineer and/or Land Surveyor.  
JAMES P. LENSE

Certificate No. 1463

(See instructions for completing this form on the reverse side)

INSTRUCTIONS FOR COMPLETION:

1. Operator shall furnish and certify to the information called for in Section A.
2. Operator shall outline the dedicated acreage for both oil and gas wells on the plat in Section B.
3. A registered professional engineer or land surveyor registered in the State of New Mexico or approved by the Commission shall show on the plat the location of the well and certify this information in the space provided.
4. All distances shown on the plat must be from the outer boundaries of Section.
5. If additional space is needed for listing owners and their respective interests as required in question 3, Section A, please use space below

OIL CONSERVATION COMMISSION		
AZTEC DISTRICT OFFICE		
No. Copies Received <u>5</u>		
DISTRIBUTION		
	NO. FURNISHED	
Operator	<u>2</u>	
Santa Fe	<u>1</u>	
Proration Office		
State Land Office		
U. S. G. S.	<u>2</u>	
Transporter		
File	<u>1</u>	<u>✓</u>

\* "Owner" means the person who has the right to drill into and to produce from any pool and to appropriate the production either for himself or for himself and another. (65-3-29 (e) NMSA 1953 Comp.)