

GENERAL	Meter: <u>71625</u> Location: <u>MARTINEZ GAS COM B #1</u>	
	Operator #: <u>0203</u> Operator Name: <u>Amoco</u> P/L District: <u>BLOOMFIELD</u>	
	Coordinates: Letter: <u>L</u> Section <u>24</u> Township: <u>29</u> Range: <u>10</u>	
	Or Latitude _____ Longitude _____	
	Pit Type: Dehydrator ___ Location Drip: <input checked="" type="checkbox"/> Line Drip: ___ Other: ___	
	Site Visit Date: <u>4.11.94</u> Run: <u>10</u> <u>42</u>	
SITE ASSESSMENT	NMOCD Zone: Inside <input type="checkbox"/> Land Type: BLM <input type="checkbox"/>	
	(From NMOCD Maps) Vulnerable Zone <input checked="" type="checkbox"/>	State <input type="checkbox"/>
	Outside <input type="checkbox"/>	Fee <input checked="" type="checkbox"/>
		Indian <input type="checkbox"/>
	Depth to Groundwater	<i>Denny E. Faust</i> DEPUTY OIL & GAS INSPECTOR
	Less Than 50 Feet (20 points) <input type="checkbox"/>	SEP 11 0 1996
	50 Ft to 99 Ft (10 points) <input checked="" type="checkbox"/>	<i>Hypocord</i>
	Greater Than 100 Ft (0 points) <input type="checkbox"/>	
	Wellhead Protection Area :	
	Is it less than 1000 ft from wells, springs, or other sources of fresh water extraction? , or ; Is it less than 200 ft from a private domestic water source? <input type="checkbox"/> YES (20 points) <input checked="" type="checkbox"/> NO (0 points)	
Horizontal Distance to Surface Water Body	RECEIVED APR - 4 1996 OIL CON. DIV. DIST. 3	
Less Than 200 Ft (20 points) <input type="checkbox"/>		
200 Ft to 1000 Ft (10 points) <input checked="" type="checkbox"/>		
Greater Than 1000 Ft (0 points) <input type="checkbox"/>		
Name of Surface Water Body <u>SAN JUAN RIVER</u>		
(Surface Water Body : Perennial Rivers, Major Wash, Streams, Creeks, Irrigation Canals, Ditches, Lakes, Ponds)		
TOTAL HAZARD RANKING SCORE: <u>20</u> POINTS		
REMARKS	Remarks : <u>TWO PITS ON LOCATION. WILL CLOSE ONLY ONE. PIT IS DRY. LOCATION IS AT A HIGHER ELEVATION THAN THE SAN JUAN RIVER.</u>	

ORIGINAL PIT LOCATION

ORIGINAL PIT LOCATION

Original Pit : a) Degrees from North 257° Footage to Wellhead 110'
b) Degrees from North _____ Footage to Dogleg _____
Dogleg Name _____
c) Length : 19' Width : 18' Depth : 3'

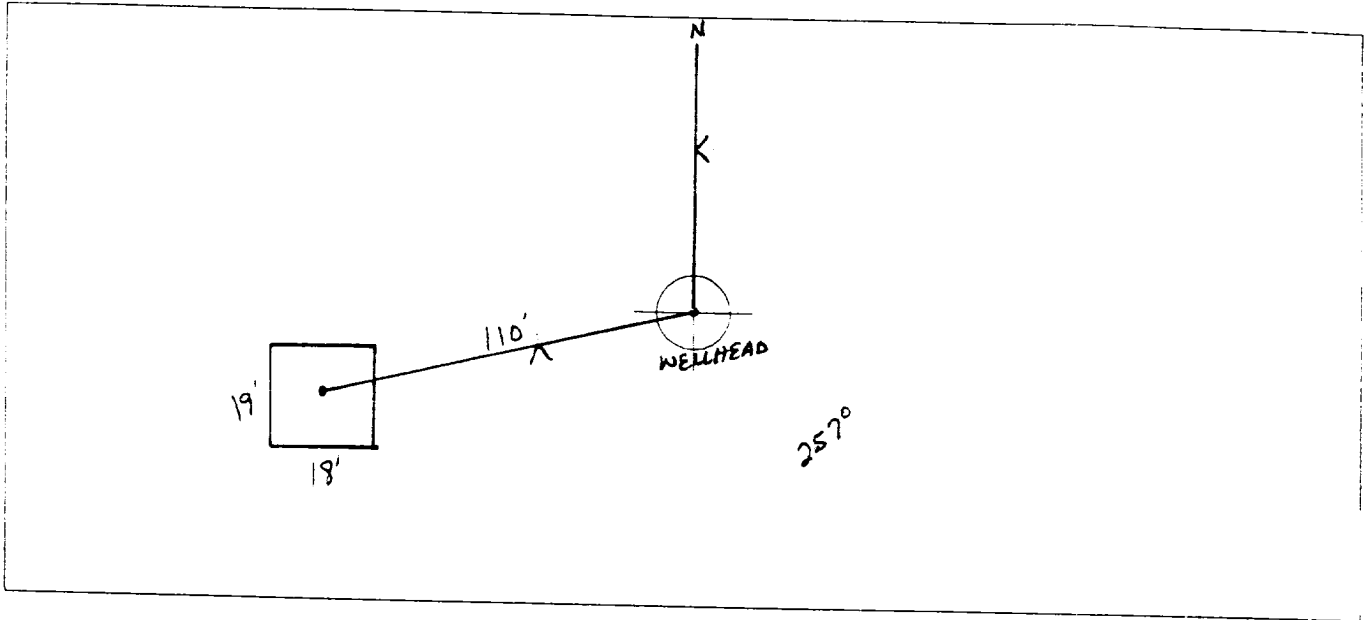

REMARKS

Remarks :

STARTED TAKING PICTURES AT 1:44 P.M.
END DUMP

Completed By:

Robert Thompson
Signature

4.11.94
Date

FIELD PIT REMEDIATION/CLOSURE FORM

GENERAL	Meter: <u>71625</u> Location: <u>Martinez Gas Com B#1</u> Coordinates: Letter: <u>L</u> Section <u>24</u> Township: <u>29</u> Range: <u>10</u> Or Latitude _____ Longitude _____ Date Started : <u>5-6-94</u> Area: <u>10</u> Run: <u>42</u>
OBSERVATIONS	Sample Number(s): ⁹⁴⁵⁰⁹⁰ <u>KD4041</u> Sample Depth: <u>12'</u> Feet Final PID Reading <u>22 ppm</u> PID Reading Depth <u>12'</u> Feet Yes No Groundwater Encountered <input type="checkbox"/> (1) <input checked="" type="checkbox"/> (2) Approximate Depth _____ Feet
CLOSURE	Remediation Method : Excavation <input checked="" type="checkbox"/> (1) Approx. Cubic Yards <u>75</u> Onsite Bioremediation <input type="checkbox"/> (2) Backfill Pit Without Excavation <input type="checkbox"/> (3) Soil Disposition: Envirotech <input type="checkbox"/> (1) <input checked="" type="checkbox"/> (3) Tierra Other Facility <input type="checkbox"/> (2) Name: _____ Pit Closure Date: <u>5-6-94</u> Pit Closed By: <u>BEI</u>
REMARKS	Remarks : <u>Pit appeared to be clean, Dug test hole to 12' took PID Reading, sample read 200 ppm, Excavated pit to 12', took sample closed pit</u>
	Signature of Specialist: <u>Kerry Dearen</u>



FIELD SERVICES LABORATORY

ANALYTICAL REPORT

PIT CLOSURE PROJECT - Soil

SAMPLE IDENTIFICATION

	Field ID	Lab ID
SAMPLE NUMBER:	KD41	945090
MTR CODE : SITE NAME:	71625	N/A
SAMPLE DATE TIME (Hrs):	5/6/94	0915
SAMPLED BY:	N/A	
DATE OF TPH EXT. ANAL.:	5/10/94	5/10/94
DATE OF BTEX EXT. ANAL.:	5/13/94	5/15/94
TYPE DESCRIPTION:	VC	Red Sand / Clay

REMARKS:

RESULTS

PARAMETER	RESULT	UNITS	QUALIFIERS			
			DF	Q	M(g)	V(ml)
BENZENE	<0.025	MG/KG				
TOLUENE	0.042	MG/KG				
ETHYL BENZENE	<0.025	MG/KG				
TOTAL XYLENES	0.10	MG/KG				
TOTAL BTEX	0.19	MG/KG				
TPH (418.1)	<10	MG/KG			2.01	28
HEADSPACE PID	22	PPM				
PERCENT SOLIDS	89.8	%				

- TPH is by EPA Method 418.1 and BTEX is by EPA Method 8020 -

The Surrogate Recovery was at 99 % for this sample All QA/QC was acceptable.

Narrative: ATI results attached.

DF = Dilution Factor Used

Approved By: John Sardi

Date: 6/15/94



Analytical **Technologies**, Inc.

2709-D Pan American Freeway, NE Albuquerque, NM 87107
Phone (505) 344-3777 FAX (505) 344-4413

copy

ATI I.D. **405343**

May 27, 1994

El Paso Natural Gas Company
770 W. Navajo
Farmington, NM 87401

Project Name/Number: PIT CLOSURE 24324

Attention: John Lambdin



On **05/11/94**, Analytical Technologies, Inc., (ADHS License No. AZ0015), received a request to analyze **aqueous** and **non-aqueous** samples. The samples were analyzed with EPA methodology or equivalent methods. The results of these analyses and the quality control data, which follow each set of analyses, are enclosed.

Client instructed ATI (verbally) to perform a TRPH (418.1) analysis on field ID 945100 (ATI ID 405343-24).

Client instructed ATI (verbally) to continue analysis on field ID 940831 (ATI ID 405343-25) past hold time, as received.

Client was informed that field ID 945085 (ATI ID 405343-01) was received with headspace. Samples were analyzed "as is."

This report is being reissued to correct sample ID's.

If you have any questions or comments, please do not hesitate to contact us at (505) 344-3777.

Letitia Krakowski, Ph.D.
Project Manager

H. Mitchell Rubenstein, Ph.D.
Laboratory Manager

MR:jd

Enclosure



GAS CHROMATOGRAPHY RESULTS

TEST : BTEX (EPA 8020)
 CLIENT : EL PASO NATURAL GAS CO. ATI I.D.: 405343
 PROJECT # : 24324
 PROJECT NAME : PIT CLOSURE

SAMPLE ID. #	CLIENT I.D.	MATRIX	DATE SAMPLED	DATE EXTRACTED	DATE ANALYZED	DIL. FACTOR
14	945090	NON-AQ	05/06/94	05/13/94	05/15/94	1
15	945091	NON-AQ	05/06/94	05/13/94	05/15/94	20
16	945092	NON-AQ	05/06/94	05/13/94	05/15/94	20

PARAMETER	UNITS	14	15	16
BENZENE	MG/KG	<0.025	<0.50	<0.50
TOLUENE	MG/KG	0.042	<0.50	4.1
ETHYLBENZENE	MG/KG	<0.025	6.8	3.3
TOTAL XYLENES	MG/KG	0.10	73	31

SURROGATE:

BROMOFLUOROBENZENE (%) 99 220* 59*

*OUTSIDE ATI QUALITY CONTROL LIMITS DUE TO MATRIX INTERFERENCE