

(SUBMIT IN TRIPLICATE)

UNITED STATES
DEPARTMENT OF THE INTERIOR
GEOLOGICAL SURVEY

Budget Bureau No. 42-R358.4.
Approval expires 12-31-60.

Santa Fe

Land Office

078197

Lease No.

Unit E/2

SUNDRY NOTICES AND REPORTS ON WELLS

NOTICE OF INTENTION TO DRILL	X	SUBSEQUENT REPORT OF WATER SHUT-OFF	
NOTICE OF INTENTION TO CHANGE PLANS		SUBSEQUENT REPORT OF SHOOTING OR ACIDIZING	
NOTICE OF INTENTION TO TEST WATER SHUT-OFF		SUBSEQUENT REPORT OF ALTERING CASING	
NOTICE OF INTENTION TO RE-DRILL OR REPAIR WELL		SUBSEQUENT REPORT OF RE-DRILLING OR REPAIR	
NOTICE OF INTENTION TO SHOOT OR ACIDIZE		SUBSEQUENT REPORT OF ABANDONMENT	
NOTICE OF INTENTION TO PULL OR ALTER CASING		SUPPLEMENTARY WELL HISTORY	
NOTICE OF INTENTION TO ABANDON WELL			

(INDICATE ABOVE BY CHECK MARK NATURE OF REPORT, NOTICE, OR OTHER DATA)

December 12, 1960, 19

Turner - Nye

Well No. 8-2 is located 1600 ft. from [N] line and 1630 ft. from [E] line of sec. 8

W/4 Section 8

(1/4 Sec. and Sec. No.)

T 29-N

(Twp.)

R 10-W

(Range)

San Juan County

(Meridian)

Basin Dakota

(Field)

San Juan County

(County or Subdivision)

New Mexico

(State or Territory)

The elevation of the derrick floor above sea level is 5,791 ft.

DETAILS OF WORK

(State names of and expected depths to objective sands; show sizes, weights, and lengths of proposed casings; indicate mudding jobs, cementing points, and all other important proposed work)

Dakota Test. W/2 Section 8 (320 acres) dedicated to this well.

Casing program: 300 ft. 8-5/8" casing - 200 sacks cement, circulated to surface.
15.5# - 5-1/2" J-55 casing to be set on bottom, expected
at 6600 feet - cemented with 200 sacks cement.

Two stage tool will be used to protect Pictured Cliffs - with 100 sacks of cement.
Similar protection will be provided with 200 sacks if logs indicate Mesa Verde formation is present, and protection needed.

If commercial well indicated, formation will be
sand water fractured - and 2-7/8" E.U.E. tubing set about 20 feet off bottom.

I understand that this plan of work must receive approval in writing by the Geological Survey before operations may be commenced.

Company J. Glenn Turner

Address Box 728

Farmington, New Mexico

By
C. Beeson Neal, Agent in Farmington
Title

NUMBER OF COPIES RECEIVED	
DISTRIBUTION	
SANTA FE	
FILE	
U.S.G.S.	
LAND OFFICE	
TRANSPORTATION	OIL GAS
PRORATION OFFICE	
OPERATOR	

NEW MEXICO OIL CONSERVATION COMMISSION
WELL LOCATION AND ACREAGE DEDICATION PLAT
 SEE INSTRUCTIONS FOR COMPLETING THIS FORM ON THE REVERSE SIDE

FORM C-128
Revised 5/1/57

SECTION A

Operator J. Glenn Turner		Lease Nye		Well No. 8-2	
Unit Letter G	Section 8	Township 29 NORTH	Range 10 WEST	County SAN JUAN	
Actual Footage Location of Well: 1600 feet from the NORTH line and 1630 feet from the EAST line					
Ground Level Elev. 5781.5	Producing Formation Dakota	Pool Basin Dakota		Dedicated Acreage: 320 Acres	

- Ref. GLO Plat dated 19 April 1881
- Is the Operator the only owner in the dedicated acreage outlined on the plat below? YES ☒ NO ☐ ("Owner" means the person who has the right to drill into and to produce from any pool and to appropriate the production either for himself or for himself and another. (65-3-29 (e) NMSA 1935 Comp.)
 - If the answer to question one is "no," have the interests of all the owners been consolidated by communitization agreement or otherwise? YES ☐ NO ☐ . If answer is "yes," Type of Consolidation _____
 - If the answer to question two is "no," list all the owners and their respective interests below:

Owner	Land Description

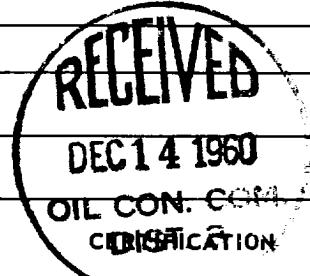

SECTION B

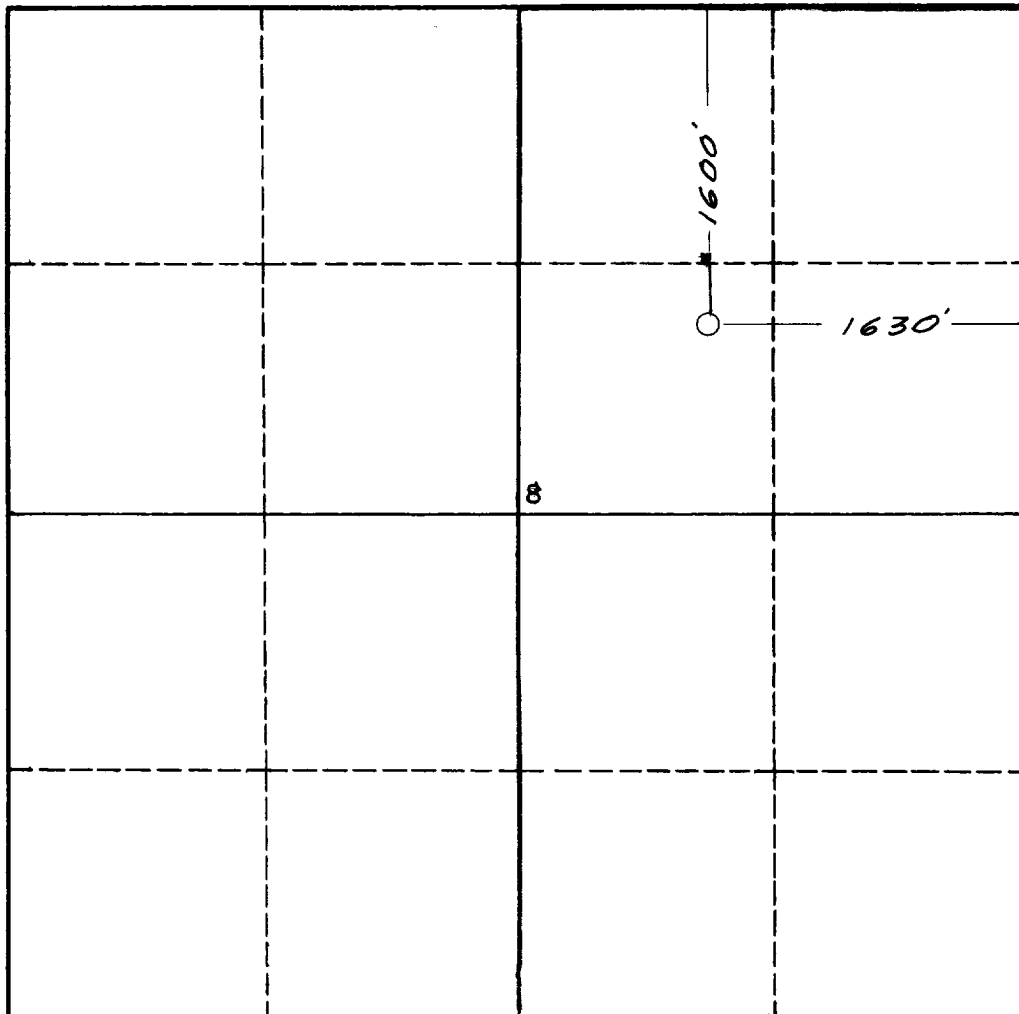

I hereby certify that the information in SECTION A above is true and complete to the best of my knowledge and belief.

Name C. Beeson Neal
Position Agent in Farmington
Company J. Glenn Turner
Date December 12, 1960

I hereby certify that the well location shown on the plat in SECTION B was plotted from field notes of actual surveys made by me or under my supervision, and that the same is true and correct to the best of my knowledge and belief.

Date Surveyed 27 October 1960
Registered Professional Engineer and/or Land Surveyor James P. Leese
Certificate No. 1463

0 330 660 990 1320 1650 1980 2310 2640 2000 1500 1000 500 0

INSTRUCTIONS FOR COMPLETION OF FORM C-128

1. Operator shall furnish and certify to the information called for in Section A.
2. Operator shall outline the dedicated acreage for *both* oil and gas wells on the plat in Section B.
3. A registered professional engineer or land surveyor registered in the State of New Mexico or approved by the Commission shall show on the plat the location of the well and certify this information in the space provided.
4. All distances shown on the plat must be from the outer boundaries of the Section.
5. If additional space is needed for listing owners and their respective interests as required in question 3 of Section A, please use space below.