



STATE OF NEW MEXICO  
ENERGY, MINERALS AND NATURAL RESOURCES DEPARTMENT

OIL CONSERVATION DIVISION

2040 S. PACHECO  
SANTA FE, NEW MEXICO 87505  
(505) 827-7131

July 7, 1997

Dugan Production Corporation  
P.O. Box 420  
Farmington, New Mexico 87499-0420  
Attention: Gary W. Brink

RECEIVED  
JUL 14 1997

OIL CON. DIV.  
DIST. 3

*Administrative Order NSL-3826*

Dear Ms. Staley:

Reference is made to your application dated June 11, 1997 for a non-standard Basin-Fruitland coal gas well location for your existing Com Well No. 1 (API No. 30-045-08722), which was drilled in 1961 and completed in the Basin-Dakota Pool at a standard gas well location 1750 feet from the South line and 1820 feet from the East line (Unit J) of Section 2, Township 29 North, Range 14 West, NMPM, San Juan County, New Mexico.

It is our understanding that the Dakota interval has been plugged off and said well was recompleted up-hole into the Basin-Fruitland Coal (Gas) Pool, which pursuant to the "*Special Rules and Regulations for the Basin-Fruitland Coal (Gas) Pool*", as promulgated by Division Order No. R-8768, as amended, is also unorthodox. Further, Lots 1 and 2, the S/2 NE/4, and the SE/4 (the E/2 equivalent) of said Section 2 is to be dedicated to the well to form a standard 316.65-acre gas spacing and proration unit for said pool.

By the authority granted me under the provisions of Rule 8 of said Order No. R-8768, as amended, the above-described unorthodox coal gas well location is hereby approved.

Sincerely,

William J. LeMay  
Director

WJL/MES/kv

cc: Oil Conservation Division - Aztec  
New Mexico State Land Office - Santa Fe

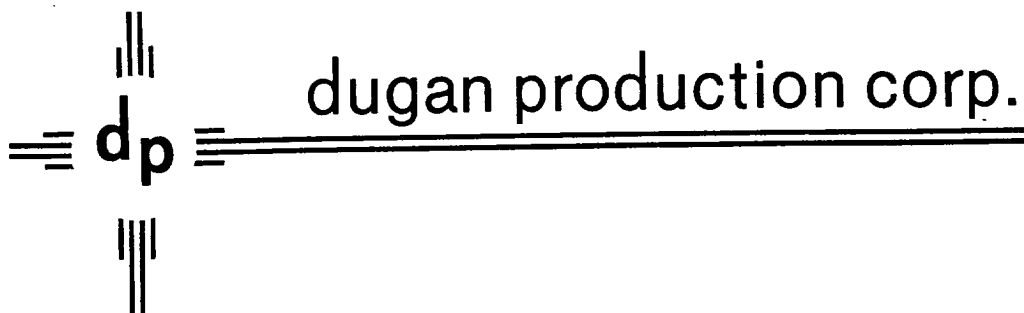

June 11, 1997

Mr. Michael E. Stogner  
New Mexico Oil Conservation Division  
2040 South Pacheco Street  
Santa Fe, NM 87505

**Subject:** *Administrative Approval of Unorthodox Location  
Dugan Production Corp.  
Com #1  
1750' FSL & 1820' FEL, Sec. 2, T29N, R14W, NMPM  
San Juan County, NM  
Basin Fruitland Coal*

*COPY*

RECEIVED  
JUN 12 1997

OIL CON. DIV.  
DIST. 3

Dear Mr. Stogner:

Dugan Production Corp. requests administrative approval for an unorthodox location for its Com #1 well under the provisions of NMOCD Order No. R-8768.

The subject well was originally drilled as a Basin Dakota well. It was later plugged back to a Basin Fruitland Coal in order to test the potential of the Coal formation in the area.

A copy of this application is being submitted to all offset operators by certified mail with a request that they furnish your office in Santa Fe a Waiver of Objection.

Attached is a well location plat showing dedicated acreage, a well location map and a map showing all offsetting operators.

Sincerely,

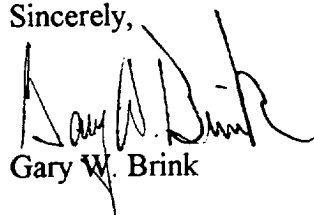

Gary W. Brink

GWB/cg

cc: New Mexico Oil Conservation Division, Aztec  
Bureau of Land Management, Farmington  
Offset Operators

Submit to Appropriate  
District Office  
State Lease - 4 copies  
Fee Lease - 3 copies

State of New Mexico  
Energy, Minerals and Natural Resources Department

Form C-102  
Revised 1-1-89

OIL CONSERVATION DIVISION

P.O. Box 2088  
Santa Fe, New Mexico 87504-2088

DISTRICT I  
P.O. Box 1980, Hobbs, NM 88240

DISTRICT II  
P.O. Drawer DD, Artesia, NM 88210

DISTRICT III  
1000 Rio Brazos Rd., Aztec, NM 87410

WELL LOCATION AND ACREAGE DEDICATION PLAT

All Distances must be from the outer boundaries of the section

Operator DUGAN PRODUCTION CORP.			Lease Com		Well No. 1
Unit Letter J	Section 2	Township 29 North	Range 14 West	County San Juan	
Actual Footage Location of Well: 1750 feet from the South line and 1820 feet from the East line					
Ground level Elev. 5516'	Producing Formation Fruitland Coal		Pool Basin Fruitland Coal	Dedicated Acreage: 316.65 Acres	

1. Outline the acreage dedicated to the subject well by colored pencil or hatchure marks on the plat below.

2. If more than one lease is dedicated to the well, outline each and identify the ownership thereof (both as to working interest and royalty).

3. If more than one lease of different ownership is dedicated to the well, have the interest of all owners been consolidated by communitization, unitization, force-pooling, etc.?

☒ Yes ☐ No If answer is "yes" type of consolidation

If answer is "no" list the owners and tract descriptions which have actually been consolidated. (Use reverse side of this form if necessary. C.A. Agrmt #NMNM 91272, approved 1/18/94, effective 12/1/90)

No allowable will be assigned to the well until all interests have been consolidated (by communitization, unitization, forced-pooling, or otherwise) or until a non-standard unit, eliminating such interest, has been approved by the Division.

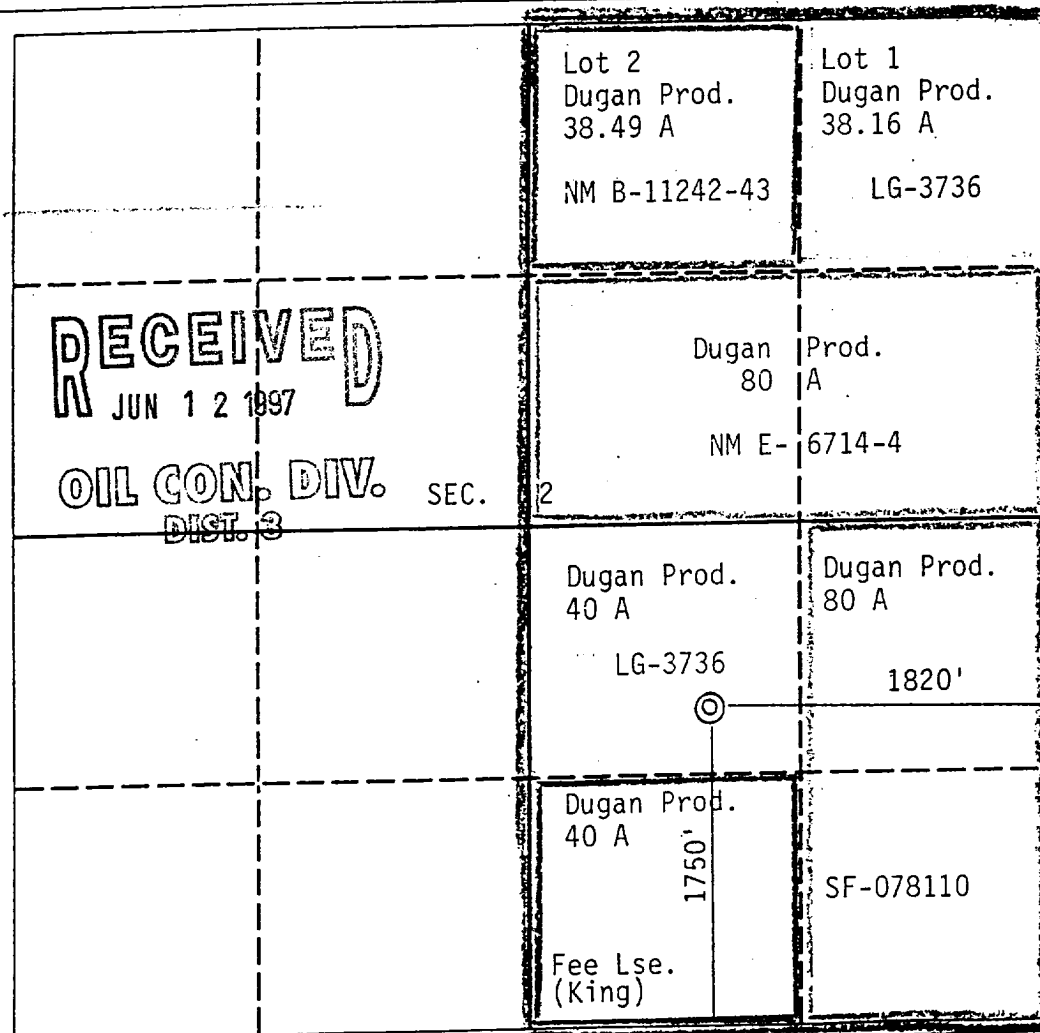

OPERATOR CERTIFICATION

I hereby certify that the information contained herein is true and complete to the best of my knowledge and belief.

Signature

Printed Name

Position

Company

Date

SURVEYOR CERTIFICATION

I hereby certify that the well location shown on this plat was plotted from field notes of actual surveys made by me or under my supervision, and that the same is true and correct to the best of my knowledge and belief.

Date Surveyed

Signature & Seal of Professional Surveyor

Original signed survey plat by James P. Leese is on file.

Certificate No.

1463

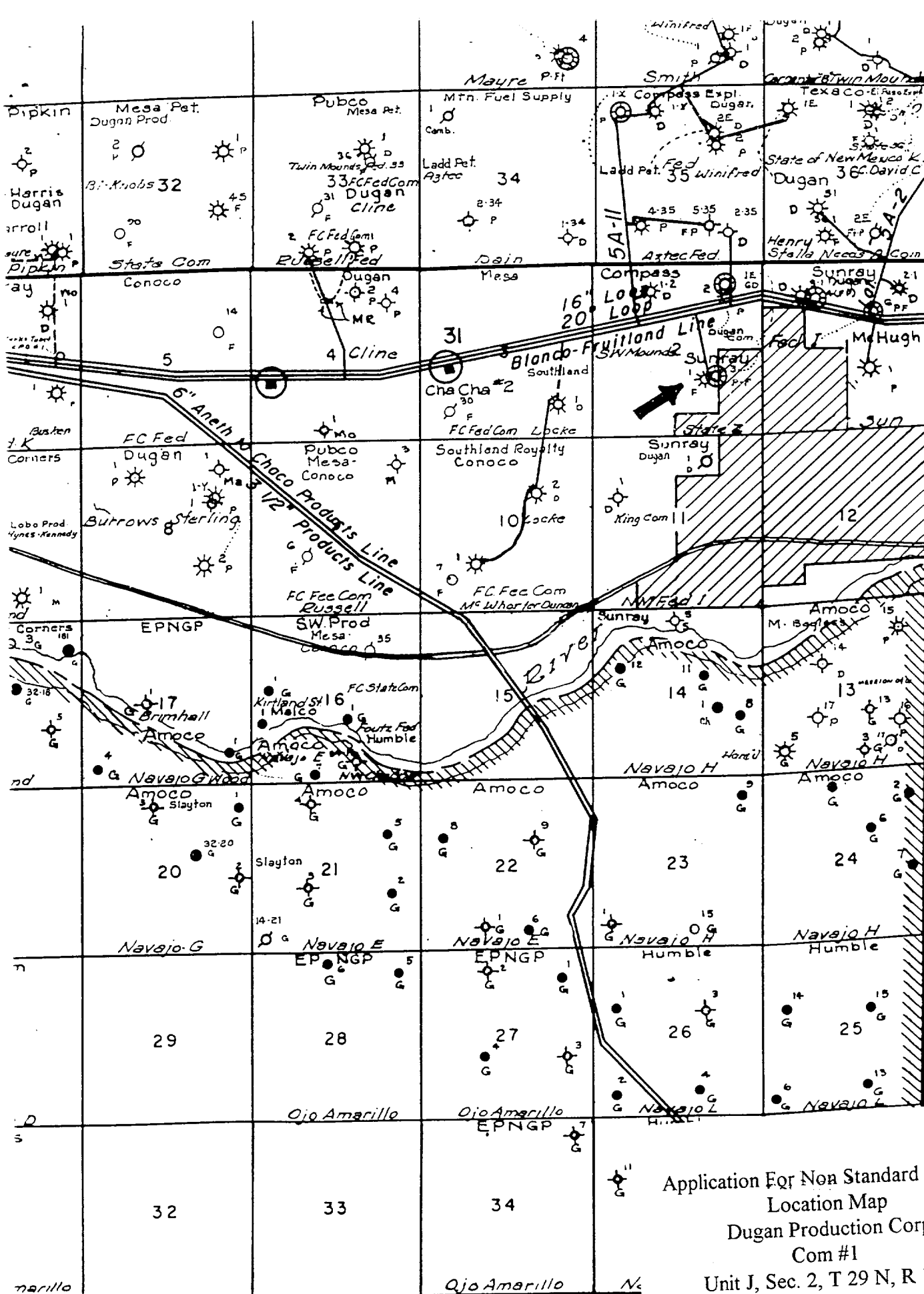

T  
29  
N

R-14-W

Application For Non Standard Location  
 Offset Operators  
 Dugan Production Corp.  
 Com #1  
 Unit J, Sec. 2, T 29 N, R 14 W  
 San Juan Co., N.M.  
 Basin Fruitland Coal

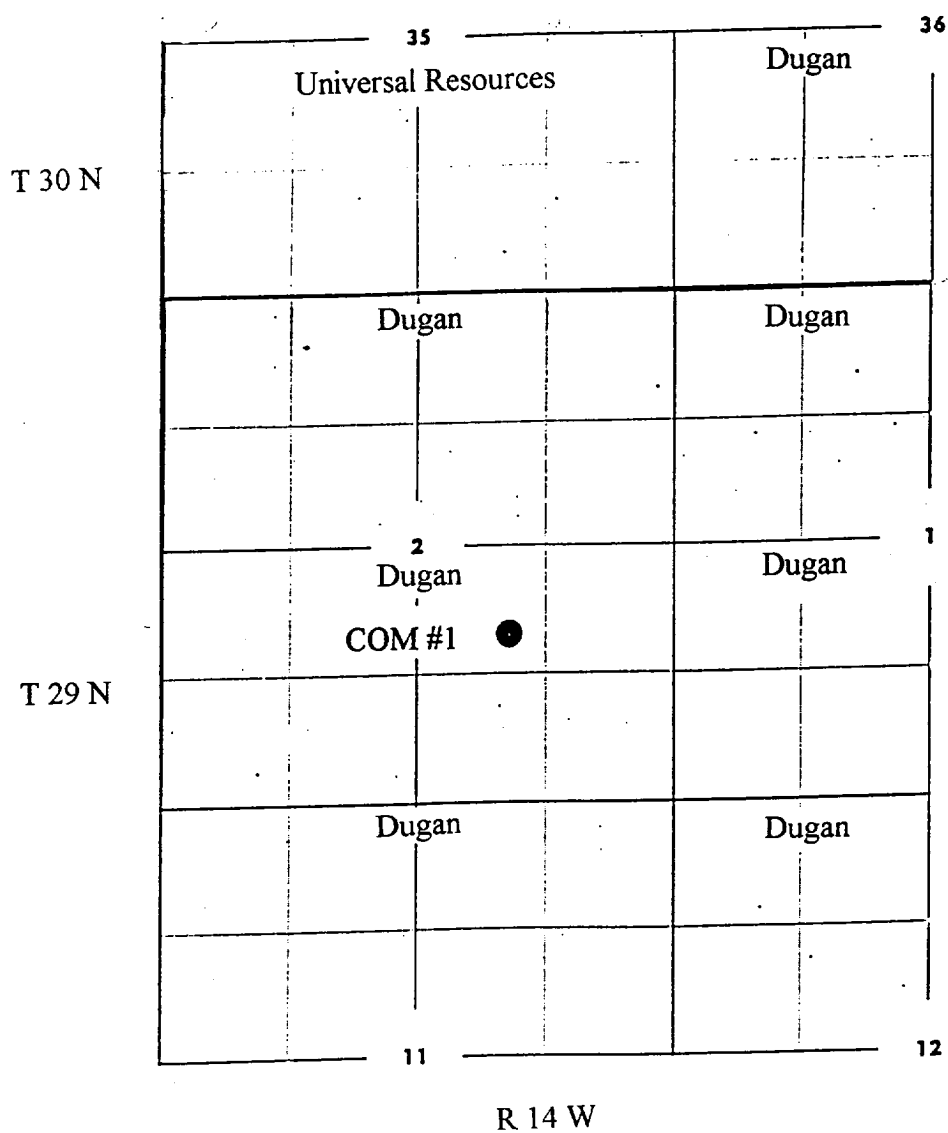

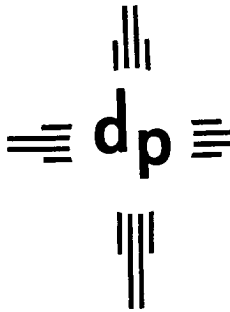

dugan production corp.

June 11, 1997

Mr. Michael E. Stogner  
New Mexico Oil Conservation Division  
2040 South Pacheco Street  
Santa Fe, NM 87505

**Subject:** *Administrative Approval of Unorthodox Location  
Dugan Production Corp.  
Com #1  
1750' FSL & 1820' FEL, Sec. 2, T29N, R14W, NMPM  
San Juan County, NM  
Basin Fruitland Coal*

**RECEIVED**  
JUN 12 1997  
**OIL CON. DIV.**  
**DIST. 3**

Dear Mr. Stogner:

Dugan Production Corp. requests administrative approval for an unorthodox location for its Com #1 well under the provisions of NMOCD Order No. R-8768.

The subject well was originally drilled as a Basin Dakota well. It was later plugged back to a Basin Fruitland Coal in order to test the potential of the Coal formation in the area.

A copy of this application is being submitted to all offset operators by certified mail with a request that they furnish your office in Santa Fe a Waiver of Objection.

Attached is a well location plat showing dedicated acreage, a well location map and a map showing all offsetting operators.

Sincerely,

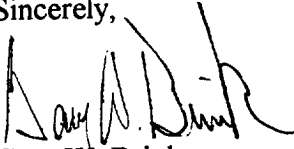

Gary W. Brink

GWB/cg

cc: New Mexico Oil Conservation Division, Aztec  
Bureau of Land Management, Farmington  
Offset Operators

Submit to Appropriate  
District Office  
State Lease - 4 copies  
Fee Lease - 3 copies

State of New Mexico  
Energy, Minerals and Natural Resources Department

Form C-102  
Revised 1-1-89

OIL CONSERVATION DIVISION

P.O. Box 2088  
Santa Fe, New Mexico 87504-2088

DISTRICT I  
P.O. Box 1980, Hobbs, NM 88240

DISTRICT II  
P.O. Drawer DD, Artesia, NM 88210

DISTRICT III  
1000 Rio Brazos Rd., Aztec, NM 87410

WELL LOCATION AND ACREAGE DEDICATION PLAT

All Distances must be from the outer boundaries of the section

Operator DUGAN PRODUCTION CORP.			Lease Com		Well No. 1
Unit Letter J	Section 2	Township 29 North	Range 14 West	County San Juan	
Actual Footage Location of Well: 1750 feet from the South line and 1820 feet from the East line					
Ground level Elev. 5516'	Producing Formation Fruitland Coal		Pool Basin Fruitland Coal	Dedicated Acreage: 316.65 Acres	

1. Outline the acreage dedicated to the subject well by colored pencil or hatchure marks on the plat below.

2. If more than one lease is dedicated to the well, outline each and identify the ownership thereof (both as to working interest and royalty).

3. If more than one lease of different ownership is dedicated to the well, have the interest of all owners been consolidated by communitization, unitization, force-pooling, etc.?

☒ Yes ☐ No If answer is "yes" type of consolidation

If answer is "no" list the owners and tract descriptions which have actually been consolidated. (Use reverse side of this form if necessary. C.A. Agrmt #NMNM 91272, approved 1/18/94, effective 12/1/90

No allowable will be assigned to the well until all interests have been consolidated (by communitization, unitization, forced-pooling, or otherwise) or until a non-standard unit, eliminating such interest, has been approved by the Division.

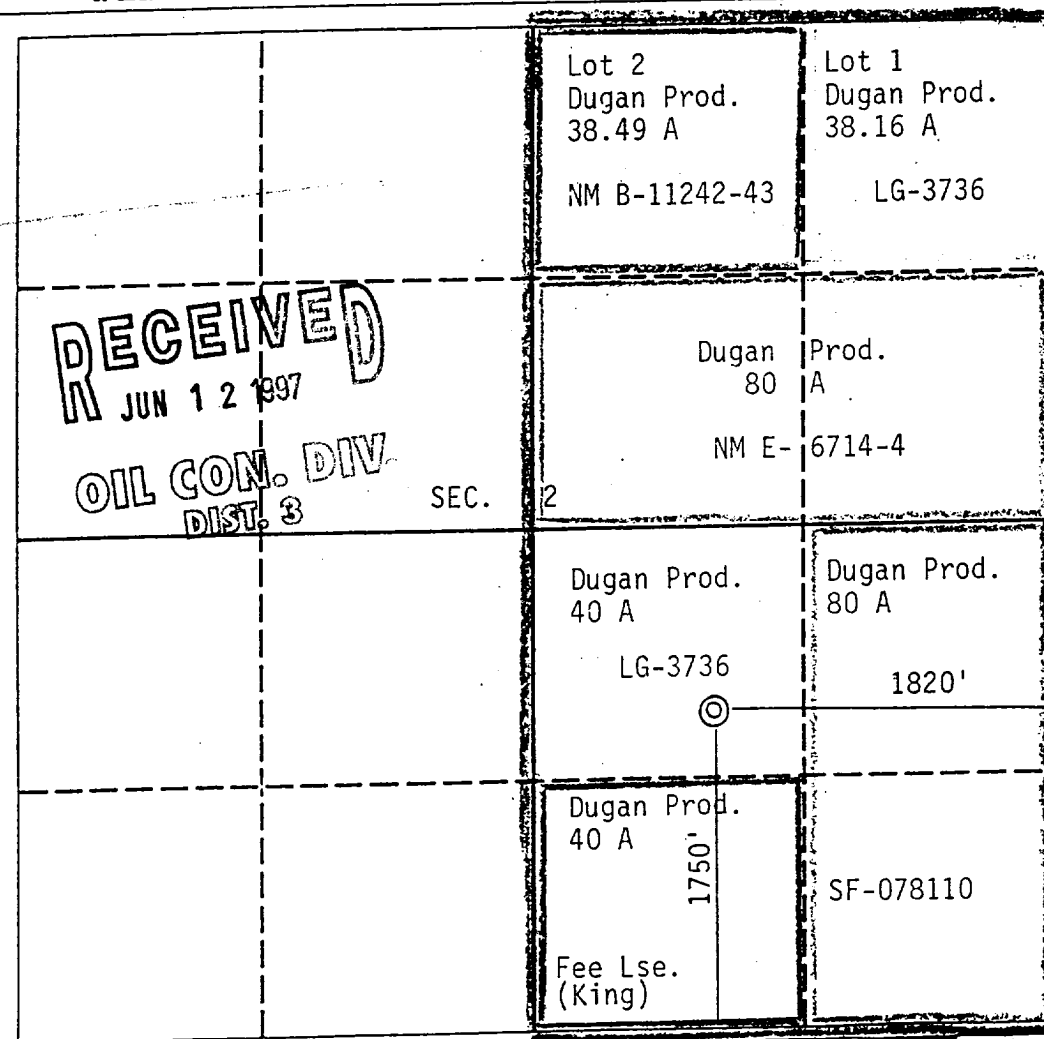

OPERATOR CERTIFICATION

I hereby certify that the information contained herein is true and complete to the best of my knowledge and belief.

Signature

Printed Name

Position

Company

Date

SURVEYOR CERTIFICATION

I hereby certify that the well location shown on this plat was plotted from field notes of actual surveys made by me or under my supervision, and that the same is true and correct to the best of my knowledge and belief.

Date Surveyed

Signature & Seal of  
Professional Surveyor

Original signed survey  
plat by James P. Leese  
is on file.

Certificate No.

1463

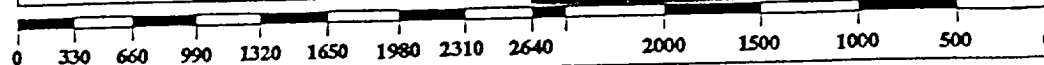

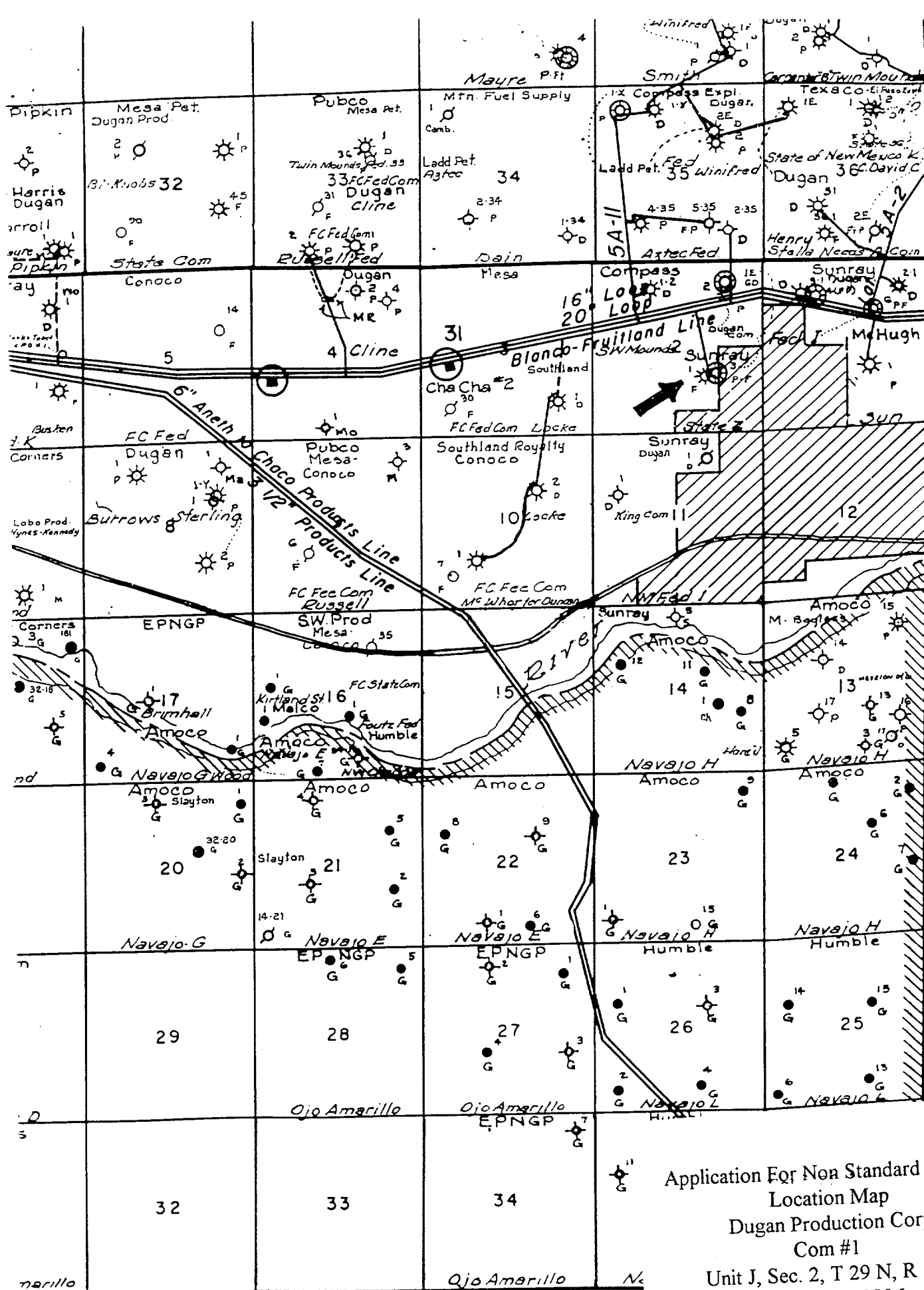

T  
29  
N

R-14-W

Application For Non Standard Location  
Location Map  
Dugan Production Corp.  
Com #1  
Unit J, Sec. 2, T 29 N, R 14 W  
San Juan Co., N.M.  
Basin Fruitland Coal



Application For Non Standard Location  
 Offset Operators  
 Dugan Production Corp.  
 Com #1  
 Unit J, Sec. 2, T 29 N, R 14 W  
 San Juan Co., N.M.  
 Basin Fruitland Coal

	35	36
	Universal Resources	Dugan
T 30 N		
	Dugan	Dugan
	2	1
	Dugan	Dugan
T 29 N	COM #1 ●	
	Dugan	Dugan
	11	12
	R 14 W	