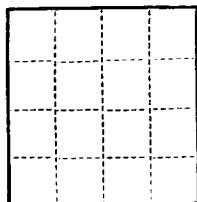

(SUBMIT IN TRIPLICATE)

Land Office **Santa Fe**Lease No. **078581-A**UNITED STATES
DEPARTMENT OF THE INTERIOR
GEOLOGICAL SURVEYUnit **Northeast Blance**
Unit Agreement No 1 Sec 929

SUNDRY NOTICES AND REPORTS ON WELLS

	NOTICE OF INTENTION TO DRILL	<input checked="" type="checkbox"/>	SUBSEQUENT REPORT OF WATER SHUT-OFF	
	NOTICE OF INTENTION TO CHANGE PLANS		SUBSEQUENT REPORT OF SHOOTING OR ACIDIZING	
	NOTICE OF INTENTION TO TEST WATER SHUT-OFF		SUBSEQUENT REPORT OF ALTERING CASING	
	NOTICE OF INTENTION TO RE-DRILL OR REPAIR WELL		SUBSEQUENT REPORT OF RE-DRILLING OR REPAIR	
	NOTICE OF INTENTION TO SHOOT OR ACIDIZE		SUBSEQUENT REPORT OF ABANDONMENT	
	NOTICE OF INTENTION TO PULL OR ALTER CASING		SUPPLEMENTARY WELL HISTORY	
	NOTICE OF INTENTION TO ABANDON WELL			

(INDICATE ABOVE BY CHECK MARK NATURE OF REPORT, NOTICE, OR OTHER DATA)

July 13, 1953

Well No. **9-12** is located **990** ft. from **S** line and **1970** ft. from **W** line of sec. **12**
Sec 12 **30 N** **8 W** **New Mexico Principal**
 (1/4 Sec. and Sec. No.) (Twp.) (Range) (Meridian)
Blanco **San Juan** **New Mexico**
 (Field) (County or Subdivision) (State or Territory)

The elevation of the derrick floor above sea level is **- -** ft.

DETAILS OF WORK

(State names of and expected depths to objective sands; show sizes, weights, and lengths of proposed casings; indicate mudding jobs, cementing points, and all other important proposed work)

This ~~unorthodox~~ location was approved by the New Mexico Oil Conservation Commission by letter dated May 27, 1953.

Set approximately 200' of 10-3/4" 32.75# surface casing and circulate cement.

Set approximately 4,820' of 7" 20# & 23# production string and cement with 300 or more sacks of cement if necessary.

Drill to a total depth of approximately 5,470' to test the Mesa Verde formation.

I understand that this plan of work must receive approval in writing by the Geological Survey before operations may be commenced.

Company **Blackwood & Nichols Company (Unit Operator)**Address **P. O. Box 611**
Durango, ColoradoBy **De Laso Loos**Title **Field Superintendent**

RECEIVED

JUL 20 1953

U. S. GEOLOGICAL SURVEY
FARMINGTON, N. M.

Company.....Blackwood-Nichols.....

Lease..... Well No.....

Sec.....12....., T.....30 N....., R.....8 W., N.M.P.M..

Location.....990' from the South line and 1970' from
the West line.

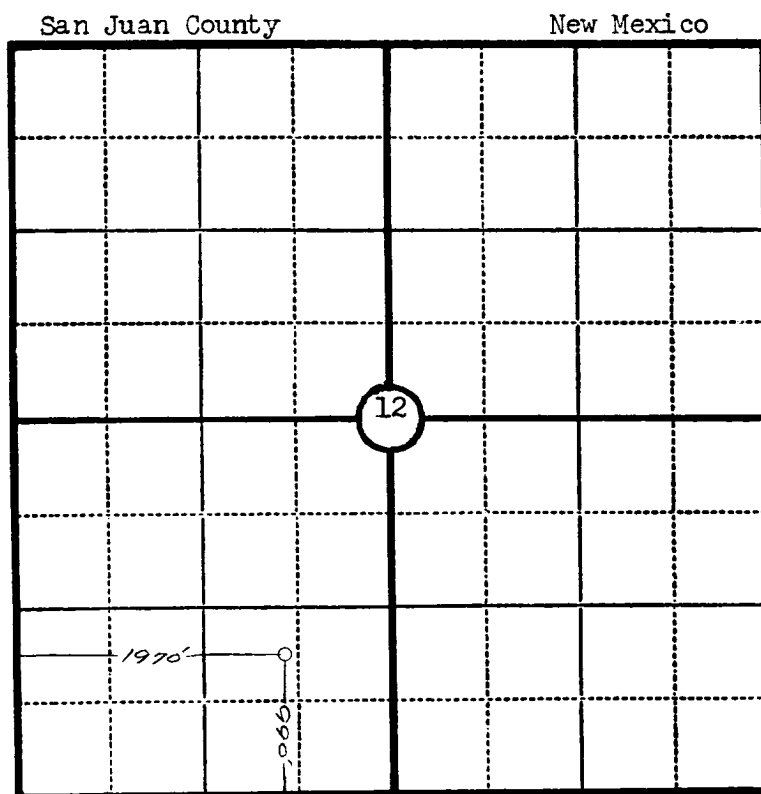

Scale—4 inches equal 1 mile.

This is to certify that the above plat was prepared from field notes of actual surveys made by me or under my supervision and that the same are true and correct to the best of my knowledge and belief.

Charles J. Finklea

Seal:

Registered Professional
Engineer and Land Surveyor.

Charles J. Finklea
N. Mex. Reg. No. 1302

Surveyed May 18, 1953

Company.....Blackwood-Nichols.....

Lease..... Well No.....

Sec..... 12....., T..... 30 N....., R..... 8 W., N.M.P.M.....

Location..... 990' from the South line and 1970' from
the West line.

San Juan County

New Mexico

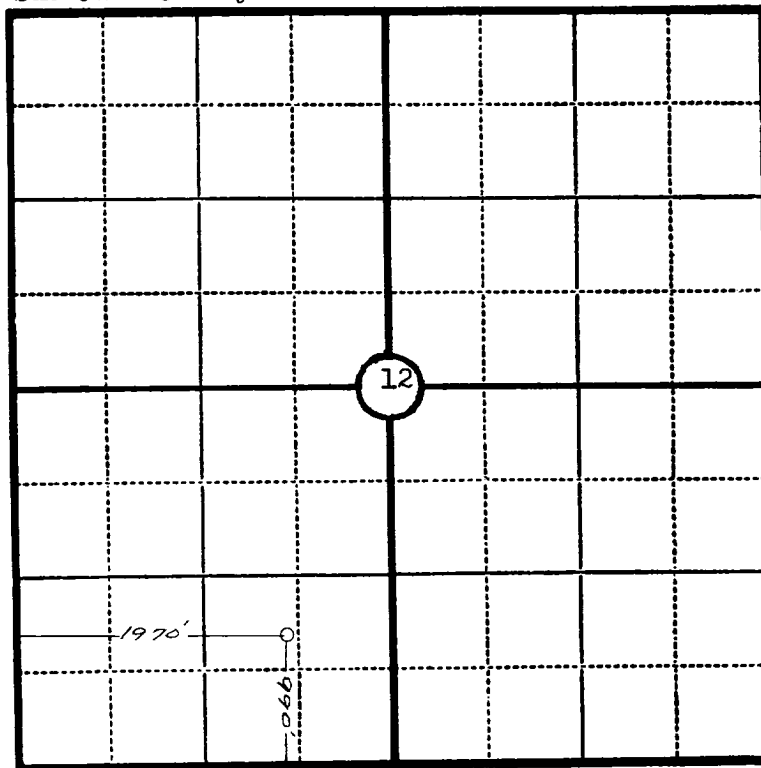

Scale—4 inches equal 1 mile.

This is to certify that the above plat was prepared from field notes of actual surveys made by me or under my supervision and that the same are true and correct to the best of my knowledge and belief.

Charles J. Finklea

Seal:

Registered Professional
Engineer and Land Surveyor.

Charles J. Finklea
N. Mex. Reg. No. 1302

Surveyed May 18....., 19...53.

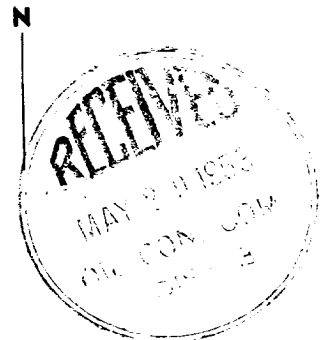

OIL CONSERVATION COMMISSION
P. O. BOX 871
SANTA FE, NEW MEXICO

May 27, 1953

C
O
P
Y

Blackwood & Nichols
Box 611
Durango, Colorado

Attention: Mr. DeLasso Loos

Gentlemen:

This will acknowledge your letter of May 25, 1953 in which you refer to an unorthodox location to be located 1970 feet from the West line and 990 feet from the South line of Section 12, Township 30 North, Range 8 West, San Juan County, New Mexico.

Under authority granted to me by Rule 104 of the Commission, this will constitute your permission to drill and produce the unorthodox well as you have set it out in your letter.

A copy of this letter is being sent to our Aztec, New Mexico office in whose district the location will be produced.

Very truly yours,

R. R. Spurrier
R. R. Spurrier
Secretary-Director

vc
cc: Aztec
USGS, Farmington
Unorthodox File
Well File



NOT CONSERVATION COMMISSION

U.S. O. BOX 371

SAVILLA DE NEW MEXICO

ALL INFORMATION CONTAINED
HEREIN IS UNCLASSIFIED
DATE 08-22-2011 BY 60322 UCBAW/SJS

7. *Phragmites australis* (Cav.) Trin. ex Steud.

[illegible]

1. The first step in the development of a self-concept is the awareness of one's own existence. This is the foundation upon which all other self-concepts are built. It is the recognition that one is a distinct individual, separate from others.

1. The first line of the text is "The first line of the text is".
2. The second line of the text is "The second line of the text is".
3. The third line of the text is "The third line of the text is".
4. The fourth line of the text is "The fourth line of the text is".
5. The fifth line of the text is "The fifth line of the text is".
6. The sixth line of the text is "The sixth line of the text is".
7. The seventh line of the text is "The seventh line of the text is".
8. The eighth line of the text is "The eighth line of the text is".
9. The ninth line of the text is "The ninth line of the text is".
10. The tenth line of the text is "The tenth line of the text is".
11. The eleventh line of the text is "The eleventh line of the text is".
12. The twelfth line of the text is "The twelfth line of the text is".
13. The thirteenth line of the text is "The thirteenth line of the text is".
14. The fourteenth line of the text is "The fourteenth line of the text is".
15. The fifteenth line of the text is "The fifteenth line of the text is".
16. The sixteenth line of the text is "The sixteenth line of the text is".
17. The seventeenth line of the text is "The seventeenth line of the text is".
18. The eighteenth line of the text is "The eighteenth line of the text is".
19. The nineteenth line of the text is "The nineteenth line of the text is".
20. The twentieth line of the text is "The twentieth line of the text is".
21. The twenty-first line of the text is "The twenty-first line of the text is".
22. The twenty-second line of the text is "The twenty-second line of the text is".
23. The twenty-third line of the text is "The twenty-third line of the text is".
24. The twenty-fourth line of the text is "The twenty-fourth line of the text is".
25. The twenty-fifth line of the text is "The twenty-fifth line of the text is".
26. The twenty-sixth line of the text is "The twenty-sixth line of the text is".
27. The twenty-seventh line of the text is "The twenty-seventh line of the text is".
28. The twenty-eighth line of the text is "The twenty-eighth line of the text is".
29. The twenty-ninth line of the text is "The twenty-ninth line of the text is".
30. The thirtieth line of the text is "The thirtieth line of the text is".
31. The thirty-first line of the text is "The thirty-first line of the text is".
32. The thirty-second line of the text is "The thirty-second line of the text is".
33. The thirty-third line of the text is "The thirty-third line of the text is".
34. The thirty-fourth line of the text is "The thirty-fourth line of the text is".
35. The thirty-fifth line of the text is "The thirty-fifth line of the text is".
36. The thirty-sixth line of the text is "The thirty-sixth line of the text is".
37. The thirty-seventh line of the text is "The thirty-seventh line of the text is".
38. The thirty-eighth line of the text is "The thirty-eighth line of the text is".
39. The thirty-ninth line of the text is "The thirty-ninth line of the text is".
40. The fortieth line of the text is "The fortieth line of the text is".
41. The forty-first line of the text is "The forty-first line of the text is".
42. The forty-second line of the text is "The forty-second line of the text is".
43. The forty-third line of the text is "The forty-third line of the text is".
44. The forty-fourth line of the text is "The forty-fourth line of the text is".
45. The forty-fifth line of the text is "The forty-fifth line of the text is".
46. The forty-sixth line of the text is "The forty-sixth line of the text is".
47. The forty-seventh line of the text is "The forty-seventh line of the text is".
48. The forty-eighth line of the text is "The forty-eighth line of the text is".
49. The forty-ninth line of the text is "The forty-ninth line of the text is".
50. The fiftieth line of the text is "The fiftieth line of the text is".
51. The fifty-first line of the text is "The fifty-first line of the text is".
52. The fifty-second line of the text is "The fifty-second line of the text is".
53. The fifty-third line of the text is "The fifty-third line of the text is".
54. The fifty-fourth line of the text is "The fifty-fourth line of the text is".
55. The fifty-fifth line of the text is "The fifty-fifth line of the text is".
56. The fifty-sixth line of the text is "The fifty-sixth line of the text is".
57. The fifty-seventh line of the text is "The fifty-seventh line of the text is".
58. The fifty-eighth line of the text is "The fifty-eighth line of the text is".
59. The fifty-ninth line of the text is "The fifty-ninth line of the text is".
60. The sixtieth line of the text is "The sixtieth line of the text is".
61. The sixty-first line of the text is "The sixty-first line of the text is".
62. The sixty-second line of the text is "The sixty-second line of the text is".
63. The sixty-third line of the text is "The sixty-third line of the text is".
64. The sixty-fourth line of the text is "The sixty-fourth line of the text is".
65. The sixty-fifth line of the text is "The sixty-fifth line of the text is".
66. The sixty-sixth line of the text is "The sixty-sixth line of the text is".
67. The sixty-seventh line of the text is "The sixty-seventh line of the text is".
68. The sixty-eighth line of the text is "The sixty-eighth line of the text is".
69. The sixty-ninth line of the text is "The sixty-ninth line of the text is".
70. The seventieth line of the text is "The seventieth line of the text is".
71. The seventy-first line of the text is "The seventy-first line of the text is".
72. The seventy-second line of the text is "The seventy-second line of the text is".
73. The seventy-third line of the text is "The seventy-third line of the text is".
74. The seventy-fourth line of the text is "The seventy-fourth line of the text is".
75. The seventy-fifth line of the text is "The seventy-fifth line of the text is".
76. The seventy-sixth line of the text is "The seventy-sixth line of the text is".
77. The seventy-seventh line of the text is "The seventy-seventh line of the text is".
78. The seventy-eighth line of the text is "The seventy-eighth line of the text is".
79. The seventy-ninth line of the text is "The seventy-ninth line of the text is".
80. The eightieth line of the text is "The eightieth line of the text is".
81. The eighty-first line of the text is "The eighty-first line of the text is".
82. The eighty-second line of the text is "The eighty-second line of the text is".
83. The eighty-third line of the text is "The eighty-third line of the text is".
84. The eighty-fourth line of the text is "The eighty-fourth line of the text is".
85. The eighty-fifth line of the text is "The eighty-fifth line of the text is".
86. The eighty-sixth line of the text is "The eighty-sixth line of the text is".
87. The eighty-seventh line of the text is "The eighty-seventh line of the text is".
88. The eighty-eighth line of the text is "The eighty-eighth line of the text is".
89. The eighty-ninth line of the text is "The eighty-ninth line of the text is".
90. The ninetieth line of the text is "The ninetieth line of the text is".
91. The ninety-first line of the text is "The ninety-first line of the text is".
92. The ninety-second line of the text is "The ninety-second line of the text is".
93. The ninety-third line of the text is "The ninety-third line of the text is".
94. The ninety-fourth line of the text is "The ninety-fourth line of the text is".
95. The ninety-fifth line of the text is "The ninety-fifth line of the text is".
96. The ninety-sixth line of the text is "The ninety-sixth line of the text is".
97. The ninety-seventh line of the text is "The ninety-seventh line of the text is".
98. The ninety-eighth line of the text is "The ninety-eighth line of the text is".
99. The ninety-ninth line of the text is "The ninety-ninth line of the text is".
100. The hundredth line of the text is "The hundredth line of the text is".

1. The first step is to identify the problem or question that needs to be answered. This involves understanding the context and the specific information required.

L. K. Lawrence

