

OIL CONSERVATION COMMISSION  
ALBERT DISTRICT

OIL CONSERVATION COMMISSION  
BOX 871  
SANTA FE, NEW MEXICO

DATE 4-20-67

Re: Proposed NSP \_\_\_\_\_

Proposed NWU \_\_\_\_\_

Proposed NSL xxx \_\_\_\_\_

Proposed NFO \_\_\_\_\_

Proposed DC \_\_\_\_\_

Gentlemen:

I have examined the application dated 4-11-67  
for the Walter Duncan North Hogback 7 #2 D-7-29N-16W  
Operator Lease and Well No. S-T-R

and my recommendations are as follows:

Approve  
\_\_\_\_\_  
\_\_\_\_\_  
\_\_\_\_\_  
\_\_\_\_\_  
\_\_\_\_\_

Yours very truly,

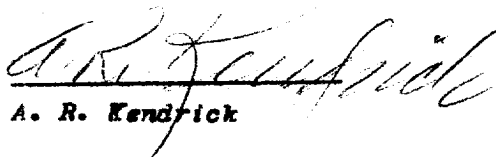
  
A. R. Kendrick

WALTER DUNCAN  
OIL PROPERTIES  
Post Office Box 137  
Durango, Colorado

April 11, 1967

NOTICE  
APR 14 1967

RECEIVED  
APR 14 9 56 AM '67  
STATE LAND OFFICE  
SANTA FE, N.M.

New Mexico Oil and Gas Commission  
Box 791  
Santa Fe, New Mexico

ATTENTION: Mr. A. L. Porter

Dear Mr. Porter:

Walter Duncan proposes to drill a test to be located 1310' from the north line and 330' from the west line of Section 7, Township 29 North, Range 16 West, San Juan County, New Mexico. Enclosed for your information is a photocopy of the well location plat prepared by Mr. Frederick H. Reed, Registered Land Surveyor.

We realize this is an irregular location; however, we request administrative approval to drill the location as staked because of topographic reasons: The location is 18' from a steep cliff going down to the San Juan River, and in order to effectively test as an offset to our producing Walter Duncan, North Hogback 12, Well No. 1, this is the best geographic location we could arrive at. Walter Duncan is also the owner of the leases adjoining to the north and to the west. For your information we have also prepared and enclose here-with a plat showing the proposed location, the river and the cliff.

We would very much appreciate your early and favorable consideration of this matter. Please call us if there is any question with which we may be able to help.

Yours very truly,

WALTER DUNCAN

Raymond T. Duncan

RTD:br  
Encl,



T29N-R17W T29N-R16W

6

Walter Duncan  
NM 97  
4-9-71

Walter Duncan  
NM 115  
12-12-71

SAN

JUAN

Walter Duncan  
NM 117  
12-12-71

Walter Duncan  
NM 116  
12-12-71

No Hogback 12  
Well No. 1

330'

Proposed Location  
No. Hogback 7  
Well No. 2

No Hogback 7  
Well No. 1

RIVER

RECEIVED

APR 14 3 56 AM '67

STATE LAND OFFICE  
SANTA FE, N. M.

WALTER DUNCAN OIL PROPERTIES  
NORTH HOGBACK AREA  
SAN JUAN COUNTY, NEW MEXICO

NEW MEXICO OIL CONSERVATION COMMISSION  
WELL LOCATION AND ACREAGE DEDICATION PLAT

Form C-102  
Supersedes C-128  
Effective 1-1-65

All distances must be from the outer boundaries of the Section.

Operator <b>Walter Duncan</b>		Lease <b>North Hogback 7</b>		Well No. <b>2</b>
Unit Letter	Section <b>7</b>	Township <b>29 N</b>	Range <b>16 W</b>	County <b>San Juan</b>
Actual Footage Location of Well: <b>1310</b> feet from the <b>North</b> line and <b>330</b> feet from the <b>West</b> line				
Ground Level Elev: <b>5030</b>	Producing Formation		Pool	Dedicated Acreage:  Acres

1. Outline the acreage dedicated to the subject well by colored pencil or hachure marks on the plat below.
2. If more than one lease is dedicated to the well, outline each and identify the ownership thereof (both as to working interest and royalty).
3. If more than one lease of different ownership is dedicated to the well, have the interests of all owners been consolidated by communization, unitization, force-pooling, etc?

☐ Yes ☐ No If answer is "yes," type of consolidation \_\_\_\_\_

If answer is "no," list the owners and tract descriptions which have actually been consolidated. (Use reverse side of this form if necessary.) \_\_\_\_\_

No allowable will be assigned to the well until all interests have been consolidated (by communization, unitization, forced-pooling, or otherwise) or until a non-standard unit, eliminating such interests, has been approved by the Commission.

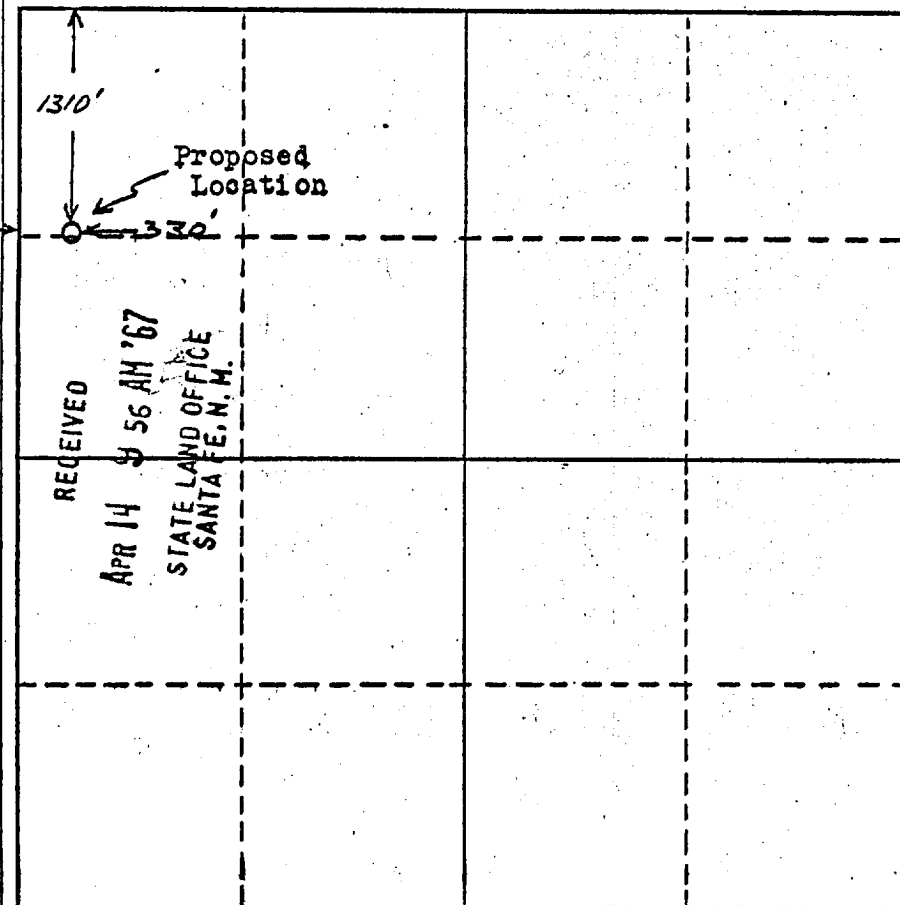

CERTIFICATION

I hereby certify that the information contained herein is true and complete to the best of my knowledge and belief.

Name

Position

Company

Date

I hereby certify that the well location shown on this plat was plotted from field notes of actual surveys made by me or under my supervision, and that the same is true and correct to the best of my knowledge and belief.

Date Surveyed

**April 10, 1967**

Registered Professional Engineer  
and/or Land Surveyor

*Frederick H. Reid*

Certificate No.

**N. M. # 3795**

0 330 660 990 1320 1650 1980 2310 2640 2970 3300 3630 3960 4290 4620 4950 5280 5610 5940 6270 6600 6930 7260 7590 7920 8250 8580 8910 9240 9570 9900 0