

30-045-20517

UNITED STATES
DEPARTMENT OF THE INTERIOR
GEOLOGICAL SURVEY

APPLICATION FOR PERMIT TO DRILL, DEEPEN, OR PLUG BACK

1a. TYPE OF WORK
 DRILL DEEPEN PLUG BACK
 b. TYPE OF WELL
 OIL WELL GAS WELL OTHER
 SINGLE ZONE MULTIPLE ZONE

2. NAME OF OPERATOR
Aztec Oil and Gas Company

3. ADDRESS OF OPERATOR
Drawer 570, Farmington, New Mexico

4. LOCATION OF WELL (Report location clearly and in accordance with any State requirements.)*
 At surface
1120 FSL & 1090 FWL, Sec. 6-29N-11W
 At proposed prod. zone

14. DISTANCE IN MILES AND DIRECTION FROM NEAREST TOWN OR POST OFFICE*

15. DISTANCE FROM PROPOSED* LOCATION TO NEAREST PROPERTY OR LEASE LINE, FT. (Also to nearest drlg. unit line, if any)
 16. NO. OF ACRES IN LEASE
 17. NO. OF ACRES ASSIGNED TO THIS WELL
 18. DISTANCE FROM PROPOSED LOCATION* TO NEAREST WELL, DRILLING, COMPLETED, OR APPLIED FOR, ON THIS LEASE, FT.
 19. PROPOSED DEPTH
 20. ROTARY OR CABLE TOOLS
 21. ELEVATIONS (Show whether DF, RT, GR, etc.)
 22. APPROX. DATE WORK WILL START*

23. PROPOSED CASING AND CEMENTING PROGRAM

| SIZE OF HOLE | SIZE OF CASING | WEIGHT PER FOOT | SETTING DEPTH | QUANTITY OF CEMENT |
|--------------|----------------|-----------------|---------------|--------------------|
| 12-1/4 | 8-5/8 | 24# | 115' | 60 sx |
| 6-3/4 | 4-1/2 | 9.5# | 2017' | 250 sx |

Propose to:

Drill 12-1/4" hole to TD 115', set 8-5/8" casing cement w/60' sx
 Drill to TD 2017 a 6-3/4" hole, set 4 1/2" casing cement w/250 sx
 Run Induction Electric log
 Perforate and frac Pictured Cliffs
 Run 1" tubing

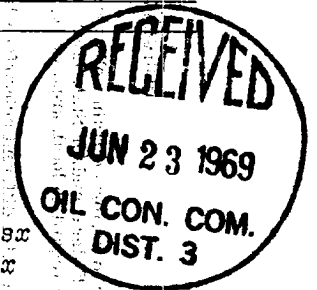

RECEIVED

JUN 19 1969

U. S. GEOLOGICAL SURVEY
FARMINGTON, N. M.

147.12

IN ABOVE SPACE DESCRIBE PROPOSED PROGRAM: If proposal is to deepen or plug back, give data on present productive zone and proposed new productive zone. If proposal is to drill or deepen directionally, give pertinent data on subsurface locations and measured and true vertical depths. Give blowout preventer program, if any.

24. SIGNED *Jac C. Beaman* TITLE District Superintendent DATE 6-16-69

(This space for Federal or State office use)

PERMIT NO. _____ APPROVAL DATE _____

APPROVED BY _____ TITLE _____ DATE _____

CONDITIONS OF APPROVAL, IF ANY:

Write NW 1/4 order

NEW MEXICO OIL CONSERVATION COMMISSION
WELL LOCATION AND ACREAGE DEDICATION PLAT

Form O-101
Supersedes O-128
Effective 1-1-65

All distances must be from the outer boundaries of the Section

| | | | | |
|--|---|--------------------------------|--|----------------------------------|
| Operator Aztec Oil & Gas Company | | Lease Cooper | | Well No. 5 |
| Unit Letter M | Section 6 | Township 29N | Range 11W | County San Juan County |
| Actual Footage Location of Well: 1120 feet from the South line and 1090 feet from the West line | | | | |
| Ground Level Elev. 5764 | Producing Formation Pictured Cliffs | Pool Pictured Cliffs | Dedicated Acreage: 1st 147.17 Acres | |

1. Outline the acreage dedicated to the subject well by colored pencil or hachure marks on the plat below.
2. If more than one lease is dedicated to the well, outline each and identify the ownership thereof (both as to working interest and royalty).
3. If more than one lease of different ownership is dedicated to the well, have the interests of all owners been consolidated by communitization, unitization, force-pooling, etc?

Yes No If answer is "yes," type of consolidation _____

If answer is "no," list the owners and tract descriptions which have actually been consolidated. (See reverse side of this form if necessary.) _____

No allowable will be assigned to the well until all interests have been consolidated (by communitization, unitization, forced-pooling, or otherwise) or until a non-standard unit, eliminating such interests, has been approved by the Commission.

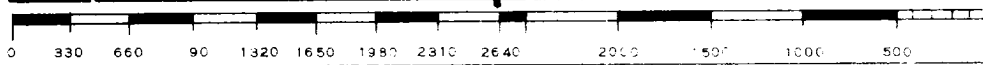
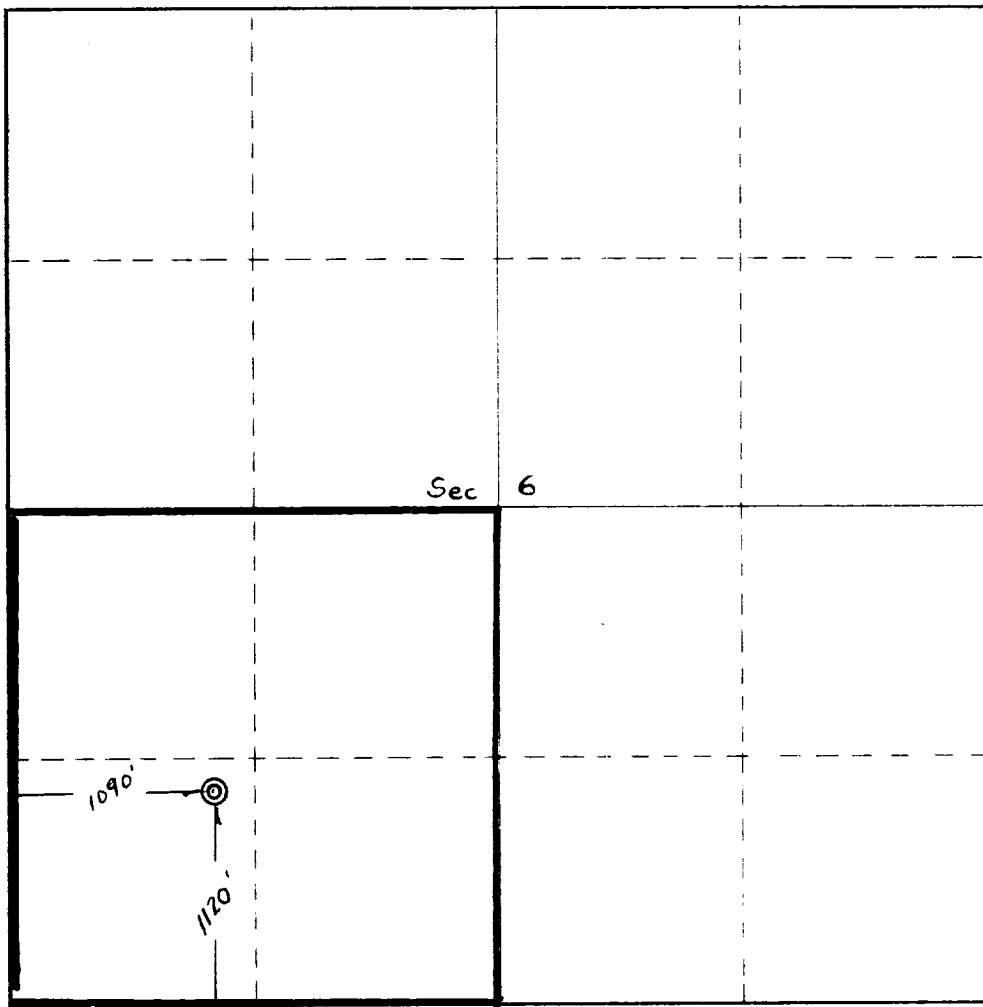
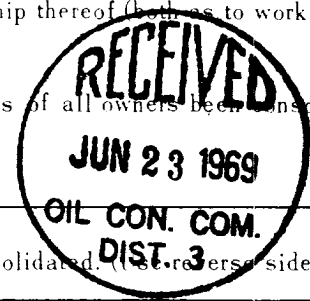

CERTIFICATION

I hereby certify that the information contained herein is true and complete to the best of my knowledge and belief.

Name: **Joe P. Wilson**

Position: **District Superintendent**

Company: **Aztec Oil and Gas**

Date: **June 10, 1969**

I hereby certify that the well location shown on this plat was plotted from field notes of actual surveys made by me or under my supervision, and that the same is true and correct to the best of my knowledge and belief.

Date Surveyed: **June 11, 1969**

Registered Professional Engineer and of legal age: _____

Signature No. **3950**