

UNITED STATES
DEPARTMENT OF THE INTERIOR

GEOLOGICAL SURVEY

APPLICATION FOR PERMIT TO DRILL, DEEPEN, OR PLUG BACK

1a. TYPE OF WORK

DRILL ☒DEEPEN ☐PLUG BACK ☐

b. TYPE OF WELL

OIL
WELL ☒GAS
WELL ☐OTHER ☐SINGLE
ZONE ☐MULTIPLE
ZONE ☐

2. NAME OF OPERATOR

Walter Duncan

3. ADDRESS OF OPERATOR

Box 234, Farmington, NM 87401

4. LOCATION OF WELL (Report location clearly and in accordance with any State requirements.*)

At surface

2146' FSL - 924' FWL

At proposed prod. zone

14. DISTANCE IN MILES AND DIRECTION FROM NEAREST TOWN OR POST OFFICE*

8 miles east southeast of Shiprock, NM

15. DISTANCE FROM PROPOSED*

LOCATION TO NEAREST
PROPERTY OR LEASE LINE, FT.
(Also to nearest drlg. unit line, if any)

924'

16. NO. OF ACRES IN LEASE

659.04

17. NO. OF ACRES ASSIGNED
TO THIS WELL

40

18. DISTANCE FROM PROPOSED LOCATION*

TO NEAREST WELL, DRILLING, COMPLETED,
OR APPLIED FOR, ON THIS LEASE, FT.

650' approx

19. PROPOSED DEPTH

720'

20. ROTARY OR CABLE TOOLS

Cable tool surface csg

Rotary btm surface csg to TD

21. ELEVATIONS (Show whether DF, RT, GR, etc.)

5002' GR

22. APPROX. DATE WORK WILL START*

12-10-75

23.

PROPOSED CASING AND CEMENTING PROGRAM

SIZE OF HOLE	SIZE OF CASING	WEIGHT PER FOOT	SETTING DEPTH	QUANTITY OF CEMENT
9"	7"	20#	30'	5 sx
6-1/4"	4-1/2"	10.5#	700'	75 sx

1. Drive 7" casing thru boulders and cement with 5 sx cement
2. Drill 6-1/4" hole to top of Dakota sand at approximately 700'
3. Run 4-1/2" casing and cement to surface with 75 sx cement
4. Drill 3-7/8" hole below 4-1/2" casing to approximately 720'
5. Complete well in open hole without stimulation of Dakota sand
6. Run 2-3/8" tubing to 710'

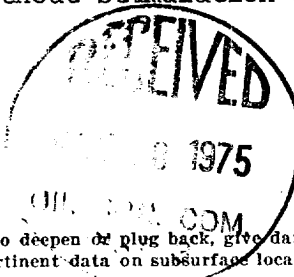
RECEIVED
NOV 17 1975U.S. GEOLOGICAL SURVEY
FARMINGTON, N.M.

IN ABOVE SPACE DESCRIBE PROPOSED PROGRAM: If proposal is to deepen or plug back, give data on present productive zone and proposed new productive zone. If proposal is to drill or deepen directionally, give pertinent data on subsurface locations and measured and true vertical depths. Give blowout preventer program, if any.

24.

SIGNED

Thomas A. Dugan

TITLE

Engineer

DATE

11-14-75

(This space for Federal or State office use)

PERMIT NO.

APPROVAL DATE

APPROVED BY

TITLE

DATE

CONDITIONS OF APPROVAL, IF ANY:

Okal

**NEW MEXICO OIL CONSERVATION COMMISSION
WELL LOCATION AND ACREAGE DEDICATION PLAT**

Form O-102
Supersedes O-12B
Effective 1-1-65

All distances must be from the outer boundaries of the Section.

Operator Walter Duncan			Lease North Hogback		Well No. 6-9
Unit Letter X	Section 6	Township 29 N	Range 16 W	County San Juan	
Actual Footage Location of Well: 2146 feet from the South line and 924 feet from the West line					
Ground Level Elev. 5002	Producing Formation Dakota	Pool Slickrock	Dedicated Acreage: 40 Acres		

1. Outline the acreage dedicated to the subject well by colored pencil or hatchure marks on the plat below.
2. If more than one lease is dedicated to the well, outline each and identify the ownership thereof (both as to working interest and royalty).
3. If more than one lease of different ownership is dedicated to the well, have the interests of all owners been consolidated by communitization, unitization, force-pooling, etc?

☐ Yes ☐ No If answer is "yes," type of consolidation _____

If answer is "no," list the owners and tract descriptions which have actually been consolidated. (Use reverse side of this form if necessary.) _____

No allowable will be assigned to the well until all interests have been consolidated (by communitization, unitization, forced-pooling, or otherwise) or until a non-standard unit, eliminating such interests, has been approved by the Commission.

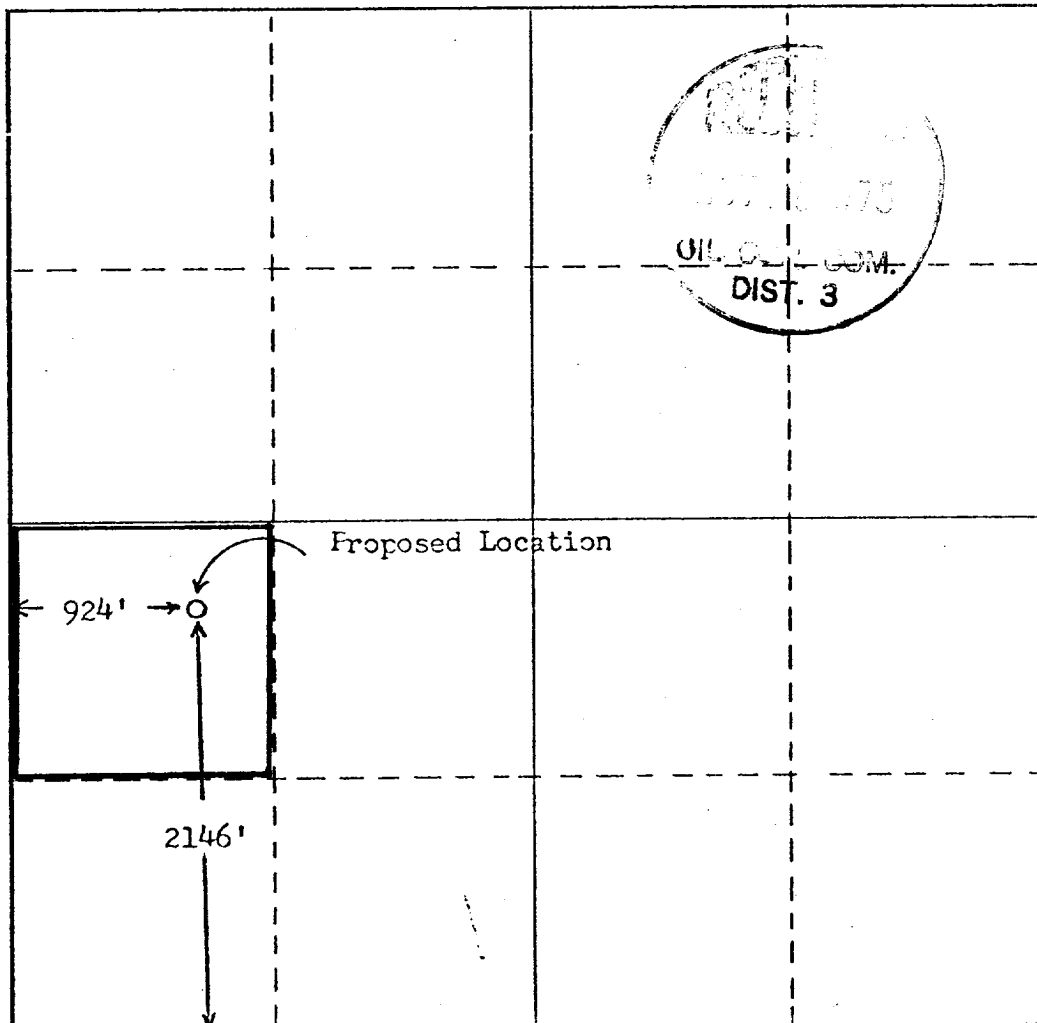

CERTIFICATION

I hereby certify that the information contained herein is true and complete to the best of my knowledge and belief.

Thomas A. Dugan
Name

Thomas A. Dugan
Position

Engineer
Company

Walter Duncan
Date

11-14-75

I hereby certify that the well location shown on this plat was plotted from field notes of actual surveys made by me or under my supervision, and that the same is true and correct to the best of my knowledge and belief.

Date Surveyed **October 31, 1975**

Registered Professional Engineer
and/or Land Surveyor

Ernest H. Reed
Certificate No.

3795

