

UNITED STATES
DEPARTMENT OF THE INTERIORGEOLOGICAL SURVEY *API 30-045-22081*

APPLICATION FOR PERMIT TO DRILL, DEEPEN, OR PLUG BACK

1a. TYPE OF WORK

DRILL ☒DEEPEN ☐PLUG BACK ☐

b. TYPE OF WELL

OIL
WELL ☐GAS
WELL ☒

OTHER

SINGLE
ZONE ☒MULTIPLE
ZONE ☐

2. NAME OF OPERATOR

El Paso Natural Gas Company

3. ADDRESS OF OPERATOR

PO Box 990, Farmington, NM 87401

4. LOCATION OF WELL (Report location clearly and in accordance with any State requirements.)*

At surface

1180'S, 1480'E

At proposed prod. zone

14. DISTANCE IN MILES AND DIRECTION FROM NEAREST TOWN OR POST OFFICE*

15. DISTANCE FROM PROPOSED*

LOCATION TO NEAREST
PROPERTY OR LEASE LINE, FT.
(Also to nearest drlg. unit line, if any)18. DISTANCE FROM PROPOSED LOCATION*
TO NEAREST WELL, DRILLING, COMPLETED,
OR APPLIED FOR, ON THIS LEASE, FT.

21. ELEVATIONS (Show whether DF, RT, GR, etc.)

5734' GR

16. NO. OF ACRES IN LEASE

19. PROPOSED DEPTH

4800'

17. NO. OF ACRES ASSIGNED
TO THIS WELL

E/ 320 ✓

20. ROTARY OR CABLE TOOLS

Rotary

12. COUNTY OR PARISH

San Juan

13. STATE

NM

5. LEASE DESIGNATION AND SERIAL NO.

NM 03999

6. IF INDIAN, ALLOTTEE OR TRIBE NAME

7. UNIT AGREEMENT NAME

8. FARM OR LEASE NAME

Grambling

9. WELL NO.

1A

10. FIELD AND POOL, OR WILDCAT

Blanco Mesa Verde

11. SEC., T., R., M., OR BLK.
AND SURVEY OR AREASec. 28, T-29-N, R-9-W
NMPM

PROPOSED CASING AND CEMENTING PROGRAM

SIZE OF HOLE	SIZE OF CASING	WEIGHT PER FOOT	SETTING DEPTH	QUANTITY OF CEMENT
13 3/4"	9 5/8"	32.3#	200'	224 cu.ft. to circulate
8 3/4"	7"	20.0#	2425'	372 cu.ft. to cover OjoAlamo
6 1/4"	4 1/2"	10.5#	2275-4800'	440 cu.ft. to fill to 2275'

Selectively perforate and sandwater fracture the Mesa Verde formation.

A 3000 psi WP and 6000 psi test double gate preventer equipped with blind and pipe rams will be used for blow out prevention on this well.

This gas is dedicated.

The E/2 of Section 28 is dedicated to this well.

IN ABOVE SPACE DESCRIBE PROPOSED PROGRAM: If proposal is to deepen or plug back, give data on present productive zone and proposed new productive zone. If proposal is to drill or deepen directionally, give pertinent data on subsurface locations and measured and true vertical depths. Give blowout preventer program, if any.

24.

SIGNED

A. G. Duico

TITLE

Drilling Clerk

DATE JUN 1 1976

(This space for Federal or State office use)

PERMIT NO.

APPROVAL DATE

APPROVED BY

TITLE

CONDITIONS OF APPROVAL, IF ANY:

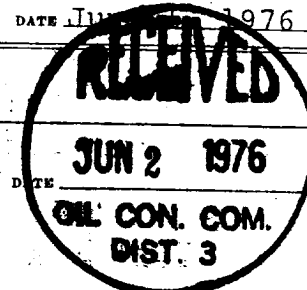
Alae

*See Instructions On Reverse Side

**NEW MEXICO OIL CONSERVATION COMMISSION
WELL LOCATION AND ACREAGE DEDICATION PLAT**

Form C-102
Supersedes C-128
Effective 1-1-65

All distances must be from the outer boundaries of the Section.

Operator EL PASO NATURAL GAS COMPANY		Lease GRAMBLING (NM-03999)		Well No. 1A
Unit Letter 0	Section 28	Township 29-N	Range 9-W	County SAN JUAN
Actual Footage Location of Well: <div style="display: flex; justify-content: space-between;"> 1180 feet from the SOUTH line and 1480 feet from the EAST line </div>				
Ground Level Elev. 5734	Producing Formation MESA VERDE	Pool BLANCO MESA VERDE	Dedicated Acreage: 320.00 Acres	

1. Outline the acreage dedicated to the subject well by colored pencil or hachure marks on the plat below.
2. If more than one lease is dedicated to the well, outline each and identify the ownership thereof (both as to working interest and royalty).
3. If more than one lease of different ownership is dedicated to the well, have the interests of all owners been consolidated by communitization, unitization, force-pooling, etc?

☐ Yes ☐ No If answer is "yes," type of consolidation _____

If answer is "no," list the owners and tract descriptions which have actually been consolidated. (Use reverse side of this form if necessary.) _____

No allowable will be assigned to the well until all interests have been consolidated (by communitization, unitization, forced-pooling, or otherwise) or until a non-standard unit, eliminating such interests, has been approved by the Commission.

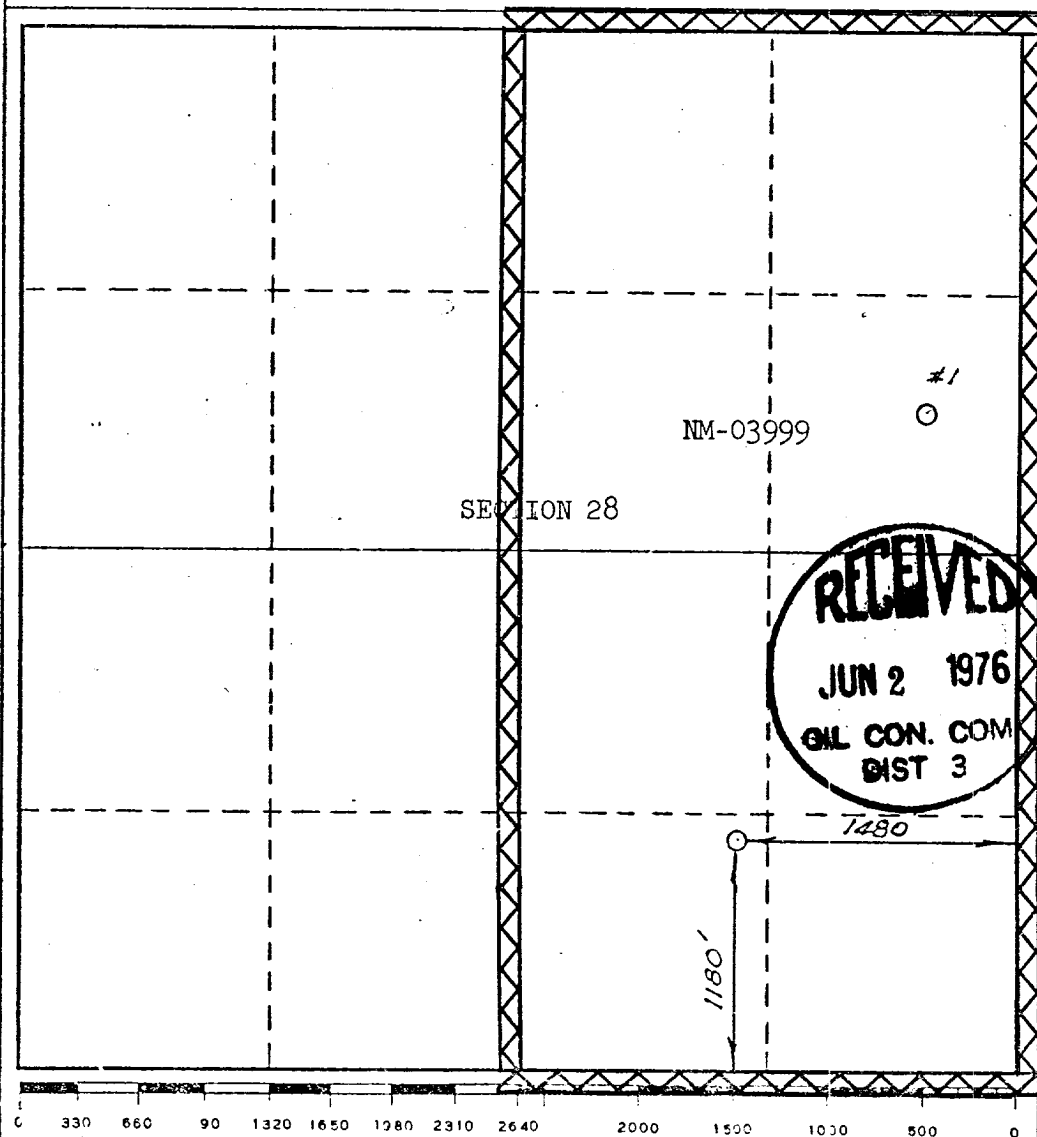

CERTIFICATION

I hereby certify that the information contained herein is true and complete to the best of my knowledge and belief.

Original Signed by
D. G. Brisco

Name

Drilling Clerk
Position

El Paso Natural Gas Co.
Company

June 1, 1976
Date

I hereby certify that the well location shown on this plat was plotted from field notes of actual surveys made by me or under my supervision, and that the same is true and correct to the best of my knowledge and belief.

Date Surveyed
MAY 5, 1976

Registered Professional Engineer
and/or Land Surveyor

Certificate No. **1760**

El Paso NATURAL GAS
COMPANY

P. O. BOX 990
FARMINGTON, NEW MEXICO 87401
PHONE: 505-325-2841

June 1, 1976

Mr. P. T. McGrath
U. S. Geological Survey
Post Office Box 959
Farmington, New Mexico 87401

Re: Application for Permit to Drill
Grambling #1A
SWSE/4 Section 28, T-29-N, R-9-W
Blanco Mesa Verde

Dear Mr. McGrath:

Details regarding existing roads, pipelines, wells, etc.
relative to the above well location are included on the
previously submitted base maps, "Field Road Map" and
"Composite Map No. 1".

The proposed new well location, new roads and new pipeline
are shown on the attached plat along with connecting existing
roads and pipelines in the vicinity of the proposed new well.

Water for drilling and completion operations will be obtained
from the following location: Five Mile Crossing on Largo Wash.

Waste material will be disposed of by burial in the burn pit,
latrine, or reserve pit as applicable. There will be no camp
nor air strip associated with drilling this well. Upon
completion or abandonment of this well, the location will be
cleaned and leveled and a dry hole marker placed, if applicable.

Yours very truly,



D. G. Brisco
Drilling Clerk

pb



LOCATION AND EQUIPMENT LAY-OUT

Grabbing 1A

28-29-9

M.V.

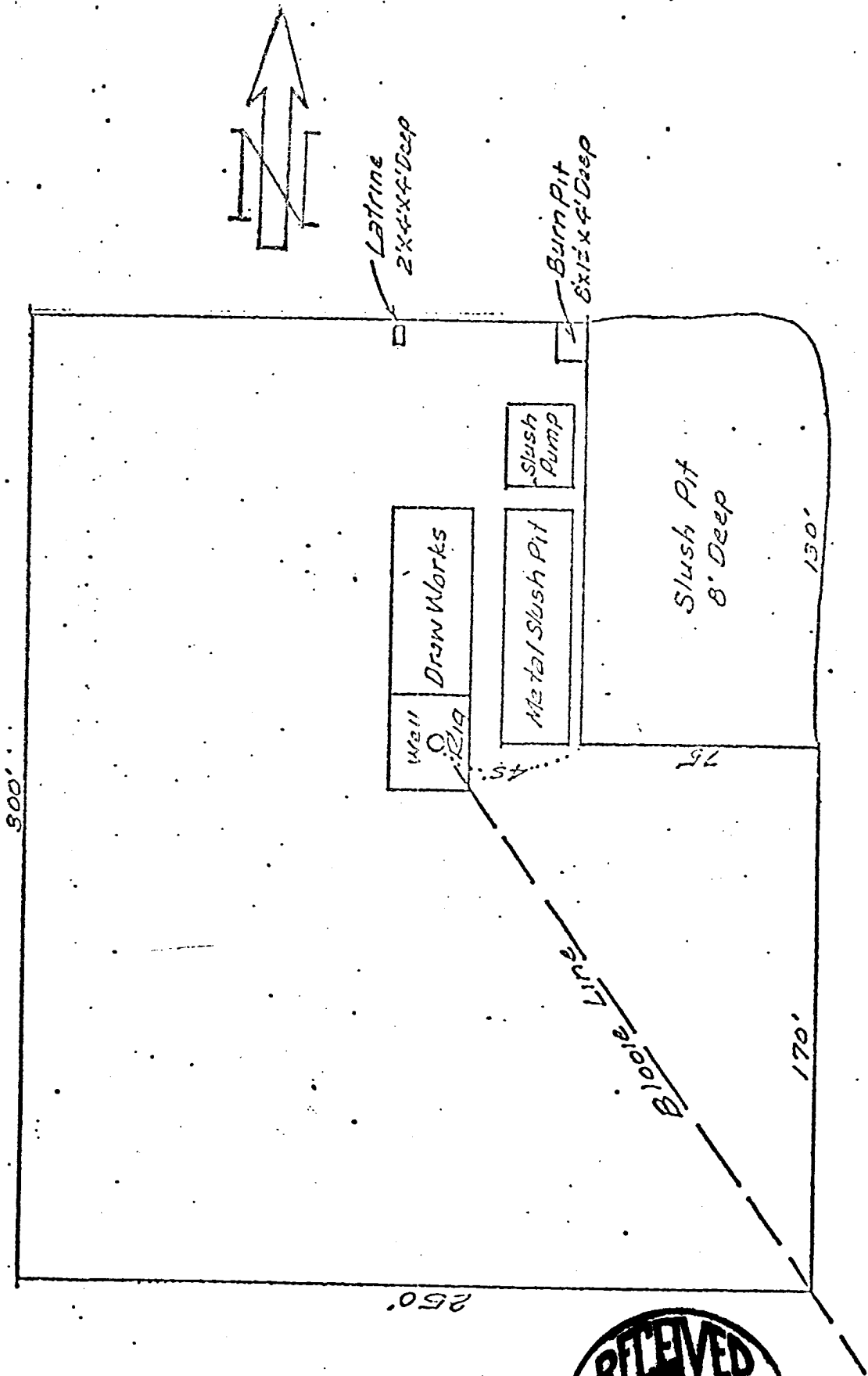

R. G. M.



EXISTING ROADS	_____
EXISTING PIPELINES	++ ++
EXISTING ROAD & PIPELINE	++ ++
PROPOSED ROADS	_____
PROPOSED PIPELINES	+++ ++
PROPOSED ROAD & PIPELINE	+++ ++



LTR



Job separation sheet

ALBUQUERQUE, NEW MEXICO 87401

UNITED STATES
DEPARTMENT OF THE INTERIOR
GEOLOGICAL SURVEY

SUBMIT IN DUPLICATE*

(See other instructions on reverse side)

Form approved,
Budget Bureau No. 72-R355.5.

WELL COMPLETION OR RECOMPLETION REPORT AND LOG *

1a. TYPE OF WELL:		OIL WELL <input type="checkbox"/>		GAS WELL <input checked="" type="checkbox"/>		DRY <input type="checkbox"/>		Other _____	
b. TYPE OF COMPLETION:		NEW WELL <input checked="" type="checkbox"/>		WORK OVER <input type="checkbox"/>		DEEP-EN <input type="checkbox"/>		PLUG BACK <input type="checkbox"/>	
				DIFF. RESVR. <input type="checkbox"/>				Other _____	
2. NAME OF OPERATOR El Paso Natural Gas Company									
3. ADDRESS OF OPERATOR P. O. Box 990, Farmington, New Mexico 87401									
4. LOCATION OF WELL (Report location clearly and in accordance with any State requirements)* At surface 1180' S, 1480' E At top prod. interval reported below At total depth									
14. PERMIT NO.				DATE ISSUED					
5. DATE SPUDDED 11-08-76		16. DATE T.D. REACHED 11-14-76		17. DATE COMPL. (Ready to prod.) 12-14-76		18. ELEVATIONS (DF, RKB, RT, GR, ETC.)* 5734' GL		19. ELEV. CASINGHEAD	
20. TOTAL DEPTH, MD & TVD 4797'		21. PLUG, BACK T.D., MD & TVD 4779'		22. IF MULTIPLE COMPL., HOW MANY*		23. INTERVALS DRILLED BY 10-4797		24. PRODUCING INTERVAL(S), OF THIS COMPLETION—TOP, BOTTOM, NAME (MD AND TVD)* 3772 - 4714 (MV)	
25. WAS DIRECTIONAL SURVEY MADE No								26. TYPE ELECTRIC AND OTHER LOGS RUN I-GR; FDC-GR; Temperature Survey	
27. WAS WELL CORED No									
28. CASING RECORD (Report all strings set in well)									
CASING SIZE	WEIGHT, LB./FT.	DEPTH SET (MD)	HOLE SIZE	CEMENTING RECORD	AMOUNT PULLED				
9 5/8"	36#	196'	12 1/4"	130 cu. ft.					
7"	20#	2425'	8 3/4"	383 cu. ft.					
29. LINER RECORD									
SIZE	TOP (MD)	BOTTOM (MD)	SACKS CEMENT*	SCREEN (MD)					
4 1/2"	2276'	4797'	442 cu. ft.						
30. TUBING RECORD									
SIZE	DEPTH SET (MD)	PACKER SET (MD)							
2 3/8"	4724'								
31. PERFORATION RECORD (Interval, size and number) 3772, 3775, 3781, 3785, 3838, 3843, 3860, 3864, 3868, 4087, 4092, 4096, 4108, 4125, 4132, 4135, 4139, 4245, 4251, 4256 with 1 shot per zone, 4398, 4401, 4406, 4410, 4414, 4418, 4430, 4466, 4470, 4483, 4488, 4514, 4545, 4552, 4567, 4589, 4612, 4658, 4693, 4714 w/1 SPZ									
32. ACID, SHOT, FRACTURE, CEMENT SQUEEZE, ETC.									
DEPTH INTERVAL (MD)	AMOUNT AND KIND OF MATERIAL USED								
3772-4256	50,000# sd; 50,150 gal. wtr.								
4398-4714	50,000# sd; 51,870 gal. wtr.								
33. PRODUCTION									
DATE FIRST PRODUCTION		PRODUCTION METHOD (Flowing, gas lift, pumpjack, etc.) After Frac Gauge 928 MCF/D				WELL STATUS (Producing or shut-in) Shut-In			
DATE OF TEST 12-14-76	HOURS TESTED	CHOKE SIZE	PROD'N. FOR TEST PERIOD	OIL—BBL.	GAS—MCF.	WATER—BBL.	GAS-OIL RATIO		
FLOW. TUBING PRESS. SI 270	CASING PRESSURE SI 688	CALCULATED 24-HOUR RATE	OIL—BBL.	GAS—MCF.	WATER—BBL.	OIL GRAVITY-API (COR.)			
34. DISPOSITION OF GAS (Solid, used for fuel, vented, etc.)									
35. LIST OF ATTACHMENTS									
36. I hereby certify that the foregoing and attached information is complete and correct as determined from all available records									

TEST WITNESSED BY
H. E. McAnally

DATE January 5, 1977

*(See Instructions and Spaces for Additional Data on Reverse Side)