

Form 9-331C  
(May 1963)

SUBMIT IN TRIPLICATE\*

(Other instructions on  
reverse side)Form approved.  
Budget Bureau No. 42-R1425.UNITED STATES  
DEPARTMENT OF THE INTERIOR  
GEOLOGICAL SURVEY

## APPLICATION FOR PERMIT TO DRILL, DEEPEN, OR PLUG BACK

1a. TYPE OF WORK  
 DRILL ☒ DEEPEN ☐ PLUG BACK ☐

b. TYPE OF WELL  
 OIL WELL ☒ GAS WELL ☐ OTHER ☐ SINGLE ZONE ☐ MULTIPLE ZONE ☐

2. NAME OF OPERATOR  
 Walter Duncan Oil Properties

3. ADDRESS OF OPERATOR  
 P. O. Box 234, Farmington, NM 87401

4. LOCATION OF WELL (Report location clearly and in accordance with any State requirements.)\*  
 At surface 2450' FNL - 1880' FWL  
 At proposed prod. zone

5. LEASE DESIGNATION AND SERIAL NO.  
 14-20-0603-9591

6. IF INDIAN, ALLOTTEE OR TRIBE NAME  
 Navajo Tribe

7. UNIT AGREEMENT NAME

8. FARM OR LEASE NAME  
 North Hogback 1

9. WELL NO.  
 #25

10. FIELD AND POOL, OR WILDCAT  
 Slickrock - Dakota

11. SEC., T., R., M., OR BLK. AND SURVEY OR AREA  
 Sec 1, T29N R17W

12. COUNTY OR PARISH  
 San Juan

13. STATE  
 NM

14. DISTANCE IN MILES AND DIRECTION FROM NEAREST TOWN OR POST OFFICE\*  
 7 miles east of Shiprock NM

15. DISTANCE FROM PROPOSED\* LOCATION TO NEAREST PROPERTY OR LEASE LINE, FT. (Also to nearest drlg. unit line, if any)  
 1880'

16. NO. OF ACRES IN LEASE  
 640

17. NO. OF ACRES ASSIGNED TO THIS WELL  
 40

18. DISTANCE FROM PROPOSED LOCATION\* TO NEAREST WELL, DRILLING, COMPLETED, OR APPLIED FOR, ON THIS LEASE, FT.  
 575'

19. PROPOSED DEPTH  
 680'

20. ROTARY OR CABLE TOOLS  
 Cable tools 0-25 Rotary 25 --

21. ELEVATIONS (Show whether DF, RT, GR, etc.)  
 4968' GR

22. APPROX. DATE WORK WILL START\*  
 3-15-78

## 23. PROPOSED CASING AND CEMENTING PROGRAM

SIZE OF HOLE	SIZE OF CASING	WEIGHT PER FOOT	SETTING DEPTH	QUANTITY OF CEMENT
9"	7"	20#	25'	5/sx
6-1/4"	4-1/2"	10.5#	670'	75/sx

1. Drill surface hole thru boulders to approx. 25' with cable tools and run 7" csg cemented to surface with 5/sx cement.
2. Drill 6-1/4" hole to top of Dakota Formation @ approximately 670'.
3. Run 4-1/2" csg and cement to surface w/75 sx.
4. Drill 3-7/8" hole into Dakota pay zone with air.
5. If commercial production is indicated 2-3/8" tbg will be run and the well completed naturally.

IN ABOVE SPACE DESCRIBE PROPOSED PROGRAM: If proposal is to deepen or plug back, give data on present productive zone and proposed new productive zone. If proposal is to drill or deepen directionally, give pertinent data on subsurface locations and measured and true vertical depths. Give blowout preventer program, if any.

24. SIGNED Jim L. Jacobs TITLE Agent DATE 2-13-78  
 (This space for Federal or State office use)

PERMIT NO. \_\_\_\_\_ APPROVAL DATE \_\_\_\_\_

APPROVED BY \_\_\_\_\_ TITLE \_\_\_\_\_ DATE \_\_\_\_\_

CONDITIONS OF APPROVAL, IF ANY:

*ab*

\*See Instructions On Reverse Side

FEB 15 1978

NEW MEXICO OIL CONSERVATION COMMISSION  
WELL LOCATION AND ACREAGE DEDICATION PLAT

Form C-102  
Supersedes C-128  
Effective 1-1-65

All distances must be from the outer boundaries of the Section.

Operator <b>Walter Duncan</b>		Lease <b>North Hogback /</b>		Well No. <b>25</b>
Unit <b>1</b>	Section <b>1</b>	Township <b>29N</b>	Range <b>17W</b>	County <b>San Juan</b>
Actual Footage Location of Well: <b>2450</b> feet from the <b>North</b> line and <b>1880</b> feet from the <b>West</b> line				
Ground Level Elev. <b>4978</b>	Producing Formation <b>Dakota</b>	Pool <b>Slickrock Dakota</b>	Dedicated Acreage: <b>40</b> Acres	

1. Outline the acreage dedicated to the subject well by colored pencil or hachure marks on the plat below.
2. If more than one lease is dedicated to the well, outline each and identify the ownership thereof (both as to working interest and royalty).
3. If more than one lease of different ownership is dedicated to the well, have the interests of all owners been consolidated by communitization, unitization, force-pooling, etc?

☐ Yes ☐ No If answer is "yes," type of consolidation \_\_\_\_\_

If answer is "no," list the owners and tract descriptions which have actually been consolidated. (Use reverse side of this form if necessary.) \_\_\_\_\_

No allowable will be assigned to the well until all interests have been consolidated (by communitization, unitization, forced-pooling, or otherwise) or until a non-standard unit, eliminating such interests, has been approved by the Commission.

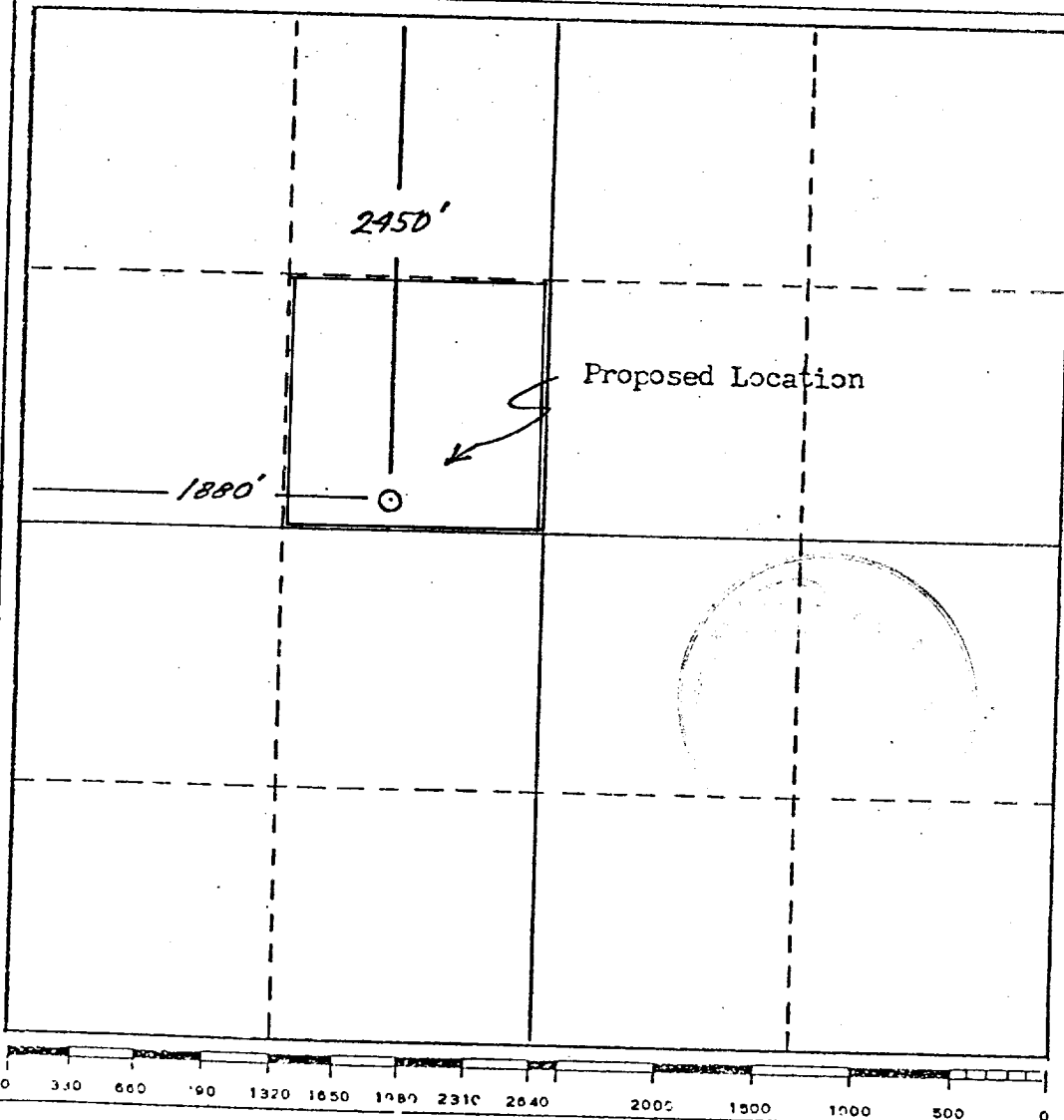

CERTIFICATION

I hereby certify that the information contained herein is true and complete to the best of my knowledge and belief.

Name *Jim L. Jacobs*  
**Jim L. Jacobs**

Position  
**Agent**

Company  
**Walter Duncan**

Date  
**2-13-78**

I hereby certify that the well location shown on this plat was plotted from field notes of actual surveys made by me or under my supervision, and that the same is true and correct to the best of my knowledge and belief.

**February 2, 1978**

Date Surveyed

Registered Professional Engineer and/or Land Surveyor

*Charles H. Reed*  
Certificate No. **3795**