

* OF COPIES RECEIVED	5
DISTRIBUTION	
SANTA FE	1
FILE	1
U.S.G.S.	2
LAND OFFICE	
OPERATOR	1

NEW MEXICO OIL CONSERVATION COMMISSION

Form C-101
Revised 1-1-65

REVISED

APPLICATION FOR PERMIT TO DRILL, DEEPEN, OR PLUG BACK

1a. Type of Work		7. Unit Agreement Name	
b. Type of Well OIL WELL <input type="checkbox"/> DRILL <input checked="" type="checkbox"/> DEEPEN <input type="checkbox"/> PLUG BACK <input type="checkbox"/> GAS WELL <input checked="" type="checkbox"/> OTHER <input type="checkbox"/> SINGLE ZONE <input type="checkbox"/> MULTIPLE ZONE <input checked="" type="checkbox"/>		8. Farm or Lease Name Hanley "A"	
2. Name of Operator Getty Oil Company		9. Well No. 1	
3. Address of Operator P.O. Box 3360, Casper, WY 82602		10. Field and Pool, or Wildcat Wildcat Mesa Verde Elmwood Chacra	
4. Location of Well UNIT LETTER F LOCATED 1515' FEET FROM THE North LINE AND 1700' FEET FROM THE West LINE OF SEC. 18 TWP. 29N RGE. 10W NMPM		12. County San Juan	
19. Proposed Depth 4600'		19A. Formation Mesa Verde-Chacra	
20. Rotary or C.T. Rotary		21. Elevations (Show whether DF, RT, etc.) 5608' GR	
21A. Kind & Status Plug. Bord Blanket		21B. Drilling Contractor Brinkerhoff	
22. Approx. Date Work will start June 8, 1978			

PROPOSED CASING AND CEMENT PROGRAM

SIZE OF HOLE	SIZE OF CASING	WEIGHT PER FOOT	SETTING DEPTH	SACKS OF CEMENT	EST. TOP
12-1/4"	9-5/8" OD	36#	300'	150	surface
8-3/4"	7" OD	23#	3225'	300	surface
6-1/4"	4-1/2" OD	11.6#	4600'	175	3225'

We propose to drill to 3225' with mud and set 7" OD casing. Air will be used to drill from 3225' to 4600' T.D. If tests indicate commercial production in both the Chacra and Mesa Verde we propose to dual complete the well.

Acceage and pool change

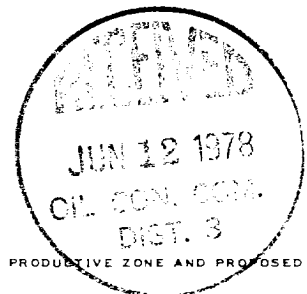

IN ABOVE SPACE DESCRIBE PROPOSED PROGRAM: IF PROPOSAL IS TO DEEPEN OR PLUG BACK, GIVE DATA ON PRESENT PRODUCTIVE ZONE AND PROPOSED NEW PRODUCTIVE ZONE. GIVE BLOWOUT PREVENTER PROGRAM, IF ANY.

I hereby certify that the information above is true and complete to the best of my knowledge and belief.

Signed W E Gab Title Area Superintendent Date 6/7/78

(This space for State Use)

APPROVED BY AR Kendrick TITLE SUPERVISOR DIST. 3 DATE 6/7/78
CONDITIONS OF APPROVAL, IF ANY:

NEW MEXICO OIL CONSERVATION COMMISSION
WELL LOCATION AND ACREAGE DEDICATION PLAT

Form C-102
Supersedes C-128
Effective 1-1-55

All distances must be from the outer boundaries of the Section.

Operator GETTY OIL COMPANY			Lease HANLEY "A"		Well No. 1
Unit Letter F	Section 18	Township 29N	Range 10W	County San Juan	
Actual Footage Location of Well:					
1515 feet from the North line and		1700 feet from the West line			
Ground Level Elev. 5608	Producing Formation Mesa Verde-Chacra	Pool Elbow Field - Chacra Wildcat - Mesa Verde	Dedicated Acreage 151.41 151.41 Acres		

1. Outline the acreage dedicated to the subject well by colored pencil or hachure marks on the plat below.
2. If more than one lease is dedicated to the well, outline each and identify the ownership thereof (both as to working interest and royalty).
3. If more than one lease of different ownership is dedicated to the well, have the interests of all owners been consolidated by communitization, unitization, force-pooling, etc?

☐ Yes ☐ No If answer is "yes," type of consolidation _____

If answer is "no," list the owners and tract descriptions which have actually been consolidated. (Use reverse side of this form if necessary.) _____

No allowable will be assigned to the well until all interests have been consolidated (by communitization, unitization, forced-pooling, or otherwise) or until a non-standard unit, eliminating such interests, has been approved by the Commission.

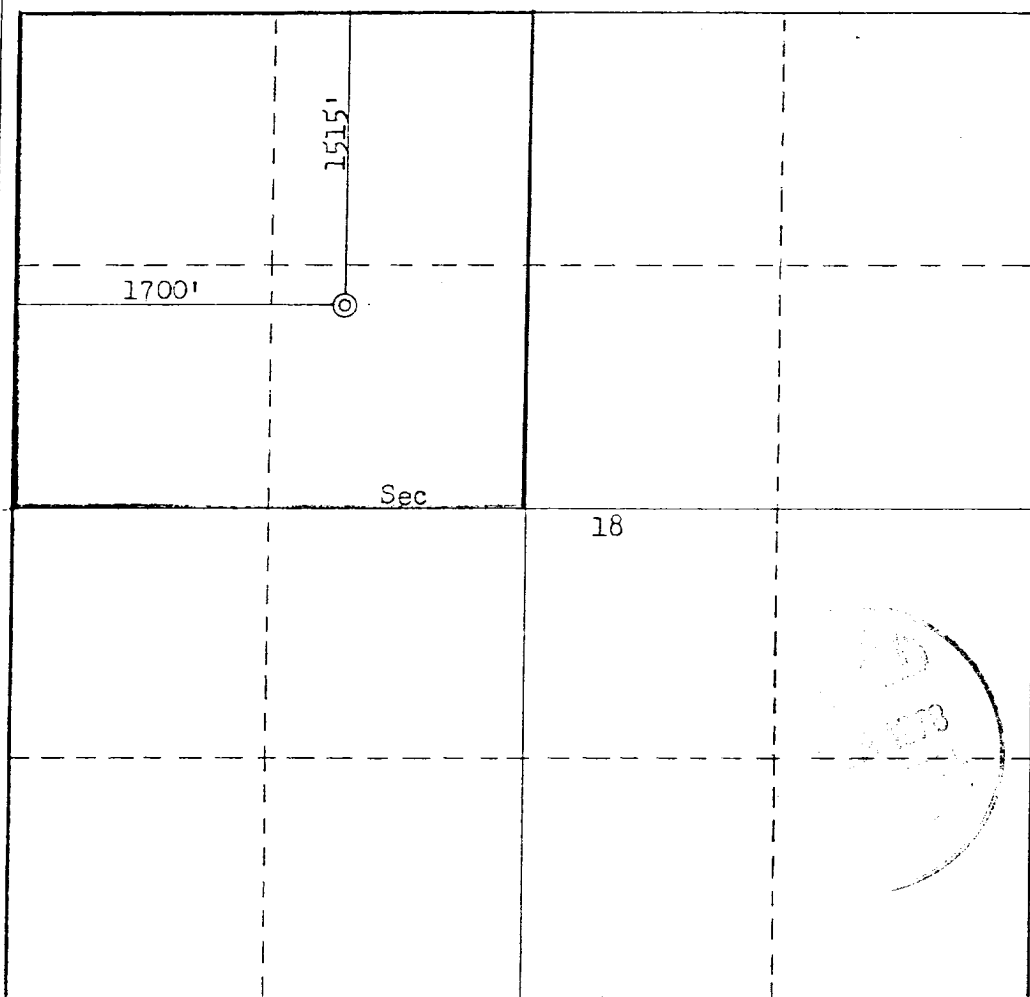

CERTIFICATION

I hereby certify that the information contained herein is true and complete to the best of my knowledge and belief.

H. E. Aab

Name

H. E. Aab

Position

Area Superintendent

Company

Getty Oil Co.

Date

6-7-78

I hereby certify that the well location shown on this plat was plotted from field notes of actual surveys made by me or under my supervision, and that the same is true and correct to the best of my knowledge and belief.

Date Surveyed

May 3, 1978

Registered Professional Engineer
and/or Land Surveyor

Fred B. Kerr, Jr.

Certificate No. **3950**

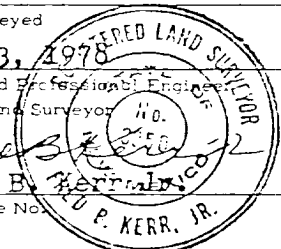

0 170 660 90 1320 1650 1980 2310 2640 2000 1500 1000 500 0



STATE OF NEW MEXICO
ENERGY AND MINERALS DEPARTMENT
OIL CONSERVATION DIVISION
AZTEC DISTRICT OFFICE

JERRY APODACA
GOVERNOR

NICK FRANKLIN
SECRETARY

June 16, 1978

1000 RIO BRAZOS ROAD
AZTEC, NEW MEXICO 87410
(505) 334-6178

NWU 3- 723

Getty Oil Co.
P. O. Box 510
Farmington, NM

SUBJECT: NON-STANDARD GAS PRORATION UNIT CONSISTING OF 151.41
ACRES IN THE Undesignated Mesaverde GAS
POOL DESCRIBED AS FOLLOWS:

TOWNSHIP 29 NORTH, RANGE 10 WEST, NMPM

SECTION: 18 NW/4

By authority granted me by Rule 5(B) of Order R-1670, as amended, the above-described acreage has been approved as a non-standard gas proration unit to be dedicated to the Hanley A
well no. 1, located 1515/N; 1700/W of said
Section 18.

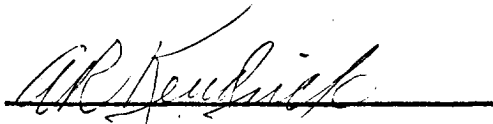
Supervisor, District #3

xc: Oil Conservation Commission
Santa Fe, New Mexico