

30-045-24802

| | |
|------------------------|--|
| NO. OF COPIES RECEIVED | |
| DISTRIBUTION | |
| SANTA FE | |
| FILE | |
| U.S.G.S. | |
| LAND OFFICE | |
| OPERATOR | |

NEW MEXICO OIL CONSERVATION COMMISSION

Form C-101
Revised 1-1-65

5A. Indicate Type of Lease
STATE FEE

5. State Oil & Gas Lease No.
E-3149

APPLICATION FOR PERMIT TO DRILL, DEEPEN, OR PLUG BACK

1a. Type of Work

b. Type of Well
 DRILL DEEPEN PLUG BACK
 OIL WELL GAS WELL OTHER _____
 SINGLE ZONE MULTIPLE ZONE

2. Name of Operator
Southland Royalty Company 21281

3. Address of Operator
P. O. Drawer 570, Farmington, NM 87401

4. Location of Well
 UNIT LETTER A LOCATED 830 FEET FROM THE North LINE
 AND 800 FEET FROM THE East LINE OF SEC. 19 TWP. 29N RGE. 13W NMPM

7. Unit Agreement Name

8. Farm or Lease Name
TEXACO STATE 16209

9. Well No.
#2

10. Field and Pool or Wildcat
Kutz Pictured Cliffs

12. County
San Juan

19. Proposed Depth
1300'

19A. Formation
Pict. Cliffs

20. Rotary or C.T.
Rotary

21. Elevations (Show whether DF, RT, etc.)
5357' GR

21A. Kind & Status Plug. Bond

21B. Drilling Contractor
Four Corners Drilling

22. Approx. Date Work will start
Feb. 15, 1981

PROPOSED CASING AND CEMENT PROGRAM

| SIZE OF HOLE | SIZE OF CASING | WEIGHT PER FOOT | SETTING DEPTH | SACKS OF CEMENT | EST. TOP |
|--------------|----------------|-----------------|---------------|-----------------------|----------|
| 12 1/4" | 8 5/8" | 24# | 140' | 100 sx | |
| 6 3/4" | 2 7/8" | 6.5# | 1300' | 285 sx | |
| | | | | sufficient to line | |

Surface formation is Kirtland Shale.
 Top of Fruitland sand is at 895'.
 Top of Pictured Cliffs sand is at 1055'.
 Fresh water mud will be used to drill from surface to total depth.
 It is anticipated that an IES and GR-Density log will be run at total depth.
 No abnormal pressures or poisonous gases are anticipated in this well.
 It is expected that this well will be drilled before April 1, 1981. This depends
 on time required for approvals, rig availability and the weather.
 Gas is dedicated.

APPROVAL VALID
 FOR 90 DAYS UNLESS
 DRILLING COMMENCED,

EXPIRES 7-20-81

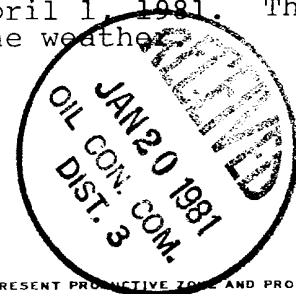

IN ABOVE SPACE DESCRIBE PROPOSED PROGRAM IF PROPOSAL IS TO DEEPEN OR PLUG BACK, GIVE DATA ON PRESENT PRODUCTIVE ZONE AND PROPOSED NEW PRODUCTIVE ZONE. GIVE BLOWOUT PREVENTER PROGRAM, IF ANY.

I hereby certify that the information above is true and complete to the best of my knowledge and belief.

Signed R. E. Fielder Title District Engineer Date 1-19-81

(This space for State Use)

APPROVED BY Frank S. King TITLE SUPERVISOR DISTRICT #3 DATE JAN 20 1981

CONDITIONS OF APPROVAL, IF ANY:

DRILLING SCHEDULE - TEXACO STATE #2

Location: 830' FNL & 800' FEL of Sec. 19, T29N, R13W

Field: Kutz Pictured Cliffs

Elevation: 5357' G.L.

Geology:

Formation Tops: Fruitland 895'
Pictured Cliffs 1055'
Total Depth 1300'

Logging Program: IES and GR-Density at total depth.

Coring Program: None

Natural Gauges: None

Drilling:

Contractor:

Tool Pusher:

SRC Representative:

SRC Answering Service: 325-1841
Dispatch Number: 325-7391

Mud Program: Fresh water mud from surface to total depth.

Materials:

| Casing Program: | <u>Hole Size</u> | <u>Depth</u> | <u>Casing Size</u> | <u>Wt. & Grade</u> |
|-----------------|------------------|--------------|--------------------|------------------------|
| | 12-1/4" | 140' | 8-5/8" | 24# K-55 |
| | 6-3/4" | 1300' | 2-7/8" | 6.5# K-55 |

Float Equipment:

8-5/8" Surface Casing: B&W cement guide shoe (FC01).

2-7/8" Production Casing: Notched collar guide shoe. Howco 2-7/8" latch down baffle (Pr. Ref. 60). Two 3-1/16" rubber balls and one 2-7/8" Omega latching plug (Pr. Ref. 59). Use 3-1/4" plug container head. Six (6) B & W stabilizers on bottom 6 joints.

Wellhead Equipment: 8-5/8" x 2-7/8", EUE, screwed head.

Cementing:

8-5/8" Surface Casing: 100 sxs (118 cu. ft.) Class "B" with 1/4# gel flake per sx and 3% CaCl₂. (100% excess)

2-7/8" Production Casing: 210 sxs (313 cu. ft.) of 50/50 Class "B" Poz with 6% gel mixed with 7.2 gals water per sx to weigh 12.85 ppg. Tail in with 75 sxs (88 cu. ft.) Class "B" with 2% CaCl₂. If lost circulation occurs add 1/4 cu. ft. fine gilsonite per sack. (50% excess to circulate to surface) Displace cement with 75 gals. of 7-1/2% acetic acid. Run temperature survey after 12 hours.

L. O. Van Ryan
District Production Manager

JAC:dm _____
Date 1-19-81



Southland Royalty Company

January 16, 1981

Oil Conservation Division
Mr. Frank Chavez
1000 Rio Brazos Road
Aztec, NM 87410

RE: Blowout Preventer Plan

Dear Mr. Chavez:

All drilling and completion rigs will be equipped with 6" or larger double gate hydraulic blowout preventers and a hydraulic operated closing unit with steel lines.

The preventer is 3000# working pressure and 6000# test pressure.

All crews will be thoroughly trained in the operation of this preventer. The preventer will be tested frequently enough to ensure proper operation.

Sincerely,

SOUTHLAND ROYALTY COMPANY

Robert E. Fielder
District Engineer

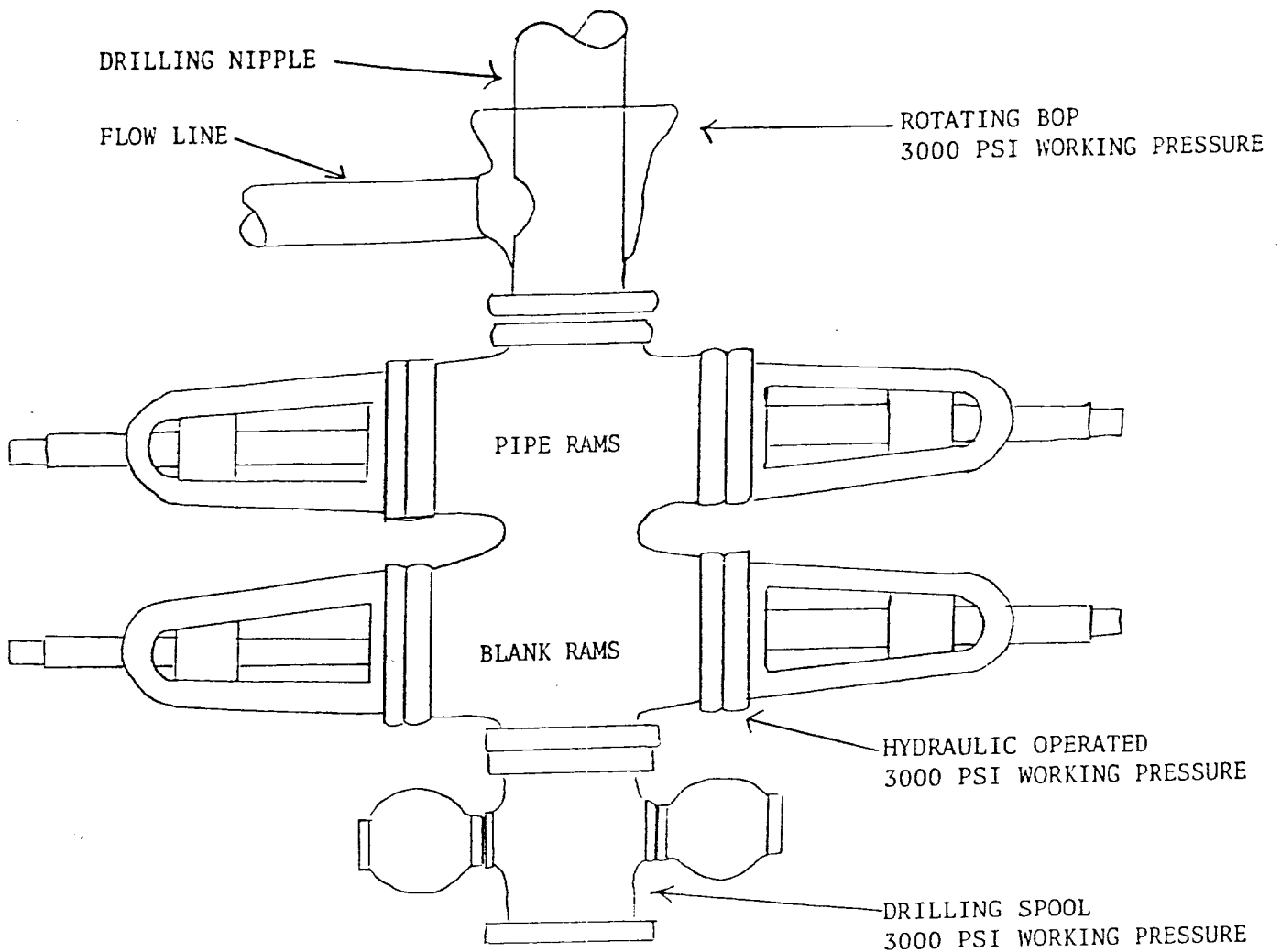

PREVENTERS AND SPOOLS ARE TO HAVE
THROUGH BORE OF 6" - 3000 PSI OR LARGER

Southland Royalty Company - TEXACO STATE #2
Section 19, T29N, R13W
San Juan County, NM

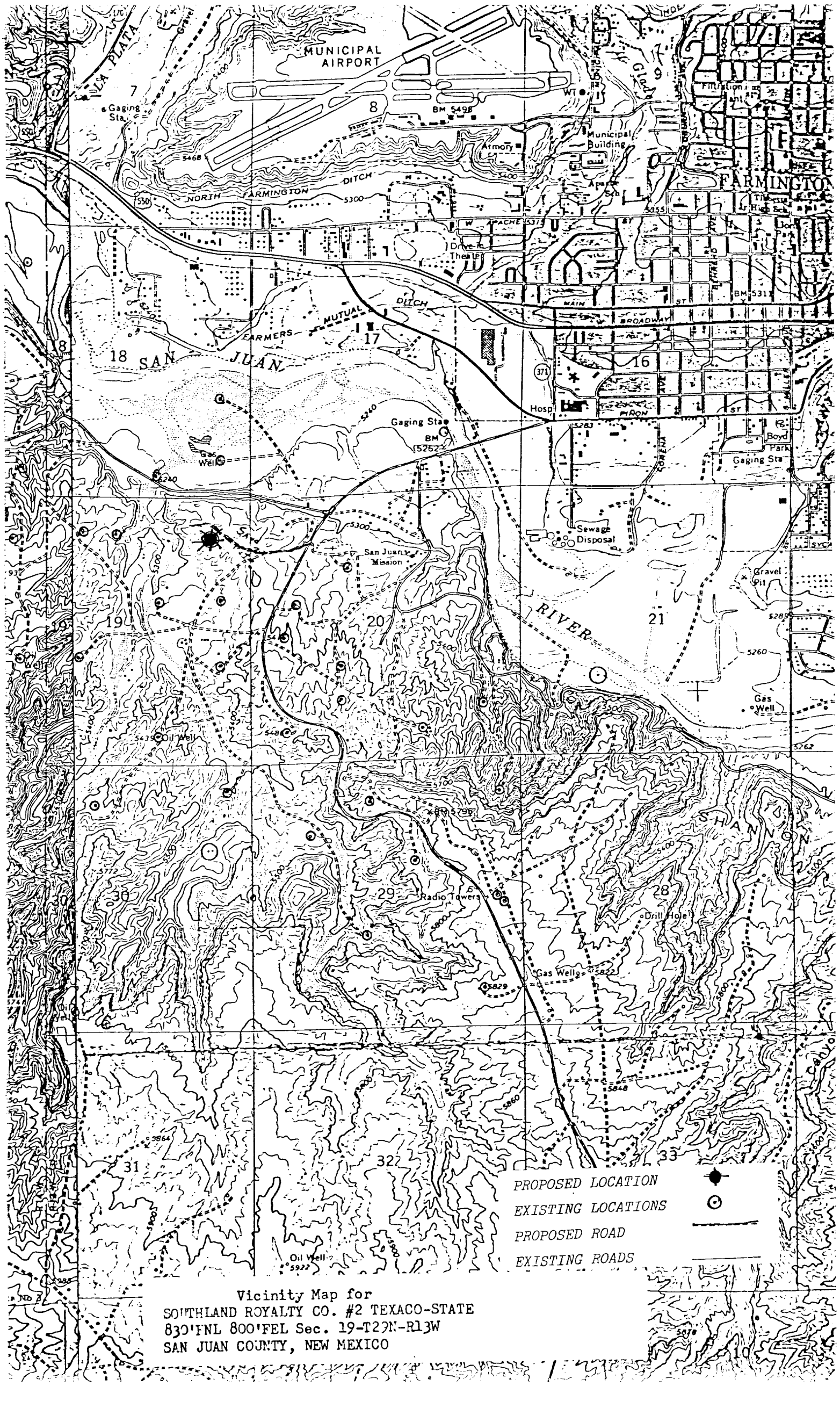

- PROPOSED LOCATION
- EXISTING LOCATIONS
- PROPOSED ROAD
- EXISTING ROADS

Vicinity Map for
 SOUTHLAND ROYALTY CO. #2 TEXACO-STATE
 830'FNL 800'FEL Sec. 19-T29N-R13W
 SAN JUAN COUNTY, NEW MEXICO

SOUTHLAND ROYALTY CO. #2 TEXACO-STATE
 830'FNL 800'FEL Sec. 19-T29N-R13W
 SAN JUAN COUNTY, NEW MEXICO

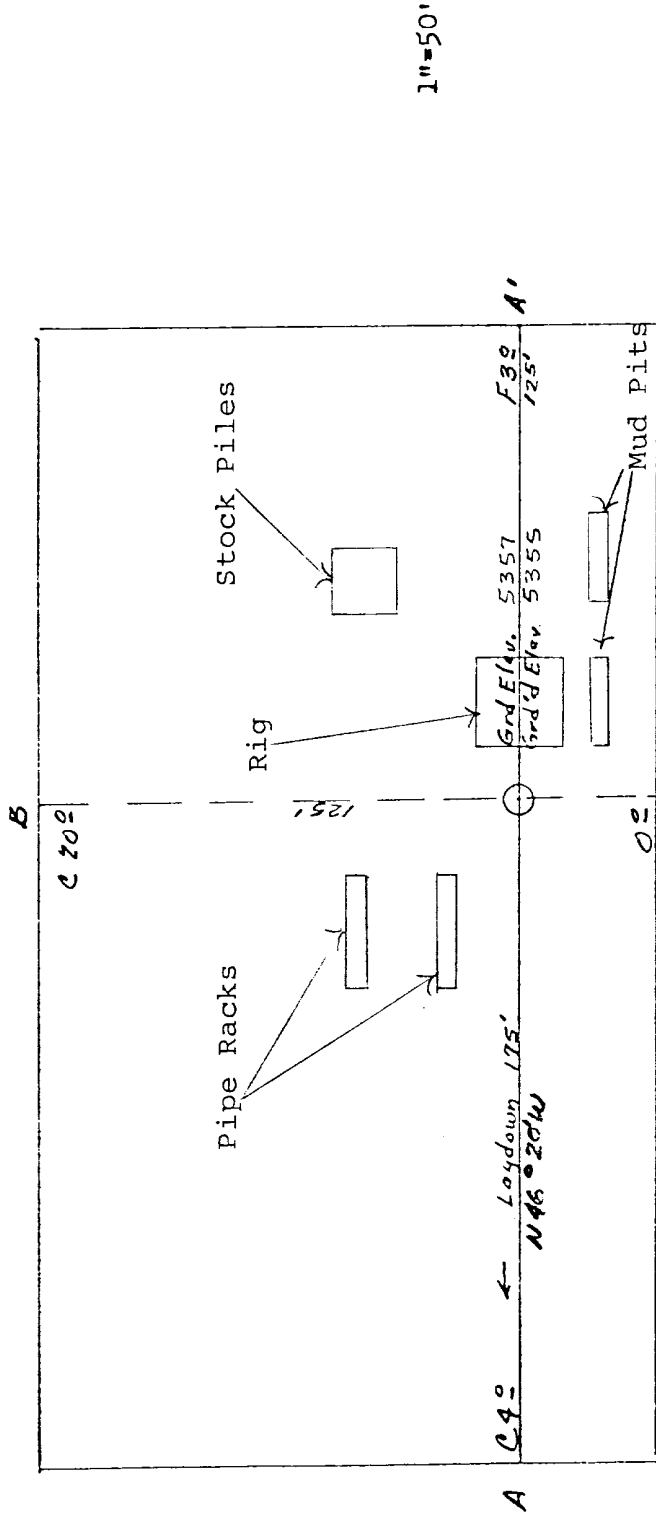

1"=50'

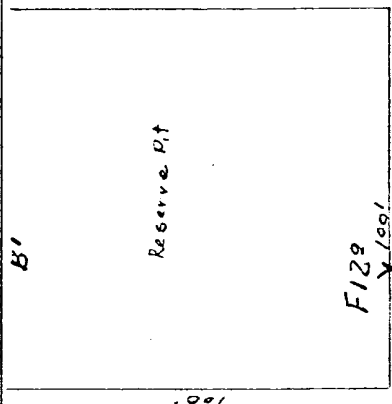
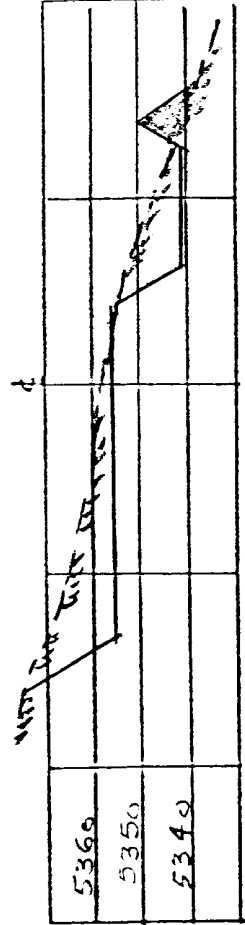
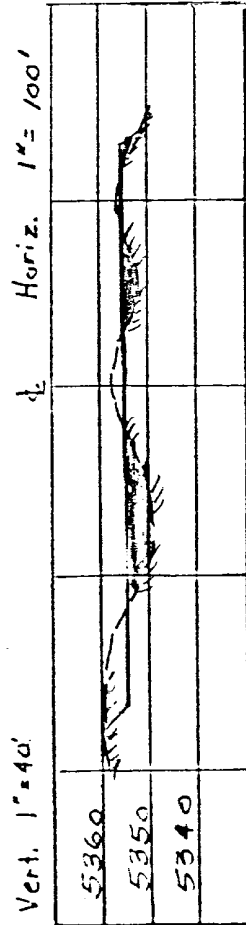

| | | | | | | | |
|--|--|--|--|--|--|--|--|
| | | | | | | | |
| | | | | | | | |
| | | | | | | | |
| | | | | | | | |

| | | | | | | | |
|--|--|--|--|--|--|--|--|
| | | | | | | | |
| | | | | | | | |
| | | | | | | | |
| | | | | | | | |

Date 1/9/81

Kerr Land Surveying, Inc.