

OIL CONSERVATION DIVISION
P. O. BOX 2088
SANTA FE, NEW MEXICO 87501

Form C-103
Revised 10-1-76

NO. OF COPIES RECEIVED	
DISTRIBUTION	
SANTA FE	
FILE	
U.S.G.S.	
LAND OFFICE	
OPERATOR	

5a. Indicate Type of Lease
State ☒ Fee ☐
5. State Oil & Gas Lease No.
E-7122

SUNDRY NOTICES AND REPORTS ON WELLS

(DO NOT USE THIS FORM FOR PROPOSALS TO DRILL OR TO DEEPEN OR PLUG BACK TO A DIFFERENT RESERVOIR.
USE "APPLICATION FOR PERMIT -" (FORM C-101) FOR SUCH PROPOSALS.)

1. <input type="checkbox"/> OIL WELL <input checked="" type="checkbox"/> GAS WELL <input type="checkbox"/> OTHER	7. Unit Agreement Name State A
2. Name of Operator ARCO Oil and Gas Company, Division of Atlantic Richfield Company	8. Farm or Lease Name State A Com
3. Address of Operator P. O. Box 5540, Denver, Colorado 80217	9. Well No. 1E
4. Location of Well ** UNIT LETTER <u>E</u> <u>1850</u> FEET FROM THE <u>North</u> LINE AND <u>800</u> FEET FROM THE <u>West</u> LINE, SECTION <u>36</u> TOWNSHIP <u>29N</u> RANGE <u>11W</u> NMPM.	10. Field and Pool, or Wildcat Basin Dakota - Dakota
15. Elevation (Show whether DF, RT, GR, etc.) 5679'	12. County San Juan

16. Check Appropriate Box To Indicate Nature of Notice, Report or Other Data
NOTICE OF INTENTION TO: SUBSEQUENT REPORT OF:

PERFORM REMEDIAL WORK <input type="checkbox"/>	PLUG AND ABANDON <input type="checkbox"/>	REMEDIAL WORK <input type="checkbox"/>	ALTERING CASING <input type="checkbox"/>
TEMPORARILY ABANDON <input type="checkbox"/>	CHANGE PLANS <input type="checkbox"/>	COMMENCE DRILLING OPNS. <input type="checkbox"/>	PLUG AND ABANDONMENT <input type="checkbox"/>
PULL OR ALTER CASING <input type="checkbox"/>	OTHER <input checked="" type="checkbox"/> CHANGE OF LOCATION	CASING TEST AND CEMENT JOB <input type="checkbox"/>	

17. Describe Proposed or Completed Operations (Clearly state all pertinent details, and give pertinent dates, including estimated date of starting any proposed work) SEE RULE 1103.

** We request that the location for this well be moved from 800' FNL & 800' FWL of Section 36-29N-11W, approved August 10, 1981, to the above location of 1850' FNL & 800' FWL of Section 36-29N-11W. Certified Location Plat attached.



18. I hereby certify that the information above is true and complete to the best of my knowledge and belief.

SIGNED W.A. Walther, Jr. TITLE District Manager of Production DATE September 11, 1981

Original Signed by FRANK T. CHAVEZ

SUPERVISOR DISTRICT # 3

SEP 14 1981

APPROVED BY

TITLE

DATE

OIL CONSERVATION DIVISION

P. O. BOX 2088

SANTA FE, NEW MEXICO 87501

Form C-107

Revised 10-1-78

STATE OF NEW MEXICO

ENERGY AND MINERALS DEPARTMENT

All distances must be from the outer boundaries of the Section.

Operator ARCO OIL & GAS			Lease STATE "A"		Well No. 1E
Unit Letter E	Section 36	Township 29N	Range 11W	County San Juan	
Actual Footage Location of Well: 1850 feet from the North line and 800 feet from the West line					
Ground Level Elev. 5679	Producing Formation Dakota	Pool Basin Dakota		Dedicated Acreage: 320 Acres	

1. Outline the acreage dedicated to the subject well by colored pencil or hachure marks on the plat below.
2. If more than one lease is dedicated to the well, outline each and identify the ownership thereof (both as to working interest and royalty).
3. If more than one lease of different ownership is dedicated to the well, have the interests of all owners been consolidated by communitization, unitization, force-pooling, etc?

☒ Yes ☐ No If answer is "yes," type of consolidation Communitization

If answer is "no," list the owners and tract descriptions which have actually been consolidated. (Use reverse side of this form if necessary.) _____

No allowable will be assigned to the well until all interests have been consolidated (by communitization, unitization, forced-pooling, or otherwise) or until a non-standard unit, eliminating such interests, has been approved by the Commission.

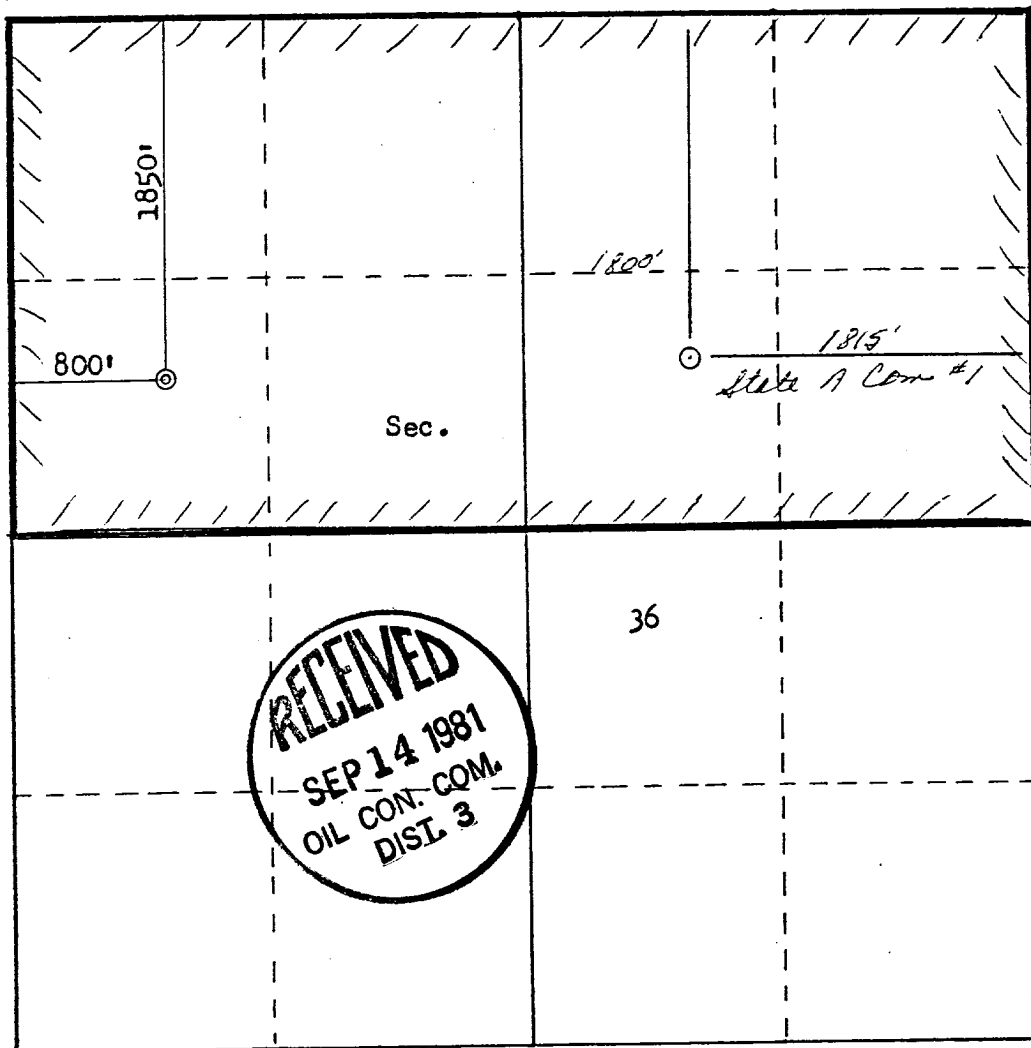

Scale: 1"=1000'

CERTIFICATION

I hereby certify that the information contained herein is true and complete to the best of my knowledge and belief.

Name

Position **W.A. Walther, Jr.**

District Manager of Production
Company **ARCO Oil & Gas Co, Div**
of **Atlantic Richfield Company**

Date

September 11, 1981

I hereby certify that the well location shown on this plat was plotted from field notes of actual surveys made by me or under my supervision, and that the same is true and correct to the best of my knowledge and belief.

Date Surveyed

August 28, 1981

Registered Professional Engineer
and State Surveyor

Fred B. Kerr, Jr.
Certificate No. A7EX10
3950 B. KERR, JR.