



# ENERGY AND MINERALS DEPARTMENT

OIL CONSERVATION DIVISION  
AZTEC DISTRICT OFFICE

1000 RIO BRAZOS ROAD  
AZTEC, NEW MEXICO 87410  
(505) 334-6178

OIL CONSERVATION DIVISION  
BOX 2088  
SANTA FE, NEW MEXICO 87501

DATE 9-5-85

RE: Proposed MC \_\_\_\_\_  
Proposed DHC \_\_\_\_\_  
Proposed NSL X \_\_\_\_\_  
Proposed SWD \_\_\_\_\_  
Proposed WFX \_\_\_\_\_  
Proposed PMX \_\_\_\_\_

Gentlemen:

I have examined the application dated 8-15-85  
for the Amoco Abrams 'L' # 1A I-26-29A-10W  
Operator Lease and Well No. Unit, S-T-R

and my recommendations are as follows:

Approved  
\_\_\_\_\_  
\_\_\_\_\_  
\_\_\_\_\_  
\_\_\_\_\_

Yours truly,

E. Kusch

August 13, 1985

Mr. Gilbert Quintana  
New Mexico Oil Conservation Division  
P. O. Box 2088  
Santa Fe, NM 87501

File: DDL-865-400.1

Application for Unorthodox Location  
Abrams L No. 1A  
Blanco Mesaverde  
San Juan County, New Mexico

Amoco Production Company hereby requests approval of an unorthodox well location for the Abrams L No. 1A. The proposed location is 1850' FSL x 350' FEL of Section 26, T29N, R10W, San Juan County, New Mexico.

This well was originally completed as an Armenta Gallup but later recompleted as a Blanco Mesaverde. The location is unorthodox for the Mesaverde formation.

A copy of this application is being sent by certified mail to the offset lease holders, El Paso Natural Gas Co. and Mesa Petroleum, with the request that they furnish you a waiver of objection and return one copy of the same to me.

Sincerely,

<sup>signed</sup>  
**W. J. Holcomb**  
by **BDS**  
LJM/ct

Attachments

✓cc: Mr. Ernie Busch  
New Mexico Oil Conservation Division  
1000 Rio Brazos Road  
Aztec, NM 87410

cc: R. J. Criswell - Denver  
J. D. Cutter - Denver

RECEIVED  
AUG 15 1985  
OIL CON. DIV.  
DIST. 3

\_\_\_\_\_ hereby waives objection to  
Amoco's application for unorthodox location as proposed above.

By: \_\_\_\_\_ Date: \_\_\_\_\_

PE6

August 13, 1988

Mr. Gilbert Quirana  
New Mexico Oil Conservation Division  
P. O. Box 3088  
Santa Fe, NM 87501

Re: ODL-865-400.1

Application for Unorthodox Location  
Abrams L No. 1A  
Blanco Mesaverte  
San Juan County, New Mexico

Amoco Production Company hereby requests approval of an unorthodox well location for the Abrams L No. 1A. The proposed location is 1050' FSL x 350' FEL of Section 26, T29N, R10W, San Juan County, New Mexico.

This well was originally completed as an Armenta Gallup but later recompleated as a Blanco Mesaverte. The location is unorthodox for the Mesaverte formation.

A copy of this application is being sent by certified mail to the offset lease holders, El Paso Natural Gas Co. and Mesa Petroleum, with the request that they furnish you a waiver of objection and return one copy of the same to me.

Sincerely,

Mr. Ernest Busch  
New Mexico Oil Conservation Division  
1000 Rio Brazos Road  
Santa Fe, NM 87410

Attachments

cc: Mr. Ernest Busch  
New Mexico Oil Conservation Division  
1000 Rio Brazos Road  
Santa Fe, NM 87410

Amoco's application for unorthodox location as proposed above.

By: \_\_\_\_\_ Date: \_\_\_\_\_

PEE

All distances must be from the corner boundaries of the Section.

Company <b>AMOCO PRODUCTION COMPANY</b>			Lease <b>ABRAMS " B"</b>		Well No. <b>1 A</b>
Unit Letter <b>I</b>	Section <b>26</b>	Township <b>29N</b>	Range <b>10W</b>	County <b>San Juan</b>	
Actual Footage Location of Well: <b>1850</b> feet from the <b>South</b> line and <b>350</b> feet from the <b>East</b> line					
Ground Level Elev. <b>5554</b>	Producing Formation <b>Mesaverde</b>		Pool <b>B lanco Mesaverde</b>		Dedicated Acreage: <b>320</b> Acres

1. Outline the acreage dedicated to the subject well by colored pencil or hachure marks on the plat below.
2. If more than one lease is dedicated to the well, outline each and identify the ownership thereof (both as to working interest and royalty).
3. If more than one lease of different ownership is dedicated to the well, have the interests of all owners been consolidated by communitization, unitization, force-pooling, etc?

Yes  No If answer is "yes," type of consolidation \_\_\_\_\_

If answer is "no," list the owners and tract descriptions which have actually been consolidated. (Use reverse side of this form if necessary.) \_\_\_\_\_

No allowable will be assigned to the well until all interests have been consolidated (by communitization, unitization, forced-pooling, or otherwise) or until a non-standard unit, eliminating such interests, has been approved by the Commission.

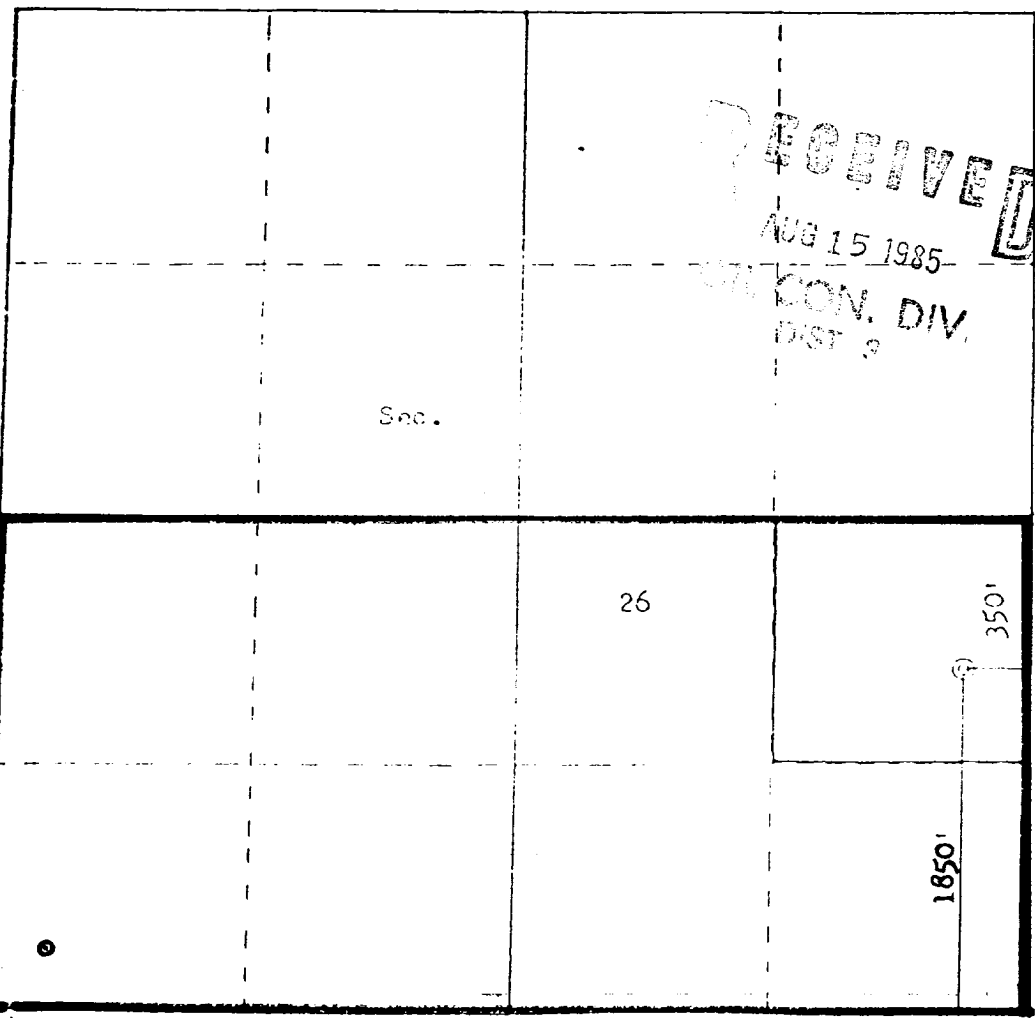

Scale: 1"=1000'

**CERTIFICATION**

I hereby certify that the information contained herein is true and complete to the best of my knowledge and belief.

*Dale H. Shoemaker*

Name <b>DALE H. SHOEMAKER</b>
Position <b>DISTRICT ENGINEER</b>
Company <b>AMOCO PRODUCTION COMPANY</b>
Date <b>MARCH 15, 1983</b>

I hereby certify that the well location shown on this plat was plotted from field notes of actual surveys made by me or under my supervision, and that the same is true and correct to the best of my knowledge and belief.

Date Surveyed <b>February 24, 1983</b>
Registered Professional Engineer and Land Surveyor <i>Fred B. Kerr Jr.</i> <b>Fred B. Kerr Jr.</b>
Certificate No. <b>3950</b>

ABRAMS 1 # 1A

R 10W

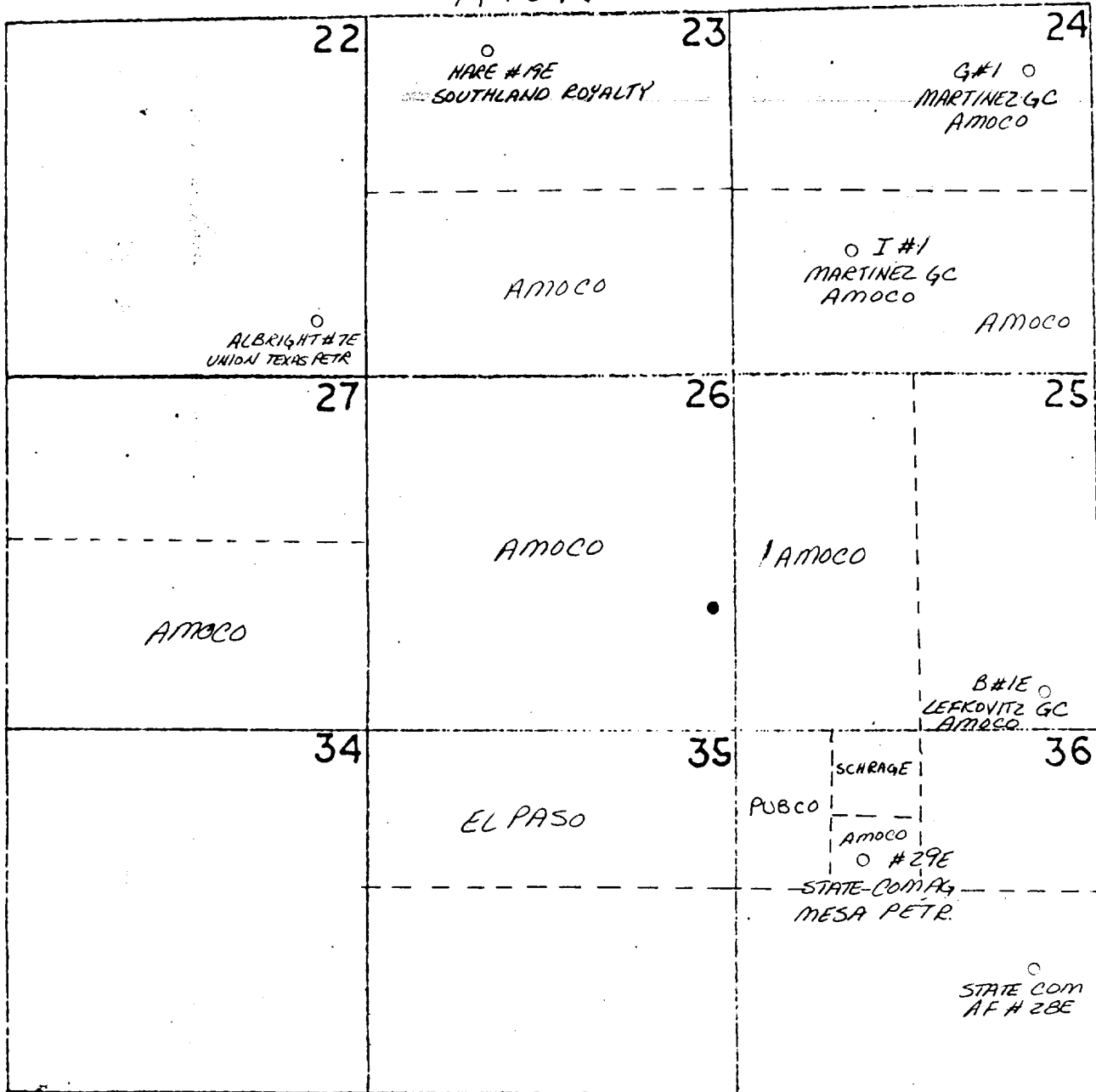

○ BLANCO MESAVERDE WELLS

● PROPOSED WELL