



# NEW MEXICO ENERGY, MINERALS and NATURAL RESOURCES DEPARTMENT

GARY E. JOHNSON  
Governor  
Jennifer A. Salisbury  
Cabinet Secretary

April 26, 2001

Lori Wrotenbery  
Director  
Oil Conservation Division

Amoco Production Company  
San Juan Business Unit  
501 West Lake Park Boulevard  
Houston, Texas 77059-3092

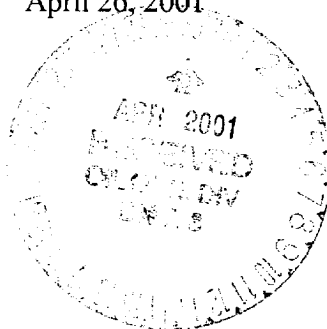

Attention: Mary Corley

*Re: Amoco Production Company's placement of its proposed Florance Well No. 117-M 2380 feet from the South line and 1790 feet from the East line (Lot 10/Unit J) of Section 35, Township 29 North, Range 9 West, NMPM, San Juan County, New Mexico, as an infill gas well in both the Basin-Dakota Pool within an existing standard 306.35-acre stand-up gas spacing and proration unit comprising Lots 1, 2, 7, 8, 9, 10, 15, and 16 (E/2 equivalent) of Section 35.*

Dear Ms. Corley:

Your application dated April 2, 2001 can not be addressed in the administrative review process.

The rules and procedures currently governing the Basin-Dakota Pool contain a provision that serves to check well density within existing spacing units. Review of your application and the Division's records indicate that the proposed Florance Well No. 117-M is located within the same quarter section as Amoco's Florance Well No. 117, currently completed in and producing from the Basin-Dakota Pool. I have therefore prepared the following advertisement, which will be placed on the May 31, 2001 hearing docket:

*"Application of Amoco Production Company for an exception to the well density and location provisions of the special rules governing the Basin-Dakota Pool, San Juan County, New Mexico. The applicant in this matter proposes to drill its Florance Well No. 117-M 2380 feet from the South line and 1790 feet from the East line (Lot 10/Unit J) of Section 35, Township 29 North, Range 9 West, as an infill gas well in the Basin-Dakota Pool within an existing standard 306.35-acre stand-up gas spacing and proration unit comprising Lots 1, 2, 7, 8, 9, 10, 15, and 16 (E/2 equivalent) of Section 35 (which is located approximately 13 miles east of Bloomfield, New Mexico. Applicant seeks an exception to the well location requirements provided within the "Special Rules and Regulations for the Basin-Dakota Pool," as promulgated by Division Order No. R-10987-B, as amended by Division Order No. R-10987-B (1), in order to drill and complete the proposed Florance Well No. 117-M within the same quarter section as the above-described Florance Well No. 117".*

Amoco Production Company  
April 26, 2001  
Page 2

---

Thank you for your cooperation and understanding, should you have any questions concerning this matter, your legal counsel should be able to assist you.

Sincerely,

A handwritten signature in dark ink, appearing to read "Michael E. Stogner", written over a horizontal line.

Michael E. Stogner  
Chief Hearing Officer/Engineer

cc: **New Mexico Oil Conservation Division - Aztec**  
U. S. Bureau of Land Management - Farmington  
William F. Carr, Legal Counsel for Amoco Production Company - Santa Fe

110032596

NSL

4/26/01

bp

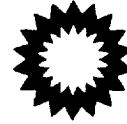

**San Juan Business Unit**  
**Amoco Production Company**  
A Part of the BP Amoco Group  
501 WestLake Park Blvd.  
Houston, TX 77079-3092

Phone: 281-366-4491

April 2, 2001

Mr. Michael Stogner  
New Mexico Oil Conservation Division  
2040 S. Pacheco Street  
Santa Fe, NM 87505

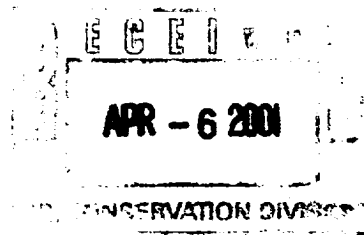

**Application For Non-Standard Well Location**  
**Florance Well No. 117M**  
**2380' FSL, 1790' FEL, Section 35-T29N-R09W**  
**Basin Dakota Gas Pool**  
**San Juan County, New Mexico**

Amoco Production Company hereby requests administrative approval for an non-standard well location for our Florance well no. 117M to be drilled and completed in both the Basin Dakota and the Blanco Mesaverde Gas Pools and downhole commingled. The subject well will require a non-standard location exception for the Basin Dakota completion as the proposed location does not conform to the Dakota location requirements that stipulate that a well be located no closer than 660' to any outer boundary of the quarter section on which the well is located. The proposed well location is 260' from the north line of the quarter section as shown on the attached Form C-102.

We respectfully request than administrative approval be granted for this Dakota location as stated above our intention is to completed in both the Dakota and Mesaverde Pools and downhole commingle. Application will be made to commingle the Mesaverde and Dakota via a separate application. The well is outside the well location window for the Dakota by being too close to the interior quarter section line thereby crowding our own spacing unit. Amoco is the only affected party. By completing the well at the proposed location it conforms to Mesaverde spacing requirements, prevents waste in the Mesaverde, minimizes interference with other Mesaverde wells and allows maximum drainage and recovery of the Mesaverde resource.

Also attached for your reference is a 9 Section plat with the subject well and surrounding wells identified, a portion of a topographic map with the well identified, and a map indicating directions to the well location.

bp

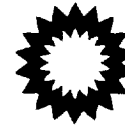

Your attention to this matter is greatly appreciated. Should you have any questions concerning this application please do not hesitate to call me at 281-366-4491.

Sincerely,

  
Mary Corley  
Sr. Regulatory Analyst  
[corleym1@bp.com](mailto:corleym1@bp.com)

cc: Frank Chavez, Supervisor  
NMOCD District III  
1000 Rio Brazos Road  
Aztec, NM 87410

District I  
PO Box 1980, Hobbs NM 88241-1980  
District II  
PO Drawer KK, Artesia, NM 87211-0719  
District III  
1000 Rio Brazos Rd., Aztec, NM 87410  
District IV  
PO Box 2088, Santa Fe, NM 87504-2088

State of New Mexico  
Energy, Minerals & Natural Resources Department

OIL CONSERVATION DIVISION  
PO Box 2088  
Santa Fe, NM 87504-2088

Form C-102  
Revised February 21, 1994  
Instructions on back  
Submit to Appropriate District Office  
State Lease - 4 Copies  
Fee Lease - 3 Copies

☐ AMENDED REPORT

WELL LOCATION AND ACREAGE DEDICATION PLAT

<sup>1</sup> API Number	<sup>2</sup> Pool Code	<sup>3</sup> Pool Name
	71599 & 72319	BASIN DAKOTA & BLANCO MESAVERDE
<sup>4</sup> Property Code	<sup>5</sup> Property Name	<sup>6</sup> Well Number
000518	Florance	# 117M
<sup>7</sup> OGRID No.	<sup>8</sup> Operator Name	<sup>9</sup> Elevation
000778	AMOCO PRODUCTION COMPANY	5695

<sup>10</sup> Surface Location

UL or Lot No.	Section	Township	Range	Lot Idn	Feet from the	North/South line	Feet from the	East/West line	County
J (Lot 10)	35	29 N	9 W		2380	SOUTH	1790	EAST	SAN JUAN

<sup>11</sup> Bottom Hole Location If Different From Surface

UL or lot no.	Section	Township	Range	Lot Idn	Feet from the	North/South line	Feet from the	East/West line	County
<sup>12</sup> Dedicated Acres	<sup>13</sup> Joint or Infill	<sup>14</sup> Consolidation Code	<sup>15</sup> Order No.						
306.35									

NO ALLOWABLE WILL BE ASSIGNED TO THIS COMPLETION UNTIL ALL INTERESTS HAVE BEEN CONSOLIDATED  
OR A NON-STANDARD UNIT HAS BEEN APPROVED BY THE DIVISION

<div><p>16</p><p>Lot 4</p><p>Florance #1 30-045-07693 1660' FSL - 995' FEL Spud: 4-14-1949 Blanco MU Comp</p><p>Lot 5</p><p>Florance Well No. 117 30-045-23827 950' FSL - 805' FEL (Spud: 12-26-79) Blanco MU Completion</p><p>Lot 12</p><p>Florance #1A 30-045-22350 745' FSL - 995' FEL Lot 13 Spud: 5-13-77 Blanco MU Completion</p></div>	<div><p>Lot 3</p><p>Florance Well No. 117-E 30-045-24350 Spud: 4-10-1951 1730' FSL - 995' FEL Basin Dakota Completion</p><p>Lot 6 Unit 1 1993 Recompleted to the Chacra and Basin Fruitland Coal</p></div> <p>35</p>	<div><p>Lot 2</p><p>Lot 1</p><p>Lot 8</p><p>Lot 7</p><p>Lot 9</p><p>Lot 10</p><p>Lot 11</p><p>Lot 15</p><p>Lot 16</p></div>	<div><p>17 OPERATOR CERTIFICATION</p><p>I hereby certify that the information contained herein is true and complete to the best of my knowledge and belief.</p><p><i>Mary Corley</i></p><p>Signature</p><p>MARY CORLEY</p><p>Printed Name</p><p>SR. REGULATORY ANALYST</p><p>Title</p><p>4-2-01</p><p>Date</p><p>18 SURVEYOR CERTIFICATION</p><p>I hereby certify that the well location shown on this plat was plotted from field notes of actual surveys made by me or under my supervision, and that the same is true and correct to the best of my belief.</p><p>January 25, 2001</p><p>Date of Survey</p><p>Signature and Seal of Professional Surveyor</p><p><i>[Signature]</i></p><p>7016</p><p>Certificate Number</p></div>
---	--	---	---

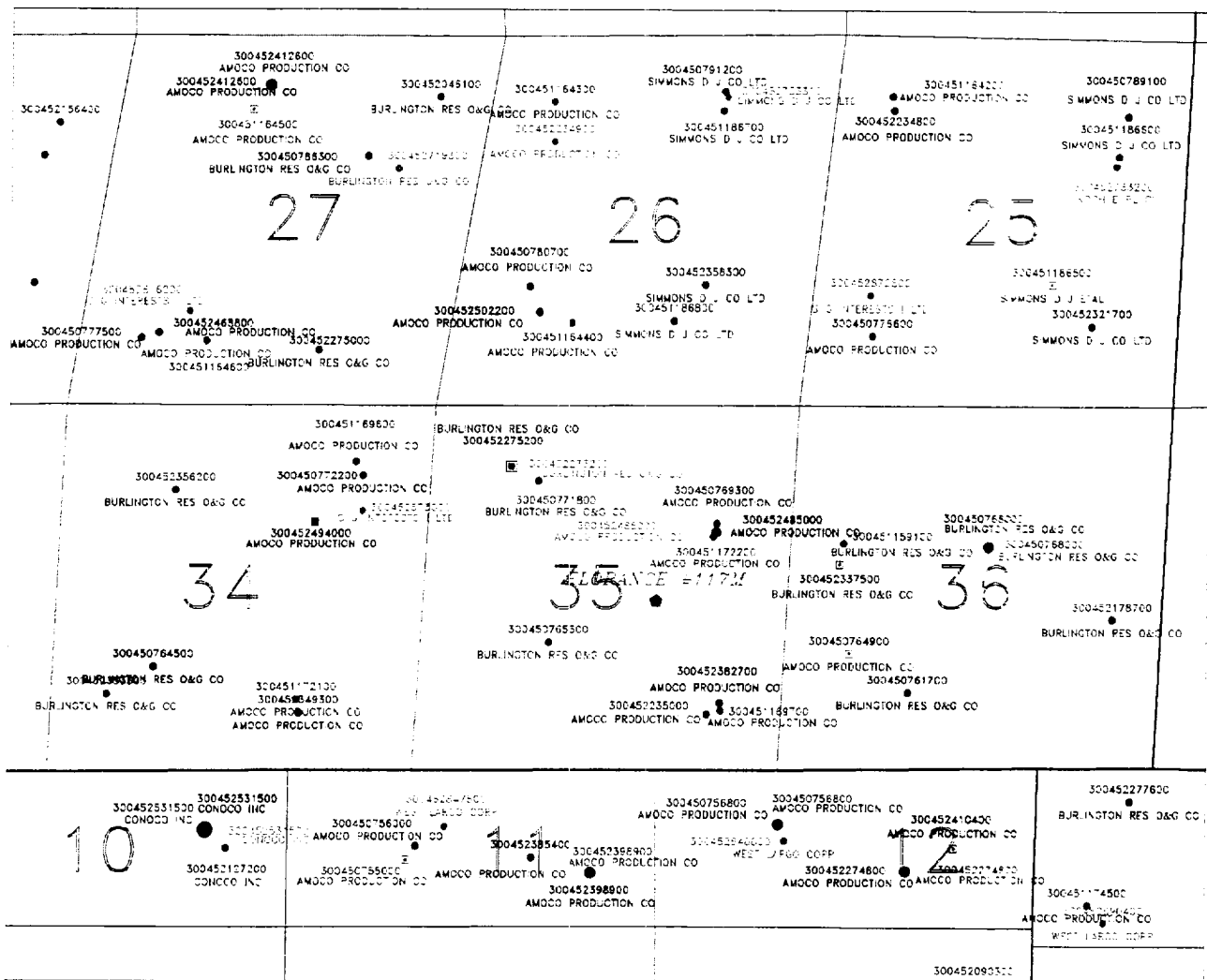

- DAKOTA ACTIVE WELL
- DAKOTA INACTIVE WELL
- MESSEVERGE ACTIVE WELL
- MESSEVERGE INACTIVE WELL
- PICTURED CLIFFS ACTIVE WELL
- PICTURED CLIFFS INACTIVE WELL

Amoco Production Company HOUSTON, TEXAS		
9 Section Plat 29N 9W Section 35 Florance 117M		
SCALE	DATE E. E. SACKETT	DATE 2-APR-2001
CORRECTION		

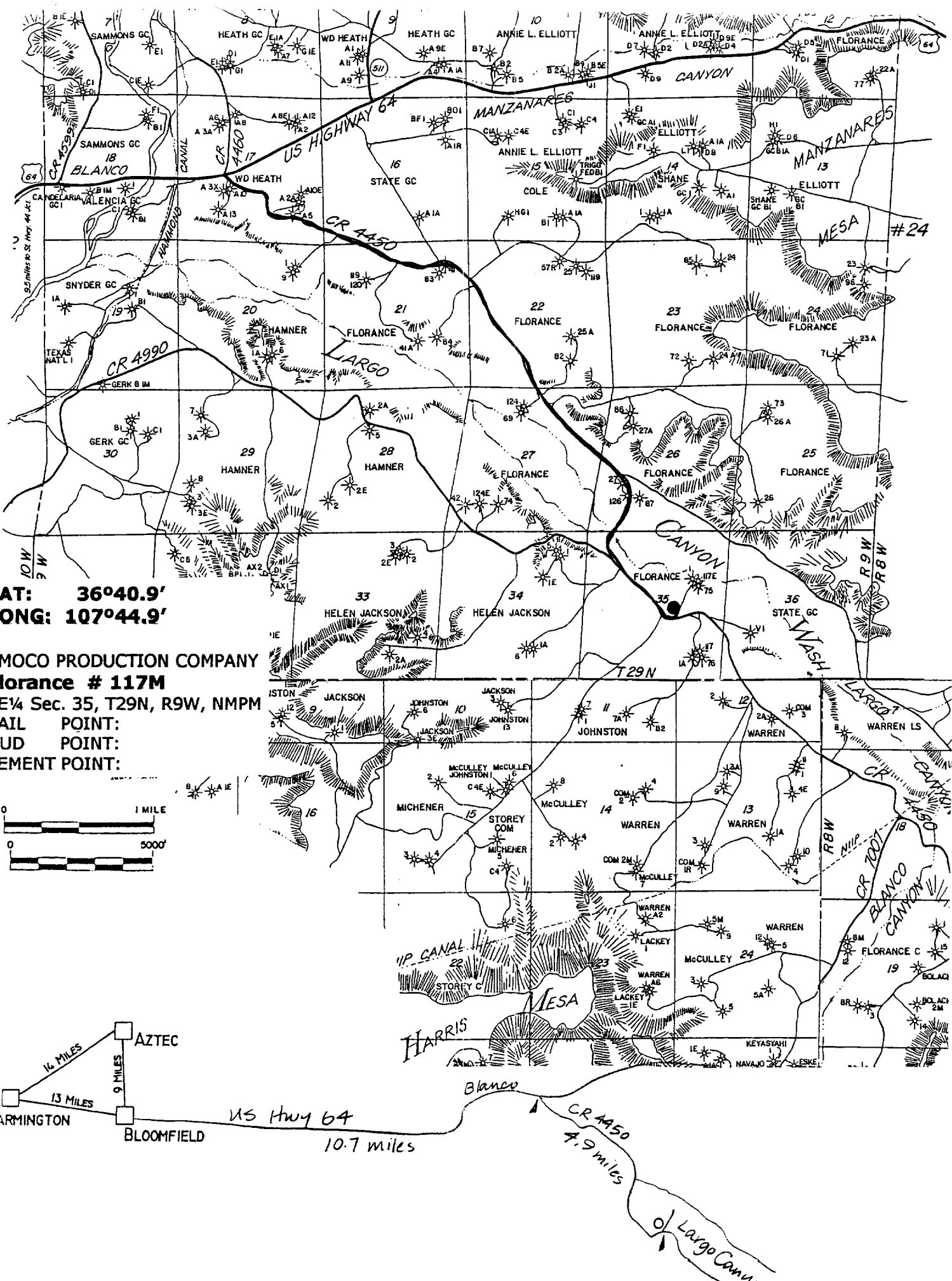

AT: 36°40.9'  
ONG: 107°44.9'

MOCO PRODUCTION COMPANY  
lorance # 117M  
E¼ Sec. 35, T29N, R9W, NMPM  
AIL POINT:  
UD POINT:  
EMENT POINT:

