

District I
1625 N. French Dr., Hobbs, NM 88240
District II
811 South First, Artesia, NM 88210
District III
1000 Rio Brazos Road, Aztec, NM 87410
District IV
1220 S. St. Francis Dr., Santa Fe, NM 87505

State of New Mexico
Energy Minerals and Natural Resources
Oil Conservation Division
1220 South St. Francis Dr.
Santa Fe, NM 87505

Form C-101
Revised March 17, 1999

Submit to appropriate District Office
State Lease - 6 Copies
Fee Lease - 5 Copies

☐ AMENDED REPORT

APPLICATION FOR PERMIT TO DRILL, RE-ENTER, DEEPEN, PLUGBACK, OR ADD A ZONE

¹ Operator Name and Address Richardson Operating Company (303) 830-8000 1700 Lincoln St., Suite 1700, Denver, Co. 80203		² OGRID Number 19219
³ Property Code 26060	⁴ Property Name Eaton White	⁵ API Number 30 - 045 - 30977
		⁶ Well No. 2

⁷ Surface Location

UL or lot no.	Section	Township	Range	Lot Idn	Feet from the	North/South line	Feet from the	East/West line	County
B	20	29n	13w		1250	North	1428	East	SJ

⁸ Proposed Bottom Hole Location If Different From Surface

UL or lot no.	Section	Township	Range	Lot Idn	Feet from the	North/South line	Feet from the	East/West line	County

⁹ Proposed Pool 1 West Kutz Picture Cliffs	¹⁰ Proposed Pool 2 Basin Fruitland Coal
---	--

¹¹ Work Type Code N	¹² Well Type Code G	¹³ Cable/Rotary R	¹⁴ Lease Type Code P	¹⁵ Ground Level Elevation 5,280'
¹⁶ Multiple Yes	¹⁷ Proposed Depth 1,150'	¹⁸ Formation Lewis	¹⁹ Contractor .	²⁰ Spud Date 1-30-02

²¹ Proposed Casing and Cement Program

Hole Size	Casing Size	Casing weight/foot	Setting Depth	Sacks of Cement	Estimated TOC
8 - 3/4"	7"	20	120'	60 sx	Surface
6 - 1/4"	4 - 1/2"	10.5	1,150'	155 sx	Surface

²² Describe the proposed program. If this application is to DEEPEN or PLUG BACK, give the data on the present productive zone and proposed new productive zone.

Describe the blowout prevention program, if any. Use additional sheets if necessary.

Will use 2000# BOP and run logs and DST as appropriate.

*Coal only - B/G
Fed mins
called SLO
1-24-02
ST*

²³ I hereby certify that the information given above is true and complete to the best of my knowledge and belief. Signature: <i>Brian Wood</i> Printed name: Brian Wood Title: Consultant Date: Jan. 18, 2002		OIL CONSERVATION DIVISION Approved by: <i>[Signature]</i> Title: PROPERTY CLERK Approval Date: JAN 22 2002 Expiration Date: JAN 22 2003 Conditions of Approval: Attached <input type="checkbox"/>	
Phone: (505) 466-8120			

State of New Mexico
Energy, Minerals & Mining Resources Department
OIL CONSERVATION DIVISION
2040 South Pacheco
Santa Fe, NM 87505

Form C - 102

☐ AMENDED REPORT

WELL LOCATION AND ACREAGE DEDICATION PLAT

APA Number 30-045-30977	Pool Code 71629 & 79680	Pool Name BASIN FRUIT. COAL & WEST KUTZ PC
Property Code 26060	Property Name EATON WHITE	Well Number 2
OGRD No. 019219	Operator Name RICHARDSON OPERATING COMPANY	Elevation 5280'

Surface Location									
UL or Lot B	Sec. 20	Twp. 29 N.	Rge. 13 W.	Lot Idn.	Feet from 1250'	North/South NORTH	Feet from 1428'	East/West EAST	County SAN JUAN

Bottom Hole Location If Different From Surface									
UL or Lot	Sec.	Twp.	Rge.	Lot Idn.	Feet from	North/South	Feet from	East/West	County
Dedication	Joint ?	Consolidation	Order No.						

NO ALLOWABLE WILL ASSIGNED TO THIS COMPLETION UNTIL ALL INTERESTS HAVE BEEN CONSOLIDATED
OR A NON-STANDARD UNIT HAS BEEN APPROVED BY THE DIVISION

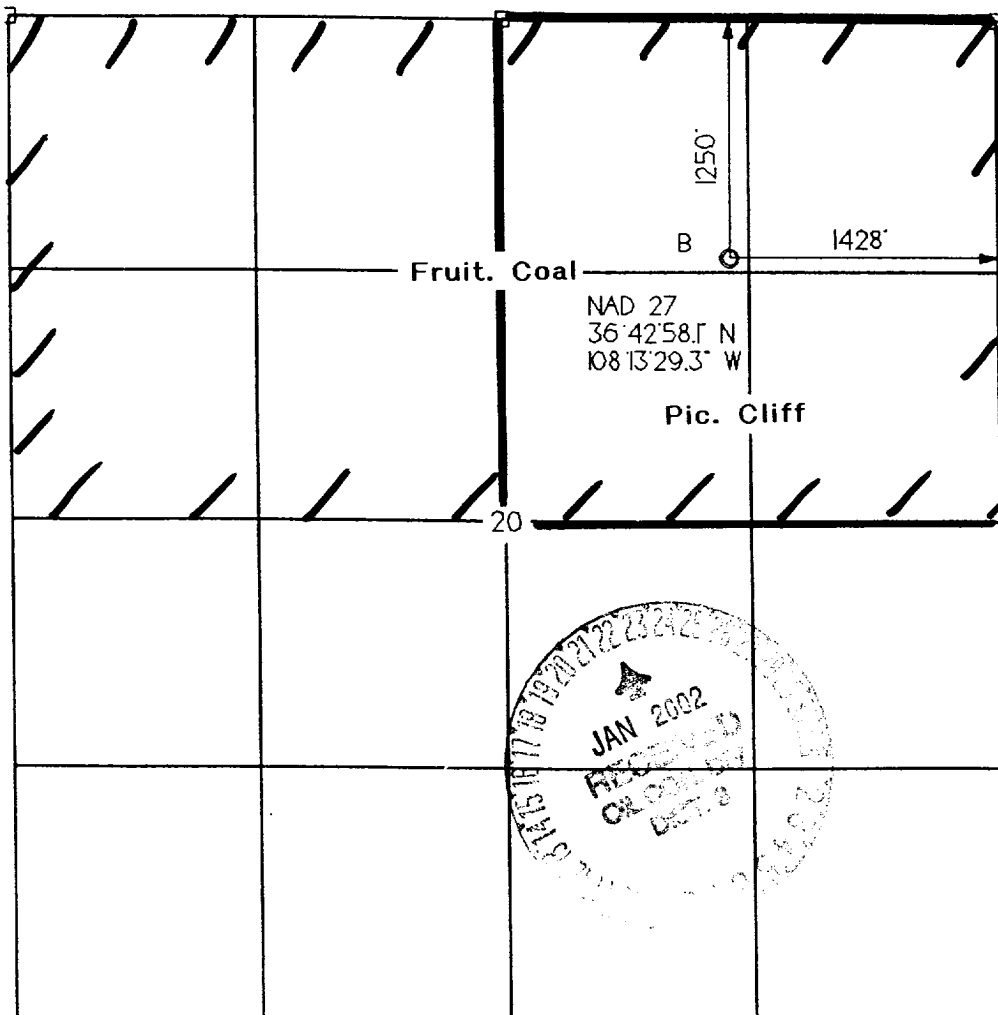

OPERATOR CERTIFICATION I hereby certify that the information contained herein is true and complete to the best of my knowledge and belief. Signature <i>Brian Wood</i>	
Printed Name	BRIAN WOOD
Title	CONSULTANT
Date	JAN. 18, 2002
SURVEYOR CERTIFICATION I hereby certify that the well location on this plat was plotted from field notes of actual surveys made by me or under my supervision, and that the same is true and correct to the best of my belief. Date of Survey OCTOBER 2001	
Signature and Seal of Professional Surveyor <i>G. W. H. B. LESTON</i> 	