

NEW MEXICO OIL CONSERVATION COMMISSION
Santa Fe, New Mexico

Form C-101
Revised (12/1/55)

30-045-60259

NOTICE OF INTENTION TO DRILL

Notice must be given to the District Office of the Oil Conservation Commission and approval obtained before drilling or recompletion begins. If changes in the proposed plan are considered advisable, a copy of this notice showing such changes will be returned to the sender. Submit this notice in QUINTUPLICATE. One copy will be returned following approval. See additional instructions in Rules and Regulations of the Commission. If State Land submit 6 Copies Attach Form C-128 in triplicate to first 3 copies of form C-101

Farmington, New Mexico

9-16-57

(Place)

(Date)

OIL CONSERVATION COMMISSION Verbal approval received from N.M.O.C.C. in Aztec, N.M. 9-16-57.
SANTA FE, NEW MEXICO

Gentlemen:

You are hereby notified that it is our intention to commence the Drilling of a well to be known as

PAN AMERICAN PETROLEUM CORPORATION

(Company or Operator)

Gonzales Gas Unit "A"

(Lease)

Well No. 1

I

(Unit)

The well is

located 1850 feet from the South line and 1010 feet from the East line of Section 20, T. 20N, R. 10W, NMPM.

(GIVE LOCATION FROM SECTION LINE) Aztec-Pictured Cliffs Pool, San Juan County

If State Land the Oil and Gas Lease is No.

If patented land the owner is F. Gonzales

Address Blanco, N.M.

We propose to drill well with drilling equipment as follows: Rotary tools to total depth

The status of plugging bond is

Drilling Contractor Sage Drilling Company
Box 788, San Angelo, Texas

We intend to complete this well in the Pictured Cliffs formation at an approximate depth of 2100' feet.

CASING PROGRAM

We propose to use the following strings of Casing and to cement them as indicated:

Size of Hole	Size of Casing	Weight per Foot	New or Second Hand	Depth	Sacks Cement
11'	8-5/8"	24#	NEW	250'	125
7-7/8"	5-1/2"	14#	NEW	2100'	100

If changes in the above plans become advisable we will notify you immediately.

ADDITIONAL INFORMATION (If recompletion give full details of proposed plan of work.)

We propose to drill the above well to approximately 2100' and complete the Pictured Cliffs Zone. Stimulation will be indicated upon reaching this depth. Copies of location plat are attached. A copy of any survey will be submitted upon completion of well.

Approved
Except as follows:

Sincerely yours,

PAN AMERICAN PETROLEUM CORPORATION
ORIGINAL SIGNATURE

By D. J. SCOTT

Position Field Clerk

Send Communications regarding well to

Name Pan American Petroleum Corporation

Address Box 487, Farmington, New Mexico

OIL CONSERVATION COMMISSION

By

NEW MEXICO OIL CONSERVATION COMMISSION

Well Location and Acreage Dedication Plat

Date **AUGUST 8, 1957**

Section A.

Operator **PAN AMERICAN PETROLEUM CORP.** Lease **GONZALES GAS UNIT "A"**
 Well No. **1** Unit Letter **I** Section **20** Township **29 NORTH** Range **10 WEST** NMPM
 Located **1850** Feet From **the SOUTH** Line. **1010** Feet From **the EAST** Line
 County **SAN JUAN** G. L. Elevation ***** Dedicated Acreage **160** Acres
 Name of Producing Formation **Pictured Cliffs** Pool **Aztec-Pictured Cliffs**

1. Is the Operator the only owner in the dedicated acreage outlined on the plat below?

Yes ☒ No ☐2. If the answer to question one is "no", have the interests of all the owners been consolidated by communitization agreement or otherwise? Yes ☐ No ☐ If answer is "yes", Type of Consolidation.

3. If the answer to question two is "no", list all the owners and their respective interests below:

Owner	Land Description
*To be reported later	

Section B.

This is to certify that the information in Section A above is true and complete to the best of my knowledge and belief.

PAN AMERICAN PETROLEUM CORPORATION

(Operator)

R. M. BAUER, JR. *RMBauer Jr.*

(Representative)

BOX 487, FARMINGTON, NEW MEXICO

(Address)

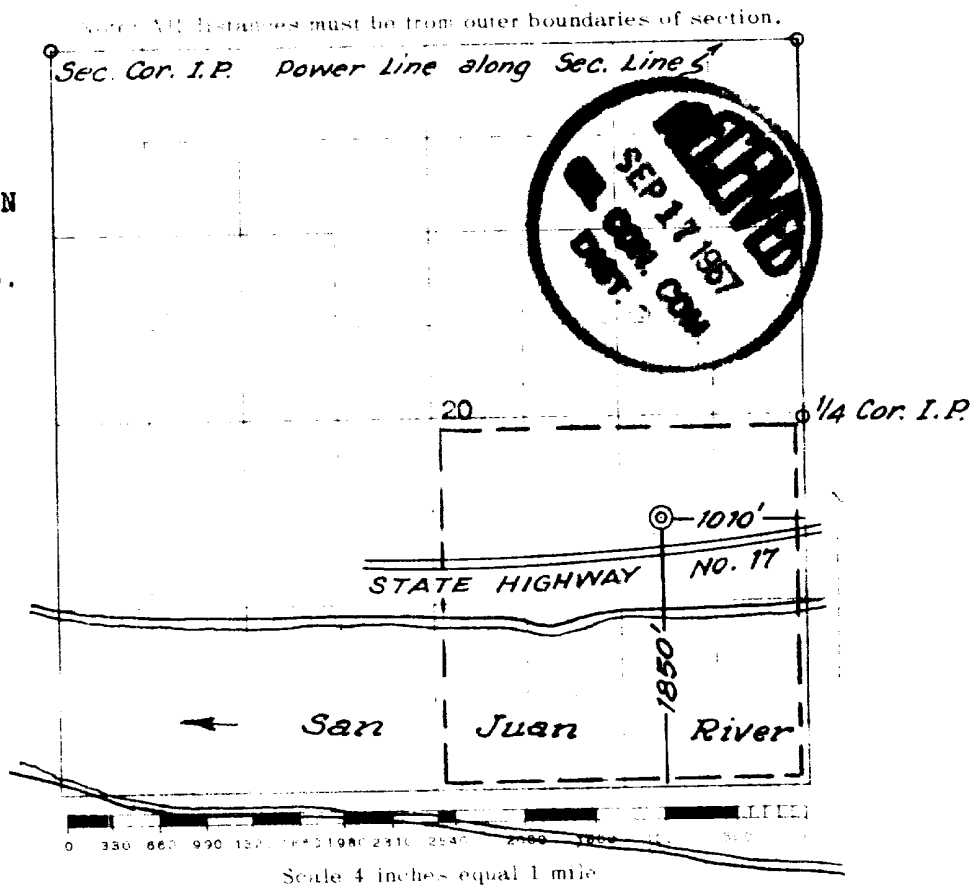

This is to certify that the above plat was prepared from field notes of actual surveys made by me or under my supervision and that the same are true and correct to the best of my knowledge and belief.

Dated Surveyed

5 JULY 1957

James P. Loebe
 Professional Engineer and Surveyor

James P. Loebe

N. Mex. Reg. No. 11622

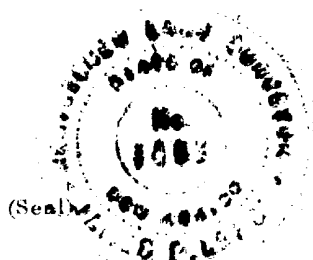

Farmington, New Mexico

OIL CONSERVATION COMMISSION		
AZTEC DISTRICT OFFICE		
No. Copies Received 5		
DISTRIBUTION		
	NO.	
	COPIES	
Operator	1	
Santa Fe	1	
Froration Office		
State Land Office		
U. S. G. S.	2	
Transporter		
File	1	✓