

(SUBMIT IN TRIPLICATE)

UNITED STATES
DEPARTMENT OF THE INTERIOR
GEOLOGICAL SURVEY

Land Office Santa Fe
Lease No. 078893
Unit Rosa

SUNDRY NOTICES AND REPORTS ON WELLS

NOTICE OF INTENTION TO DRILL	<input checked="" type="checkbox"/>	SUBSEQUENT REPORT OF WATER SHUT-OFF
NOTICE OF INTENTION TO CHANGE PLANS		SUBSEQUENT REPORT OF SHOOTING OR ACIDIZING
NOTICE OF INTENTION TO TEST WATER SHUT-OFF		SUBSEQUENT REPORT OF ALTERING CASING
NOTICE OF INTENTION TO RE-DRILL OR REPAIR WELL		SUBSEQUENT REPORT OF RE-DRILLING OR REPAIR
NOTICE OF INTENTION TO SHOOT OR ACIDIZE		SUBSEQUENT REPORT OF ABANDONMENT
NOTICE OF INTENTION TO PULL OR ALTER CASING		SUPPLEMENTARY WELL HISTORY
NOTICE OF INTENTION TO ABANDON WELL		

(INDICATE ABOVE BY CHECK MARK NATURE OF REPORT, NOTICE, OR OTHER DATA)

Well No. 7 is located ⁸⁴⁰~~850~~ ft. from [N] line and 1050 ft. from [E] line of sec. 23
(1/4 Sec. and Sec. No.)
31 North 4 West
(Twp.) (Range) (Meridian)
San Juan Basin W.C. Rio Arriba New Mexico
(Field) (County or Subdivision) (State or Territory)

The elevation of the derrick floor above sea level is _____ ft.

DETAILS OF WORK

(State names of and expected depths to objective sands; show sizes, weights, and lengths of proposed casings; indicate mudding jobs, cementing points, and all other important proposed work)

Proposed Total Depth 4000'

Formations to be Tested
and Approximate Depths

Suggestions for Running
Pipe

Suggestions for
Coring

Fruitland 3590 - 3720

Pictured Cliff 3720 - 4000

10-3/4" - 965'

7" on top of Pictured
Cliff

Make DST Thru
the Fruitland and
Pictured Cliff
Formations

I understand that this plan of work must receive approval in writing by the Geological Survey before operations may be commenced.

Company Colorado Oil and Gas Corporation

Address 311 Equitable Building

Denver 2, Colorado

By

J. P. Moroney

Title

Vice-President

1000

1000

1000

1000

1000

1000

1000

1000

1000

1000

1000

1000

1000

1000

1000

1000

1000

RECEIVED

OCT 12 1954
U. S. GEOLOGICAL SURVEY
FARMINGTON, N. M.

COMPANY Colorado Oil and Gas Company

Well Name & No. _____ Lease No. _____

Location 840' from the North line and 1050' from the East line.

Being in the NE¹ of the NE¹

Sec. 23, T 31 N., R 4 W., N.M.P.M., Rio Arriba County, New Mexico.

Ground Elevation _____

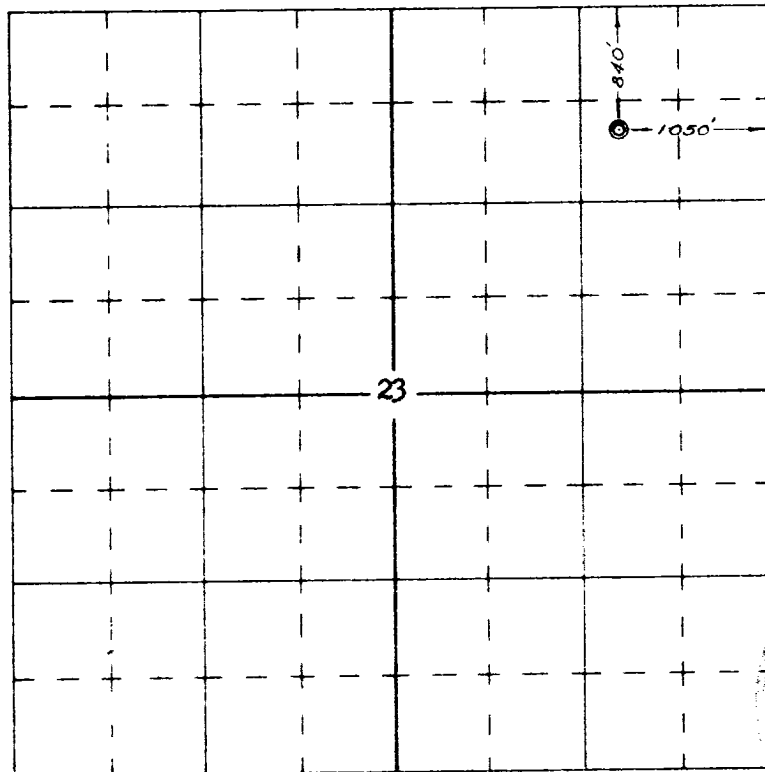

Scale -- 4 inches equals 1 mile

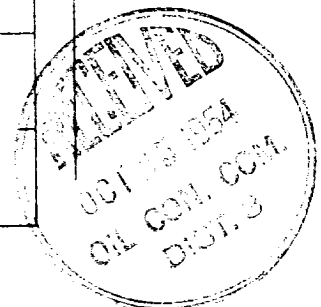

Surveyed October 9, 19 54

This is to certify that the above plat was prepared from field notes of actual surveys made by me or under my supervision and that the same are true and correct to the best of my knowledge and belief.

Seal:

Ernest V. Echohawk

Registered Professional
Engineer and Land Surveyor.
Ernest V. Echohawk
N. Mex. Reg. No. 1545

Farmington, New Mexico