

1 - Mr L.G. Truby  
1 - File

Budget Bureau No. 42-R358.4.  
Approval expires 12-31-60.

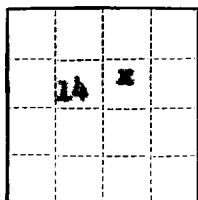

(SUBMIT IN TRIPLICATE)

UNITED STATES  
DEPARTMENT OF THE INTERIOR  
GEOLOGICAL SURVEY

Land Office **Santa Fe**  
Lease No. **SF-076771**  
Unit **Rosa**  
**14-08-001-587**

SUNDRY NOTICES AND REPORTS ON WELLS

NOTICE OF INTENTION TO DRILL.....	<input checked="" type="checkbox"/>	SUBSEQUENT REPORT OF WATER SHUT-OFF.....	
NOTICE OF INTENTION TO CHANGE PLANS.....		SUBSEQUENT REPORT OF SHOOTING OR ACIDIZING.....	
NOTICE OF INTENTION TO TEST WATER SHUT-OFF.....		SUBSEQUENT REPORT OF ALTERING CASING.....	
NOTICE OF INTENTION TO RE-DRILL OR REPAIR WELL.....		SUBSEQUENT REPORT OF RE-DRILLING OR REPAIR.....	
NOTICE OF INTENTION TO SHOOT OR ACIDIZE.....		SUBSEQUENT REPORT OF ABANDONMENT.....	
NOTICE OF INTENTION TO PULL OR ALTER CASING.....		SUPPLEMENTARY WELL HISTORY.....	
NOTICE OF INTENTION TO ABANDON WELL.....			

(INDICATE ABOVE BY CHECK MARK NATURE OF REPORT, NOTICE, OR OTHER DATA)

April 3, 1957

Well No. **20-14** is located **1580** ft. from **[N]** line and **1790** ft. from **[E]** line of sec. **14**

**14** **31 North** **6 West** **N.M.P.M.**  
( $\frac{1}{4}$  Sec. and Sec. No.) (Twp.) (Range) (Meridian)

**Blanco Mesa Verde** **Rio Arriba** **New Mexico**  
(Field) (County or Subdivision) (State or Territory)

The elevation of the ~~ungraded ground~~ above sea level is **6355** ft.

DETAILS OF WORK

(State names of and expected depths to objective sands; show sizes, weights, and lengths of proposed casings; indicate mudding jobs, cementing points, and all other important proposed work)

Propose to drill to 200' and set 10-3/4" casing, cement to surface. Set 7-5/8" casing @ 3635', cement to 1000' above shoe using 8% gel w/50 sz neat on bottom. Set 5-1/2" liner @ 5870', cement w/150 sz reg. Test top of liner and Bradenhead sqs w/50 sz reg if necessary.

Purf and frac Mesa Verde using approx 150,000 gals water. Clean out to total depth, run tubing and complete well.

The E/2 of Section 14, containing 320 acres, is dedicated to this well.

100% Pacific Northwest

I understand that this plan of work must receive approval in writing by the Geological Survey before operations may be commenced.

Company **PACIFIC NORTHWEST PIPELINE CORPORATION**

Address **405 1/2 West Broadway**

**Farmington, New Mexico**

Original signed by T. A. Dugan  
By \_\_\_\_\_

Title **T. A. Dugan**  
**Assistant Division Manager**

NEW MEXICO  
OIL CONSERVATION COMMISSION

Form C-128

Well Location and/or Gas Proration Plat

Date April 3, 1957

Operator Pacific Northwest Pipeline Corporation Lease None Unit

Well No. 20-14 Section 14 Township 31 North Range 6 West NMPM

Located 1580 Feet From North Line, 1790 Feet From East Line,

Rio Arriba County, New Mexico. G. L. Elevation 6355

Name of Producing Formation None Verde Pool None Dedicated Acreage 200

(Note: All distances must be from outer boundaries of Section)

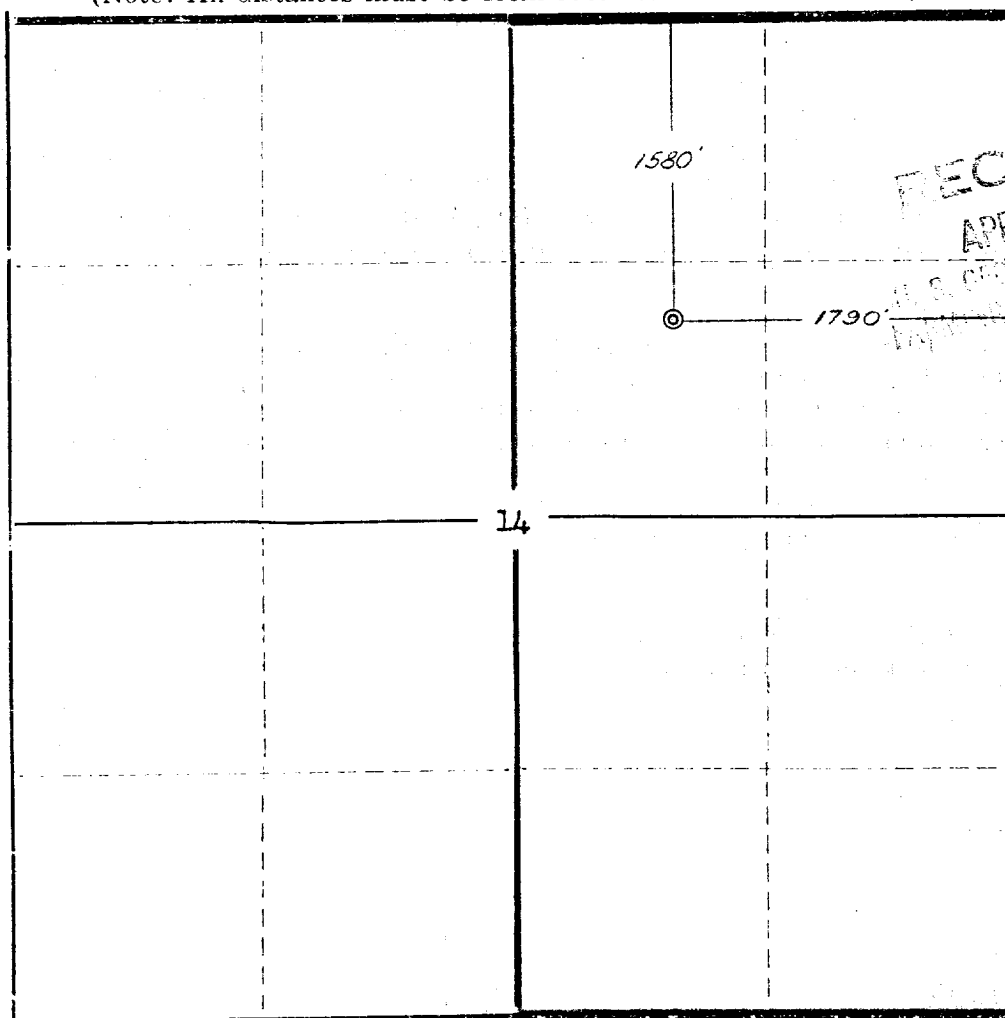

NOTE

This section of form is to be used for gas wells only.

SCALE: 1" 1000'

1. Is this Well a Dual Comp. ? Yes ☒ No ☐
2. If the answer to Question 1 is yes, are there any other dually completed wells within the dedicated acreage?  
Yes ☐ No ☒

Name T. A. Egan  
Position Assistant Division Manager  
Representing PACIFIC NORTHWEST PIPELINE CORPORATION  
Address 409 1/2 W. Broadway, Farmington, New Mexico

This is to certify that the above plat was prepared from field notes of actual surveys made by me or under my supervision and that the same are true and correct to the best of my knowledge and belief.

Date Surveyed February 6, 1957

Ernest V. Echoshawk  
Ernest V. Echoshawk  
Reg. Land Surveyor, N. Mex., Reg. No. 1545