

(SUBMIT IN TRIPLICATE)

UNITED STATES  
DEPARTMENT OF THE INTERIOR  
GEOLOGICAL SURVEY

Land Office Santa Fe  
Lease No. NM 03357  
Unit Northeast Blanco  
Unit Agrmt. No. 1, Sec. 929

SUNDRY NOTICES AND REPORTS ON WELLS

NOTICE OF INTENTION TO DRILL	<input checked="" type="checkbox"/>	SUBSEQUENT REPORT OF WATER SHUT-OFF	
NOTICE OF INTENTION TO CHANGE PLANS		SUBSEQUENT REPORT OF SHOOTING OR ACIDIZING	
NOTICE OF INTENTION TO TEST WATER SHUT-OFF		SUBSEQUENT REPORT OF ALTERING CASING	
NOTICE OF INTENTION TO RE-DRILL OR REPAIR WELL		SUBSEQUENT REPORT OF RE-DRILLING OR REPAIR	
NOTICE OF INTENTION TO SHOOT OR ACIDIZE		SUBSEQUENT REPORT OF ABANDONMENT	
NOTICE OF INTENTION TO PULL OR ALTER CASING		SUPPLEMENTARY WELL HISTORY	
NOTICE OF INTENTION TO ABANDON WELL			

(INDICATE ABOVE BY CHECK MARK NATURE OF REPORT, NOTICE, OR OTHER DATA)

June 12, 1961

Well No. 62-30 is located 1470 ft. from NX line and 1250 ft. from W line of sec. 30  
SW/4 Sec. 30 31N 6W NM  
 (1/4 Sec. and Sec. No.) (Twp.) (Range) (Meridian)  
Blanco Mesaverde Rio Arriba New Mexico  
 (Field) (County or Subdivision) (State or Territory)

The elevation of the derrick floor above sea level is 6574 ft.

DETAILS OF WORK

(State names of and expected depths to objective sands; show sizes, weights, and lengths of proposed casings; indicate mudding jobs, cementing points, and all other important proposed work)

Set approximately 200', 10 1/2" - H-40 - 32.75# surface casing and circulate cement.  
 Set approximately 3600', 7-5/8" - J-55 - 26.40# intermediate casing and cement with 350 sacks cement.  
 Set approximately 5800', 5 1/2" - J-55 - 15.50# production casing and cement with 200 sacks cement.  
 Perforate the Mesaverde Zone and sand-water fracture in two stages, with 60,000 gals. water and 40,000# sand each.

I understand that this plan of work must receive approval in writing by the Geological Survey before operations may be commenced.

Company Blackwood & Nichols Company

Address P. O. Box 1237

Durango, Colorado

By Delano Loos

Title Field Superintendent

NEW MEXICO OIL CONSERVATION COMMISSION  
Well Location and Acreage Dedication Plat

Revised 5/1/57

Section A.

Date May 11, 1961

Operator BLACKWOOD & NICHOLS CO. Lease NORTHEAST BLANCO UNIT  
Well No. 62-30 Unit Letter L Section 30 Township 31 N. Range 6 W. NMPM  
Locate. 1470 Feet From southline, 1250 Feet From west Line  
County Rio Arriba G. L. Elevation 6365 UG Dedicated Acreage 320 Acres  
Name of Producing Formation Mesa Verde Pool Blanco Mesa Verde

1. Is the Operator the only owner\* in the dedicated acreage outlined on the plat below?  
Yes \_\_\_\_\_ No X \_\_\_\_\_.
2. If the answer to question one is "no", have the interests of all the owners been consolidated by communitization agreement or otherwise? Yes X No \_\_\_\_\_. If answer is "yes", Type of Consolidation Unitization
3. If the answer to question two is "no", list all the owners and their respective interests below:

Owner

Land Description

RECEIVED  
JUN 1 1961

U.S. GEOLOGICAL SURVEY  
WASHINGTON, D.C.

Section B

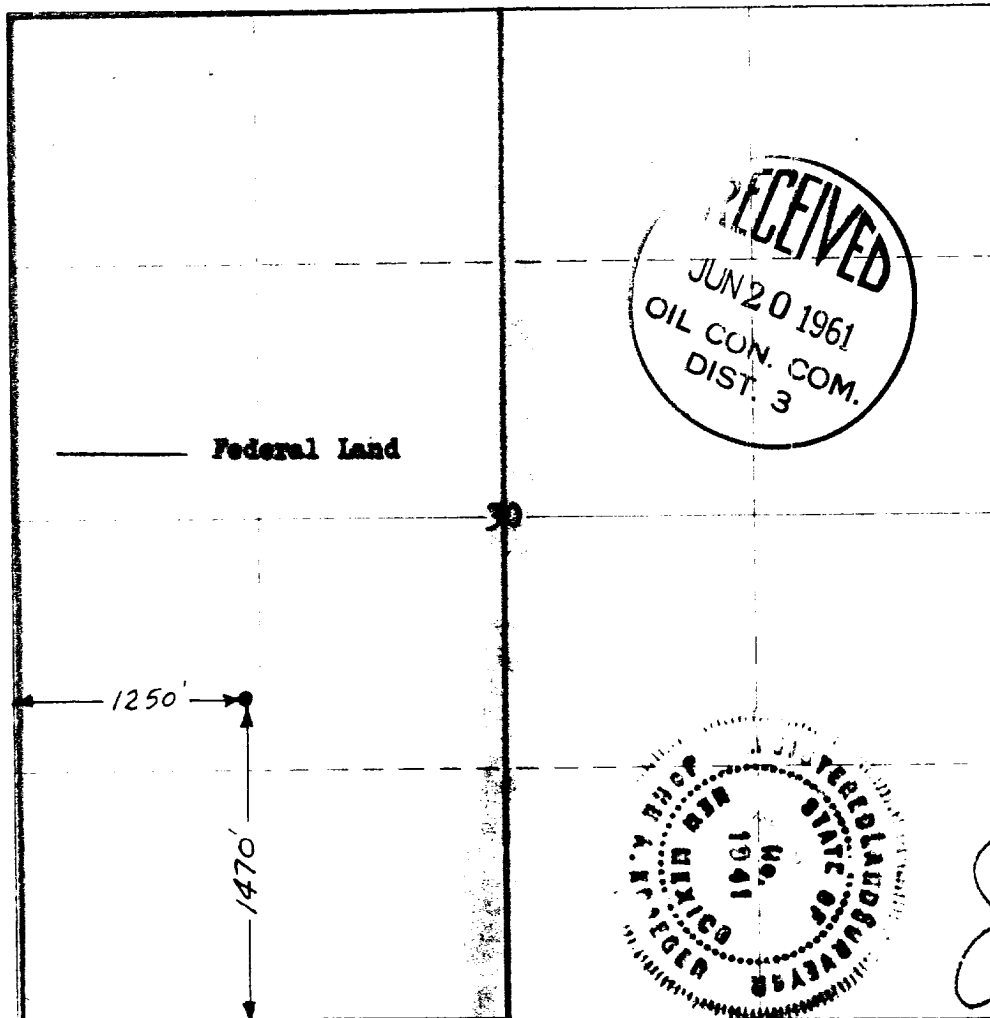

This is to certify that the information in Section A above is true and complete to the best of my knowledge and belief.

Blackwood & Nichols Company  
(Operator)

Original Signed

by Deliasse Loos  
(Representative)

P. O. Box 1237, Durango, Colo.  
Address

This is to certify that the well location shown on the plat in Section B was plotted from field notes of actual surveys made by me or under my supervision and that the same are true and correct to the best of my knowledge and belief.

Date Surveyed May 10, 1961

John A. Kroeger  
John A. Kroeger  
Registered Land Surveyor  
Durango, Colorado  
Certificate No. 1941