

NO. OF COPIES RECEIVED	5
DISTRIBUTION	
SANTA FE	1
FILE	1
U.S.G.S.	2
LAND OFFICE	
OPERATOR	1

NEW MEXICO OIL CONSERVATION COMMISSION

Form C-101
Revised 1-1-65 30-039-20491

5A. Indicate Type of Lease	
STATE <input type="checkbox"/>	FEE <input checked="" type="checkbox"/>
5. State Oil & Gas Lease No.	

APPLICATION FOR PERMIT TO DRILL, DEEPEN, OR PLUG BACK

1a. Type of Work		7. Unit Agreement Name	
b. Type of Well OIL WELL <input checked="" type="checkbox"/> GAS WELL <input type="checkbox"/> OTHER <input type="checkbox"/>		8. Farm or Lease Name Valdez	
2. Name of Operator Dugan Production Corp.		9. Well No. 1	
3. Address of Operator Box 234, Farmington, N. M. 87401		10. Field and Pool, or Wildcat Wildcat	
4. Location of Well UNIT LETTER D LOCATED 850 FEET FROM THE north LINE AND 870 FEET FROM THE west LINE OF SEC. 20 TWP. 31N RGE. 1E NMPM		12. County Rio Arriba	
19. Proposed Depth 1500'		19A. Formation Dakota	
20. Rotary or C.T. Rotary		21. Elevations (Show whether DF, RT, etc.) 7490' Gr.	
21A. Kind & Status Plug. Bond State Wide		21B. Drilling Contractor Morrow Drilling	
22. Approx. Date Work will start 4/18/72			

23.

PROPOSED CASING AND CEMENT PROGRAM

SIZE OF HOLE	SIZE OF CASING	WEIGHT PER FOOT	SETTING DEPTH	SACKS OF CEMENT	EST. TOP
8 3/4"	7 5/8"	24#	100'	15 sx.	surface
6 3/4"	4 1/2"	9.5#	1500'	100 sx.	750'

Drilling 6 3/4" hole with air to test Dakota formation, mud up hole if necessary, to log well - run and cement csg., selectively perforate, acidize, run tbg. and complete well.

APPROVAL VALID
FOR 90 DAYS UNLESS
DRILLING COMMENCED,

EXPIRES 7-24-72



IN ABOVE SPACE DESCRIBE PROPOSED PROGRAM: IF PROPOSAL IS TO DEEPEN OR PLUG BACK, GIVE DATA ON PRESENT PRODUCTIVE ZONE AND PROPOSED NEW PRODUCTIVE ZONE. GIVE BLOWOUT PREVENTER PROGRAM, IF ANY.

I hereby certify that the information above is true and complete to the best of my knowledge and belief.

Signed Original signed by T. A. Dugan Title Engineer Date 4/13/72

(This space for State Use)

APPROVED BY *George E. Currey* TITLE *Sup. Dist. III* DATE *4-25-72*

CONDITIONS OF APPROVAL, IF ANY:

**NEW MEXICO OIL CONSERVATION COMMISSION
WELL LOCATION AND ACERAGE DEDICATION PLAT**

All distances must be from the outer boundaries of the Section

Operator DUGAN PRODUCTION CORPORATION			Lease Valdez		Well No. 1
Unit Letter D	Section 20	Township 31 North	Range 1 East	County Rio Arriba	
Actual Footage Location of Well: <div style="display: flex; justify-content: space-between;"> 850 feet from the North line and 870 feet from the West line </div>					
Ground Level Elev. 7490	Producing Formation Dakota	Pool Wildcat	Dedicated Acreage: 40 Acres		

1. Outline the acreage dedicated to the subject well by colored pencil or hatchure marks on the plat below.
 2. If more than one lease is dedicated to the well, outline each and identify the ownership thereof (both as to working interest and royalty),
 3. If more than one lease of different ownership is dedicated to the well, have the interests of all owners been consolidated by communitization, unitization, force-pooling, etc?
- () Yes () No If answer is "yes," type of consolidation

If answer is "no," list the owners and tract descriptions which have actually consolidated. (Use reverse side of this form if necessary.)

No allowable will be assigned to the well until all interests have been consolidated (by communitization, unitization, forced-pooling, or otherwise) or until a non standard unit, eliminating such interests, has been approved by the Commission.

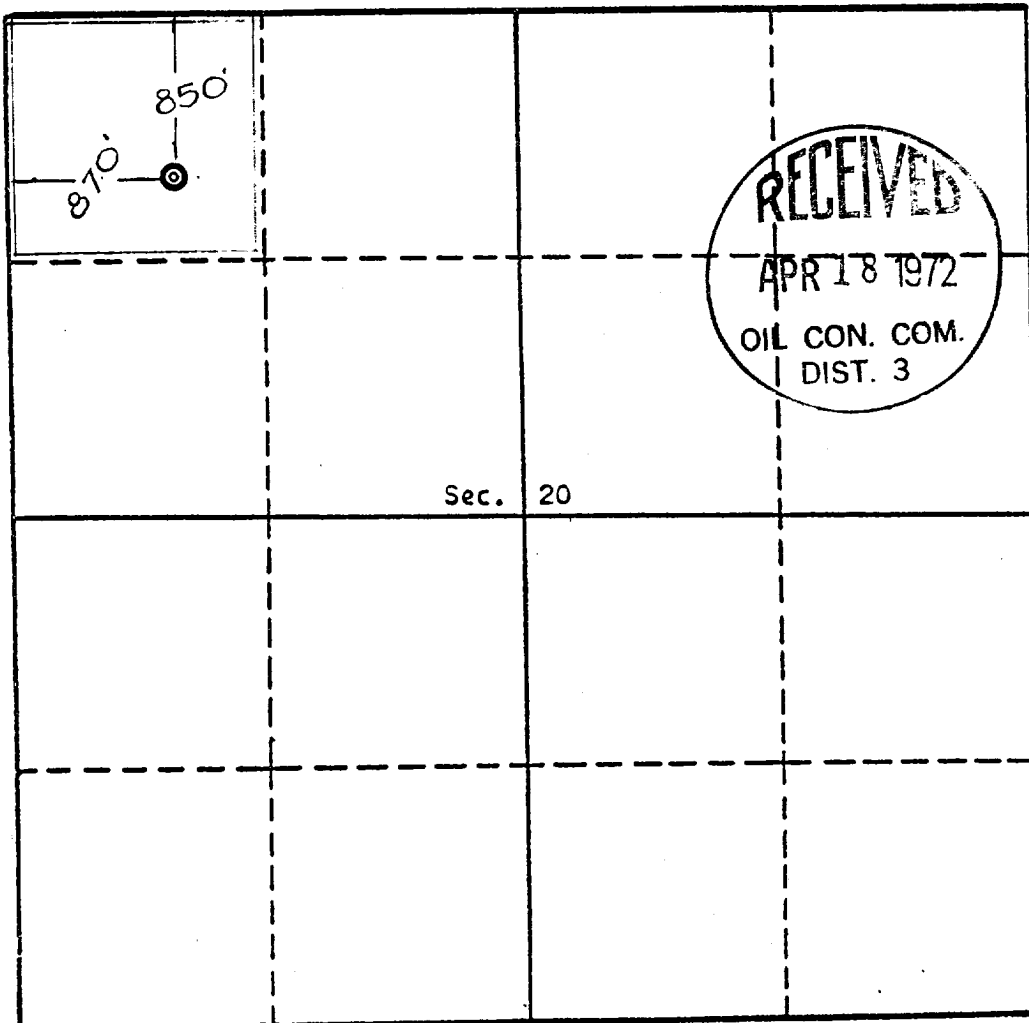

Scale, 1 inch = 1,000 feet

CERTIFICATION

I hereby certify that the information contained herein is true and complete to the best of my knowledge and belief.

Original signed by T. A. Dugan

Name Thomas A. Dugan

Position Engineer

Company Dugan Production Corp.

Date 4/13/72

I hereby certify that the well location shown on this plat was plotted from field notes of actual surveys made by me or under my supervision, and that the same is true and correct to the best of my knowledge and belief.

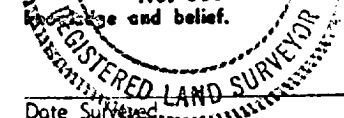

Date Surveyed

April 11, 1972
Registered Professional Engineer
and/or Land Surveyor

E. V. Echohawk
Certificate No. 3602
E. V. Echohawk LS