



STATE OF NEW MEXICO
ENERGY AND MINERALS DEPARTMENT
OIL CONSERVATION DIVISION

February 21, 1983

TONEY ANAYA
GOVERNOR

POST OFFICE BOX 2088
STATE LAND OFFICE BUILDING
SANTA FE, NEW MEXICO 87501
(505) 827-5800

Northwest Pipeline Corporation
P. O. Box 90
Farmington, New Mexico 87499

Attention: Paul C. Thompson

Administrative Order NSL-1662

Gentlemen:

Reference is made to your application for a non-standard location for your San Juan 31-6 Unit Well No. 44 to be located 2425 feet from the North line and 1020 feet from the East line of Section 29, Township 31 North, Range 6 West, Basin-Dakota Pool, Rio Arriba, County, New Mexico.

By authority granted me under the provisions of Rule 3 of Order No. R-1670, the above-described unorthodox location is hereby approved.

Sincerely,

A handwritten signature in dark ink, appearing to read "Joe D. Ramey", written over the typed name and title.

JOE D. RAMEY,
Director

JDR/RLS/dr

cc: Oil Conservation Division - Aztec
Oil & Gas Engineering Committee - Hobbs
Minerals Management Service - Albuquerque

NORTHWEST PIPELINE CORPORATION

PRODUCTION & DRILLING
P.O. BOX 90
FARMINGTON, NEW MEXICO ~~XXXX~~ 87499

5112.00-04-83

January 13, 1983

Mr. R.L. Stamets
NMOCD
P.O. Box 2088
Santa Fe, New Mexico 87501

Re: Application for Non-Standard Location
San Juan 31-6 Unit #44
2425 FNL & 1020 FEL
Sec 29, T31N, R6W

Dear Mr. Stamets:

Northwest Pipeline Corporation requests permission to drill the above captioned well in a Non-Standard Location due to archaeological and topographical reasons. This location was moved to its present location to avoid an archaeological discovery and still stay on top of the ridge which overlooks Navajo Reservoir.

Blackwood & Nichols is the only offset operator and they have been advised of this wells Non-Standard Location by certified mail. A copy of the letter along with a copy of the receipt for certified mail is enclosed.

Sincerely,

Paul C. Thompson
Paul C. Thompson
Drilling Engineer

PCT:djb
enclosure

All distances given are from the outer boundaries of the Section.

Owner Northwest Pipeline Corp			Lease San Juan 31-6 Unit		Well No. 44
Unit Letter H	Section 29	Township 31N	Range 6W	County Rio Arriba	
Actual Footage Location of Well:					
2425 feet from the North		line end 1020 feet from the East		line	
Ground Level Elev: 6503	Producing Formation Dakota	Pool Basin Dakota	Dedicated Acreage: 320 Acres		

1. Outline the acreage dedicated to the subject well by colored pencil or hachure marks on the plat below.
2. If more than one lease is dedicated to the well, outline each and identify the ownership thereof (both as to working interest and royalty).
3. If more than one lease of different ownership is dedicated to the well, have the interests of all owners been consolidated by communitization, unitization, force-pooling, etc?

☒ Yes ☐ No If answer is "yes," type of consolidation Unitization

If answer is "no," list the owners and tract descriptions which have actually been consolidated. (Use reverse side of this form if necessary.)

No allowable will be assigned to the well until all interests have been consolidated (by communitization, unitization, forced-pooling, or otherwise) or until a non-standard unit, eliminating such interests, has been approved by the Commission.

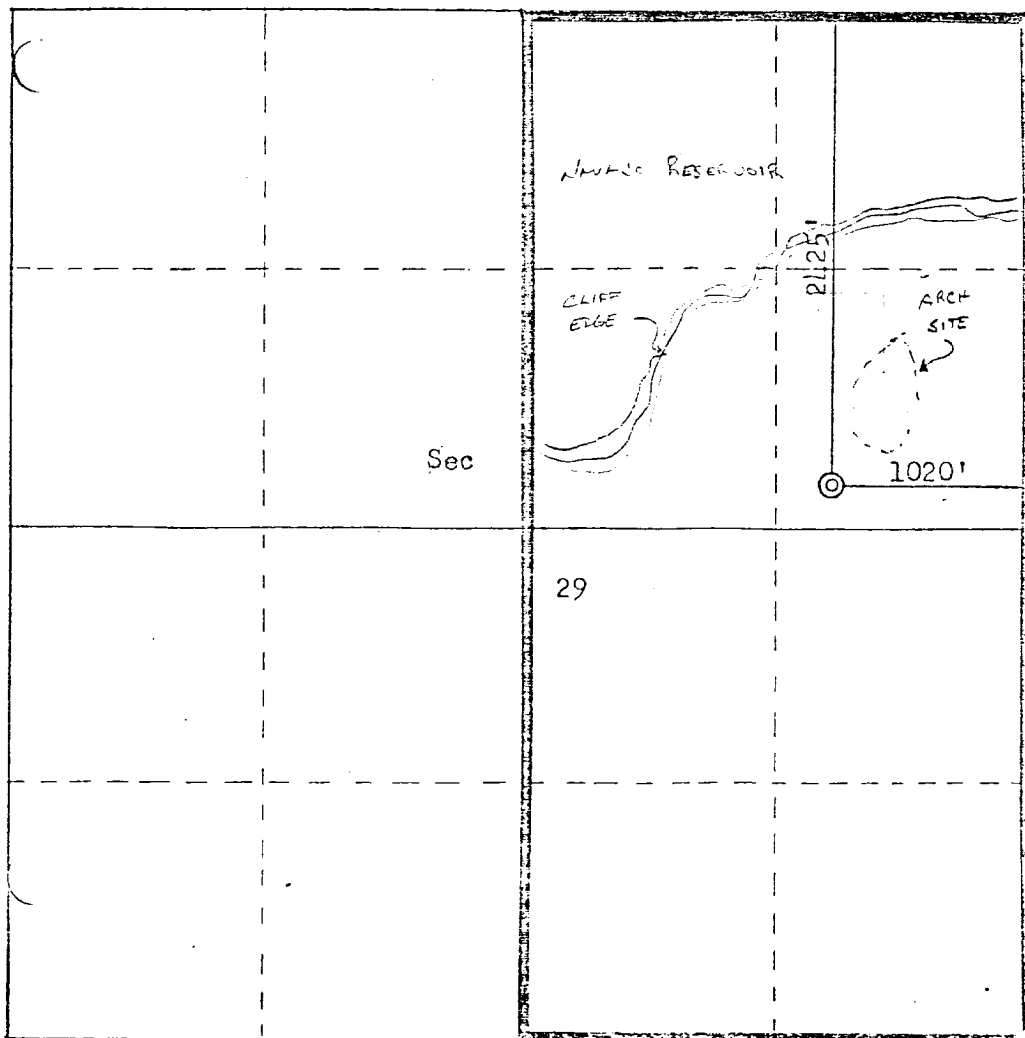

CERTIFICATION

I hereby certify that the information contained herein is true and complete to the best of my knowledge and belief.

Paul C. Thompson

Name
Paul C. Thompson

Position
Drilling Engineer

Company
Northwest Pipeline Corp

Date
November 30, 1982

I hereby certify that the well location shown on this plot was plotted from field notes of actual surveys made by me or under my supervision, and that the same is true and correct to the best of my knowledge and belief.

Date Surveyed

11-24-82

Registered Professional Engineer
and Land Surveyor

Fred B. Kerr Jr.
Fred B. Kerr Jr.

Certificate No. 4444

PLAT FOR NORTHWEST PIPELINE
SAN JUAN 31-6 UNIT #44

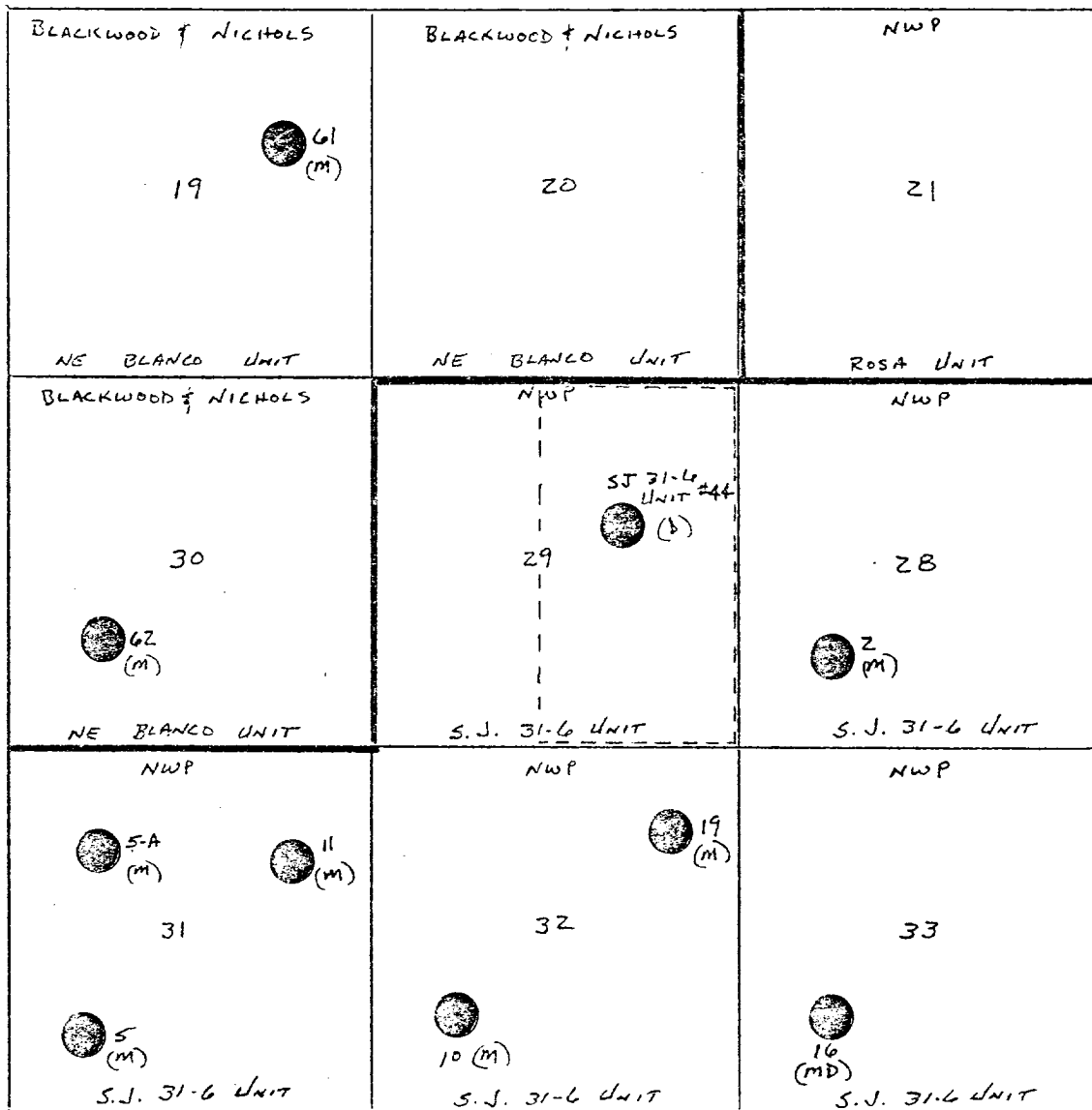

T31N

R6W

PROPOSED WELL: Northwest Pipeline Corporation - San Juan 31-6 #44

LAND STATUS: Public, administered by the Bureau of Land Management, Farmington Resource Area office.

LEGAL: Well - SW $\frac{1}{4}$, SE $\frac{1}{4}$, NE $\frac{1}{4}$ of Section 29, Township 31 North, Range 6 West, NMPM, in Rio Arriba County, New Mexico. The center stake was relocated in the field in order to further the distance from the northern well pad boundary to an archaeological site (Site JAS-53, reported on in JAS report #CR-82-71). The approximate footage to the relocated center stake is: 2370 feet from the north line and 1080 feet from the east line of Section 29. The center stake was moved approximately 150 feet southwest of its previous location and was well flagged in the field.

Access - A new access route will not be required as the southeastern edge of the proposed pad will overlap an existing road.

*Note- The first archaeological inspection of San Juan 31-6 #44 was conducted on 10-27-82 and is reported in JAS report #CR-82-71. At this inspection an archaeological site, JAS-53, was located in conjunction with the proposed pad, and a request was made by the archaeologist to move the location further to the south and west. The reinspection of this location on 11-19-82 concluded that the relocated pad was not yet far enough from the site to adequately reduce the possibility of potential impact. The northern boundary of the pad was approximately 20 feet from the southern edge of the concentrated artifact scatter of JAS-53, and thus carried the possibility of being disturbed by grading and pushpile activities. The 11-19-82 inspection requested that the center stake be relocated approximately 150 feet further south, resulting in the northern pad boundary being a safe distance from the sites southern artifact concentration. Additionally, it was requested, and agreed upon the field representatives, that the construction profile for the well pad be turned around so that the long rectangular portion of the pad is construction to the east/west and the reserve pit be placed in the northwest corner of the pad. (See Figure 7). A new stake was flagged in the field, and an archaeological inspection was conducted for the new area.

UIM COORDINATES: z13 2.78,910mE: 40,83,290mN

MAP REFERENCE: USGS Gomez Ranch, New Mexico Quadrangle, 7.5 minute series, 1954. Photorevised in 1971. (See Figure 5).

AREA OF DISTURBANCE: 300' x 265', 1.82 acres

AREA OF SURVEY: 400' x 400', 3.67 acres

VARIATION FROM PLATS: The center stake shown in Figure 6 has been moved approximately 150 feet to the southwest, and the north arrow in Figure 7 has been changed to indicate the requested profile for San Juan 31-6 #44.

TOPOGRAPHY/
SOILS The proposed location is a flat open area at 6500 feet amsl. The soils in this area belong to the Travessilla-Rockland association and are subgrouped as Lithic Ustic Torriorthents. These soils are finely textured, sandy loams formed by the decomposing sandstones and shales of the surface formation. Much of this area has been previously worked and reseeded.

WATER SOURCES: Navajo Reservoir, a constant, modern, water source is located 3/4 of a mile northeast of the location.

VEGETATION: The location will be constructed within a sagebrush (Artemisia tridentata) dominated area, fringed on the sides by sparse to moderate stands of pinon (Pinus edulis) and juniper (Juniperus monosperma). Additional surface cover includes: blue grama (Bouteloua gracilis), galleta (Hilaria jamesii), alkali sacaton (Sporobolus airoides), rabbit brush (Chrysothamnus nauseosus), snake-weed (Gutierrezia sarothrae), sideoats grama (Bouteloua curtipendula), and western wheatgrass (Agropyron smithi).

CULTURAL RESOURCES:

This report: The revised location of San Juan 31-6 #44 places the proposed pad well out of way of Site JAS-53, (plus 150 feet to southern artifact concentrations.). However, the area surrounding the occupation loci is covered by a sparse scattering of artifacts. This may be caused by many possibilities, the prehistoric occupation, sheet-washing, and the chaining/reseeding activities among them. The surface to be interrupted by the pad construction is a relatively flat, predominately grassy area, which appears to have been mechanically smoothed and cleared of its natural vegetation. Within this area (the 400' x 400' inspection) several artifacts were located, but were not assigned isolated find numbers due to their association with site JAS-53. These artifacts include: approximately 20 greyware jar sherds approximately 75 feet southwest of the new center stake, a one hand, biface, quartzite mano with short axis linear wear, measuring 11cm x 9cm x 4cm, located approximately 100 feet southwest of the center stake, a sparse scattering of fire cracked rock in the road berm approximately 200 to 300 feet northeast of the new stake, as well as an extremely sparse scattering of greyware sherds and chalcedony and obsidian lithics throughout the area.

On Record: LA 16334, LA 16335 and LA 26272 are located approximately $1\frac{1}{4}$ miles to the south/southwest of the proposed location, in addition to JAS-53 immediately north.

RECOMMENDATION: It is recommended that the proposed location of San Juan 31-6 #44 be placed approximately 2370 feet from the north line and 1080 feet from the east line of Section 29, and be turned around so that its short axis is running north/south and its reserve pit is located in the northwest corner of the pad, thus avoiding archaeological site JAS-53 by more than 200 feet. With the majority of the site thus avoided, the remaining superficial scattering of artifacts in the immediate area appear to have a limited potential significance, that has been satisfied by the locational and descriptive data here-in and in report #CR82-71. This; the fact that these scattered artifacts appear in an area that has already been mechanically disturbed; and the fact that there is little if any more satisfactory space left in the area to locate the well in, leads us to recommend that the proposed well pad construction be considered in compliance with EO 11593 and the Historic Preservation Act of 1966. Clearance is recommended with the above relocation stipulations.

Figure 7

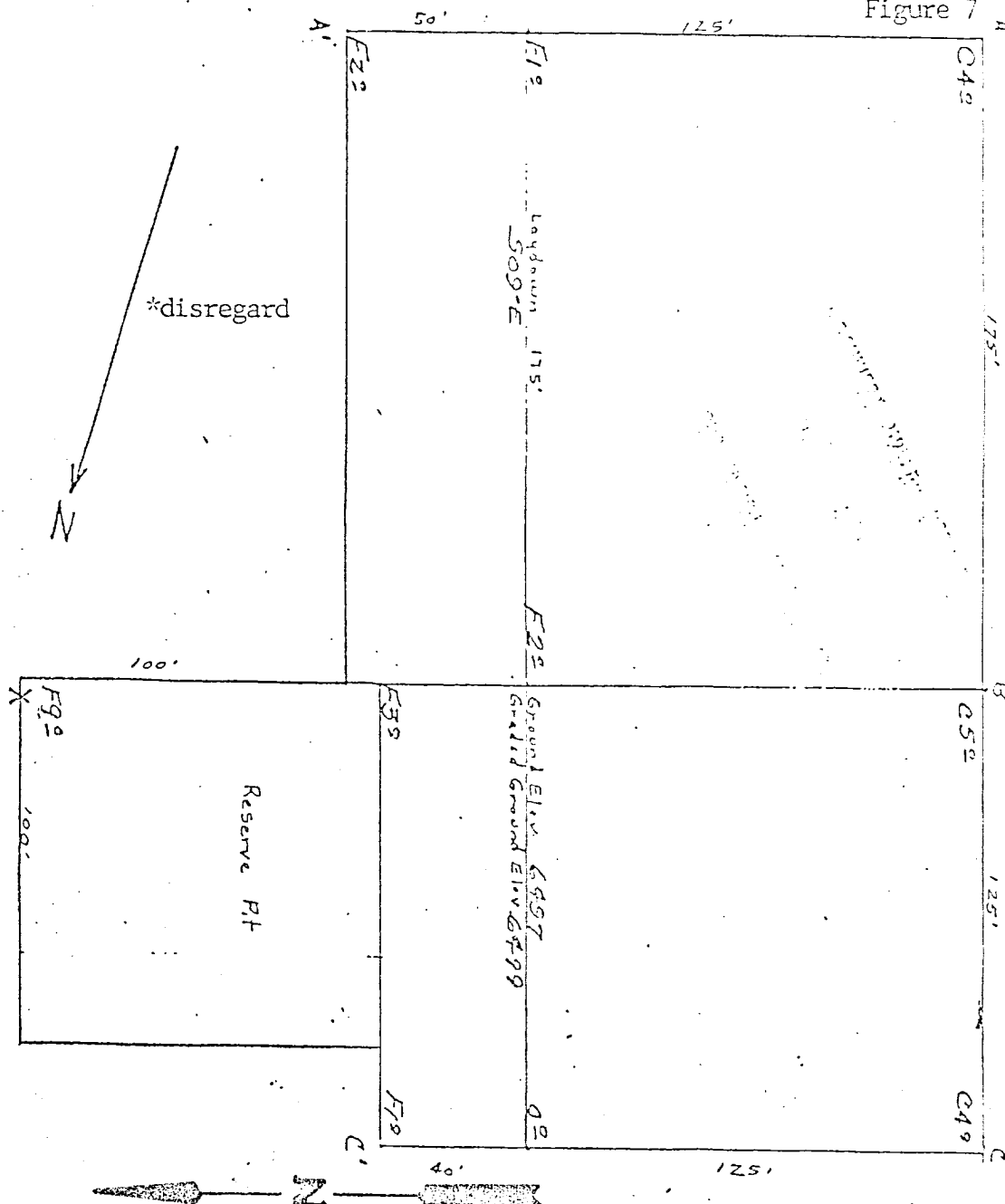

* Revised Profile will be drawn as above, except the pad will face in a new direction.

A - A'			Vert
6500	---	---	---
6490	---	---	---
	---	---	---
	---	---	---

B - B'			Vert
6500	---	---	---
6490	---	---	---
	---	---	---
	---	---	---

C - C'			Vert
6500	---	---	---
6490	---	---	---
	---	---	---
	---	---	---

100-443887-100

1997, 1998, 1999, 2000, 2001, 2002, 2003, 2004, 2005, 2006, 2007, 2008, 2009, 2010, 2011, 2012, 2013, 2014, 2015, 2016, 2017, 2018, 2019, 2020, 2021, 2022, 2023, 2024, 2025, 2026, 2027, 2028, 2029, 2030, 2031, 2032, 2033, 2034, 2035, 2036, 2037, 2038, 2039, 2040, 2041, 2042, 2043, 2044, 2045, 2046, 2047, 2048, 2049, 2050, 2051, 2052, 2053, 2054, 2055, 2056, 2057, 2058, 2059, 2060, 2061, 2062, 2063, 2064, 2065, 2066, 2067, 2068, 2069, 2070, 2071, 2072, 2073, 2074, 2075, 2076, 2077, 2078, 2079, 2080, 2081, 2082, 2083, 2084, 2085, 2086, 2087, 2088, 2089, 2090, 2091, 2092, 2093, 2094, 2095, 2096, 2097, 2098, 2099, 2100, 2101, 2102, 2103, 2104, 2105, 2106, 2107, 2108, 2109, 2110, 2111, 2112, 2113, 2114, 2115, 2116, 2117, 2118, 2119, 2120, 2121, 2122, 2123, 2124, 2125, 2126, 2127, 2128, 2129, 2130, 2131, 2132, 2133, 2134, 2135, 2136, 2137, 2138, 2139, 2140, 2141, 2142, 2143, 2144, 2145, 2146, 2147, 2148, 2149, 2150, 2151, 2152, 2153, 2154, 2155, 2156, 2157, 2158, 2159, 2160, 2161, 2162, 2163, 2164, 2165, 2166, 2167, 2168, 2169, 2170, 2171, 2172, 2173, 2174, 2175, 2176, 2177, 2178, 2179, 2180, 2181, 2182, 2183, 2184, 2185, 2186, 2187, 2188, 2189, 2190, 2191, 2192, 2193, 2194, 2195, 2196, 2197, 2198, 2199, 2200, 2201, 2202, 2203, 2204, 2205, 2206, 2207, 2208, 2209, 2210, 2211, 2212, 2213, 2214, 2215, 2216, 2217, 2218, 2219, 2220, 2221, 2222, 2223, 2224, 2225, 2226, 2227, 2228, 2229, 2230, 2231, 2232, 2233, 2234, 2235, 2236, 2237, 2238, 2239, 2240, 2241, 2242, 2243, 2244, 2245, 2246, 2247, 2248, 2249, 2250, 2251, 2252, 2253, 2254, 2255, 2256, 2257, 2258, 2259, 2260, 2261, 2262, 2263, 2264, 2265, 2266, 2267, 2268, 2269, 2270, 2271, 2272, 2273, 2274, 2275, 2276, 2277, 2278, 2279, 2280, 2281, 2282, 2283, 2284, 2285, 2286, 2287, 2288, 2289, 2290, 2291, 2292, 2293, 2294, 2295, 2296, 2297, 2298, 2299, 2300, 2301, 2302, 2303, 2304, 2305, 2306, 2307, 2308, 2309, 2310, 2311, 2312, 2313, 2314, 2315, 2316, 2317, 2318, 2319, 2320, 2321, 2322, 2323, 2324, 2325, 2326, 2327, 2328, 2329, 2330, 2331, 2332, 2333, 2334, 2335, 2336, 2337, 2338, 2339, 2340, 2341, 2342, 2343, 2344, 2345, 2346, 2347, 2348, 2349, 2350, 2351, 2352, 2353, 2354, 2355, 2356, 2357, 2358, 2359, 2360, 2361, 2362, 2363, 2364, 2365, 2366, 2367, 2368, 2369, 2370, 2371, 2372, 2373, 2374, 2375, 2376, 2377, 2378, 2379, 2380, 2381, 2382, 2383, 2384, 2385, 2386, 2387, 2388, 2389, 2390, 2391, 2392, 2393, 2394, 2395, 2396, 2397, 2398, 2399, 2400, 2401, 2402, 2403, 2404, 2405, 2406, 2407, 2408, 2409, 2410, 2411, 2412, 2413, 2414, 2415, 2416, 2417, 2418, 2419, 2420, 2421, 2422, 2423, 2424, 2425, 2426, 2427, 2428, 2429, 2430, 2431, 2432, 2433, 2434, 2435, 2436, 2437, 2438, 2439, 2440, 2441, 2442, 2443, 2444, 2445, 2446, 2447, 2448, 2449, 2450, 2451, 2452, 2453, 2454, 2455, 2456, 2457, 2458, 2459, 2460, 2461, 2462, 2463, 2464, 2465, 2466, 2467, 2468, 2469, 2470, 2471, 2472, 2473, 2474, 2475, 2476, 2477, 2478, 2479, 2480, 2481, 2482, 2483, 2484, 2485, 2486, 2487, 2488, 2489, 2490, 2491, 2492, 2493, 2494, 2495, 2496, 2497, 2498, 2499, 2500, 2501, 2502, 2503, 2504, 2505, 2506, 2507, 2508, 2509, 2510, 2511, 2512, 2513, 2514, 2515, 2516, 2517, 2518, 2519, 2520, 2521, 2522, 2523, 2524, 2525, 2526, 2527, 2528, 2529, 2530, 2531, 2532, 2533, 2534, 2535, 2536, 2537, 2538, 2539, 2540, 2541, 2542, 2543, 2544, 2545, 2546, 2547, 2548, 2549, 2550, 2551, 2552, 2553, 2554, 2555, 2556, 2557, 2558, 2559, 2560, 2561, 2562, 2563, 2564, 2565, 2566, 2567, 2568, 2569, 2570, 2571, 2572, 2573, 2574, 2575, 2576, 2577, 2578, 2579, 2580, 2581, 2582, 2583, 2584, 2585, 2586, 2587, 2588, 2589, 2590, 2591, 2592, 2593, 2594, 2595, 2596, 2597, 2598, 2599, 2600, 2601, 2602, 2603, 2604, 2605, 2606, 2607, 2608, 2609, 2610, 2611, 2612, 2613, 2614, 2615, 2616, 2617, 2618, 2619, 2620, 2621, 2622, 2623, 2624, 2625, 2626, 2627, 2628, 2629, 2630, 2631, 2632, 2633, 2634, 2635, 2636, 2637, 2638, 2639, 2640, 2641, 2642, 2643, 2644, 2645, 2646, 2647, 2648, 2649, 2650, 2651, 2652, 2653, 2654, 2655, 2656, 2657, 2658, 2659, 2660, 2661, 2662, 2663, 2664, 2665, 2666, 2667, 2668, 2669, 2670, 2671, 2672, 2673, 2674, 2675, 2676, 2677, 2678, 26

3. DATE OF DEATH _____
PLACE OF BIRTH _____
DATE OF BIRTH _____

Blackwood & Nichols

P.O. Box 1237

Durango, Colorado 81301

.20

.75

San Juan 31-6 Unit #44

11-11-69, Apr 1970

CONFIDENTIAL

POSTMARKS

.95

4083000m N

T 31 N

T 30 N

50'

4079

4078

71 AUG 21 AM 1960

