

Memo

From

ERNIE BUSCH
Geologist - Field Rep.

8-23-88

To Mary Jo

THIS WELL WAS ORIGINALLY
PERMITTED AS A STATE WELL,
HOWEVER THAT WAS IN ERROR
AND SHOULD HAVE BEEN FEDERAL.

THE WELL FILE WILL HAVE TO BE
PULLED AND REVISED TO SHOW
(yellow)
FEDERAL, AND ALSO THE KARDX
CARD WILL HAVE TO BE CHANGED
TO WHITE.

Amended
from
30-039-2A2-77
to previous loc.
changed from
Fed - Fee

Amended location / Fee to Fed.

Oil Conservation

Aztec, New Mexico

30-039-24240

NO. OF COPIES RECEIVED		
DISTRIBUTION		
SANTA FE		
FILE		
U.S.G.S.		
LAND OFFICE		
OPERATOR		

NEW MEXICO OIL CONSERVATION COMMISSION

Form C-101
Revised 1-1-65

5A. Indicate Type of Lease STATE <input type="checkbox"/> FEE <input checked="" type="checkbox"/>
5. State Oil & Gas Lease No.

APPLICATION FOR PERMIT TO DRILL, DEEPEN, OR PLUG BACK

1a. Type of Work DRILL <input checked="" type="checkbox"/> DEEPEN <input type="checkbox"/> PLUG BACK <input type="checkbox"/>		7. Unit Agreement Name
b. Type of Well OIL WELL <input type="checkbox"/> GAS WELL <input checked="" type="checkbox"/> OTHER <input type="checkbox"/> SINGLE ZONE <input checked="" type="checkbox"/> MULTIPLE ZONE <input type="checkbox"/>		8. Farm or Lease Name Rosa Unit
2. Name of Operator Northwest Pipeline Corporation		9. Well No. #206
3. Address of Operator 3539 East 30th Street - Farmington, NM 87401		10. Field and Pool, or Wildcat Undesignated Fruitland
4. Location of Well UNIT LETTER <u>A</u> LOCATED <u>1155</u> FEET FROM THE <u>North</u> LINE AND <u>1150</u> FEET FROM THE <u>East</u> LINE OF SEC. <u>24</u> TWP. <u>31N</u> RGE. <u>6W</u> NMPM		12. County Rio Arriba
19. Proposed Depth 3275'		19A. Formation Fruitland
20. Rotary or C.T. Rotary		
21. Elevations (Show whether DF, RT, etc.) 6265' GR	21A. Kind & Status Plug. Bond	21B. Drilling Contractor
22. Approx. Date Work will start 7-1-88		

PROPOSED CASING AND CEMENT PROGRAM

SIZE OF HOLE	SIZE OF CASING	WEIGHT PER FOOT	SETTING DEPTH	SACKS OF CEMENT	EST. TOP
12-1/4"	9-5/8"	36#	200'	125 cu.ft.	
8-3/4"	7"	20#	2905'	140 cu.ft.	
6-1/4"	5-1/2"	23#	3275'	Open hole completion	

The NE/4 of Sec. 24 is dedicated to this well.

UNLESS DRILLING IS COMMENCED.
SPUD NOTICE MUST BE SUBMITTED
WITHIN 10 DAYS.

IN ABOVE SPACE DESCRIBE PROPOSED PROGRAM: IF PROPOSAL IS TO DEEPEN OR PLUG BACK, GIVE DATA ON PRESENT PRODUCTIVE ZONE AND PROPOSED NEW PRODUCTIVE ZONE. GIVE BLOWOUT PREVENTER PROGRAM, IF ANY.

I hereby certify that the information above is true and complete to the best of my knowledge and belief.

Signed Mike Turnbaugh Title Senior Engineer Date 6-6-88
(This space for State Use)

APPROVED BY Ed Paul TITLE DEPUTY OIL & GAS INSPECTOR, DIST. #3 DATE JUN 15 1988

CONDITIONS OF APPROVAL, IF ANY:

Ref C-104 for NSL & NSP

OIL CONSERVATION DIVISION

STATE OF NEW MEXICO
ENERGY AND MINERALS DEPARTMENTP. O. BOX 2080
SANTA FE, NEW MEXICO 87501Form C-102
Revised 10-1-78

All distances must be from the outer boundaries of the Section.

Operator Northwest Pipeline Corporation			Lease Rosa Unit		Well No. 206
Unit Letter A	Section 24	Township 31 North	Range 6 West	County Rio Arriba	
Actual Footage Location of Well: 1155 feet from the North line and 1150 feet from the East line					
Ground Level Elev. 6265	Producing Formation Fruitland <i>CEHL</i>		Pool <i>W.C.</i> Undesignated Fruitland	Dedicated Acreage: 111.9 Acres	

1. Outline the acreage dedicated to the subject well by colored pencil or hachure marks on the plat below.
2. If more than one lease is dedicated to the well, outline each and identify the ownership thereof (both as to working interest and royalty).
3. If more than one lease of different ownership is dedicated to the well, have the interests of all owners been consolidated by communitization, unitization, force-pooling, etc?

☒ Yes ☐ No If answer is "yes," type of consolidation Unitization

If answer is "no," list the owners and tract descriptions which have actually been consolidated. (Use reverse side of this form if necessary.)

No allowable will be assigned to the well until all interests have been consolidated (by communitization, unitization, forced-pooling, or otherwise) or until a non-standard unit, eliminating such interests, has been approved by the Division.

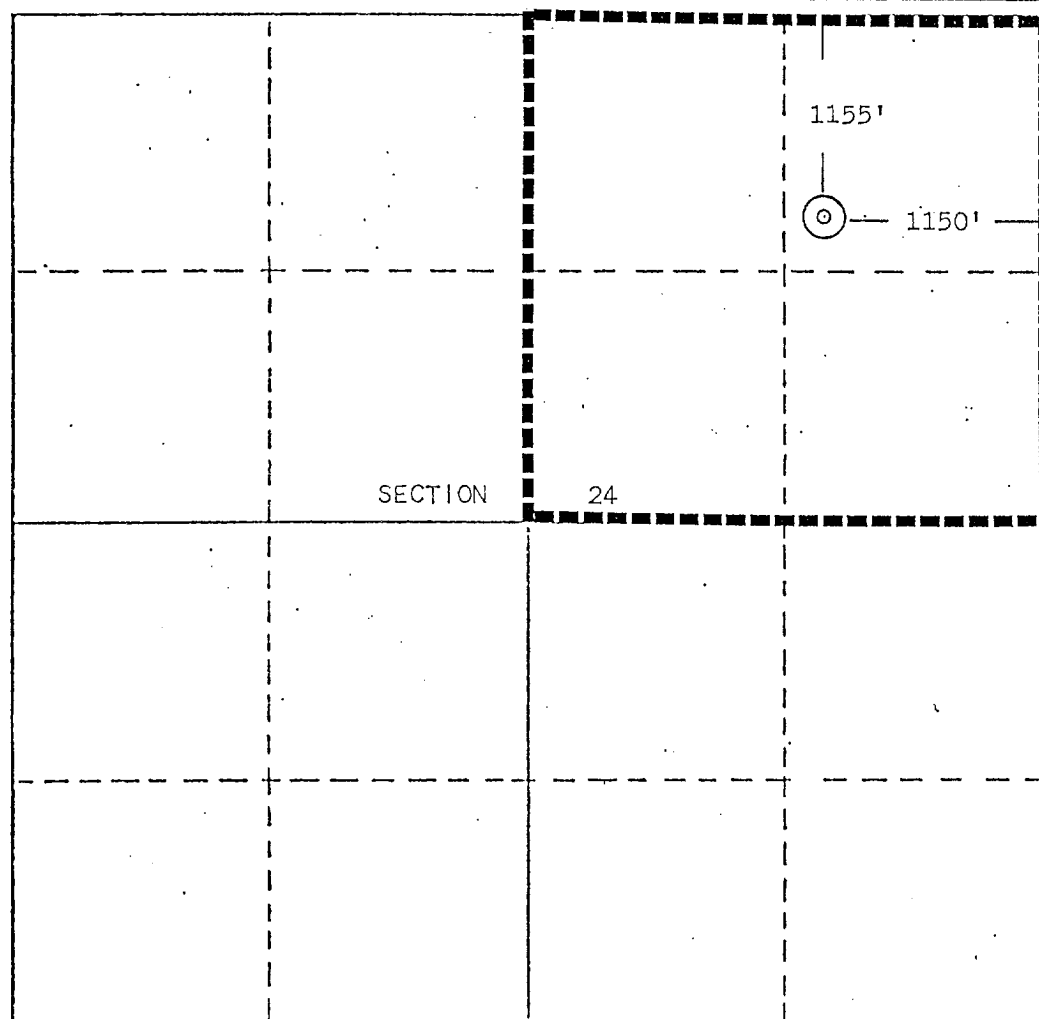

CERTIFICATION

I hereby certify that the information contained herein is true and complete to the best of my knowledge and belief.

Name

Mike J. Turlough

Position

Senior Engineer

Company

Northwest Pipeline Corp.

Date

5-3-88

I hereby certify that the location shown on this plat was plotted from field notes of actual survey made by me or under my supervision, and that the same is true and correct to the best of my knowledge and belief.

Date Surveyed

April 25, 1988

Registered Professional Engineer and/or Land Surveyor

Edgar L. Risenhoover

Certificate No. 5979

Edgar L. Risenhoover, L.S.

