

UNITED STATES
DEPARTMENT OF THE INTERIOR
BUREAU OF LAND MANAGEMENT

APPLICATION FOR PERMIT TO DRILL, DEEPEN, OR PLUG BACK

1a. TYPE OF WORK

DRILL ☒

DEEPEN ☐

PLUG BACK ☐

b. TYPE OF WELL

OIL
WELL ☐

GAS
WELL ☒

OTHER

SINGLE
ZONE ☒

MULTIPLE
ZONE ☐

2. NAME OF OPERATOR

Northwest Pipeline Corporation

3. ADDRESS OF OPERATOR

3539 E. 30th St. Farmington, New Mexico 87401

4. LOCATION OF WELL (Report location clearly and in accordance with any State requirements.)*

At surface

535' FSL & 685' FEL SE/4 SE/4

At proposed prod. zone

Same

14. DISTANCE IN MILES AND DIRECTION FROM NEAREST TOWN OR POST OFFICE*

Approximately 20 miles to Gobernador

10. DISTANCE FROM PROPOSED*

LOCATION TO NEAREST
PROPERTY OR LEASE LINE, FT.
(Also to nearest drlg. unit line, if any)

535'

16. NO. OF ACRES IN LEASE

N/A 2518.04

17. NO. OF ACRES ASSIGNED

TO THIS WELL

264.56

18. DISTANCE FROM PROPOSED LOCATION*

TO NEAREST WELL, DRILLING, COMPLETED,
OR APPLIED FOR, ON THIS LEASE, FT.

+ 2500'

19. PROPOSED DEPTH

3164'

20. ROTARY OR CABLE TOOLS

Rotary

21. ELEVATIONS (Show whether DF, RT, GR, etc.)

6350' GR DRILLING OPERATIONS AUTHORIZED ARE

22. APPROX. DATE WORK WILL START*

3-1-89

23. SUBJECT TO COMPLIANCE WITH PROPOSED CASING AND CEMENTING PROGRAM
"GENERAL REQUIREMENTS"

This action is subject to technical and
procedural review pursuant to 43 CFR 3165.3
and appeal pursuant to 43 CFR 3165.4.

SIZE OF HOLE	SIZE OF CASING	WEIGHT PER FOOT	SETTING DEPTH	
12-1/4"	9-5/8"	32.3#	200'	125 cu. ft.
8-3/4"	7"	20#	2992'	150 cu. ft.
6-1/4"	5-1/2"	23#	3164'	Open hole completion

The S/2 of Section 6 is dedicated to this well.

Location is unorthodox due to BLM request.

RECEIVED
JUL 26 1989
OIL CON. DIV.
DIST. 3

IN ABOVE SPACE DESCRIBE PROPOSED PROGRAM: If proposal is to deepen or plug back, give data on present productive zone and proposed new productive zone. If proposal is to drill or deepen directionally, give pertinent data on subsurface locations and measured and true vertical depths. Give blowout preventer program, if any.

24.

SIGNED

Mike Turnbaugh

TITLE

Senior Engineer

DATE

12/19/88

(This space for Federal or State office use)

PERMIT NO.

APPROVAL DATE

APPROVED BY

TITLE

CONDITIONS OF APPROVAL, IF ANY:

APPROVED
AS AMENDED

JUL 26 1989

AREA MANAGER

ch-1

Hold C-164 FOR NSL + NSP
NSP-1578 (L) (S) *See Instructions On Reverse Side

All distances must be from the outer boundaries of the Section.

Operator Northwest Pipeline Corporation			Lease Rosa Unit		Well No. 241
Unit Letter P	Section 6	Township 31 North	Range 5 West	County Rio Arriba	
Actual Footage Location of Well: 535 feet from the South line and 685 feet from the East line					
Ground Level Elev. 6350	Producing Formation Fruitland	Pool Basin Fruitland Pool		Dedicated Acres 264.56 Acres	

1. Outline the acreage dedicated to the subject well by colored pencil or hachure marks on the plat below.
2. If more than one lease is dedicated to the well, outline each and identify the ownership thereof (both as to working interest and royalty).
3. If more than one lease of different ownership is dedicated to the well, have the interests of all owners been consolidated by communitization, unitization, force-pooling, etc?

☒ Yes ☐ No If answer is "yes," type of consolidation unitization

If answer is "no," list the owners and tract descriptions which have actually been consolidated. (Use reverse side of this form if necessary.)

No allowable will be assigned to the well until all interests have been consolidated (by communitization, unitization, forced-pooling, or otherwise) or until a non-standard unit, eliminating such interests, has been approved by the Division.

RECEIVED
SANTA FE ROOM
00 DEC 22 PM 1:07
FARMINGTON RESOURCE AREA
FARMINGTON, NEW MEXICO

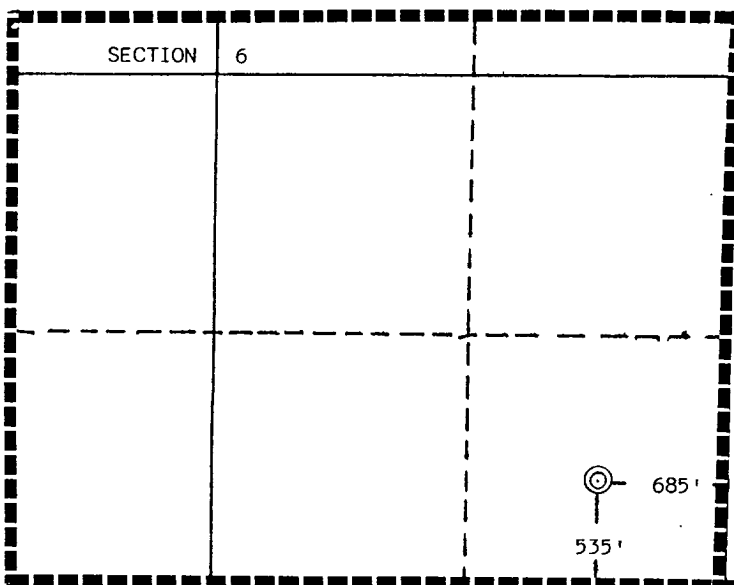

CERTIFICATION

I hereby certify that the information contained herein is true and complete to the best of my knowledge and belief.

Mike Turnbaugh

Name

Mike Turnbaugh

Position

Senior Engineer

Company

Northwest Pipeline Corp.

Date

11-1-88

I hereby certify that the well location shown on this plat was plotted from field notes of actual surveys made by me or under my supervision, and that the same is true and correct to the best of my knowledge and belief.

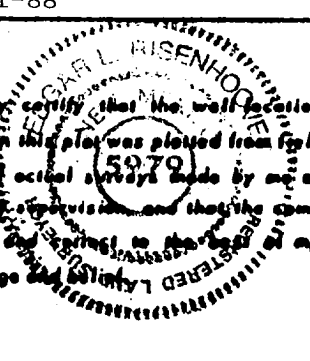

Date Surveyed

September 21, 1988

Registered Professional Engineer and/or Land Surveyor

Edgar L. Risenhoover

Certificate No. 5979

Edgar L. Risenhoover, I. S.

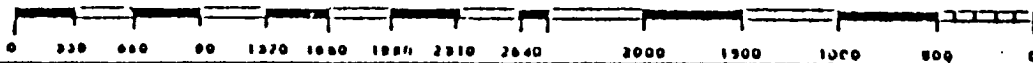

NORTHWEST PIPELINE CORP.

ROSA UNIT 241

535' F/SL 685' F/EL

Sec. 6, T-31-N, R-5-W, NMPM

Rio Arriba County, New Mexico

